

BENCHMARK:
 "□" at Back of Walk 50± West
 & 50± South of C. of Tyler &
 Central Intersection
 Elev. = 145.03 City Datum

TYLER ACRES FIFTH ADDITION
 LOT 1

APPROVED AS NOTED
 BY CITY ENGINEER OF WICHITA

Sanitary Sewer VRH 8/24/95
 Storm Sewer _____
 Driveway Approaches _____
 Drinker Sheds _____
 Paving _____

NOTE TO CONTRACTORS
 Inspection and testing for this project is to be provided by a Licensed Consulting Engineering Firm under contract with the Owner/Developer. Soil inspection is to be in accordance with the City of Wichita standard construction engineering practices and certified by a Licensed Professional Engineer. No work shall be performed in dedicated easements or public right-of-way by the Contractor without such inspection nor shall any work be commenced without written authorization by the City Engineer. All Construction and materials shall comply with the City of Wichita Specifications and Standards (on file and available in the City Engineer's Office).

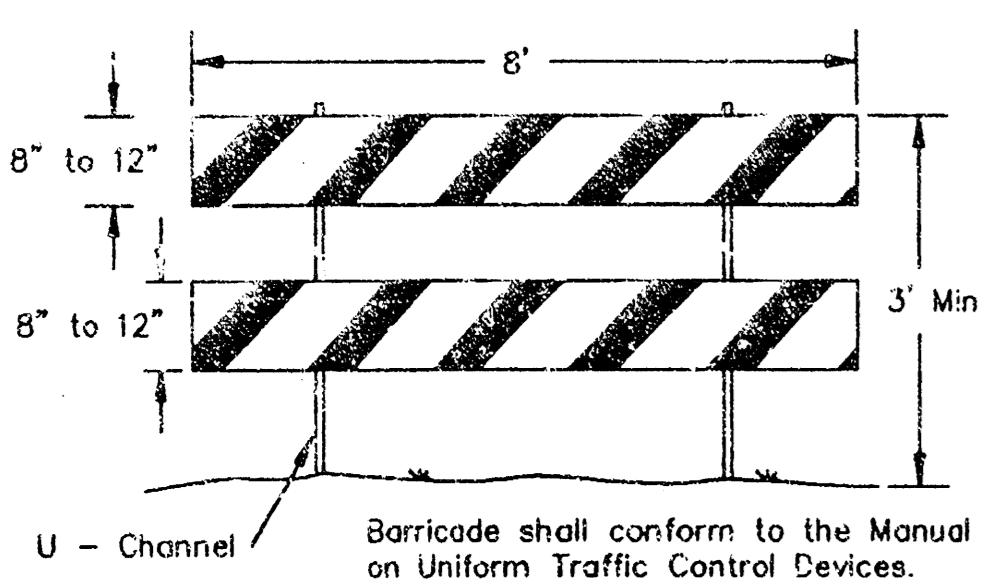

TYPE II BARRICADE
 DETAIL
 NOT TO SCALE

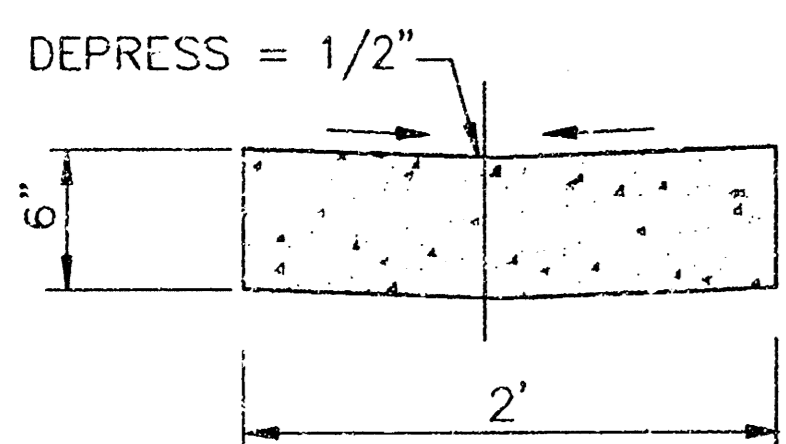

CONCRETE VALLEY
 GUTTER DETAIL
 NOT TO SCALE

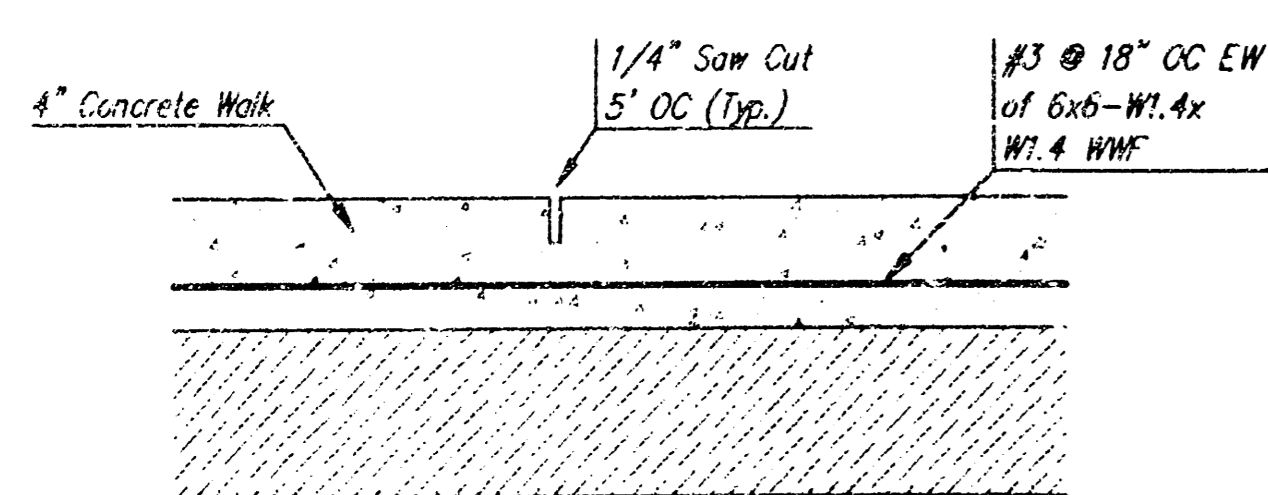

SIDEWALK DETAIL
 NOT TO SCALE

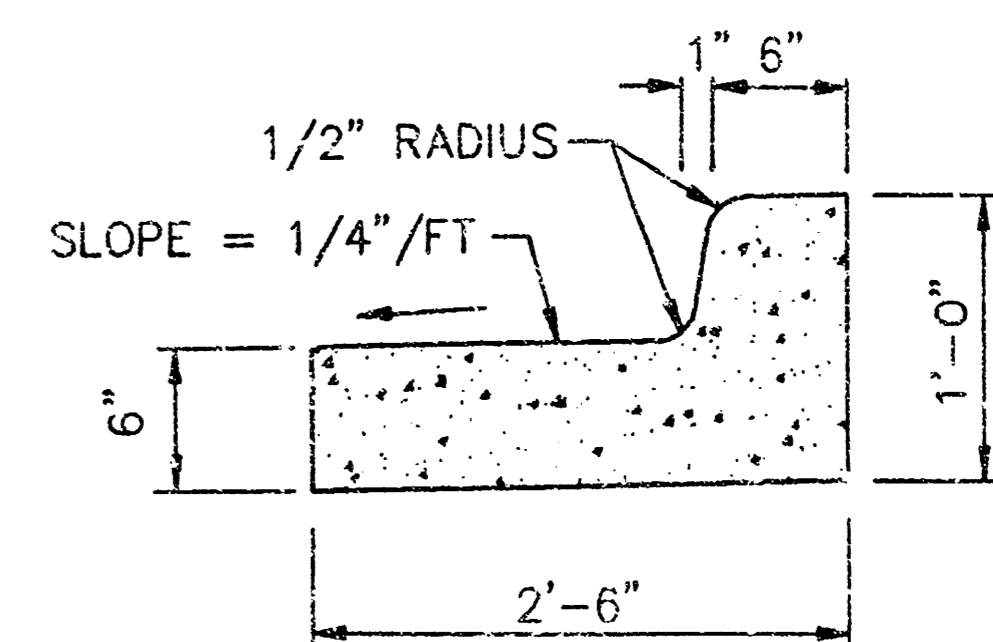
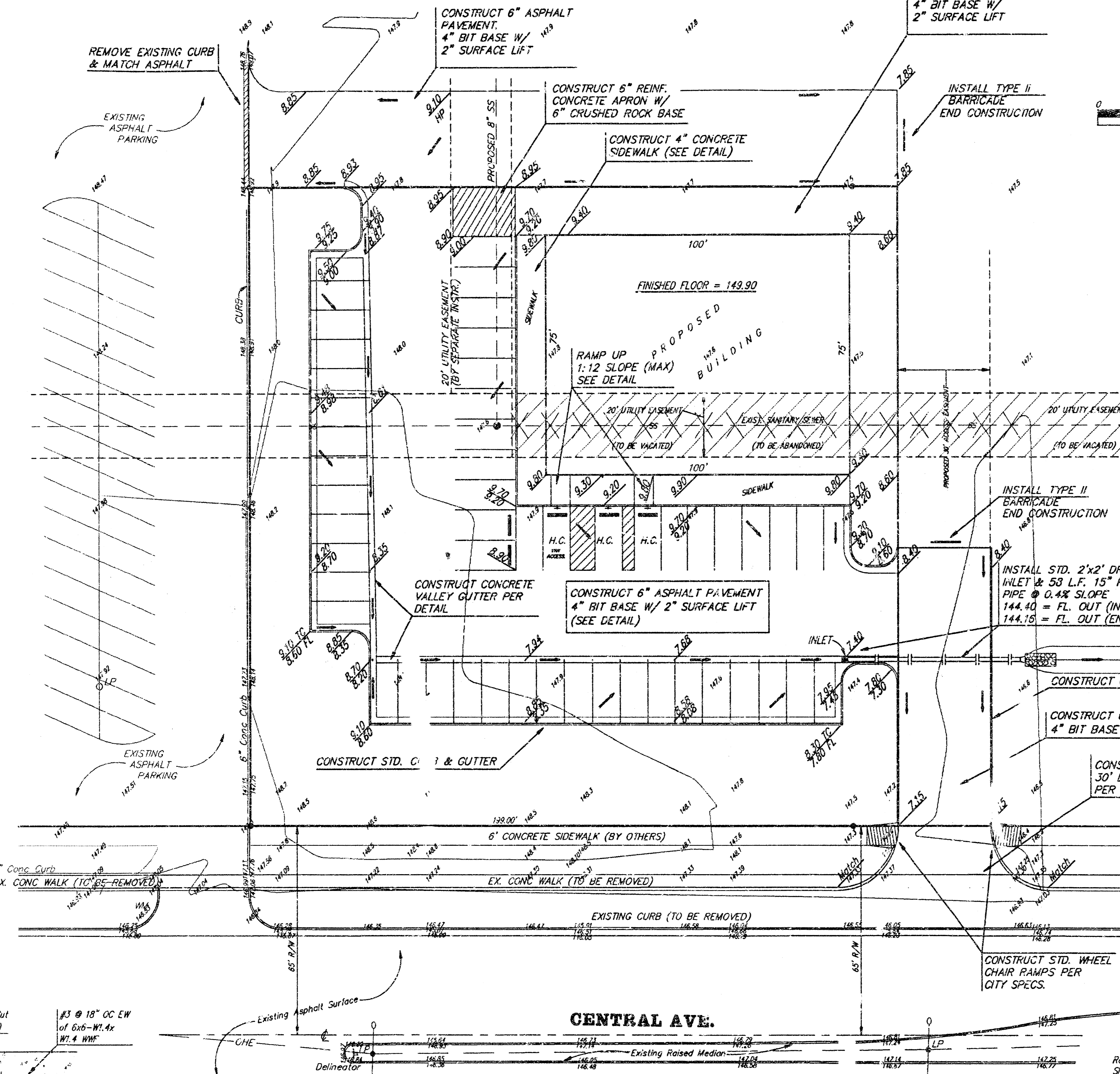

STD. CURB & GUTTER
 DETAILS
 NOT TO SCALE

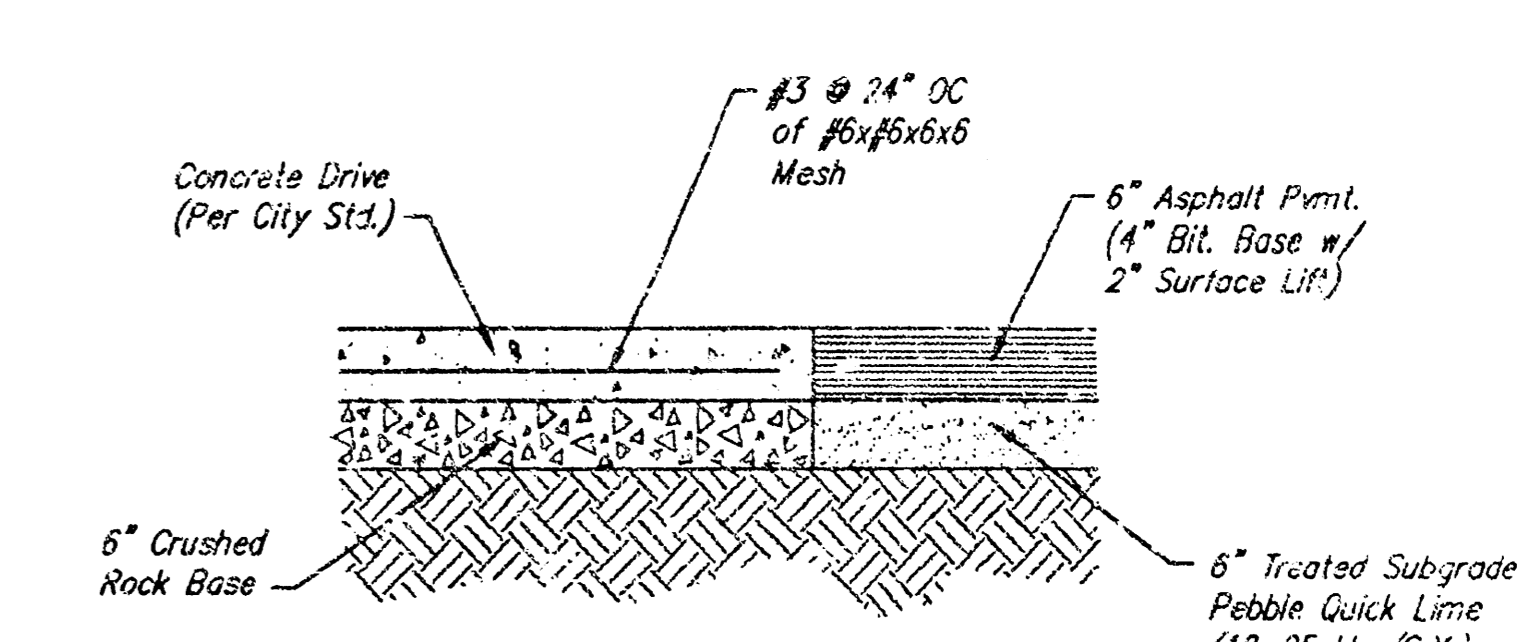

PAVEMENT DETAILS
 NOT TO SCALE

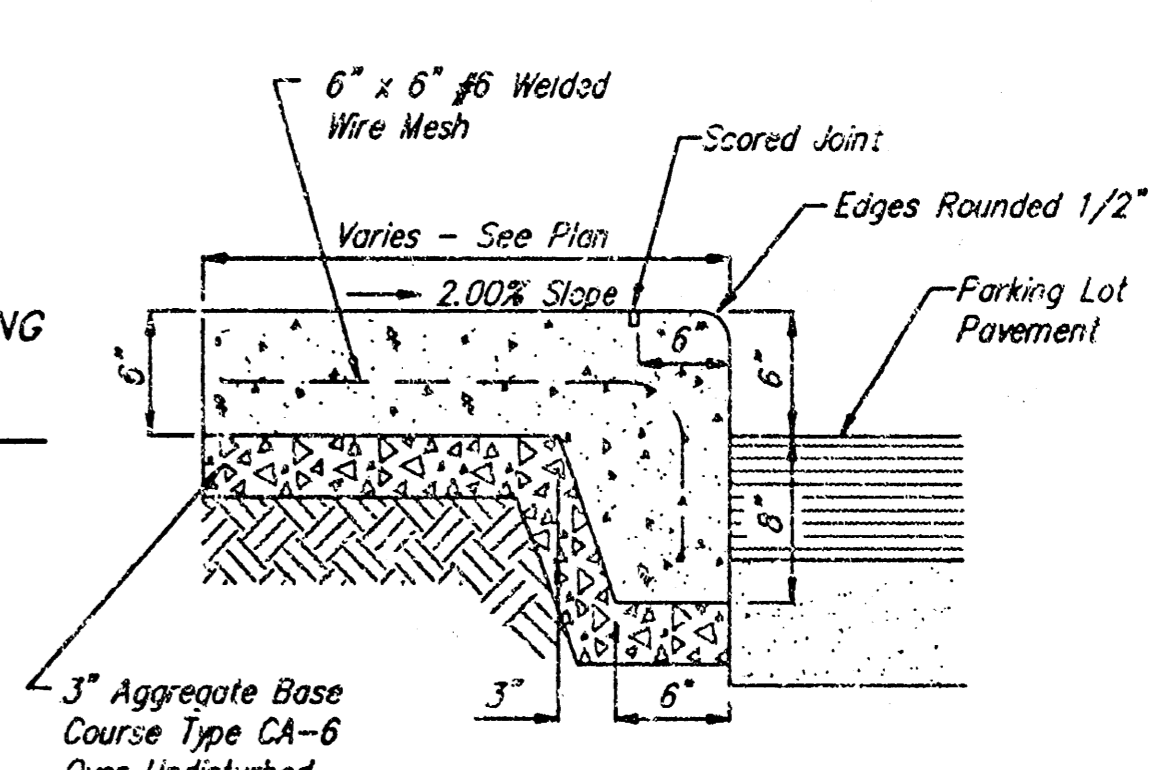

SIDEWALK CURB DETAILS
 NOT TO SCALE

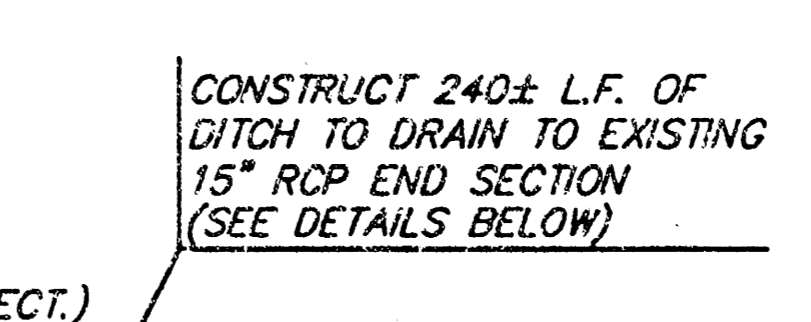

DITCH CROSS SECTION
 NOT TO SCALE

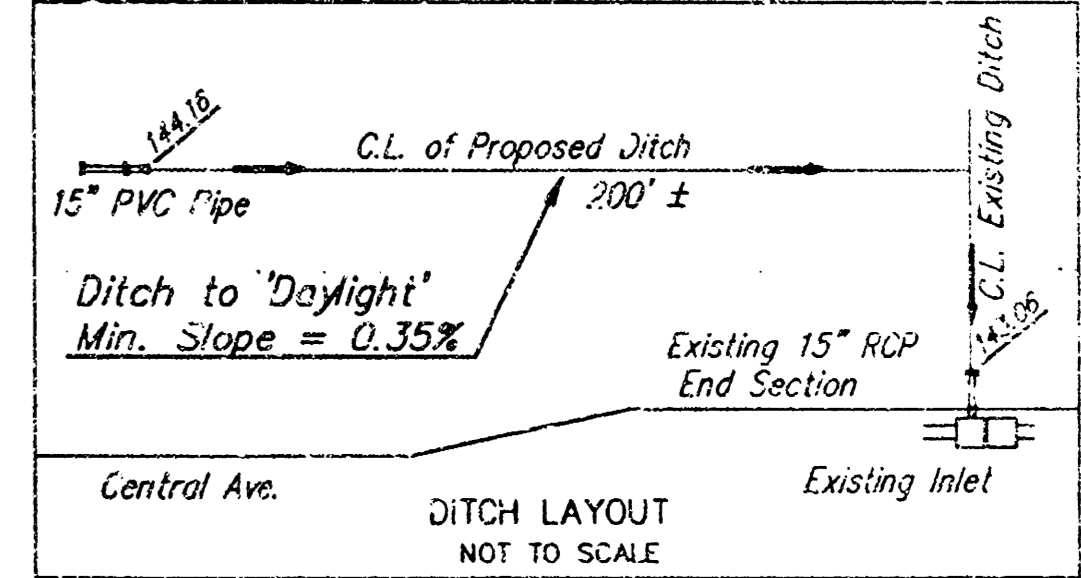

DITCH LAYOUT
 NOT TO SCALE

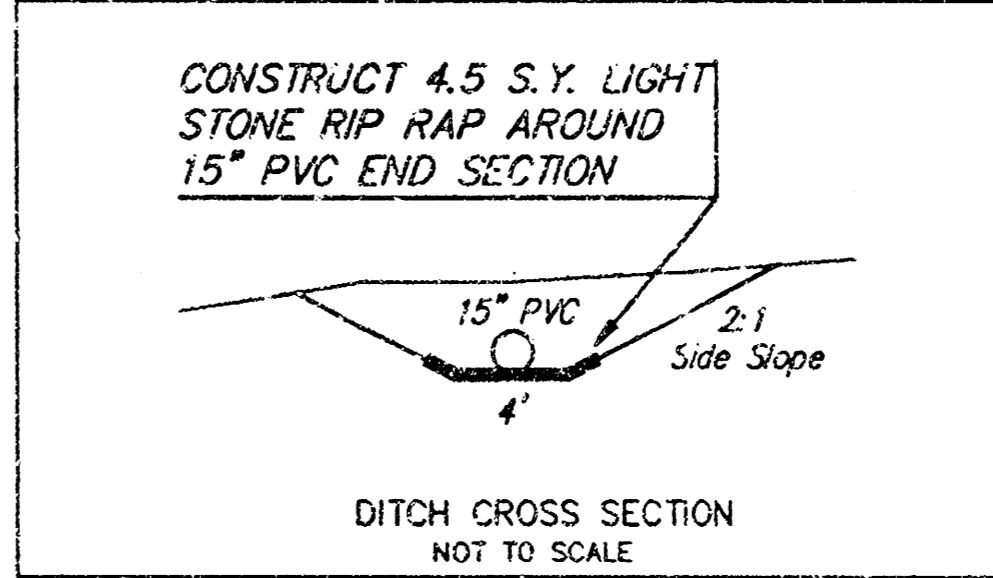

DITCH CROSS SECTION
 NOT TO SCALE

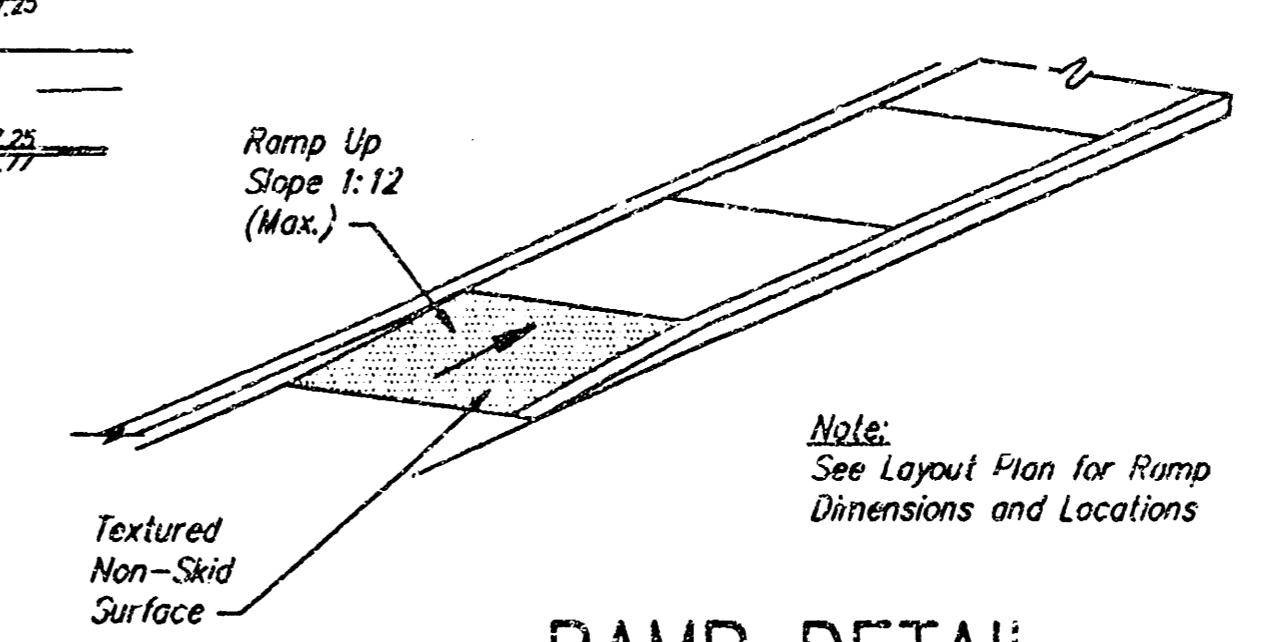

RAMP DETAIL
 NOT TO SCALE

At time the end section was installed. But this project has been added on going to east now, it is a parking area for a business.



REVISED 8-14-95 PER CITY COMMENTS
 REVISED 8-23-95 FOR DRAINAGE

HOLLYWOOD ENTERTAINMENT
SITE GRADING
 PLAN

BAUGHMAN COMPANY P. A.
 ENGINEERING, SURVEYING, & PLANNING
 318-292-7271 • 315 ELLIS • WICHITA, KANSAS 67211

PROJECT NUMBER
580 PPS (807881)

DESIGN	DRAWN	APPROVED	DATE	SCALE
NBW	MCC/MSP		7/19/95	1"=20'

SHEET