

General Notes:

1. All work on this project shall conform to the Standard Specifications for Storm Sewer Construction of the City of Wichita.
2. All areas disturbed by Contractor's operations shall be restored in accordance with City of Wichita Administrative Regulation AR-78.
3. The Contractor shall notify Kansas One-Call (867-2410) a minimum of 48 hours prior to any excavation.

CONTRACTOR NOTE:

"1" Cut on top of curb @ NE corner Lot 4, Block 1, Whisler's Fines Estates; Elevation = 145.10 City Datum.

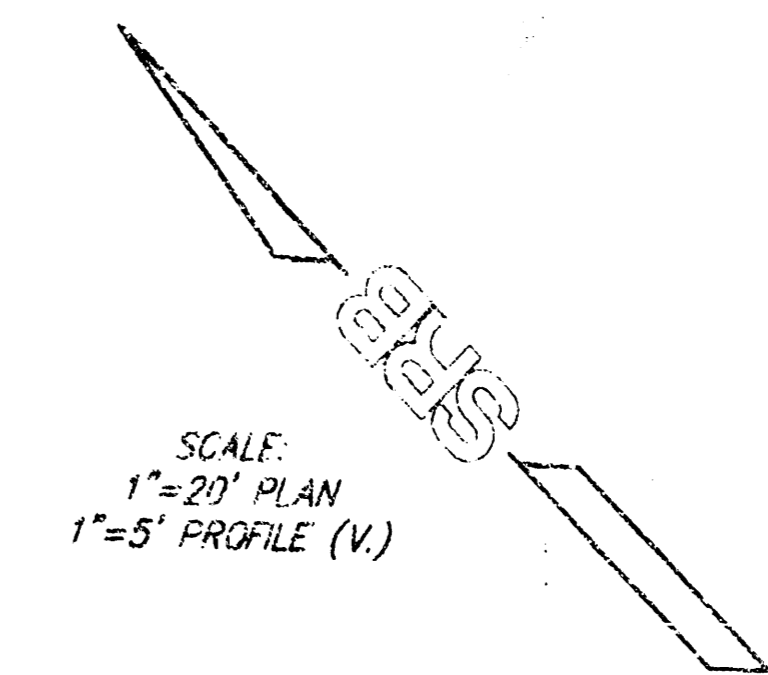
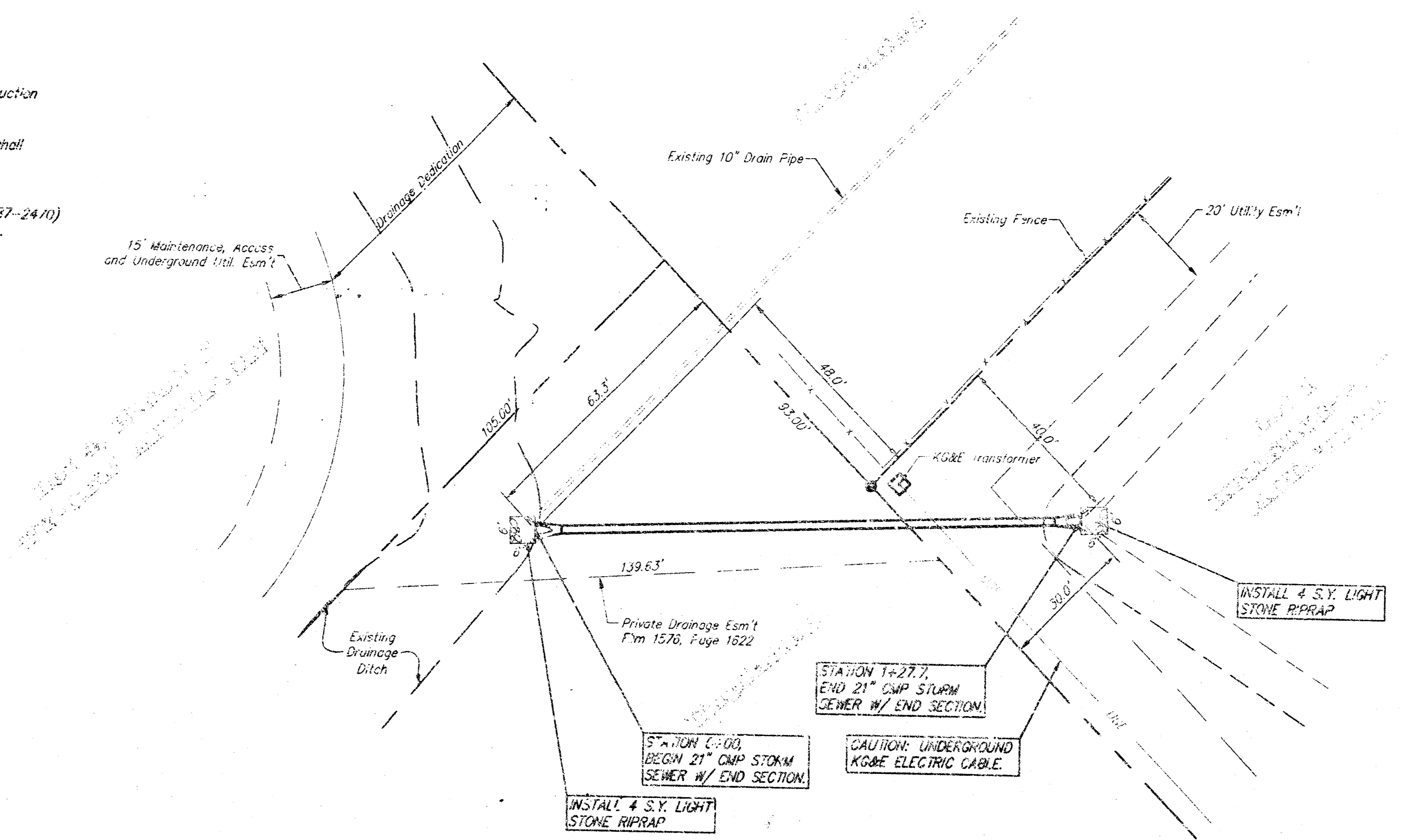

APPROVED AS NOTED
BY CITY ENGINEER OF WICHITA

Sanitary Sewers _____
Storm Sewers URP 1/12/96
Driveway Approaches _____
Water Mains _____
Paving _____

NOTE TO CONTRACTORS

Inspection and testing for this project are to be provided by a Licensed Consulting Engineering Firm under contract with the City/Developer. Said Inspector to be in accordance with the City of Wichita standard construction engineering practices and carried by a Licensed Professional Engineer. No work shall be performed in restricted easements or public right-of-way by the Contractor without such inspection, nor shall any work be commenced without written authorization by the City Engineer.

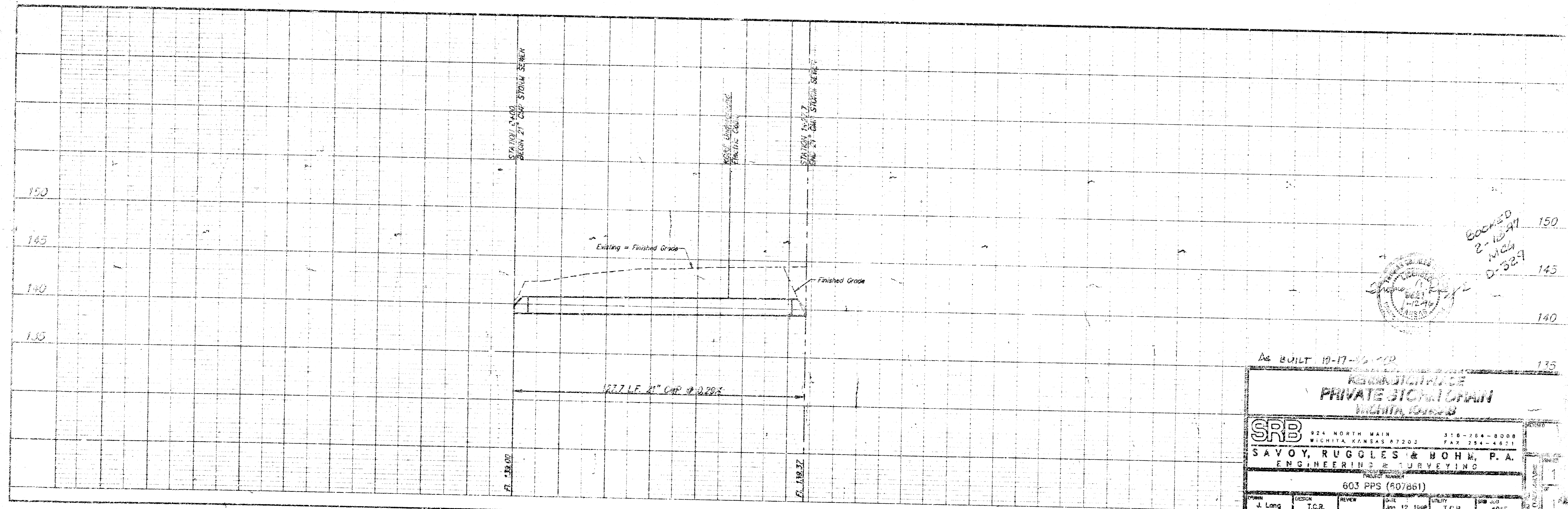
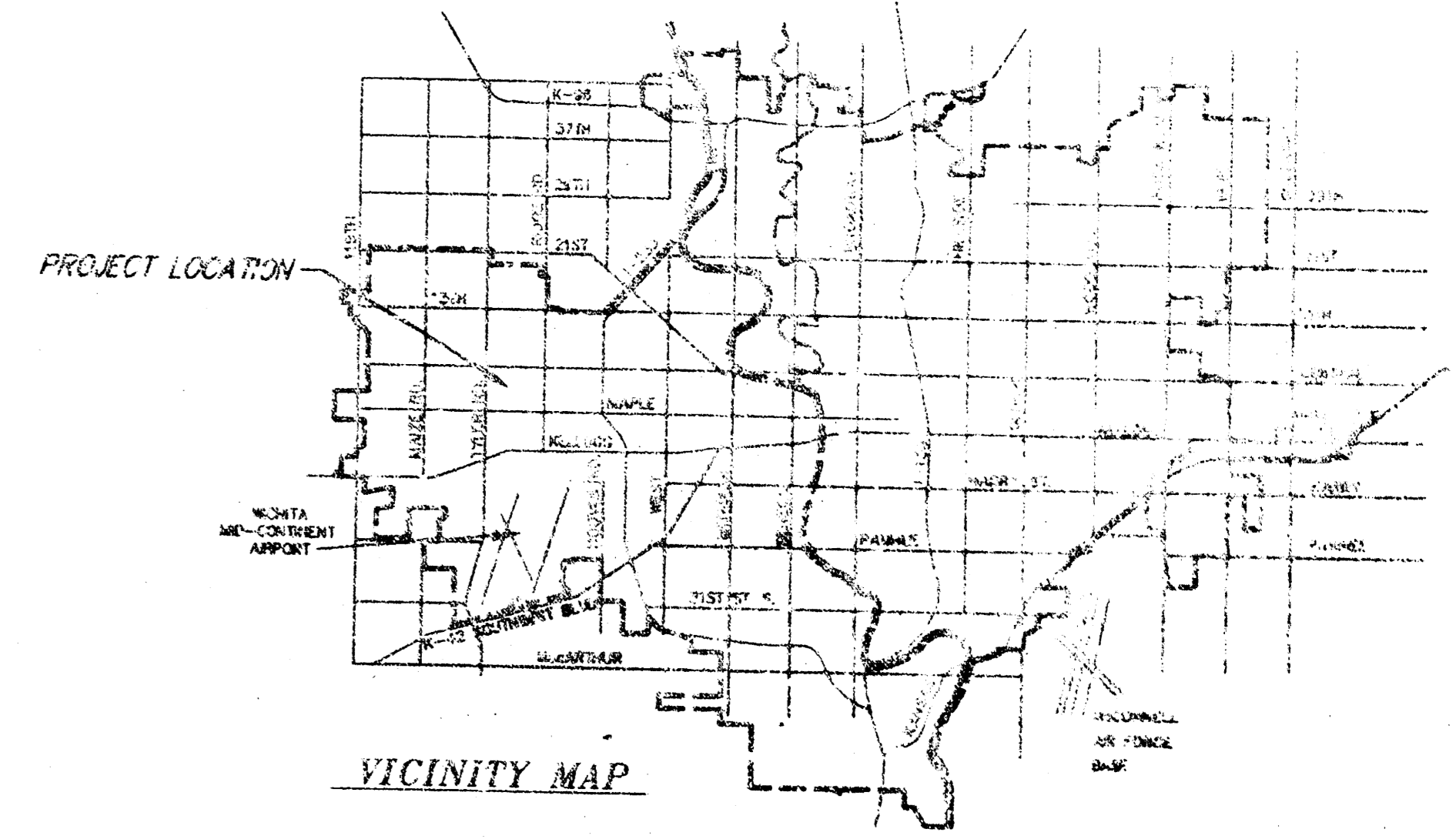

BOOKED
2-18-97
MCS
D-329

AS BUILT 10-17-96

RECONSTRUCTION
PRIVATE STORM DRAIN
WICHITA, KANSAS

SRB 324 NORTH MAIN WICHITA, KANSAS 67203 316-264-8000 FAX 316-264-4851

SAVOY, RUGGLES & BOHM, P.A.
ENGINEERING & SURVEYING

PROJECT NUMBER
603 PPS (607861)

DESIGNER	CHECKER	DATE	SCALE	TITLE
J. Long	T.C.R.	Jan. 12, 1996	T.C.R.	603 PPS