

Benchmark:
City of Wichita Benchmark. Top of Hubguard at the N.W. Corner of RBC at the N.W. Corner of the Intersection of Broadway Avenue and 55th Street South
Elevation = 84.47

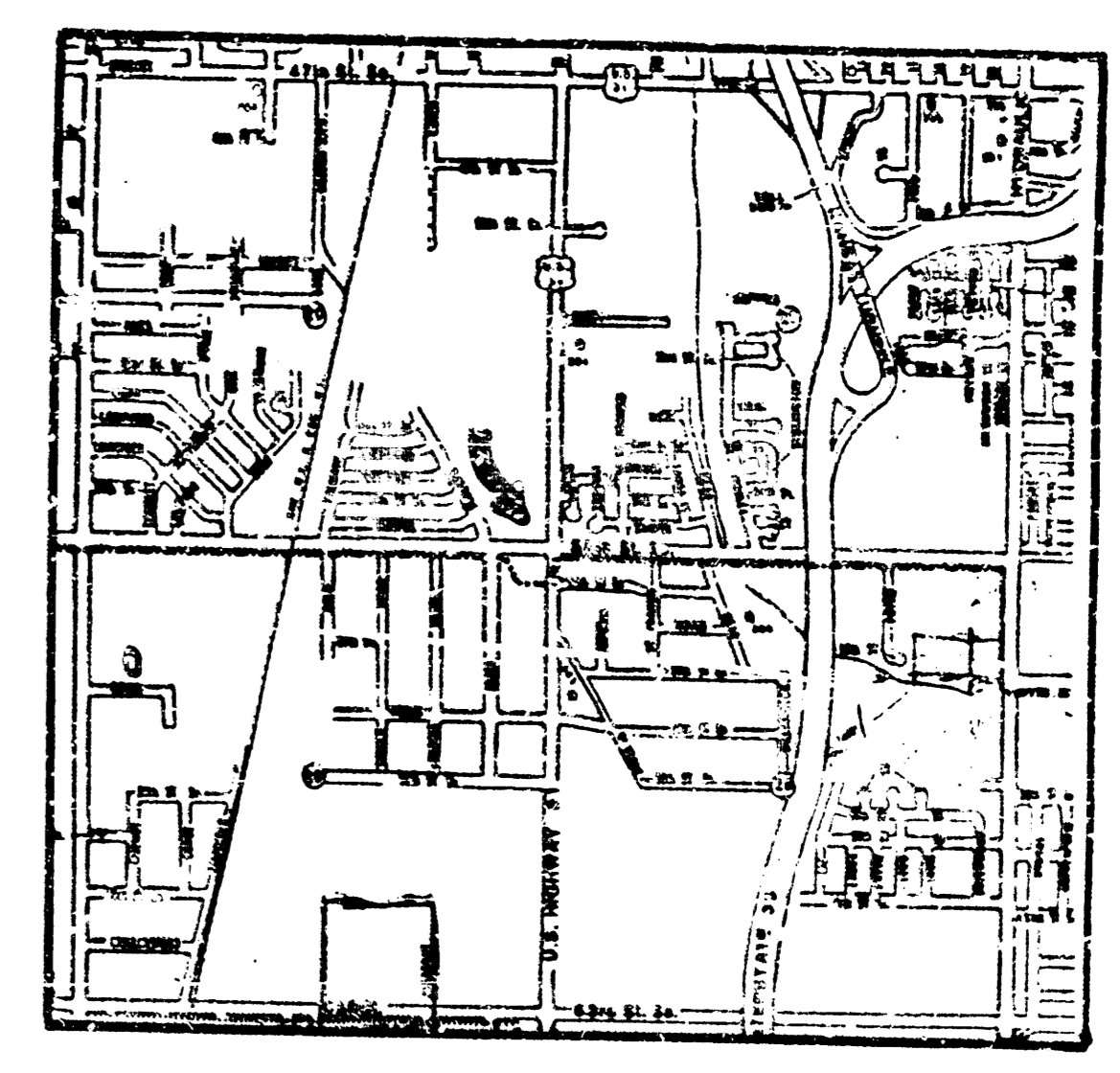
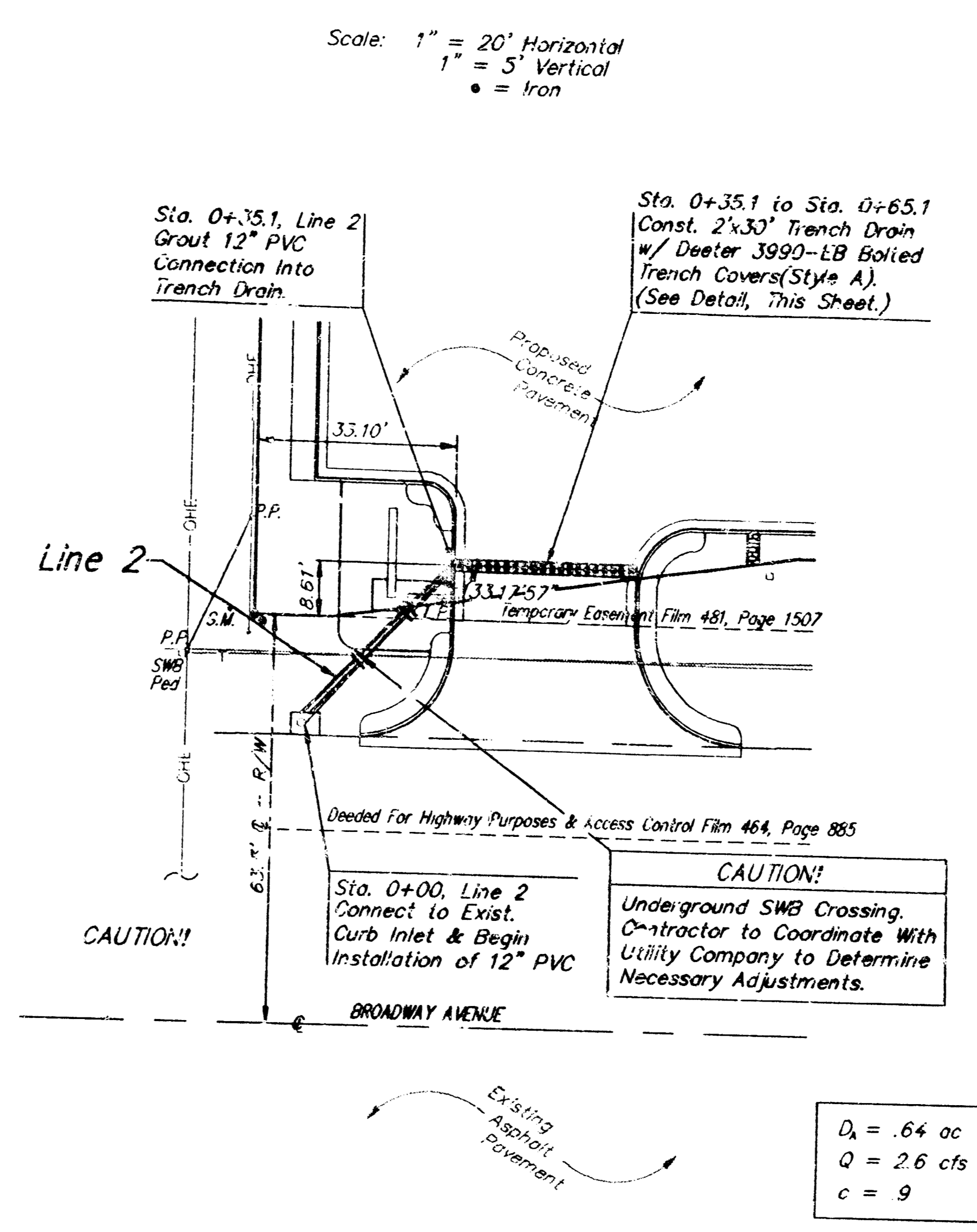

VICINITY MAP

GENERAL NOTES

- Contractor will be required to provide notice to utility companies a minimum of two (2) hours prior to any excavation as follows:
Kansas One-Call 687-2470
- Existing utilities and their locations as shown on the plans represent the best information obtainable for design. Location information has been obtained from the various utility companies and is either from company records or company field-provided locations. The Contractor will be required to work around existing utilities which do not conflict with proposed construction.
- The Contractor is to verify utility locations prior to construction for this project.
- Traffic affected by the construction of this project shall be handled in accordance with the latest edition of the Manual on Uniform Traffic Control Devices.
- All disturbed areas shall be seeded with Rebel II seed of the rate of 300 lbs. per acre. Fertilizer (13-13-13) shall be applied at the rate of 100 lbs. per acre.
- Lines 1 & 2 for this project are to be privately maintained.

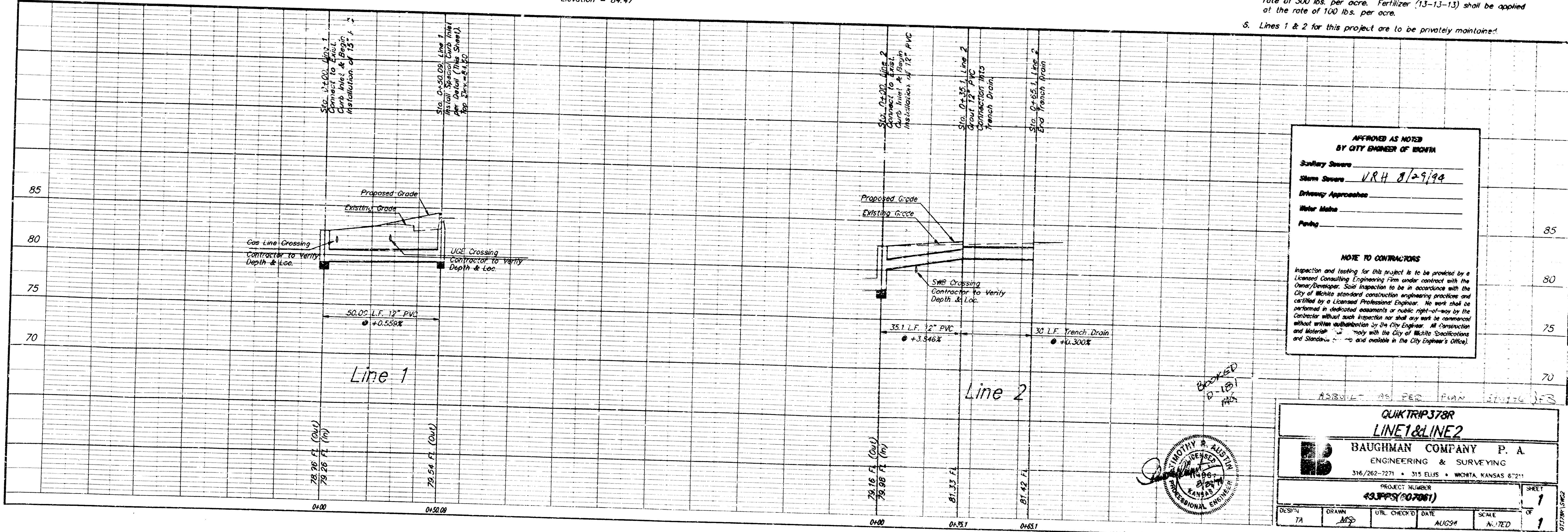

APPROVED AS NOTED
BY CITY ENGINEER OF WICHITA

Sanitary Sewer _____
Storm Sewer VRH 8/29/94
Driveway Approaches _____
Water Mains _____
Paving _____

NOTE TO CONTRACTORS
Inspection and testing for this project is to be provided by a Licensed Consulting Engineering Firm under contract with the Owner/Developer. Soil inspection to be in accordance with the City of Wichita standard construction engineering practices and City of Wichita Standard Specifications. No work shall be performed in dedicated easements or public right-of-way by the Contractor without such inspection nor shall any work be commenced without written authorization by the City Engineer. All construction shall comply with the City of Wichita Specifications and Standards and available in the City Engineer's Office.

ASBUILT AS PER PLAN SHEET 113

QUIKTRAP378R
LINE1&LINE2

BAUGHMAN COMPANY P. A.
ENGINEERING & SURVEYING
316/262-7271 • 315 ELLIS • WICHITA, KANSAS 67211

PROJECT NUMBER **431PPS(07061)**

DESIGN	DRAWN	UTL CHECK'D	DATE	SCALE
TA	MS		AUG94	AS NOTED

SHEET 1 OF 1