

SHEET NO.	TOTAL SHEETS
1	1

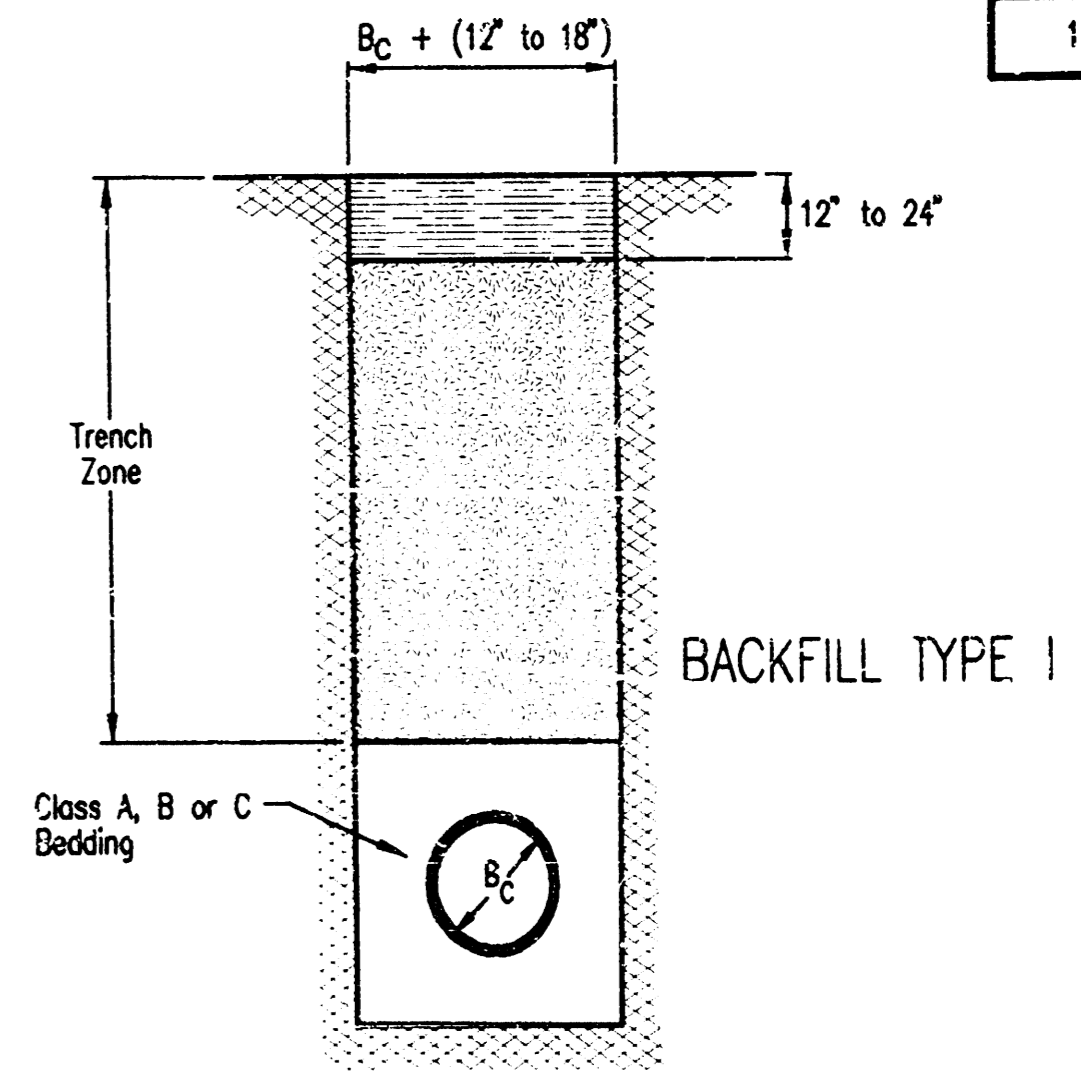
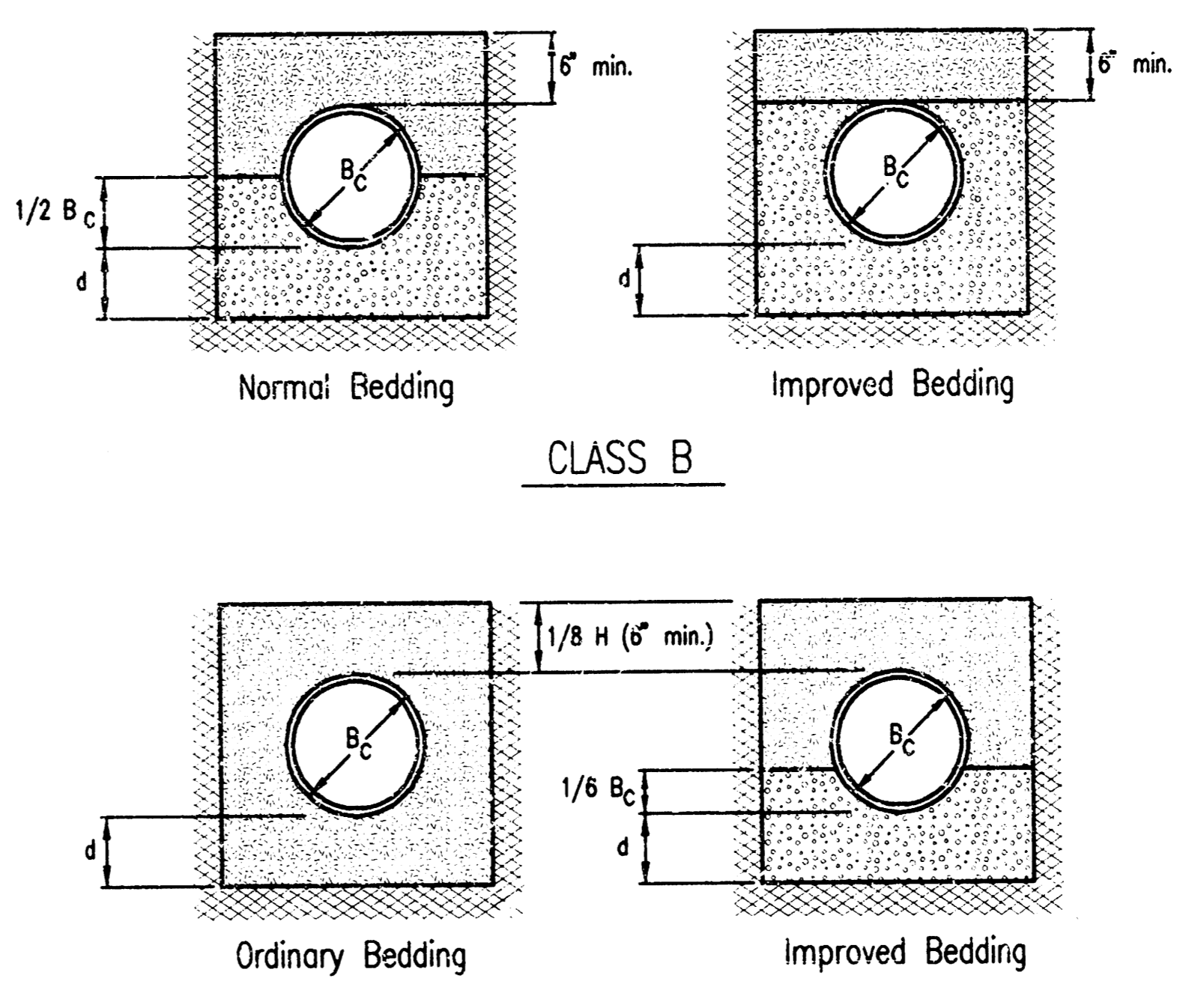
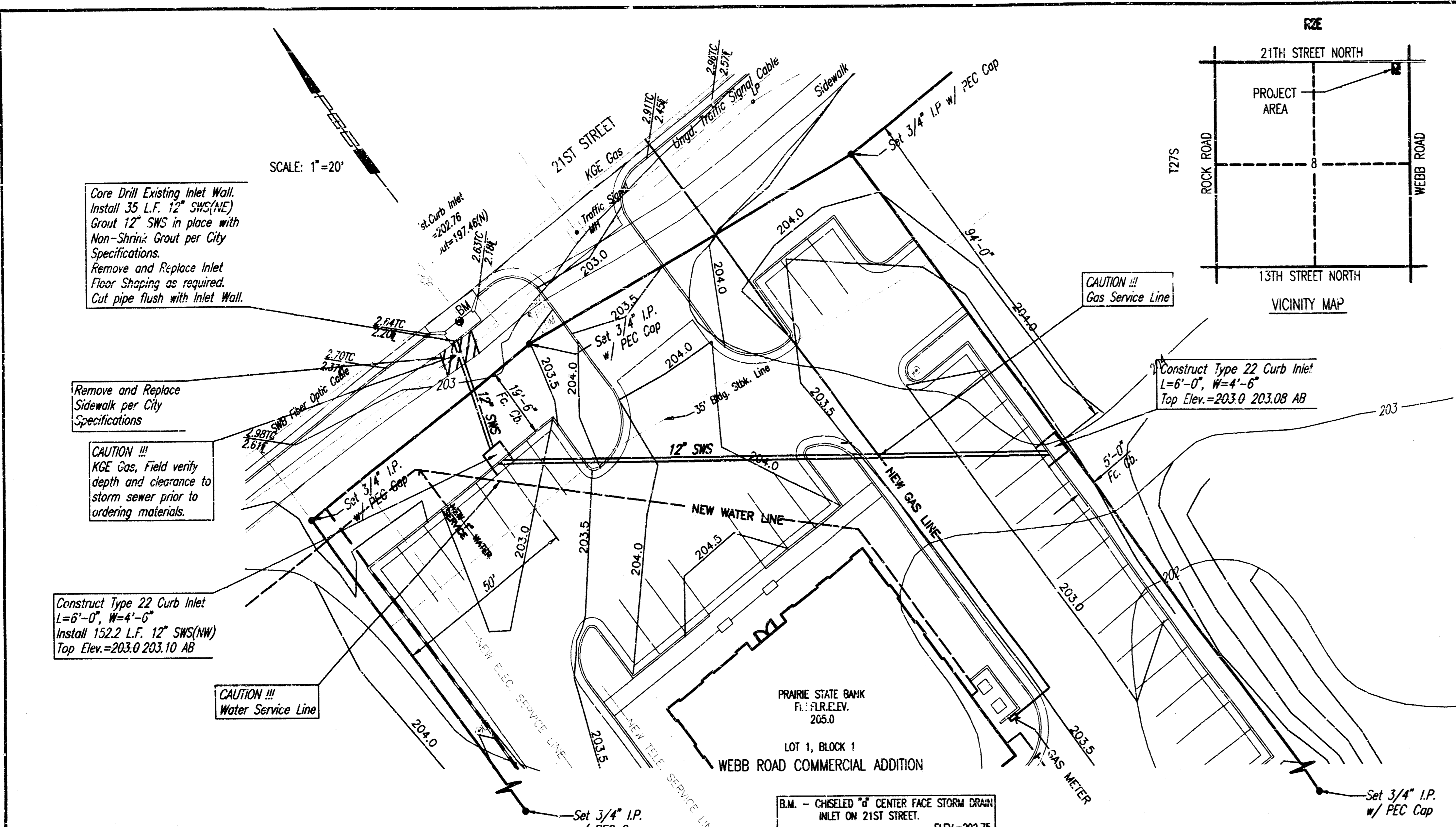

PIPE ZONE BACKFILLING

- B_c = Outside Pipe Diameter
- H = Backfill from Top of Pipe to Existing Ground
- D = Inside Pipe Diameter
- d = Depth of Bedding Material Below Pipe
- [Symbol] = Granular Bedding Material or Sand-Gravel Bedding
- [Symbol] = Compacted Embedment
- [Symbol] = Concrete

Depth of Bedding Material Below Pipe		
D	d(min) Soil	d(min) Rock
2" & smaller	4"	6"
3" to 6"	5"	9"
6" & larger	6"	12"

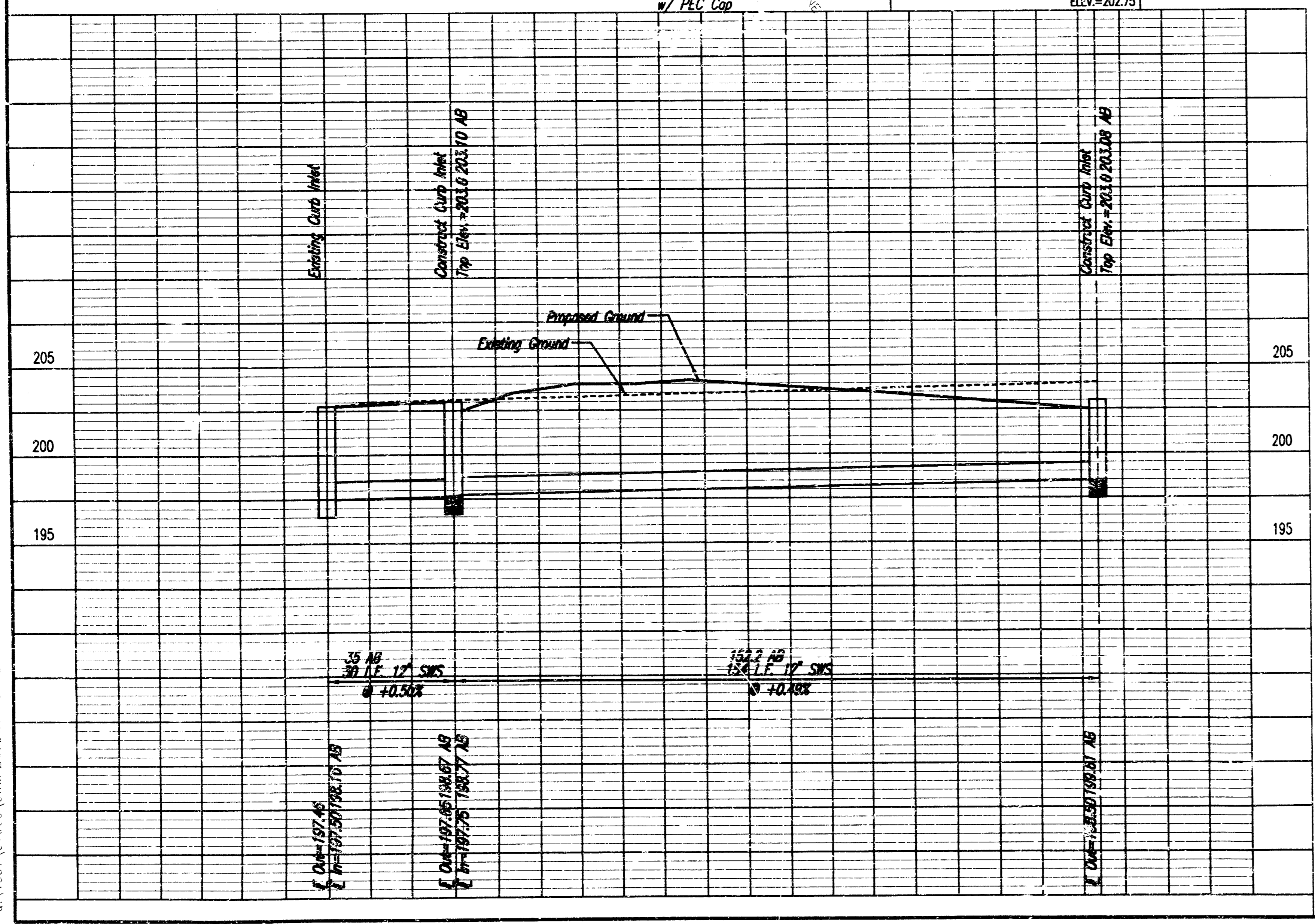

- GENERAL NOTES
- CONTRACTOR IS RESPONSIBLE FOR CONTACTING KANSAS ONE-CALL FOR LOCATION OF UNDERGROUND UTILITIES.
 - CONTRACTOR IS RESPONSIBLE FOR ALL FEES, BONDS, COORDINATION, ETC. AS REQUIRED BY THE CITY FOR WORK IN PUBLIC RIGHT-OF-WAY AND EASEMENTS.
 - CONTRACTOR IS RESPONSIBLE FOR FIELD STAKING OF LINES AND GRADES.
 - CONSTRUCTION MATERIALS AND METHODS TO CONFORM TO THE CITY OF WICHITA STANDARD SPECIFICATIONS.
 - CONTRACTOR SHALL COORDINATE WITH OTHER TRADES IN CONSTRUCTION OF UNDERGROUND FACILITIES ON SITE.
 - PAVING CONTRACTOR TO WARP GUTTER SECTION TO MATCH INLET.
 - PIPE MATERIALS TO BE RCP OR CMP PER CITY OF WICHITA STORM WATER SEWER SPECIFICATIONS, OR PVC PER CITY OF WICHITA SANITARY SEWER SPECIFICATIONS.
 - INLETS SHALL BE PRECAST AND SHALL CONFORM TO DETAILS FOR KDOT TYPE 22 CURB INLET, AS MANUFACTURED BY WICHITA CONCRETE PIPE, OR APPROVED EQUAL. INLET RING AND COVERS SHALL CONFORM TO KDOT TYPE 22 CURB INLET DETAILS.

NOTE TO CONTRACTOR

INSPECTION AND TESTING FOR THIS PROJECT IS TO BE PROVIDED BY A LICENSED CONSULTING ENGINEERING FIRM UNDER CONTRACT WITH THE OWNER/DEVELOPER. SAID INSPECTION TO BE IN ACCORDANCE WITH THE CITY OF WICHITA STANDARD CONSTRUCTION ENGINEERING PRACTICES AND CERTIFIED BY A LICENSED PROFESSIONAL ENGINEER. NO WORK SHALL BE PERFORMED IN DEDICATED EASEMENTS OR PUBLIC RIGHT-OF-WAY BY THE CONTRACTOR WITHOUT SUCH INSPECTION NOR SHALL ANY WORK BE COMMENCED IN DEDICATED EASEMENTS OR PUBLIC RIGHT-OF-WAY WITHOUT WRITTEN AUTHORIZATION BY THE CITY ENGINEER.

APPROVED AS NOTED
BY CITY ENGINEER OF WICHITA

- SANITARY SEWERS _____
- STORM SEWERS _____
- DRIVEWAY APPROACHES _____
- WATER MAINS _____
- PAVING _____

- B_c = Outside Pipe Diameter
- [Symbol] = Compacted Granular Backfill
- [Symbol] = Uncompacted Earth Backfill
- [Symbol] = Compacted Earth Backfill

Compacted Granular Backfill material shall be an approved sand material free from debris, organic material and stones with 100% passing the 3/4" sieve and not more than 15% passing a No. 200 sieve; to be jettied and mechanically vibrated into place and compacted to 90% density as determined by ASTM D698.

Uncompacted Earth Backfill material may be natural soil free from large clods or stones, brush, roots more than 2 inches in diameter, debris and junk. Flooding with water shall be provided as directed by the Engineer.

Compacted Earth Backfill shall consist of material existing prior to trenching or selected material as directed by the Engineer, and shall be compacted to 90% density as determined by ASTM D698.

Backfill: Backfill material and compaction requirements shall conform to either Type I, Type II or Type III as specified in the plans. One year maintenance will be required on all backfill.

Backfilling Under Pavement: Backfilling under existing or proposed pavement shall be performed as Backfill Type I to a level of two (2) feet from the bottom of the pavement. The remainder of the trench properly compacted in layers not exceeding six (6) inches in depth, compaction shall be performed with mechanical tampers and continued until a relative density of 100 percent of standard density, in conformance with ASTM D698 is attained.

BOOKED
3-10-98
MCG
D-385

AS BUILT
3/6/97

DATE	INITIALS	REVISION
MARCH 1997	TJT	AS BUILT (AND KANSAS ENGINEERING CONS. INC.)
LOT 1, BLOCK 1 WEBB ROAD COMMERCIAL ADDITION		
PRIVATE STORM WATER SEWER		
CITY OF WICHITA PRIVATE PROJECT NO. 683P/S (607861)		
PROFESSIONAL ENGINEERING CONSULTANTS, P.A.		
WICHITA, KANSAS		
Designed by	MWB	Checked by
Drawn by	DEP	Date
		JAN., 1997
		Job No. 97060

DSNR: MBE OPER. DUP. SCALE: 1"=20'
 C:\1997\9\060\SWPLAN\DWG 01-27-1997 10:46:22 am