

STORMWATER SYSTEM EXTENSION & REMOVAL OF SANITARY SEWER
 LOTS 1, 2, 3, 8, 9 & 10, PAWNEE ADDITION
 CITY OF WICHITA
 MICHAEL E. LINDEBAK, P.E. : CITY ENGINEER
 PRIVATE PROJECT NO.: 660PPS (607861)

PROPOSED SITE IMPROVEMENTS PROVIDED BY:

AutoZone
 STORE DEVELOPMENT PHONE (901) 495-8719
 60 MADISON AVENUE MEMPHIS, TENNESSEE 38103 FAX (901) 495-8901

TOPOGRAPHIC & BOUNDARY SURVEY PERFORMED BY:
COOK, FLATT & STROBEL

SEE SURVEY FOR COMPLETE LEGAL DESCRIPTION INFORMATION.

BENCHMARK

BRASS DISK IN RAILROAD SIGNAL BASE
 200 ± EAST OF HYDRAULIC AND 25' ± SOUTH OF PAWNEE. ELEV. 100.45

ELEVATION DATUM SHOWN IS CITY OF WICHITA UATUM.
 ELEVATIONS SHOWN PLUS 1187.4 = SEA LEVEL DATUM.

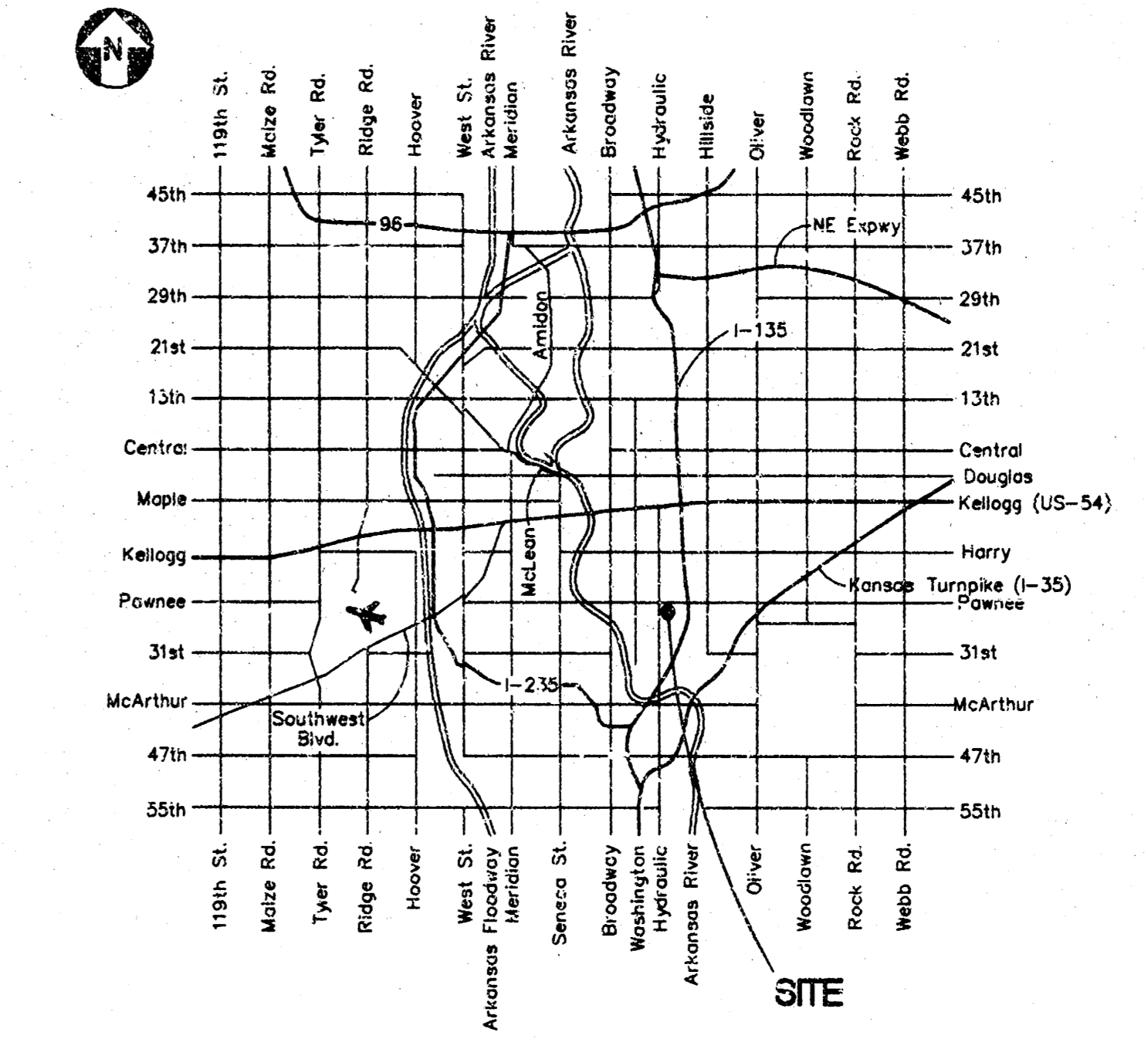

LOCATION MAP
 NOT TO SCALE

SANITARY SEWER ONLY.
 INSPECTOR: LYLE POWERS, BAUGHMAN CO.
 AS BUILT: 2/10/97 JEFF BRADLEY, BAUGHMAN CO.
 APPROVED AS NOTED

*Booked San. Sew.
 4-17-97
 JKB
 From As Bults*

By CITY ENGINEER OF WICHITA
 Sanitary Sewers VRH 11/12/96
 Storm Sewers VRH 11/12/96
 Driveway Approaches _____
 Water Mains _____
 Paving _____

NOTE TO CONTRACTOR

INSPECTION AND TESTING FOR THIS PROJECT IS TO BE PROVIDED BY A LICENSED CONSULTING ENGINEERING FIRM UNDER CONTRACT WITH THE OWNER/DEVELOPER. SAID INSPECTION TO BE IN ACCORDANCE WITH THE CITY OF WICHITA STANDARD CONSTRUCTION ENGINEERING PRACTICES AND CERTIFIED BY A LICENSED PROFESSIONAL ENGINEER. NO WORK SHALL BE PERFORMED IN DEDICATED EASEMENTS OR THE PUBLIC RIGHT-OF-WAY BY THE CONTRACTOR WITHOUT SUCH INSPECTION NOR SHALL ANY WORK BE COMMENCED IN DEDICATED EASEMENTS OR PUBLIC RIGHT-OF-WAY WITHOUT WRITTEN AUTHORIZATION BY THE CITY ENGINEER.

REVISIONS	BY

SWS EXTENSION & REMOVAL OF SANITARY SEWER
 FOR
AUTOZONE
 PAWNEE AVENUE
 WICHITA, KANSAS

PRIVATE PROJECT
Palmerton & Parrish, Inc.
 2835 - K East Division
 Springfield, MO 65803
 (417) 864-0000



JOB NO.	DATE
069825	10/30/96
DRAWN	CHECKED
KRB	BRP
SCALE	AS SHOWN

DRAWING NO.
 69825PPR
C1.1A

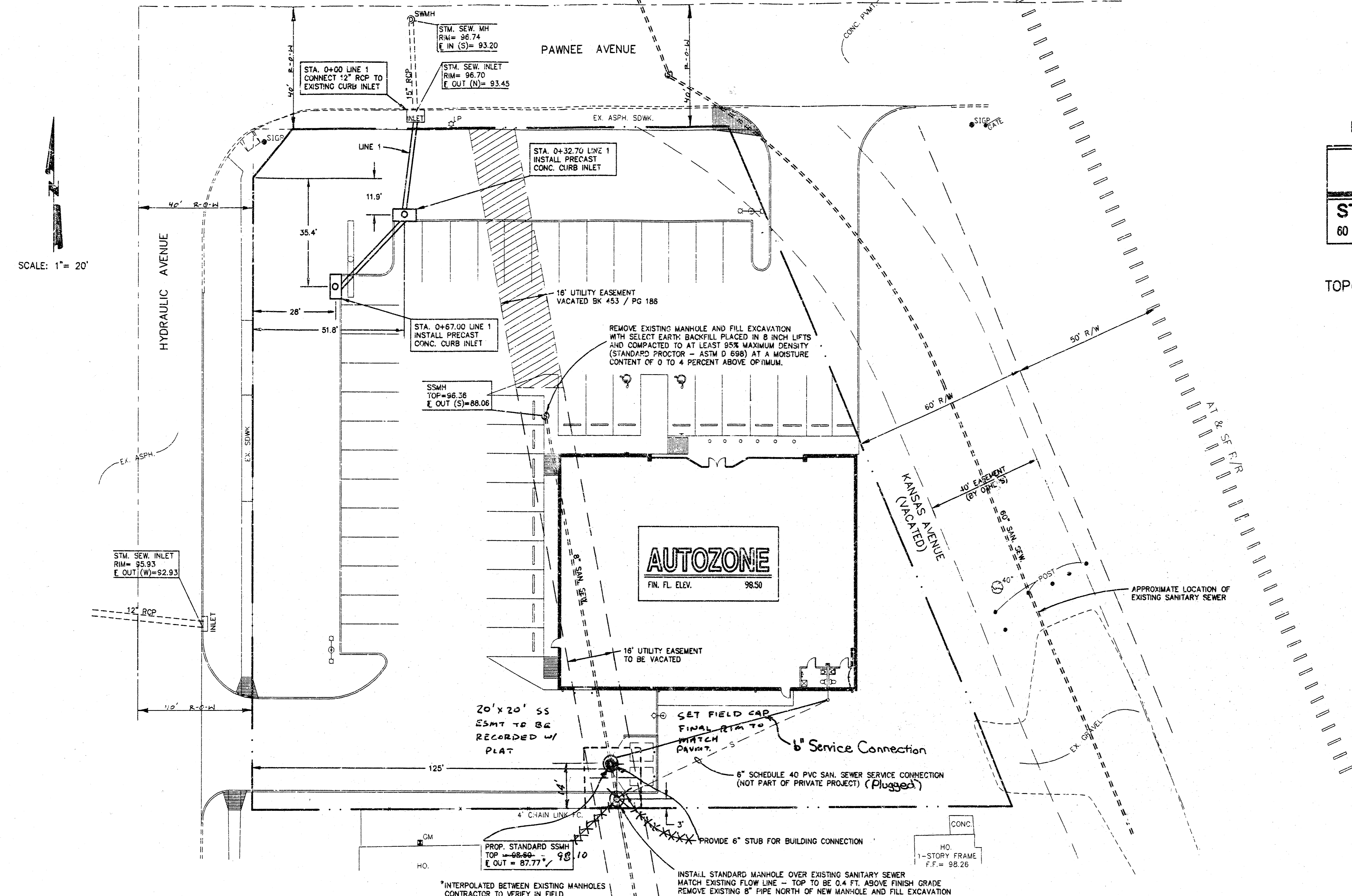

SCALE: 1" = 20'

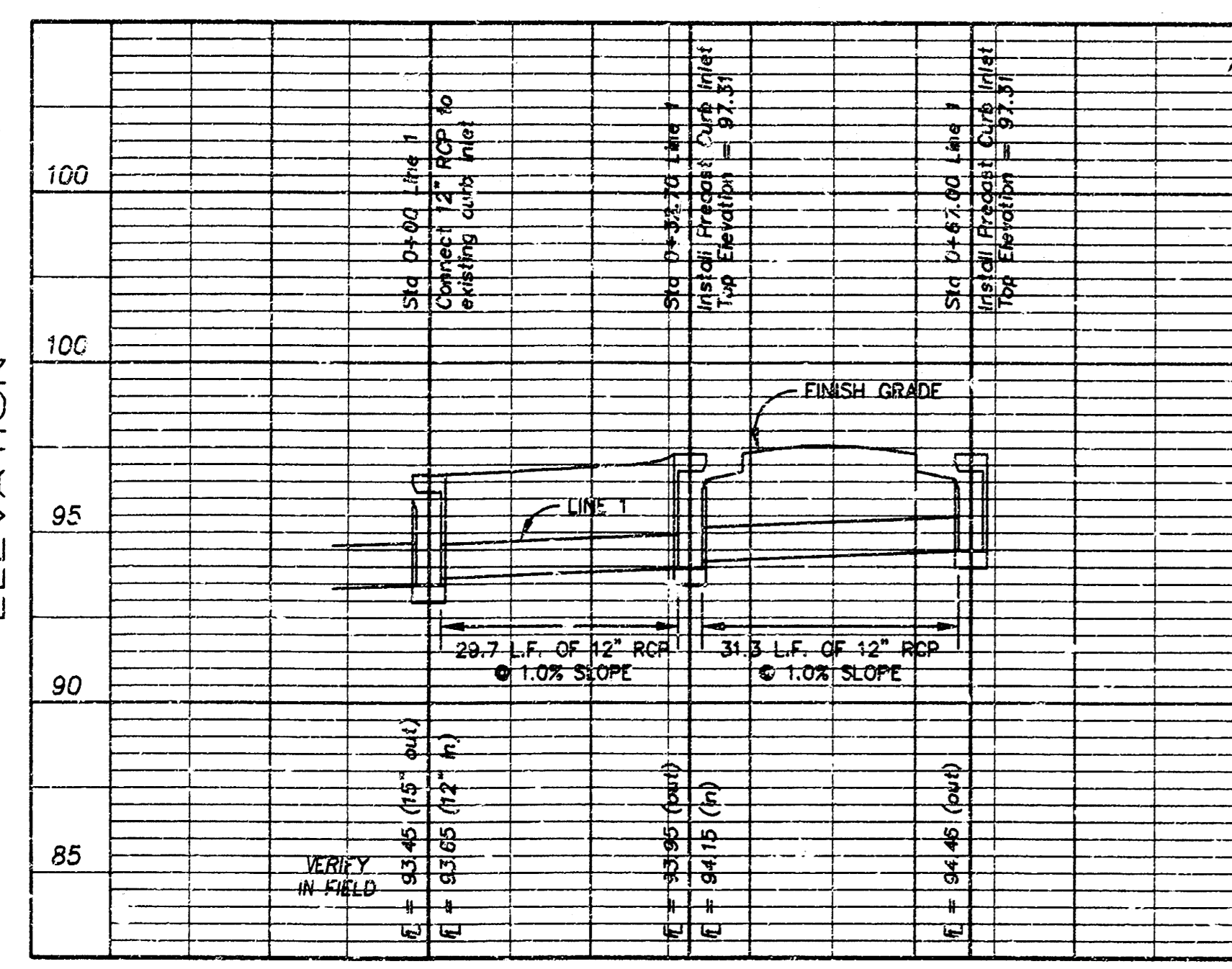

DRAINAGE PROFILE
 HOR. SCALE: 1" = 20'
 VER. SCALE: 1" = 5'

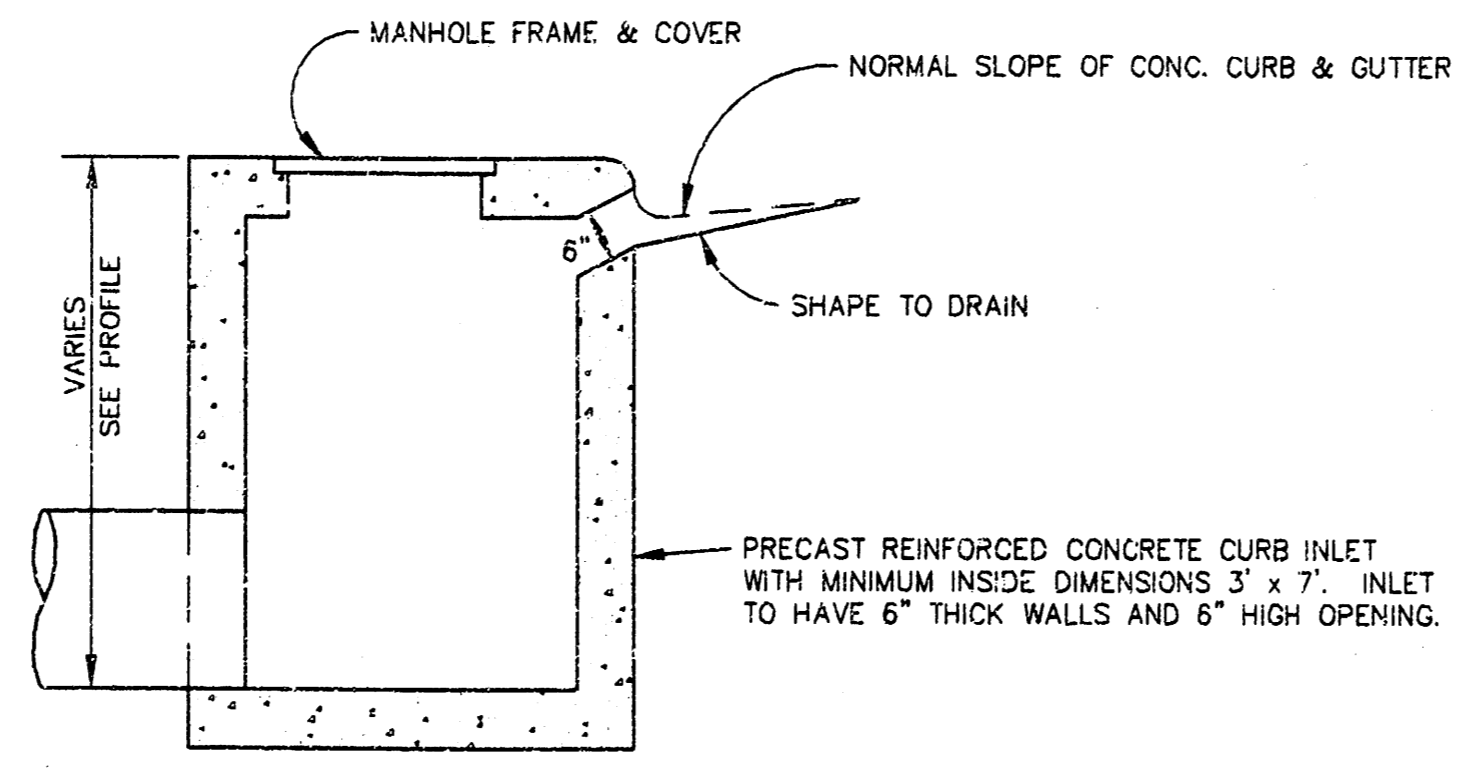

CURB INLET DETAIL
 NTS

SELECT EARTH FILL SHALL CONSIST OF CLAYEY SAND, CLAYEY GRAVEL OR SANDY CLAY CLASSIFYING AS SC, GC OR CL IN ACCORDANCE WITH THE USCS OR INORGANIC LOW PLASTICITY LEAN CLAY CONTAINING AN APPRECIABLE PERCENTAGE OF GRAVEL OR ROCK FRAGMENTS ALSO CLASSIFYING AS CL OR WELL GRADED CRUSHED STONE. USE OF SHALE AND SHALEY CLAY FILL IS PROHIBITED UNLESS PREAPPROVED BY THE GEOTECHNICAL ENGINEER.

FIELD DENSITY AND MOISTURE RELATIONSHIP TESTS SHALL BE PERFORMED TO INSURE COMPLIANCE WITH PROJECT SPECIFICATIONS. THE MINIMUM TESTING FREQUENCY SHALL BE ONE FIELD DENSITY TEST FOR EACH 2500 SQ. FT. OF FILL LIFT BUT NO LESS THAN THREE TESTS PER LIFT.

GENERAL CONSTRUCTION NOTES

- CONSTRUCTION METHODS, CONSTRUCTION MATERIALS AND TESTING PROCEDURES SHALL CONFORM TO THE CITY OF WICHITA'S TECHNICAL SPECIFICATIONS FOR PUBLIC IMPROVEMENTS.
- THE CONTRACTOR SHALL PROVIDE PERFORMANCE AND MAINTENANCE BONDS AS REQUIRED BY THE CITY OF WICHITA.
- THE CONTRACTOR SHALL SECURE THE SERVICES OF AN ENGINEERING FIRM TO PROVIDE CONSTRUCTION STAKING AND INSPECTION AND VACUUM TESTING OF THE COMPLETED SEWER SYSTEM.
- THE CONTRACTOR SHALL VERIFY LOCATION AND ELEVATION OF THE EXISTING SANITARY SEWER MAIN PRIOR TO BEGINNING CONSTRUCTION.
- THE CONTRACTOR SHALL BE RESPONSIBLE FOR ANY DAMAGE AND SUBSEQUENT REPAIR OF UNDERGROUND UTILITIES OR PERTINENT OBSTRUCTIONS DURING THE COURSE OF HIS OR HER OPERATIONS ON THE CONSTRUCTION SITE OR THE IMMEDIATE AREA. CALL KANSAS ONE-CALL (1-800-344-7233) PRIOR TO BEGINNING CONSTRUCTION.
- ALL DISTURBED UNPAVED AREAS SHALL BE SEEDED AND MULCHED.
- LINE 1 FOR THIS PROJECT IS TO BE PRIVATELY MAINTAINED.

17-5-10

SCALE: 1" = 20'

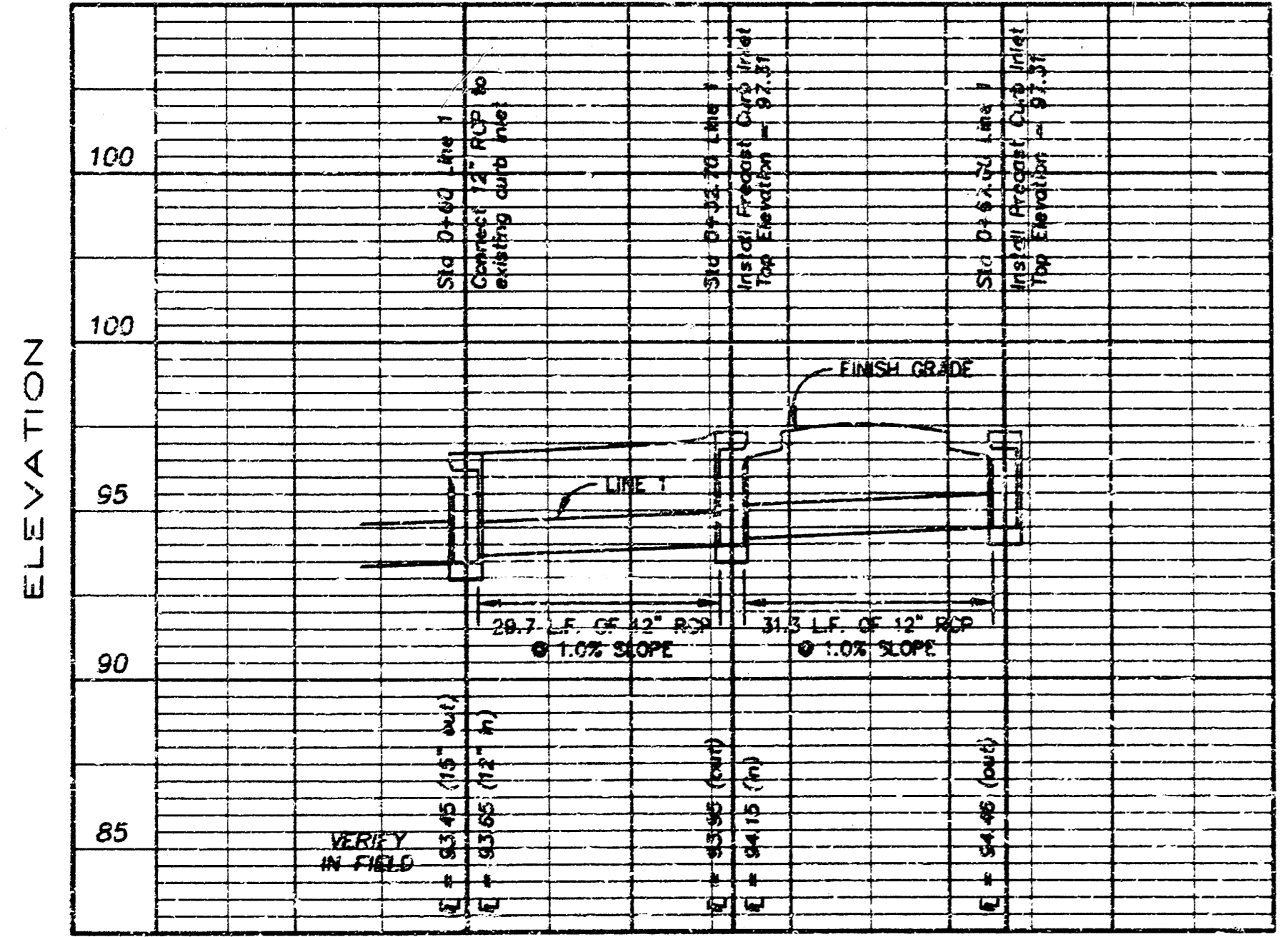
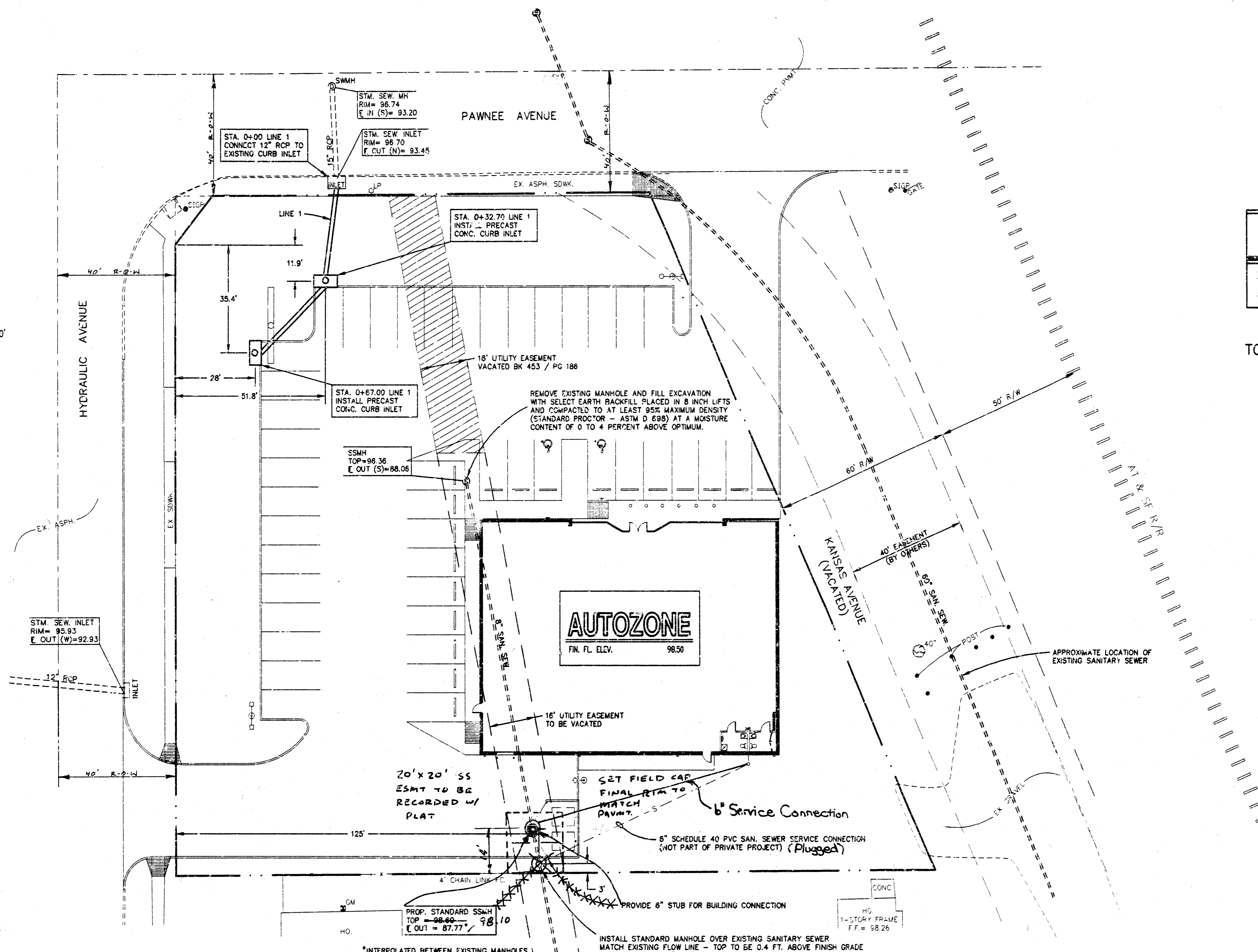

DRAINAGE PROFILE
HOR. SCALE: 1" = 20'
VERT. SCALE: 1" = 5'

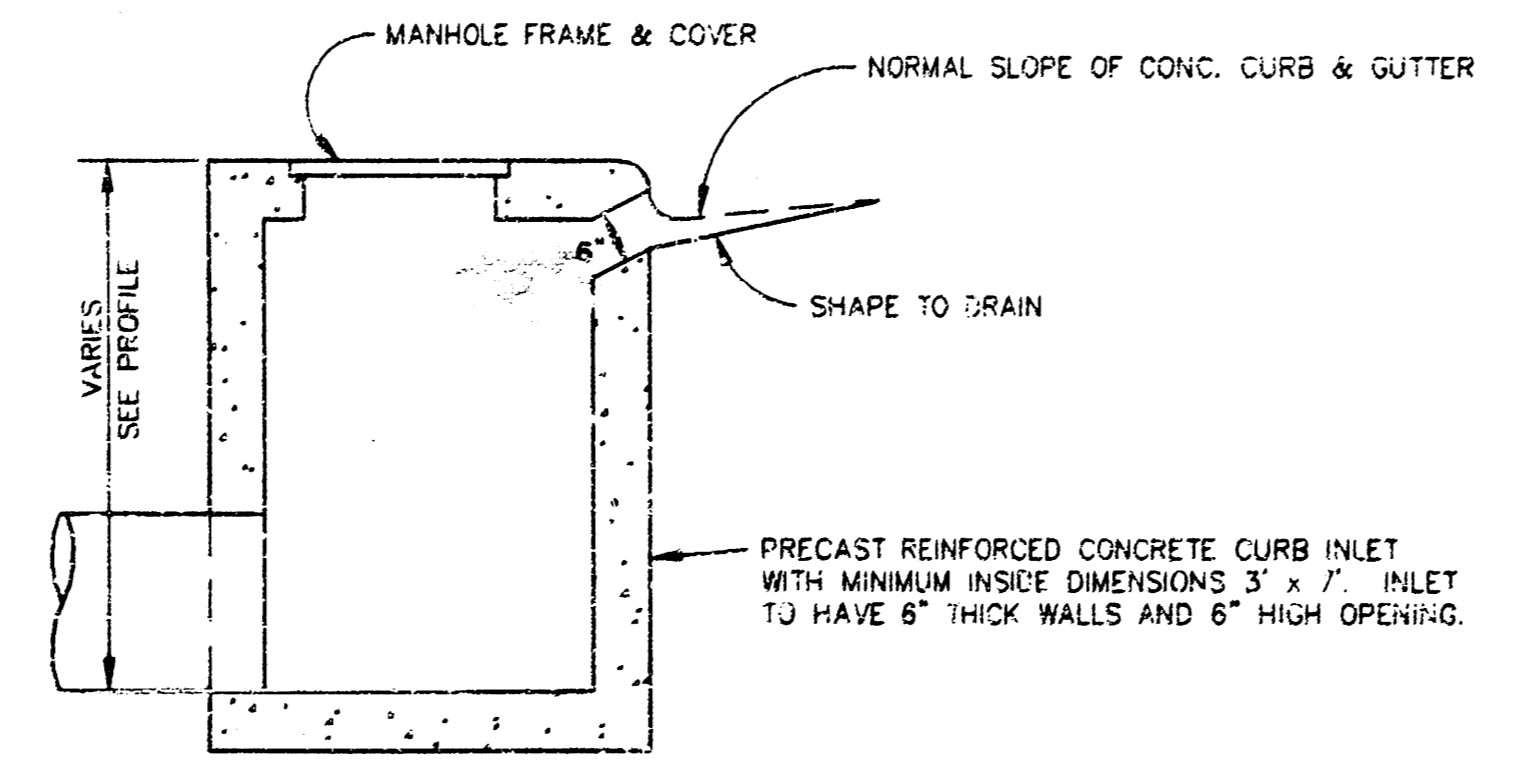

CURB INLET DETAIL
NTS

SELECT EARTH FILL SHALL CONSIST OF CLAYEY SAND, CLAYEY GRAVEL OR SANDY CLAY CLASSIFYING AS SC, GC OR CL IN ACCORDANCE WITH THE USES OF INORGANIC LOW PLASTICITY LEAN CLAY CONTAINING AN APPRECIABLE PERCENTAGE OF GRAVEL OR ROCK FRAGMENTS ALSO CLASSIFYING AS CL OR WELL GRADED CRUSHED STONE. USE OF SHALE AND SHALEY CLAY FILL IS PROHIBITED UNLESS PREAPPROVED BY THE GEOTECHNICAL ENGINEER.

FIELD DENSITY AND MOISTURE RELATIONSHIP TESTS SHALL BE PERFORMED TO INSURE COMPLIANCE WITH PROJECT SPECIFICATIONS. THE MINIMUM TESTING FREQUENCY SHALL BE ONE FIELD DENSITY TEST FOR EACH 2500 SQ. FT. OF FILL LIFT BUT NO LESS THAN THREE TESTS PER LIFT.

GENERAL CONSTRUCTION NOTES

- CONSTRUCTION METHODS, CONSTRUCTION MATERIALS AND TESTING PROCEDURES SHALL CONFORM TO THE CITY OF WICHITA'S TECHNICAL SPECIFICATIONS FOR PUBLIC IMPROVEMENTS.
- THE CONTRACTOR SHALL PROVIDE PERFORMANCE AND MAINTENANCE BONDS AS REQUIRED BY THE CITY OF WICHITA.
- THE CONTRACTOR SHALL SECURE THE SERVICES OF AN ENGINEERING FIRM TO PROVIDE CONSTRUCTION STAKING AND INSPECTION AND VACUUM TESTING OF THE COMPLETED SEWER SYSTEM.
- THE CONTRACTOR SHALL VERIFY LOCATION AND ELEVATION OF THE EXISTING SANITARY SEWER MAIN PRIOR TO BEGINNING CONSTRUCTION.
- THE CONTRACTOR SHALL BE RESPONSIBLE FOR ANY DAMAGE AND SUBSEQUENT REPAIR OF UNDERGROUND UTILITIES OR PERTINENT OBSTRUCTIONS DURING THE COURSE OF HIS OR HER OPERATIONS ON THE CONSTRUCTION SITE OR THE IMMEDIATE AREA. CALL KANSAS ONE-CALL (1-800-344-7233) PRIOR TO BEGINNING CONSTRUCTION.
- ALL DISTURBED UNPAVED AREAS SHALL BE SEEDED AND MULCHED.
- LINE 1 FOR THIS PROJECT IS TO BE PRIVATELY MAINTAINED.

STORMWATER SYSTEM EXTENSION & REMOVAL OF SANITARY SEWER
LOTS 1, 2, 3, 8, 9 & 10, PAWNEE ADDITION
CITY OF WICHITA
MICHAEL E. LINDEBAK, P.E. : CITY ENGINEER
PRIVATE PROJECT NO.: 660PPS (607861)

PROPOSED SITE IMPROVEMENTS PROVIDED BY:

STORE DEVELOPMENT PHONE (901) 495-8719
60 MADISON AVENUE MEMPHIS, TENNESSEE 38103 FAX (901) 495-8901

TOPOGRAPHIC & BOUNDARY SURVEY PERFORMED BY:
COOK, FLATT & STROBEL

SEE SURVEY FOR COMPLETE LEGAL DESCRIPTION INFORMATION.

BENCHMARK

BRASS C/SK IN RAILROAD SIGNAL BASE
200'± EAST OF HYDRAULIC AND 25'± SOUTH OF PAWNEE. ELEV. 100.45

ELEVATION DATUM SHOWN IS CITY OF WICHITA DATUM, ELEVATIONS SHOWN PLUS 1197.4 = SEA LEVEL DATUM.

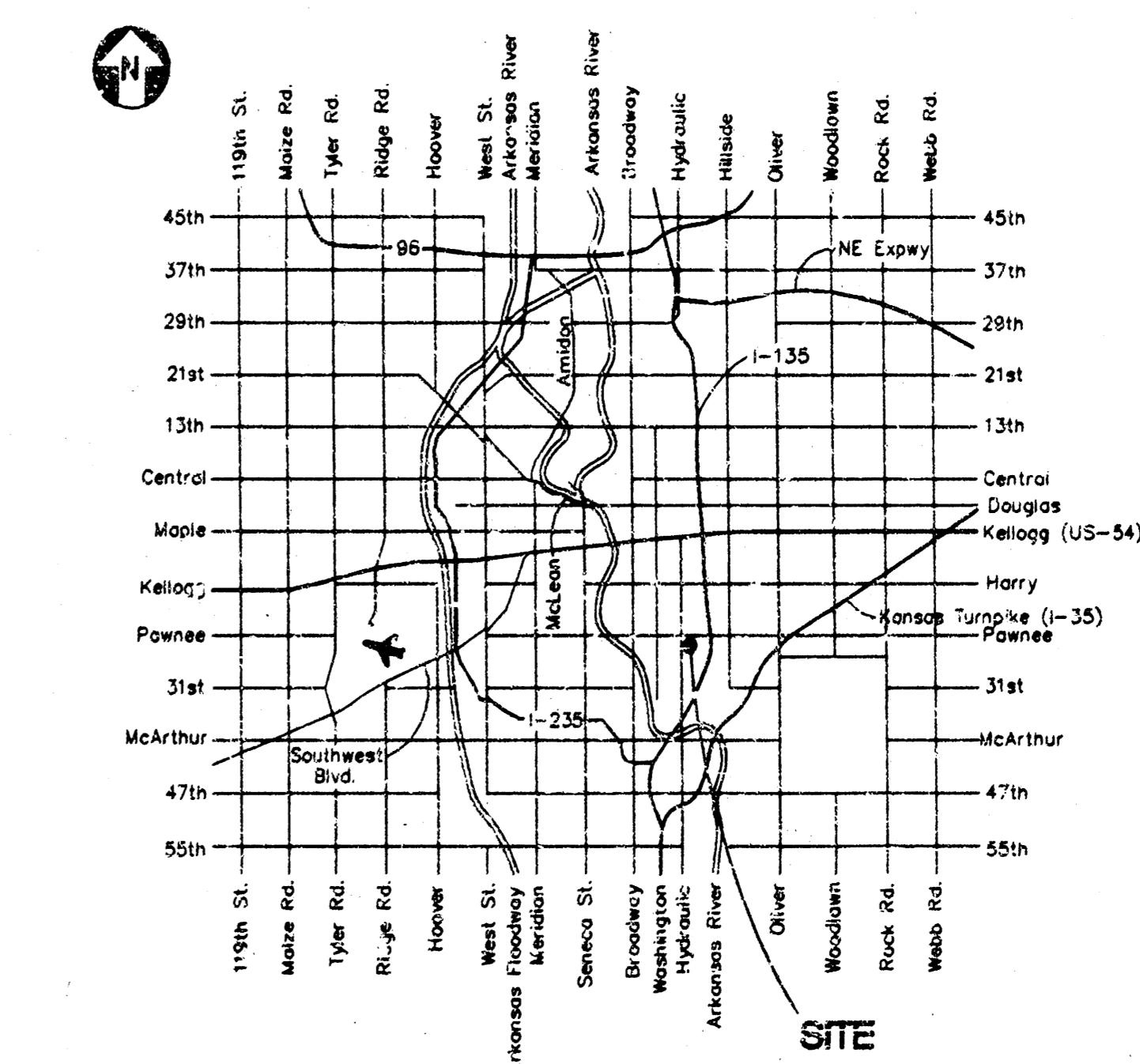

LOCATION MAP
NOT TO SCALE

SANITARY SEWER ONLY.
INSPECTOR: LYLE POWERS, BAUGHMAN CO.
ASBUILT: 2/10/97 JEFF BRADLEY, BAUGHMAN CO.
APPROVED AS NOTED

*Booked San Sew
4-17-97
JKB
From His Boils*

By CITY ENGINEER OF WICHITA
Sanitary Sewers VRH 11/1-196
Storm Sewers VRH 11/2-196
Driveway Approaches _____
Water Mains _____
Paving _____

NOTE TO CONTRACTOR

INSPECTION AND TESTING FOR THIS PROJECT IS TO BE PROVIDED BY A LICENSED CONSULTING ENGINEERING FIRM UNDER CONTRACT WITH THE OWNER/DEVELOPER. SAID INSPECTION TO BE IN ACCORDANCE WITH THE CITY OF WICHITA STANDARD CONSTRUCTION ENGINEERING PRACTICES AND CERTIFIED BY A LICENSED PROFESSIONAL ENGINEER. NO WORK SHALL BE PERFORMED IN DEDICATED EASEMENTS OR THE PUBLIC RIGHT-OF-WAY BY THE CONTRACTOR WITHOUT SUCH INSPECTION, NOR SHALL ANY WORK BE COMMENCED IN DEDICATED EASEMENTS OR PUBLIC RIGHT-OF-WAY WITHOUT WRITTEN AUTHORIZATION BY THE CITY ENGINEER.

REVISIONS	BY

SWS EXTENSION & REMOVAL OF SANITARY SEWER FOR
AUTOZONE
PAWNEE AVENUE
WICHITA, KANSAS

PRIVATE PROJECT
Palmerton & Parrish, Inc.
2836 - K East Division
Springfield, MO 65803
(417) 864-6000

3416 East 13th Street
Joplin, MO 64801
(417) 624-2005



JOB NO.	DATE
069825	12/30/96
DRAWN	CHECKED
KRB	BRP
SCALE	AS SHOWN
DRAWING NO.	69825PPR

C1.1A