

Wichita-Sedgwick County
Metropolitan Area Building
and Construction Department

REVIEWED FOR CODE COMPLIANCE

CORRECTIONS OR COMMENTS MADE ON THESE DRAWINGS AND THIS DOCUMENT BEING THIS REVIEW DO NOT RELIEVE CONTRACTOR FROM COMPLIANCE WITH ALL REQUIREMENTS OF THE CODE OF THE MANOR, THE CITY OF WICHITA OR SEDGWICK COUNTY. THIS REVIEW IS ONLY FOR GENERAL CONFORMANCE OF THE CODE. THE CONTRACTOR IS RESPONSIBLE FOR CONFORMING AND CORRECTING ALL TECHNICALS OF CONSTRUCTION. THIS APPROVAL IS SUBJECT TO PROVISIONS OF SECTION 10-4 OF THE INTERNATIONAL BUILDING CODE.

DATE: 11/5/2025 BY: Keri Jacobs

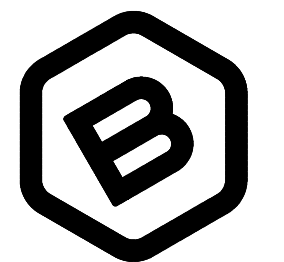

**BAUGHMAN
COMPANY**

315 Ellis St.
Wichita, KS 67211
316-262-7271
BaughmanCo.com

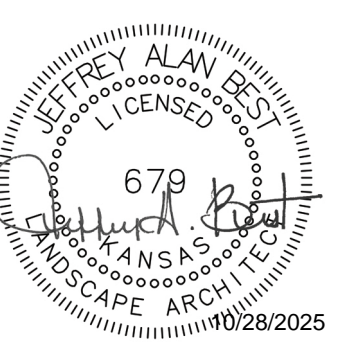

CITY OF WICHITA
CLAPP PARK PARKING LOT IMPROVEMENT PROJECT
4611 E. Harry, Wichita, KS, 67218
PROJ. NO: 482-11093

REVISION: DATE:

PROJECT NUMBER:
25-07-E173

DESIGN: JAB DRAWN: JAB

DATE: 10/28/2025

**LANDSCAPE
PLAN**

SHEET **7** OF **7**

File: E:\Projects\County Areas 2nd Lot 4\Bk 5_23-08-E572\Engineering

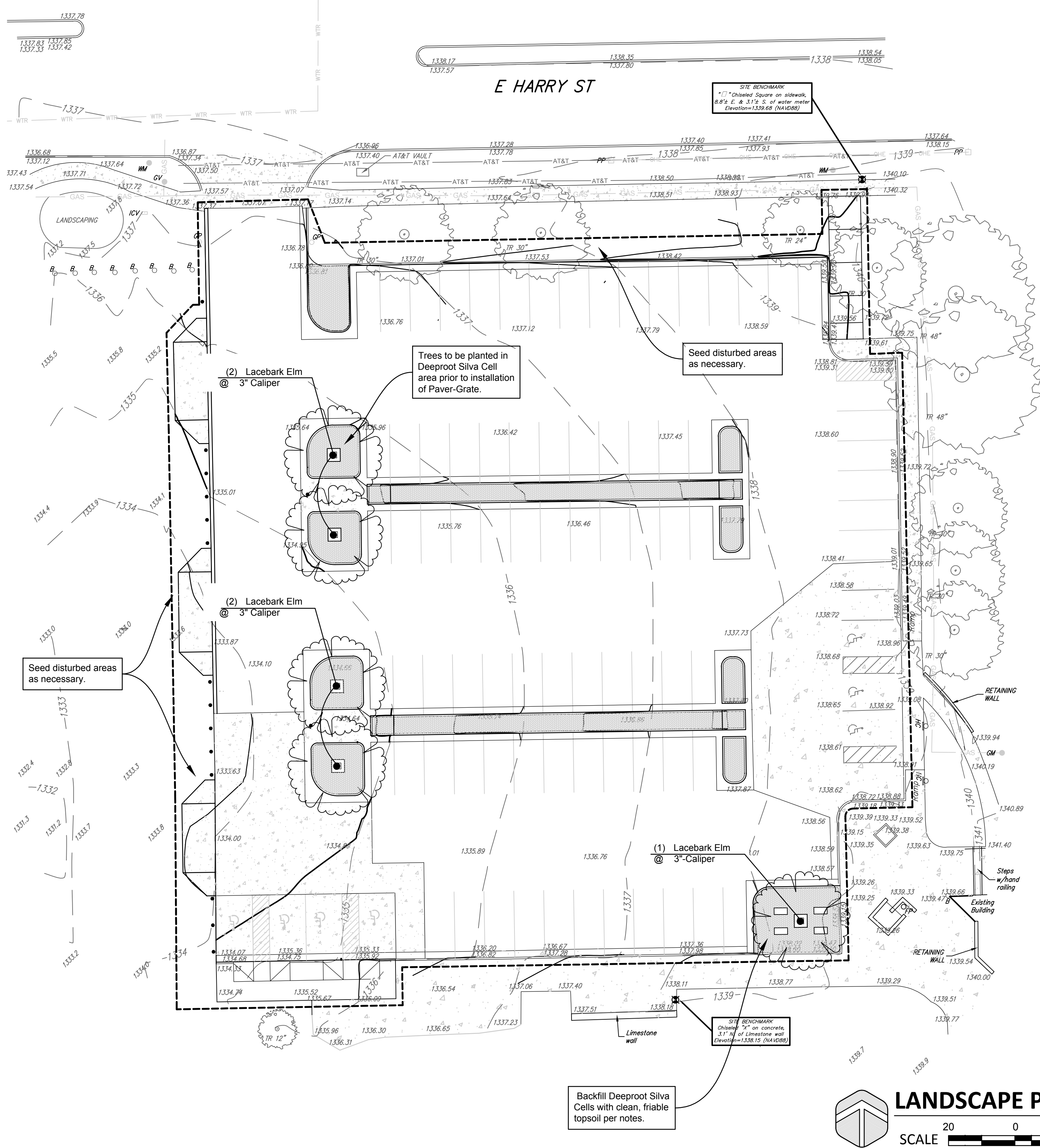

LEGAL DESCRIPTION

N 65A E1/2 NE1/4 EXC SEWER CC A-35290 & EXC CC A-43699 FOR OLIVER ST.
& EXC N 50 FT FOR ST. SEC 35-27-1E EXEMPT 609-1

SITE INFORMATION

Total Project Area:	±48,500 sq. ft. (1.11 acres)
Disturbed Area:	±11,150 sq. ft. (0.26 acres)
Impervious Area, pre-const:	±43,917 sq. ft. (1.01 acres)
Impervious Area, post-const:	±45,350 sq. ft. (1.04 acres)

BENCHMARKS

- Site Benchmark - 1
"□" chiseled square on sidewalk, 8.8' East & 3.1' South of water meter
Elevation = 1339.68 (NAVD 88)
- Site Benchmark - 2
"X" chiseled "X" on concrete 3.1' North of Limestone Wall.
Elevation = 1338.15 (NAVD 88)

KANSAS ONE CALL

Contractor shall be required to provide notice to Kansas One Call at 287-2470 a minimum of three (3) working days prior to any excavation or work adjacent to utilities.

Kansas One Call 1-800-DIG-SAFE

UTILITY CONTACTS

The Contractor must notify the following in case of an emergency:

Kansas Gas Service (Gas).....	1-888-482-4950
Black Hills Energy (Gas).....	1-800-303-0357
Everg (Electric).....	383-8650
Cox Communications (Telecommunication).....	262-4270
AT&T (Telecommunication).....	268-2759
City of Wichita Water Dept. (Water).....	268-4563
	or 268-4908
City of Wichita Sewer Maint. (San. Sewer).....	268-4024
	or 262-6000
City of Wichita Storm Sewer Maint. (Storm Sewer).....	268-4090
City of Wichita Traffic Maint. (Traf. Control).....	268-4034
	or 268-4203
Conoco Pipeline Co. (Petroleum).....	1-800-231-2551
Williams Pipeline Co. (Petroleum).....	529-6600
	or 1-800-324-9696
Phillips Pipeline Co. (Petroleum).....	1-800-766-8230

LANDSCAPE NOTES

- All landscape work shall be done in accordance with industry standards.
- All areas called out as seeded shall be seeded at 2.5 to 3 lbs per 1,000 sq ft and fertilized at 40 lbs per acre.
- Trees with broken leaders or no central leader will not be accepted.
- All planting beds shall be prepared by killing all existing vegetation with Round-Up (or equal) according to label directions. A Pre-emergent herbicide such as Treflan (5%) (or equal) shall be applied per label directions. All planting beds to receive 2" organic matter (such as cotton bur mulch, compost, or humus) and shall be rototilled in to a depth of 10-12".
- Mulch all planting beds with min. 3" of mulch. Mulch all tree saucer wells with min. 3" of mulch. Mulch material to be premium cedar mulch of uniform consistency.
- Metal edging shall be used to separate all turf areas from planting beds. Edging shall be 10 gauge thickness, commercial grade, or approved equal.
- General Contractor to supply and place at a depth of 4", all topsoil on site within the limits of Construction unless otherwise specified on the plans.
- Topsoil hauled onto site shall be fertile, friable, natural loam topsoil, of uniform quality characteristic of representative local soils which produce heavy growth of crops, grass, or other vegetation. It shall be free of trash, or other matter toxic to plant growth.
- Topsoil shall have no less than 3% organics, soluble salts shall not exceed 500ppm, and the pH shall fall in the range of 5.5 and 7.4.
- Topsoil shall be delivered in an unfrozen and non-muddy condition and shall be subject to approval by the Landscape Architect.
- Prior to any excavation for landscaping purposes the location of underground utilities shall be determined by calling Kansas One Call at 687-2470/1-800-344-7233. Contractor shall be responsible for any damage done to existing utilities.
- Report any discrepancies in the planting plan to the Landscape Architect, prior to starting construction.
- The Landscape Contractor shall coordinate with the G.C. to gain site access to install the plants and maintain grounds, until final acceptance from owner. Upon final acceptance, the one (1) year guarantee period will begin.
- The Landscape Contractor shall coordinate with the G.C. to install the plants and maintain grounds, until final acceptance from owner.
- The Landscape Contractor shall submit bid with unit prices for all plants, including mulch, installation, 1 year guarantee, bed preparation, fertilizer, etc.
- The Landscape Contractor is responsible for any damage done to the exterior of the building or any part of the parking lot when installing or maintaining the plantings before final acceptance.
- Fall planting season shall be September 1 thru October 31. Spring planting season shall be April 1 thru June 30. For grass seeding, fall season shall be September 1 thru mid October. Spring season for seeding shall be from March 15 thru mid May.
- Landscape to be watered manually. If automatic system is requested by owner, contractor to consult Irrigation notes below.

LANDSCAPE PLAN

SCALE 20 0 20