

CITY OF WICHITA, KANSAS MODIFICATIONS TO STORM SEWER SYSTEM TO SERVE

LOT 1, BLOCK 1, KANSAS SURGERY AND
RECOVERY CENTER ADDITION
WICHITA, SEDGWICK COUNTY, KANSAS

PRIVATE PROJECT NO.: 804 PPS (607861)

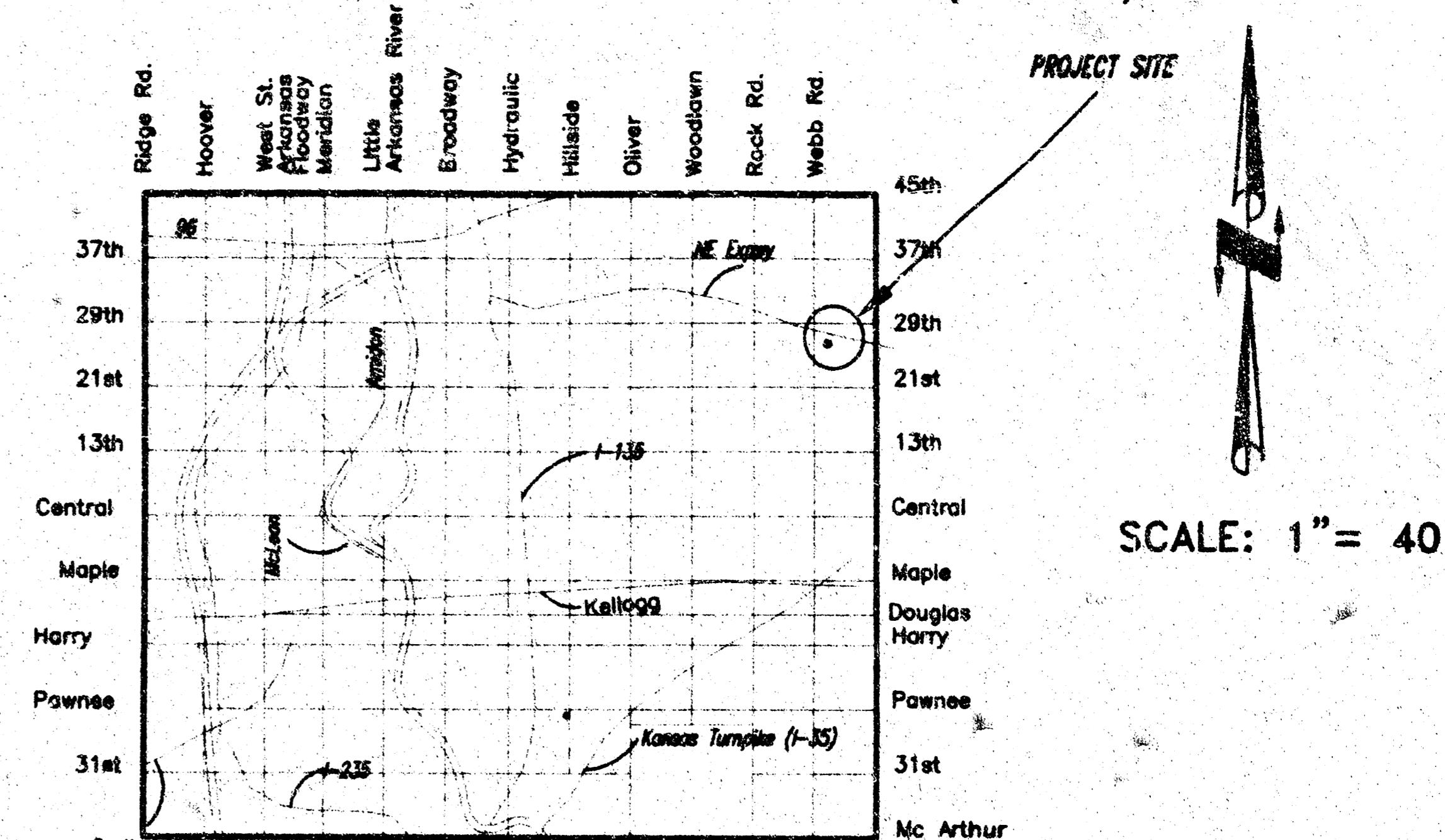

*804 PPS
B006*

NOTE TO CONTRACTOR:

INSPECTION AND TESTING FOR THIS PROJECT IS TO BE PROVIDED BY A LICENSED CONSULTING ENGINEERING FIRM UNDER CONTRACT WITH THE OWNER/DEVELOPER. SAID INSPECTION TO BE IN ACCORDANCE WITH THE CITY OF WICHITA STANDARD ENGINEERING PRACTICES AND CERTIFIED BY A LICENSED PROFESSIONAL ENGINEER. NO WORK SHALL BE PERFORMED IN DEDICATED EASEMENTS OR PUBLIC RIGHT-OF-WAY BY THE CONTRACTOR WITHOUT SUCH INSPECTION NOR SHALL ANY WORK BE COMMENCED IN DEDICATED EASEMENTS OR PUBLIC RIGHT-OF-WAY WITHOUT WRITTEN AUTHORIZATION BY THE CITY ENGINEER.

APPROVED AS NOTED
BY CITY ENGINEER OF WICHITA

SANITARY SEWER _____
STORM SEWER Julianus Kallman 5-20-98
DRIVEWAY APPROACH _____
WATER MAINS _____
PAVING _____

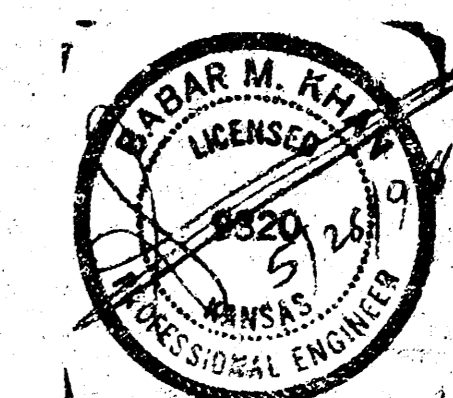

MICHAEL E. LINDEBAK, P.E., CITY ENGINEER

SCALE:	APPROVED:	DRAWN BY:
DATE:		DESIGN:
PROJECT NO.	98-46 (Municipal)	
MUNICIPAL ENGINEERS		
264-LAURA, SUITE 201 WICHITA, KANSAS 67211 316-268-2812		

GENERAL NOTES:

- CONTRACTOR WILL BE REQUIRED TO PROVIDE A MINIMUM ADVANCE NOTICE OF TWENTY-FOUR (24) HOURS TO UTILITY COMPANIES PRIOR TO STARTING ANY EXCAVATION AS FOLLOWS:

KANSAS GAS & ELECTRIC	316-261-6421
KGE GAS	316-842-8350
SOUTHWESTERN BELL TELEPHONE CO.	316-263-0454
WICHITA WATER DEPARTMENT	316-269-4550
MULTIMEDIA CABLEVISION	316-262-4270
WICHITA SEWER MAINTENANCE	316-268-4210
KANSAS ONE-CALL	1-887-2470
- CONTRACTOR SHALL NOT START WORK ON THE PROJECT UNTIL THE PROJECT INSPECTOR IS ASSIGNED TO THE PROJECT AND IS PRESENT ON THE SITE. ANY WORK DONE WITHOUT INSPECTION WILL BE REQUIRED TO BE UNCOVERED FOR INSPECTION.
- EXISTING UTILITIES AND THEIR LOCATIONS, AS SHOWN ON THE PLANS, REPRESENT THE BEST INFORMATION OBTAINABLE FOR DESIGN. LOCATION INFORMATION HAS BEEN OBTAINED FROM THE VARIOUS UTILITY COMPANIES AND IS EITHER FROM COMPANY RECORD DRAWINGS OR COMPANY PROVIDED FIELD LOCATIONS. THE CONTRACTOR WILL BE REQUIRED TO WORK AROUND EXISTING UTILITIES WITHIN THE RIGHT-OF-WAY WHICH DO NOT CONFLICT WITH PROPOSED CONSTRUCTION.
- RUBBLE FROM THE REMOVAL OF MISCELLANEOUS STRUCTURES AND EXCESS EXCAVATION WHICH IS TO BE WASTED SHALL BE DISPOSED OF ON SITES TO BE PROVIDED BY THE CONTRACTOR. THESE SITES SHALL BE APPROVED BY THE ENGINEER AS TO SUITABILITY, APPEARANCE AND SITE LOCATION. LOCATIONS THAT, IN THE OPINION OF THE ENGINEER, WILL LEAVE UNSIGHTLY APPEARANCE WILL NOT BE APPROVED.
- THE CONTRACTOR SHALL BE RESPONSIBLE FOR PRESERVING PROPERTY IRONS. THE CONTRACTOR WILL BE REQUIRED TO RE-ESTABLISH ANY PROPERTY IRONS WHICH ARE DAMAGED OR DESTROYED BY HIS CONSTRUCTION OPERATIONS. SUCH IRONS SHALL BE RE-ESTABLISHED BY A LICENSED LAND SURVEYOR IN ACCORDANCE WITH STATE LAW.
- ALL AREAS DISTURBED DURING CONSTRUCTION SHALL BE SEEDED PER CITY OF WICHITA REQUIREMENTS.

