

PRIVATE STORM WATER SEWER TO SERVE Marina Lake 7th Addition

Lot 2

Private Project Number 930 PPS (607861)

CITY OF WICHITA, KANSAS

Michael E. Lindebak, P.E. City Engineer

August, 1999

General Notes:

- Contractor will be required to provide notice to utility companies a minimum of forty-eight (48) hours prior to any excavation, as follows:
Kansas One-Call 687-2470
The Contractor must notify the following in case of an emergency:
Cablevision 262-0661
or Kansas Gas Service 263-2061
KGE 383-8650
Peoples Gas Company 383-8600
Southwestern Bell Telephone Company 800-344-7233
City of Wichita Water Department 268-4908
City of Wichita Sewer Maintenance 268-4071
- Underground utility service lines and overhead utility pole lines are to be adjusted as necessary by others prior to construction unless the plans specifically call for their adjustment by the Contractor or unless the plans specifically identify a utility to be adjusted by its owner during construction. Existing utilities and their location, as shown on the plans, represent the best information obtainable for design. The Contractor will be required to work around existing utilities within the right-of-way which do not conflict with proposed construction.
- Contractor shall not start work on the project until the Project Inspector is assigned to the project and is present on the site. Any work done without inspection will be required to be uncovered for inspection.
- All areas disturbed by construction operations shall be seeded with rye grass at a rate of 6 lbs. per 1000 sq. feet.
- Rubble from the removal of miscellaneous structures and excess excavation which is to be wasted shall be disposed of on sites to be provided by the Contractor. These sites shall be approved by the Engineer as to suitability, appearance and site location. Locations that, in the opinion of the Engineer, will leave an unsightly appearance will not be approved.
- The Contractor shall be responsible for preserving property irons. The Contractor will be required to re-establish any property irons which are damaged or destroyed by his construction operations. Such irons shall be re-established by a licensed land surveyor in accordance with state law.
- The Contractor shall give all property owners and/or tenants of developed property directly adjoining the construction of this project a minimum of ten (10) days advance notice prior to start of construction.

APPROVED AS NOTED
BY CITY ENGINEER OF WICHITA

Storm Sewers VRH 8/19/99

NOTE TO CONTRACTORS

Installation, inspection and testing for this project is to be provided by a Licensed Consulting Engineering Firm under contract with the Owner/Developer. Said inspection to be in accordance with the City of Wichita standard construction engineering practices and certified by a Licensed Professional Engineer. No work shall be performed in dedicated easements or public right-of-way by the Contractor without such inspection nor shall any work be commenced without written authorization by the City Engineer. All Construction and Materials shall comply with the City of Wichita Specifications and Standards (on file and available in the City Engineer's Office).

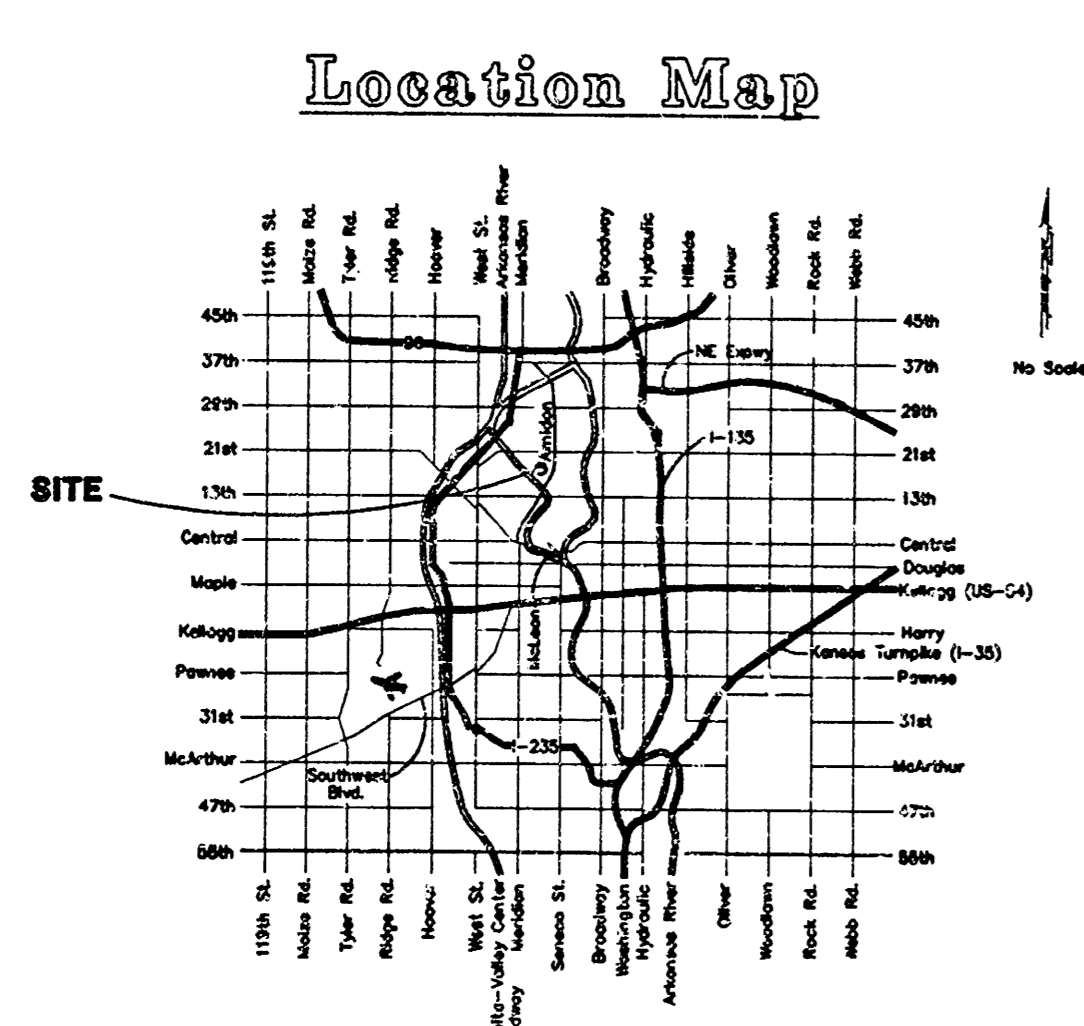

MARINA LAKE SEVENTH ADDITION

WICHITA, KANSAS

* Notes are associated with this plat.

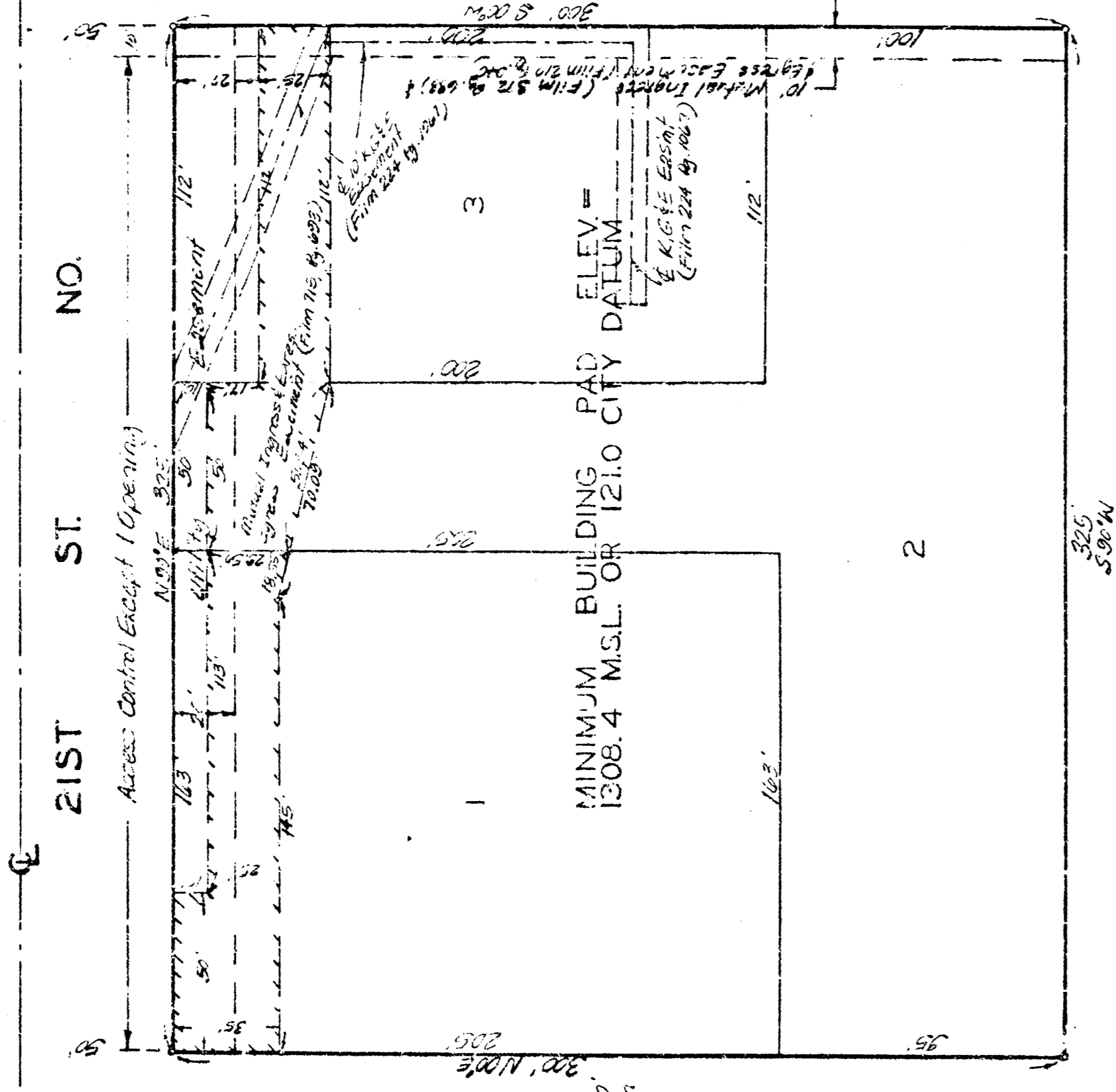

State of Kansas, ss. W.C. Baughman Company, P.A. Surveyors in and for said county and state do hereby certify that we have surveyed and plotted MARINA LAKE SEVENTH ADDITION, Wichita, Kansas, and that the accompanying plat is a true and correct exhibit of the property surveyed described as and being a part of Lot 3 Marina Lake Fourth Addition Wichita, Kansas, being situated in the N.W. 1/4 of Sec. 7, Twp. 27S., R.1E of the 6th P.M. range with County, Kansas. Access cannot be gained by virtue of R.S.T. 12-312 (S).

Dec. 1, 1935
 W.C. Baughman Company P.A.
 W.C. Baughman, Surveyor

I, the undersigned, have caused the plat described in the surveyors' Certificate to be plotted into lots to be known as "MARINA LAKE SEVENTH ADDITION," Wichita, Kansas. The utility easement is hereby granted as indicated for the construction and maintenance of all public utilities. All abutting rights of access to or from 21st St. No. over and across the north line of Lot 3 are hereby granted to the City of Wichita, provided however that the street described shall be vacated by the City of Wichita. The plat shall be considered valid if within one foot elevation of 1308.4 Mean Sea Level or 1210 City Datum.

Color Tile Supermarket, Inc.
 By _____, Vice President

Victor B. Eisenring _____, Chairman
 Annie Biedose _____, Secretary

Resthaven Gardens of Memory, Inc. (Incorporated)
 By James March _____, President

State of Kansas, ss. The foregoing instrument was acknowledged before me this _____ day of _____, 1935, by Victor B. Eisenring and James March, President of Memory, Inc., on behalf of the corporation.

My App. Exp. _____, Notary Public

State of Kansas, ss. The foregoing instrument was acknowledged before me this _____ day of _____, 1935, by Victor B. Eisenring and Annie Biedose, Secretary of Memory, Inc., on behalf of the corporation.

My App. Exp. _____, Notary Public

State of Kansas, ss. The foregoing instrument was acknowledged before me this _____ day of _____, 1935, by James March, Sr. President of Resthaven Gardens of Memory, Inc., on behalf of the corporation.

My App. Exp. _____, Notary Public

I, the undersigned, holder of a mortgage on a portion of the land described hereby, do hereby consent to this plat of MARINA LAKE SEVENTH ADDITION, Wichita, Kansas.

American Amicable Life Insurance Co.
 By _____, Vice President

State of Kansas, ss. The foregoing instrument was acknowledged before me this _____ day of _____, 1935, by American Amicable Life Insurance Co. on behalf of the company.

My App. Exp. _____, Notary Public

This plat of "MARINA LAKE SEVENTH ADDITION," Wichita, Kansas, has been submitted to and approved by the Wichita-Sedgewick County Metropolitan Area Planning Commission, Wichita, Kansas. Dated this _____ day of _____, 1935.

Wichita-Sedgewick County Metropolitan Area Planning Commission
 _____, Chairman
 _____, Secretary

This plat approved and adopted by the Board of Commissioners of the City of Wichita, Kansas, this _____ day of _____, 1935.

_____, Mayor
 _____, City Clerk

Entered on transfer records
 this _____ day of _____, 1935.
 _____, County Clerk

State of Kansas, ss. This is to certify that this plat has been filed for record in the office of the Register of Deeds, _____, and is duly recorded.

_____, Register of Deeds
 _____, Deputy

1177 W