

STORMWATER SEWER IMPROVEMENTS TO SERVE  
Lot 1 of Block A, Smithmoor Commercial Addition

**WEIGAND OFFICE**

Project Number  
**983 PPS (607861)**

**CITY OF WICHITA, KANSAS**  
Michael E. Lindebak, P. E., City Engineer

**GENERAL NOTES**

- Contractor will be required to provide notice to utility companies a minimum of twenty-four (24) hours prior to any excavation, as follows:  
Kansas One-Call 687-2470  
The Contractor must notify the following in case of an emergency:  
Cablevision 262-4270  
or 263-2061  
K.P.L. Gas Service Company 383-8650  
Kansas Gas & Electric Company 383-8600  
Peoples Natural Gas 942-8811  
or 1-800-303-0357  
Southwestern Bell Telephone Company 1-571-2611  
City of Wichita Water Department 268-4908  
City of Wichita Sewer Department 268-4071
- Exist. utilities and their locations, as shown on the plans, represent the best information obtainable for design. Location information has been obtained from the various utility companies and is either from company record drawings or company-provided field locations. The Contractor will be required to work around existing utilities which do not conflict with proposed construction.
- The Contractor to verify utility locations prior to construction of this project.
- Utility service and installation shall be coordinated with the respective utility owners. Contacts are:  
K&E Gas Steve Orth 261-6867  
K.G. & E. Miles Capps 261-6434  
Wichita Water Paul Bryant 268-4555  
Steve Palmer 268-4908  
Southwestern Bell Jim Tobin 268-2759
- All areas disturbed by construction shall be seeded with rye Rebel II Fescure grass at a rate of 350 lbs./acre immediately following construction in that area.
- Traffic affected by the construction of this project shall be handled in accordance with the latest edition of the Manual on Uniform Traffic Control Devices.
- All lawn/lurf areas disturbed by construction of proposed improvements shall be restored with the same grass/sod as existing. Restoration of disturbed areas shall include, but not be limited to, top soil preparation, seeding, mulch and/or reseeded. All seeding/sodding work shall be in accordance with the City of Wichita standard specifications and the City of Wichita administrative regulation No. AR78 which governs cleanup and replacement following construction. All costs for this work shall be subsidiary to the lump sum price bid for "Site Restoration."

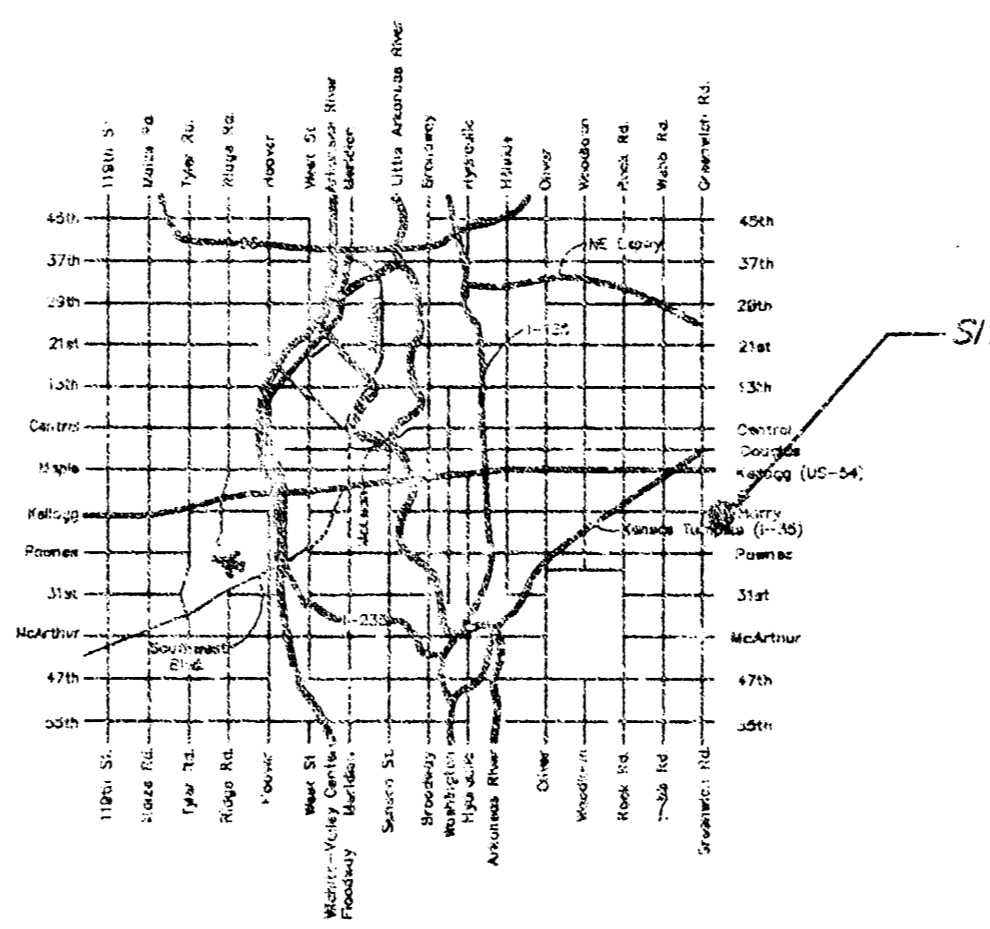

**LOCATION MAP**

**BENCHMARK:**

City of Wichita Disk on SW Corner of  
Base of Traffic Signal at NE Corner of  
Intersection of Harry Street and  
Greenwich Road  
Elev. = 1343.83

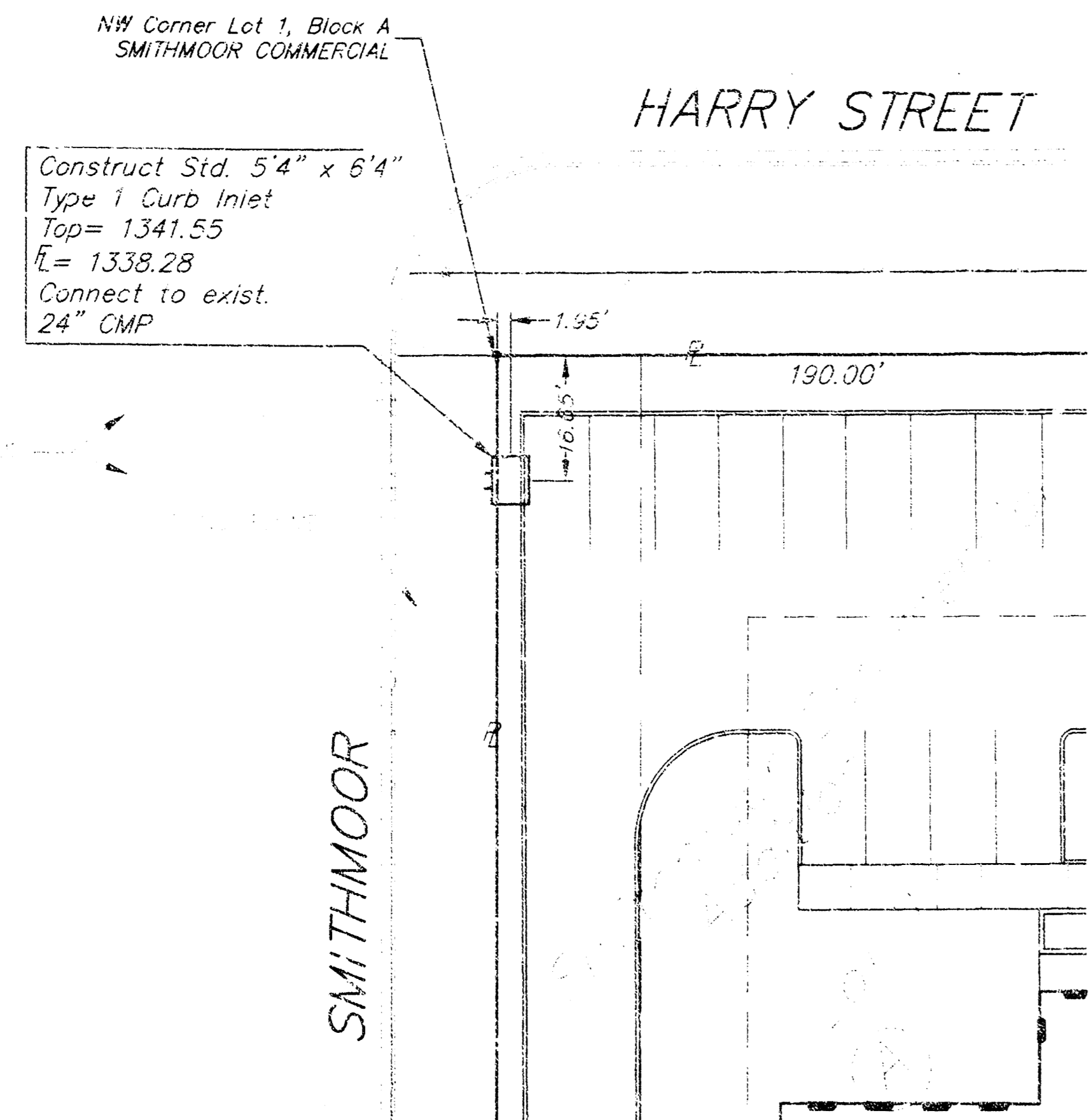
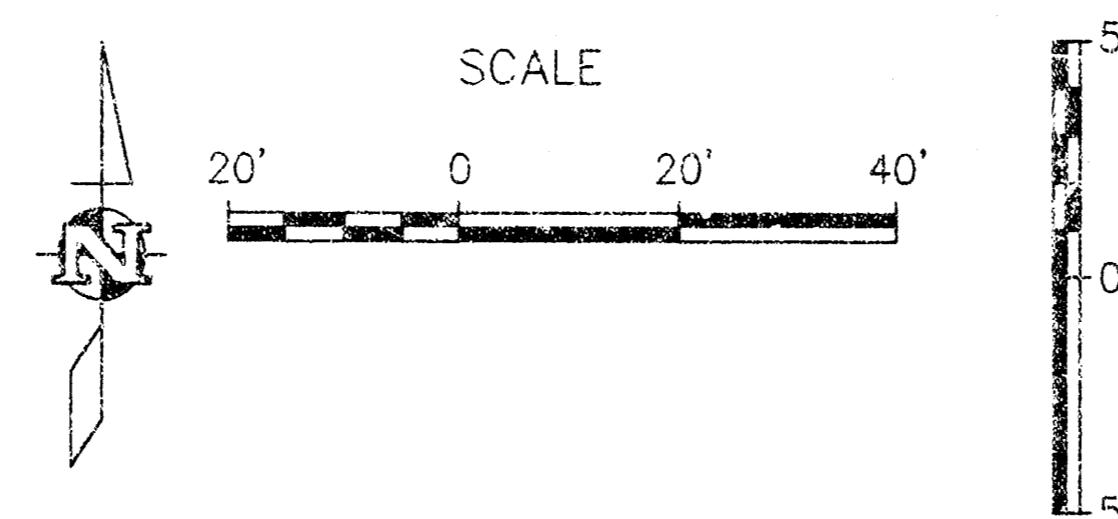

1350  
1345  
1340  
1335  
1330

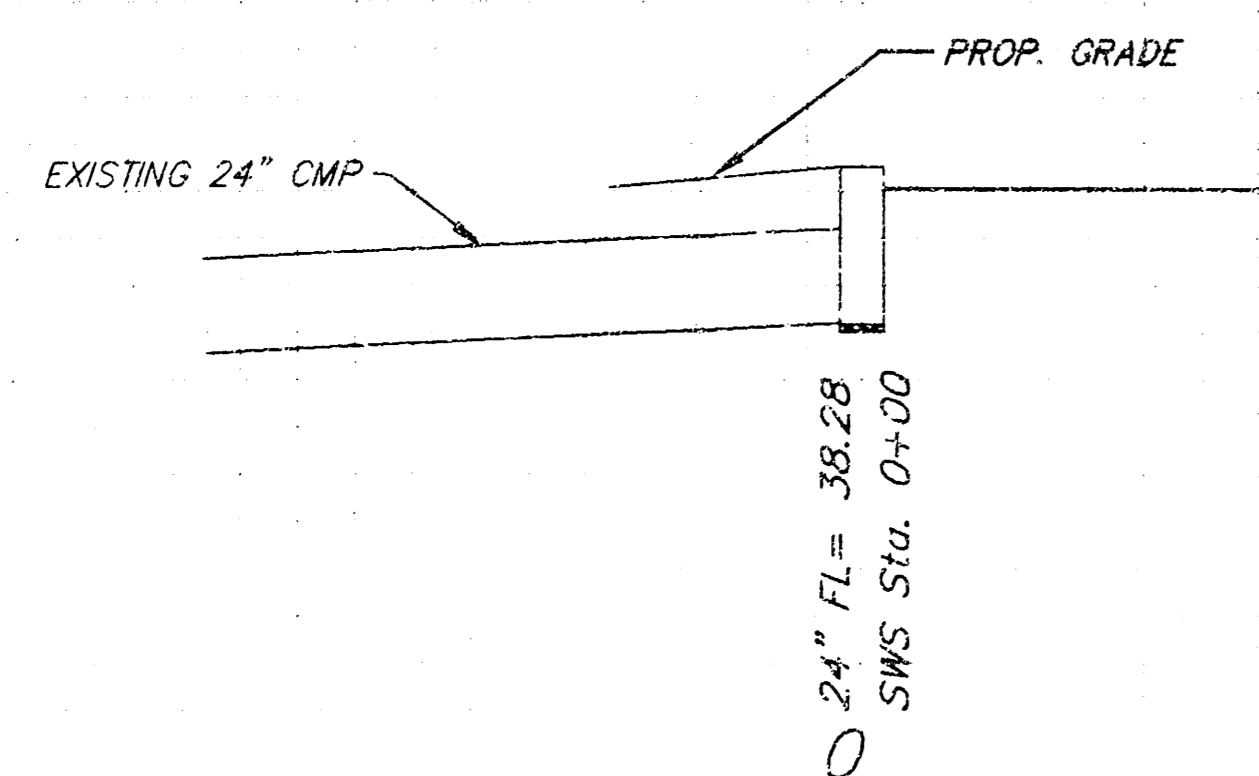

APPROVED AS NOTED BY CITY ENGINEER OF WICHITA

STORM SEWERS VRH 2/29/00

Inspection and testing for this project are to be provided by a Licensed Consulting Engineering Firm under contract with the Owner/Developer. Said inspection is to be in accordance with the City of Wichita standard construction engineering practices and certified by a Licensed Professional Engineer. No work shall be performed in dedicated easements or public right-of-way by the Contractor without such inspection nor shall work be commenced without written authorization by the City Engineer. All construction and materials shall comply with the City of Wichita Specifications and Standards (on file and available in the City Engineer's Office).



SHEET	PROJECT NUMBER				AM. NO.	SHEET
	983 PPS (607861)				39322	
DESIGN	DRAWN	FILE	DATE	SCALE	WEIGAND OFFICE	
DK	KY	swspp1	02/00	1"=20'	<b>SWS &amp; PROFILE</b>	
					Wichita, Kansas	
						OF
						2

