

# DETENTION POND PLANS FOR SELTZER ELEMENTARY (USD 259) & WOODLAND LAKES COMMUNITY CHURCH

CITY OF WICHITA, KANSAS

MICHAEL E. LINDEBAR, CITY ENGINEER

OCA NO. 607861  
USER CODE 1114 PPS

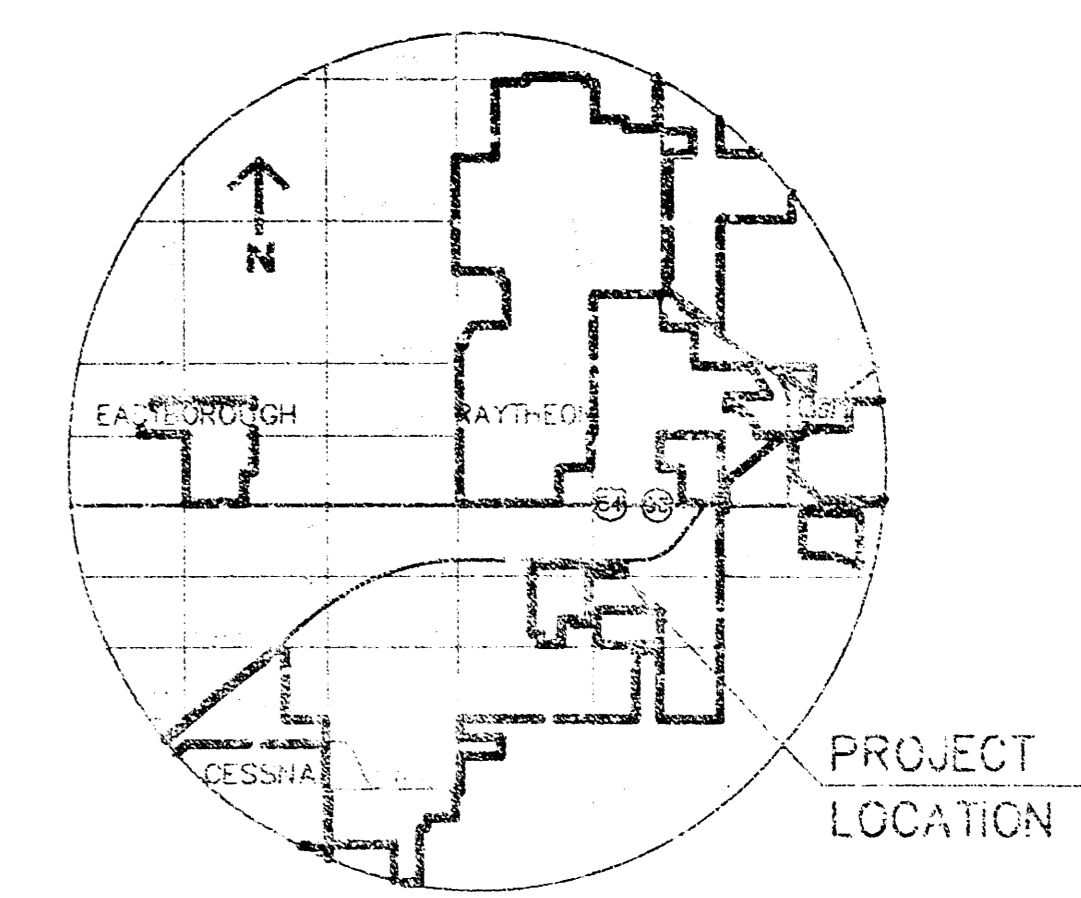

LOCATION MAP

## GENERAL NOTES

1. THE CONTRACTOR SHALL BE RESPONSIBLE FOR PRESERVING PROPERLY IRONS. THE CONTRACTOR SHALL BE REQUIRED TO RE-ESTABLISH ANY PROPERTY IRONS WHICH ARE DAMAGED OR DESTROYED BY HIS CONSTRUCTION OPERATIONS. SUCH IRONS SHALL BE RE-ESTABLISHED BY A LICENSED LAND SURVEYOR IN ACCORDANCE WITH STATE LAWS.
2. EXISTING UTILITIES AND THEIR LOCATIONS, AS SHOWN ON THE PLANS REPRESENT THE BEST INFORMATION OBTAINABLE FOR DESIGN. LOCATION INFORMATION HAS BEEN OBTAINED FROM THE VARIOUS COMPANIES AND IS EITHER FROM COMPANY UTILITY DRAWINGS OR COMPANY PROVIDED FIELD LOCATIONS. THE PLAN LOCATIONS SHOWN ARE NOT GUARANTEED. ADDITIONAL EXISTING UTILITIES MAY ALSO BE ENCOUNTERED.
3. CONTRACTOR WILL BE REQUIRED TO PROVIDE A MINIMUM ADVANCE NOTICE OF FORTY-EIGHT (48) HOURS TO UTILITY COMPANIES PRIOR TO STARTING ANY EXCAVATION AS FOLLOWS:  
  

KANSAS ONE-CALL	1-800-344-7233
-----------------	----------------

THE CONTRACTOR MUST NOTIFY THE FOLLOWING IN CASE OF AN EMERGENCY:

CABLEVISION	263-2051
ARKLA GAS COMPANY	263-7511
KANSAS GAS & ELECTRIC	264-1141
SOUTHWEST BELL TELEPHONE COMPANY	1-571-2611
CITY OF WICHITA WATER & SEWER MAINT.	252-6900
4. UNLESS SHOWN OR STATED OTHERWISE ON THESE DRAWINGS, MATERIALS AND CONSTRUCTION SHALL BE IN ACCORDANCE WITH CITY OF WICHITA SPECIFICATIONS.
5. EXCESS EXCAVATION WHICH IS TO BE WASTED SHALL BE DISPOSED OF ON SITES TO BE PROVIDED BY THE CONTRACTOR. THESE SITES SHALL BE APPROVED BY THE ENGINEER AS TO SUITABILITY, APPEARANCE AND SITE LOCATION. LOCATIONS THAT, IN THE OPINION OF THE ENGINEER, WILL LEAVE AN UNSIGHTLY APPEARANCE WILL NOT BE APPROVED. ALL DISPOSAL SITES MUST BE APPROVED BY THE KANSAS DEPARTMENT OF HEALTH AND ENVIRONMENT. MATERIAL EITHER STOCKPILED OR DISPOSED OF IN A FLOOD PLAIN WOULD REQUIRE A KANSAS STATE BOARD OF AGRICULTURE PERMIT. ANY MATERIAL DUMPED IN WATERS OF THE UNITED STATES OR WETLANDS IS SUBJECT TO U.S. CORPS OF ENGINEERS PERMITTING REGULATIONS. ANY MATERIAL BURIED OR STOCKPILED BEYOND APPROVED CONSTRUCTION LIMITS WOULD REQUIRE ADDITIONAL ARCHAEOLOGICAL INVESTIGATIONS UNLESS BURIED IN A PREVIOUSLY APPROVED BORROW LOCATION.
6. SITE RESTORATION AND PREPARATION SHALL BE SUBSIDIARY TO THE PROJECT.

KANSAS TURNPIKE

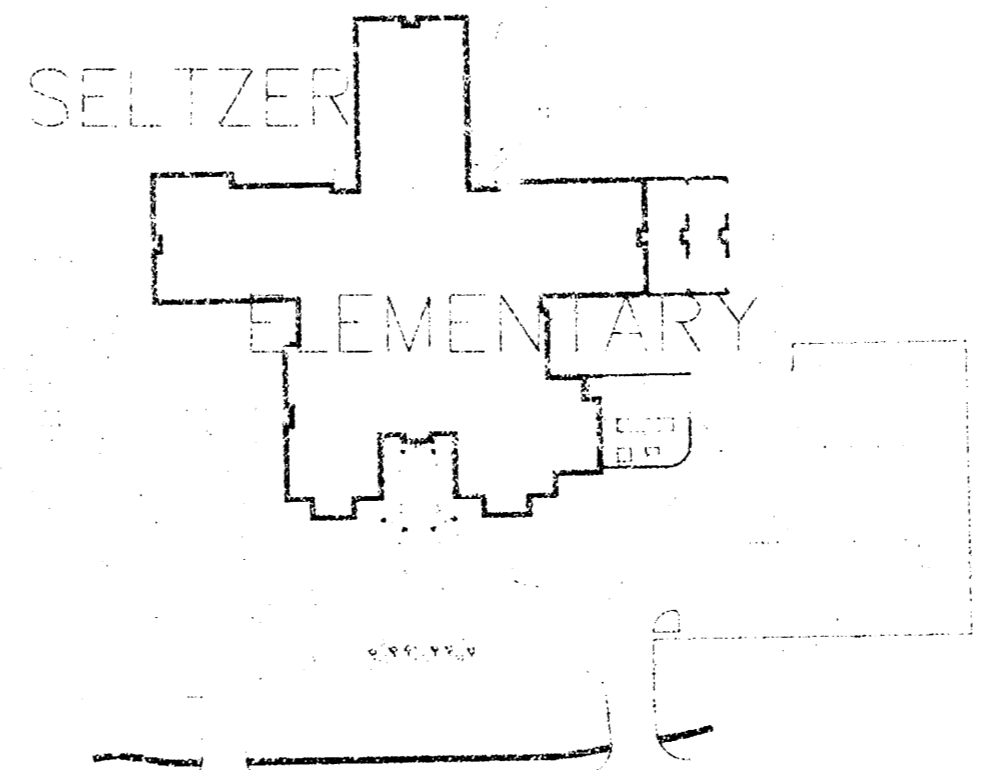
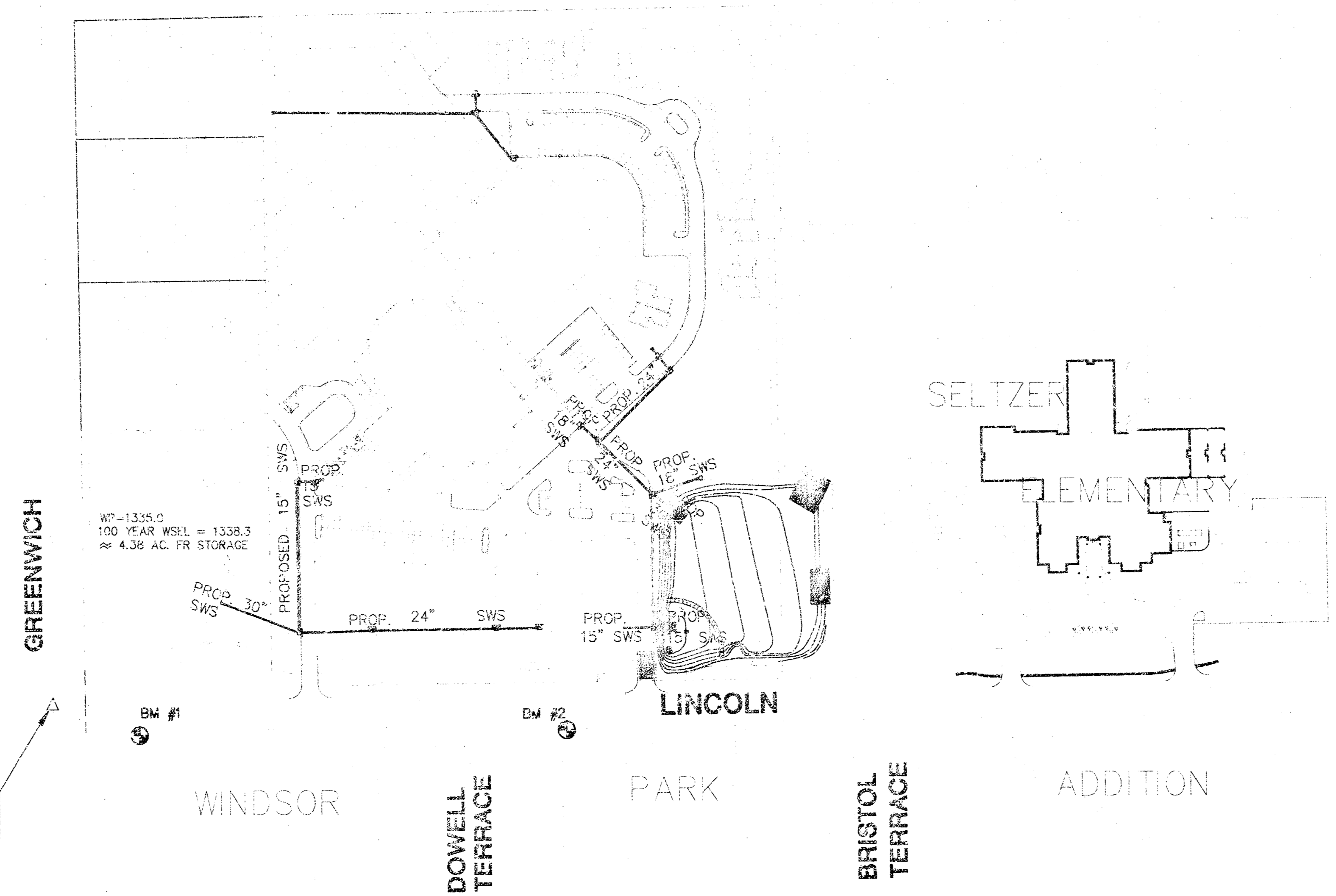

APPROVED AS NOTED  
BY CITY ENGINEER OF WICHITA

DRAIN  
STORM SEWERS VRH 5/11/01

### NOTE TO CONTRACTOR

INSPECTION AND TESTING FOR THIS PROJECT IS TO BE PROVIDED BY A LICENSED CONSULTING ENGINEERING FIRM UNDER CONTRACT WITH THE OWNER/DEVELOPER. SAID INSPECTION TO BE IN ACCORDANCE WITH THE CITY OF WICHITA STANDARD CONSTRUCTION ENGINEERING PRACTICES AND CERTIFIED BY A LICENSED PROFESSIONAL ENGINEER. NO WORK SHALL BE PERFORMED IN DEDICATED EASEMENTS OR THE PUBLIC RIGHT-OF-WAY BY THE CONTRACTOR WITHOUT SUCH INSPECTION NOR SHALL ANY WORK BE COMMENCED IN DEDICATED EASEMENTS OR PUBLIC RIGHT-OF-WAY WITHOUT WRITTEN AUTHORIZATION BY THE CITY ENGINEER.

## INDEX TO DRAWINGS

SHEET NO.	DESCRIPTION
1	TITLE SHEET
2	DETENTION POND PLAN
3	EROSION CONTROL DETAILS

### BENCH MARKS

- BM #1 RAILROAD SPIKE IN 2ND. POWER POLE EAST OF GREENWICH ROAD AND SOUTH OF LINCOLN. ELEV.=1336.39
- BM #2 RAILROAD SPIKE IN 1ST. POWER POLE EAST OF DOWELL AND SOUTH OF LINCOLN. ELEV.=1540.16
- BM #3 C.O.W. BENCH MARK NORTHWEST CORNER OF DOUBLE 4'x6" (1.219m X 1.829m) RCBC, ON HUBGUARD, IN FRONT OF 930 S. GREENWICH, 250' (76.2m) SOUTH OF LINCOLN. ELEV.=1334.02



**WOODLAND LAKES COMMUNITY CHURCH**  
PROJECT NAME



**TITLE SHEET**  
SHEET TITLE

411 N. WEBB ROAD WICHITA, KS. 67206 316-684-9600	ASH DESIGN BY:	DM DRAWN BY:	ASH CHECKED BY:
	APRIL 2001 DATE	DET-CVR DRAWING NAME	1 / 3 SHEET / OF

12 14 01 01

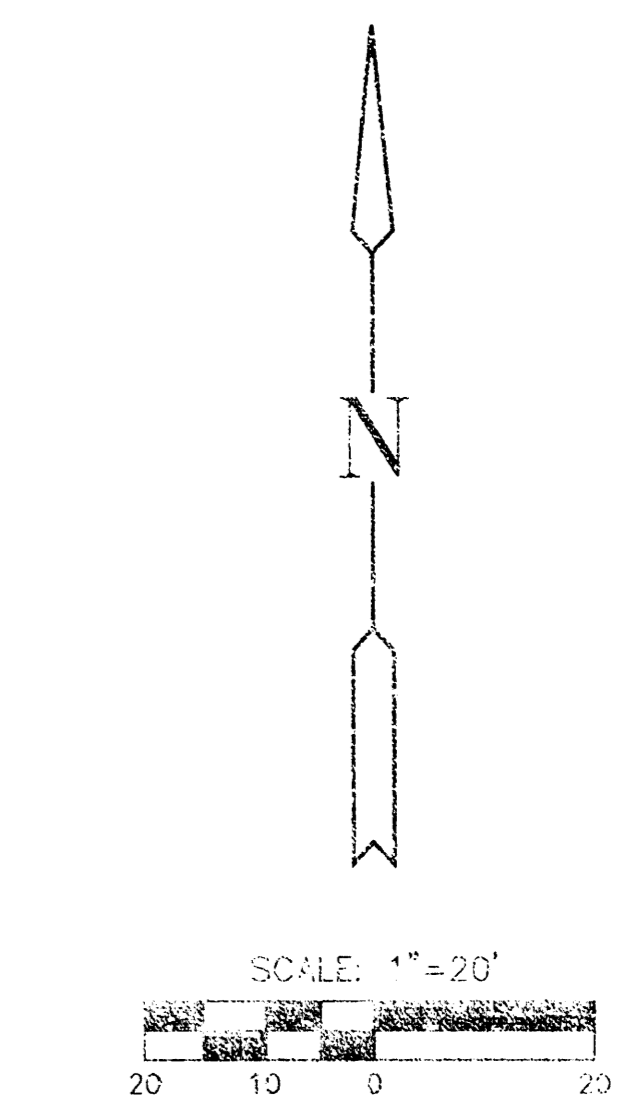
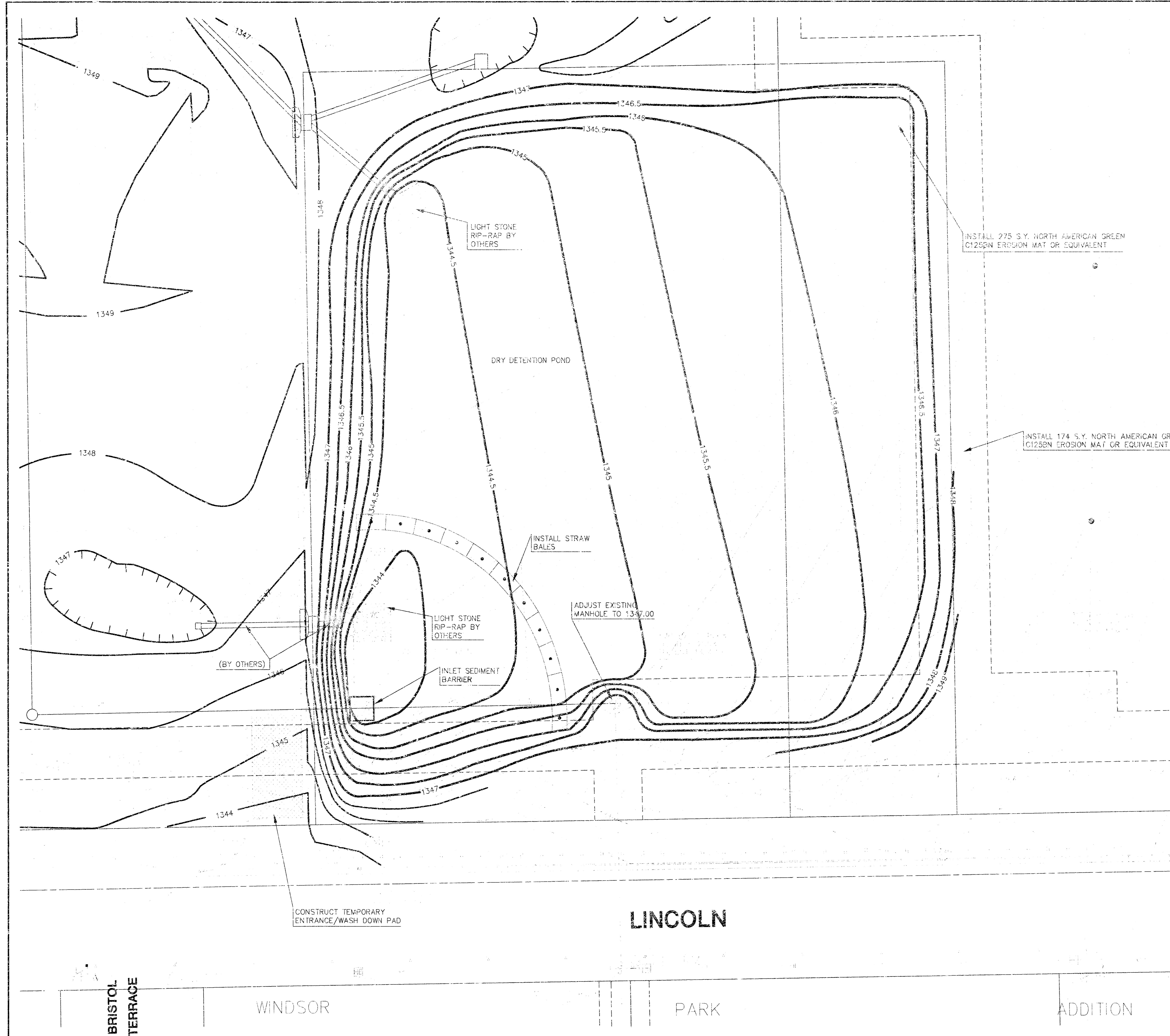
K:\CIVIL\00031\SPRINKLING\GRADING\DET.POND.DWG



- LEGEND**
-  = STRAW BALE
  -  = INLET SEDIMENT BARRIER

BRISTOL TERRACE

WINDSOR

LINCOLN

PARK

ADDITION



**MKEC**  
ENGINEERING CONSULTANTS  
411 N. WEBB ROAD  
WICHITA, KS. 67206  
316.694-9600

WOODLAND LAKES COMMUNITY CHURCH  
PROJECT NAME

GRADING - DETENTION POND  
SHEET TITLE

ASH	DM	ASH
DESIGN BY:	DRAWN BY:	CHECKED BY:
APRIL 2001	DET.POND	2 / 3
DATE	DRAWING NAME	SHEET / OF

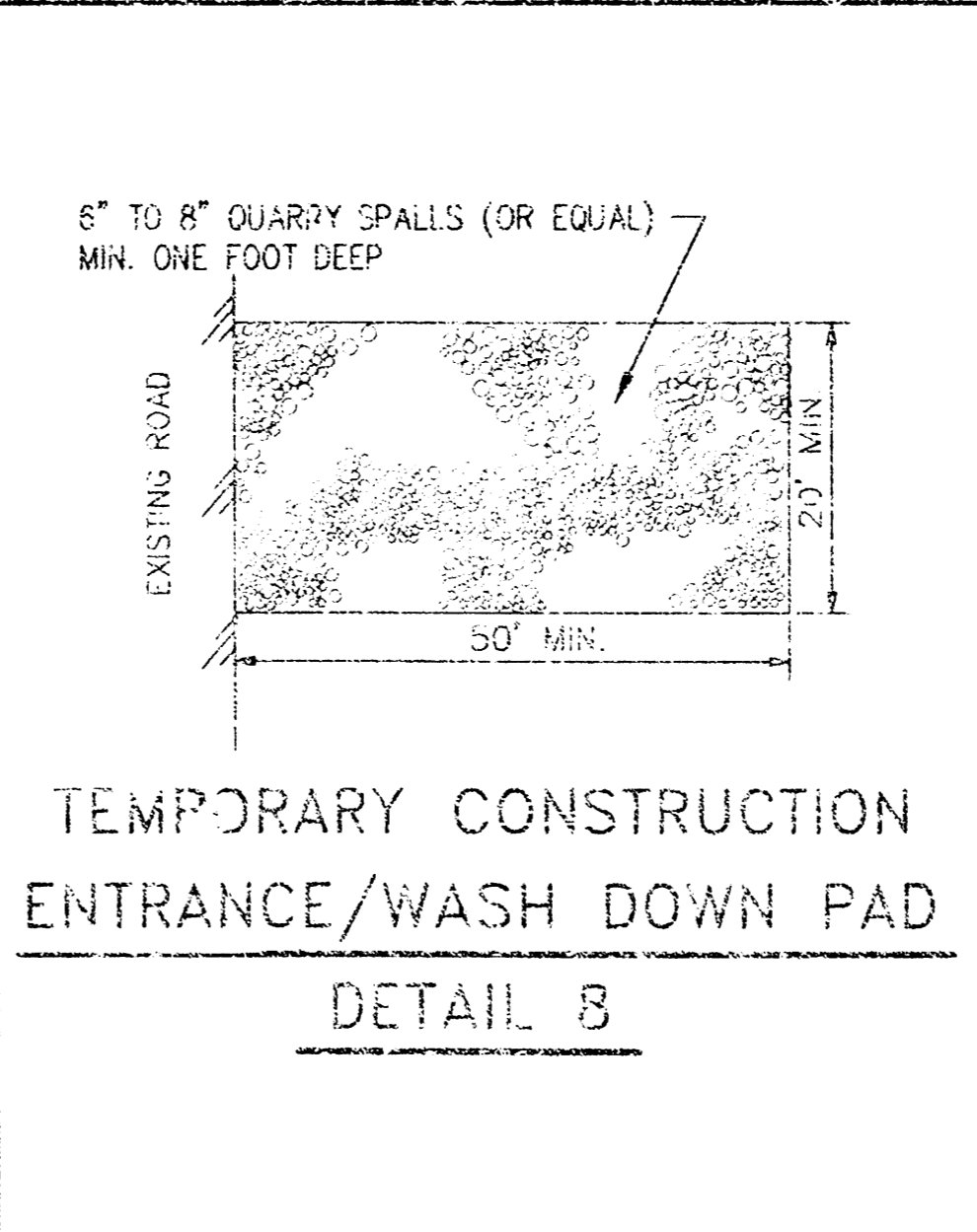
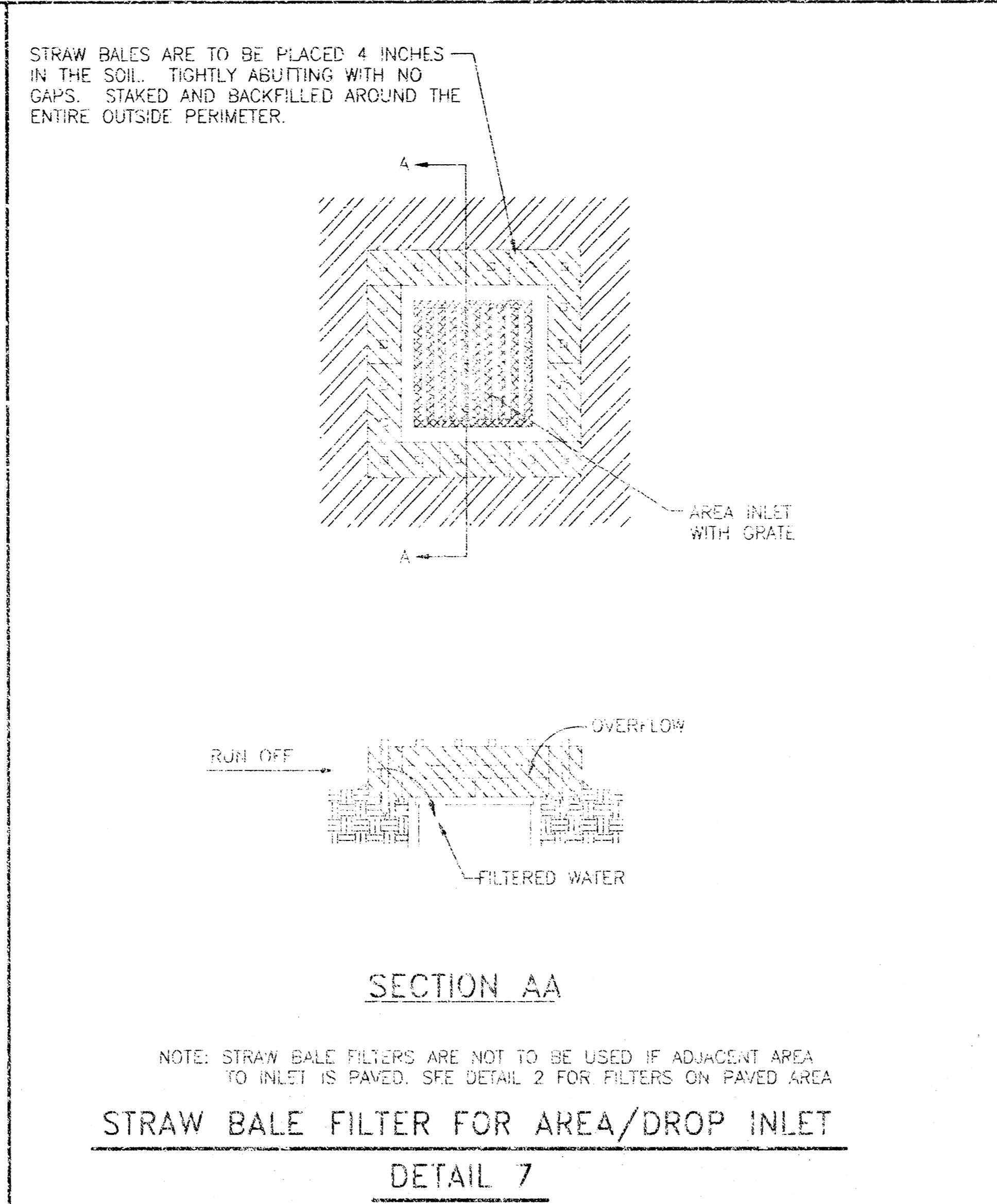
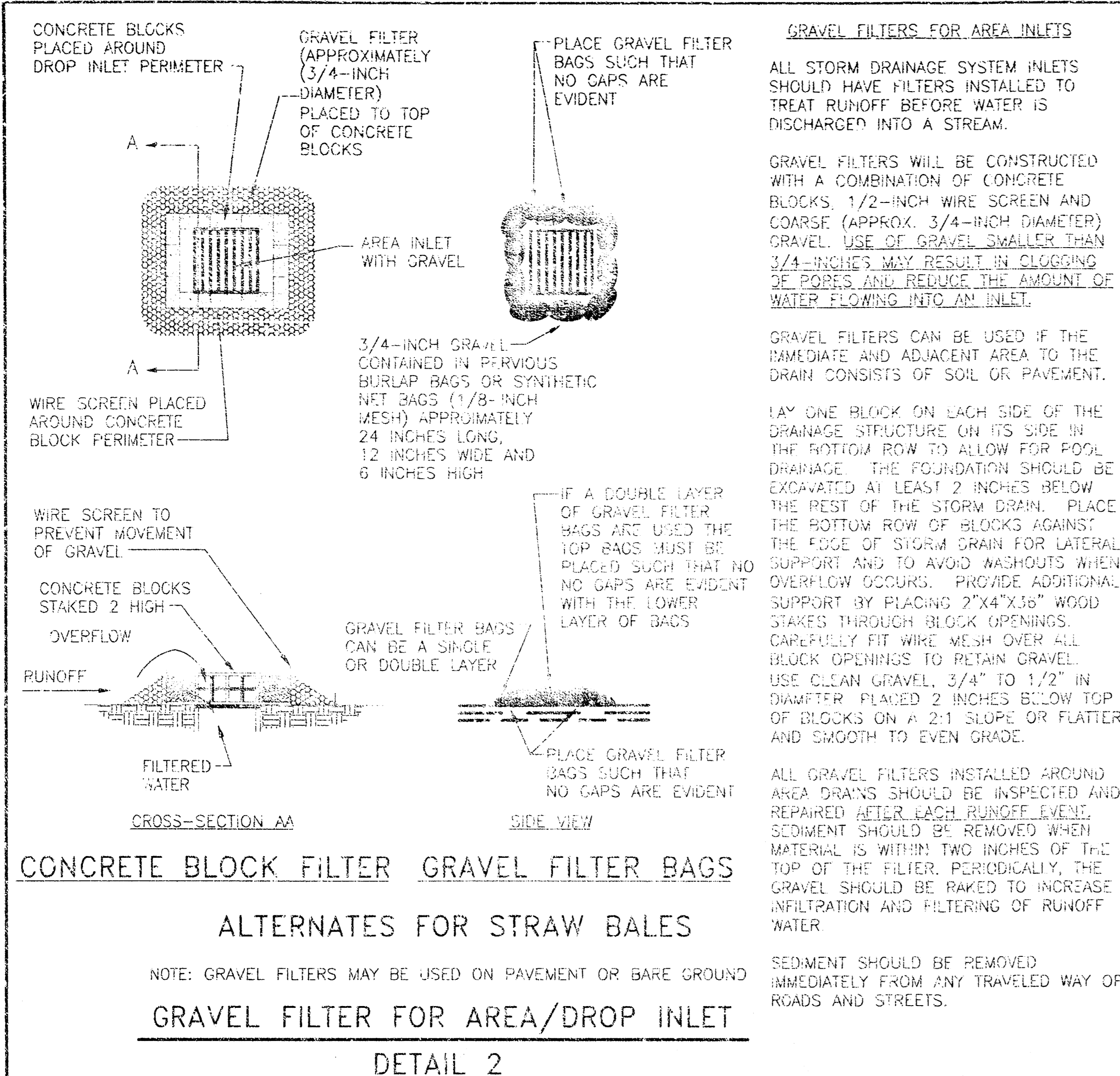

**EROSION AND SEDIMENT CONTROL NOTES:**

1. TEMPORARY STABILIZATION - TOPSOIL STOCK PILES AND DISTURBED PORTIONS OF THE SITE WHERE CONSTRUCTION ACTIVITY TEMPORARILY CEASES FOR AT LEAST 28 DAYS WILL BE STABILIZED WITH TEMPORARY SEED AND MULCH NO LATER THAN 14 DAYS FROM THE LAST CONSTRUCTION ACTIVITY IN THAT AREA. THE TEMPORARY SEED SHALL BE RYE (GRAIN) APPLIED AT THE RATE OF 160 POUNDS PER ACRE. AFTER SEEDING, EACH AREA SHALL BE MULCHED STRAW. THE STRAW MULCH IS TO BE TACKED INTO PLACE BY A DISK WITH BLADES SET NEARLY STRAIGHT.
2. PERMANENT STABILIZATION - DISTURBED PORTIONS OF THE SITE WHERE CONSTRUCTION ACTIVITIES PERMANENTLY CEASES SHALL BE STABILIZED NO LATER THAN 14 DAYS AFTER THE LAST CONSTRUCTION ACTIVITY.

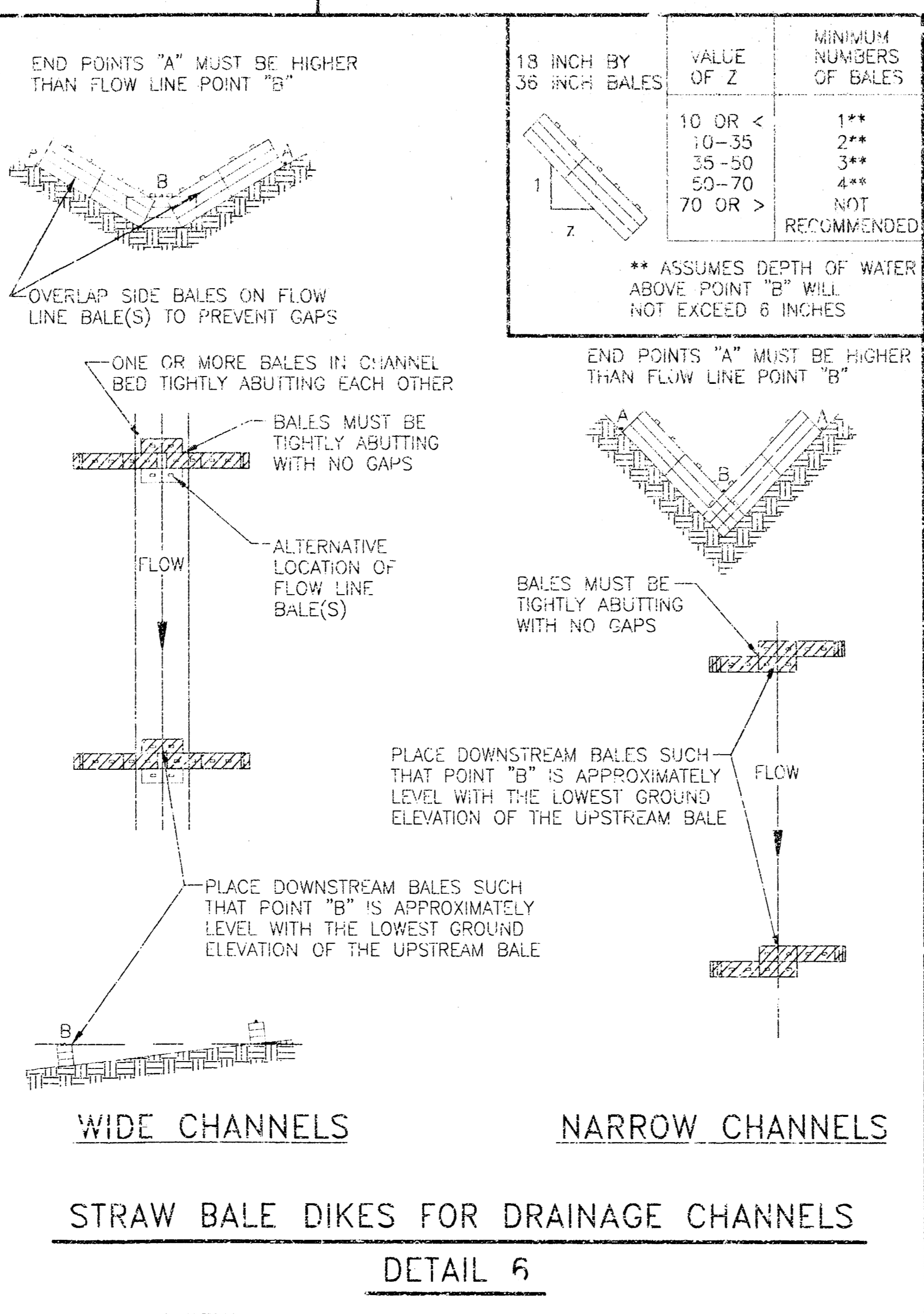
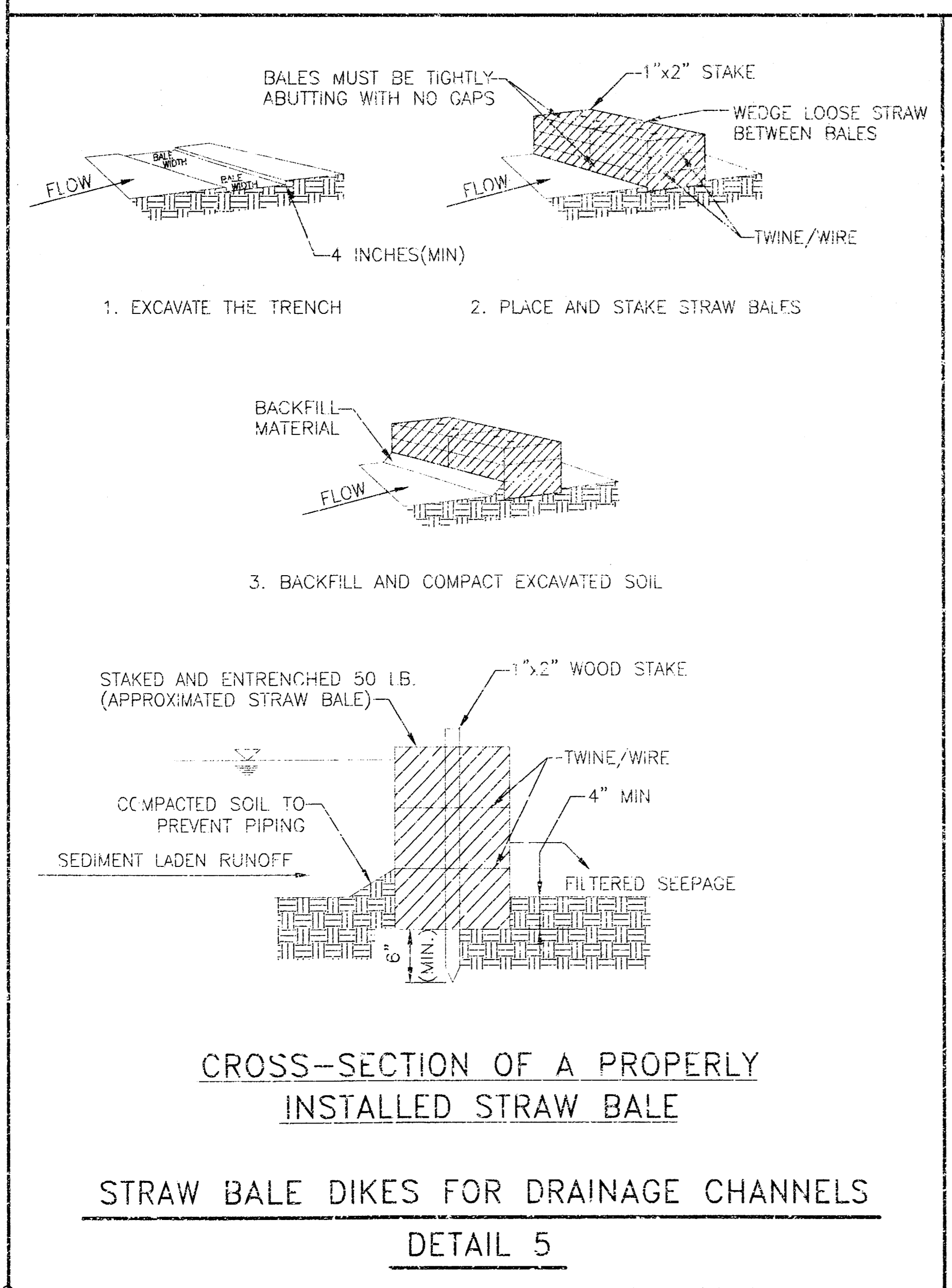

**WOODLAND LAKES COMMUNITY CHURCH**  
 PROJECT NAME

**EROSION/SEDIMENT CONTROL DETAILS**  
 SHEET TITLE

**MKEC**  
 ENGINEERING CONSULTANTS  
 411 N. WEBB ROAD  
 WICHITA, KS. 67206  
 316-664-9600

DESIGN BY: JTC  
 DRAWN BY: DAC  
 CHECKED BY: JTC

DATE: APRIL 2001  
 DRAWING NAME: ERO-DTL  
 SHEET / OF: 3 / 3