

# PRIVATE GRADING / DRAINAGE & SANITARY SEWER PLANS

## WESLEY MEDICAL CENTER

### ICU ADDITION & RENOVATION

#### PRIVATE PROJECT # 1221PPS(607861)

CITY OF WICHITA, KANSAS  
MICHAEL E. LINDEBAK, CITY ENGINEER

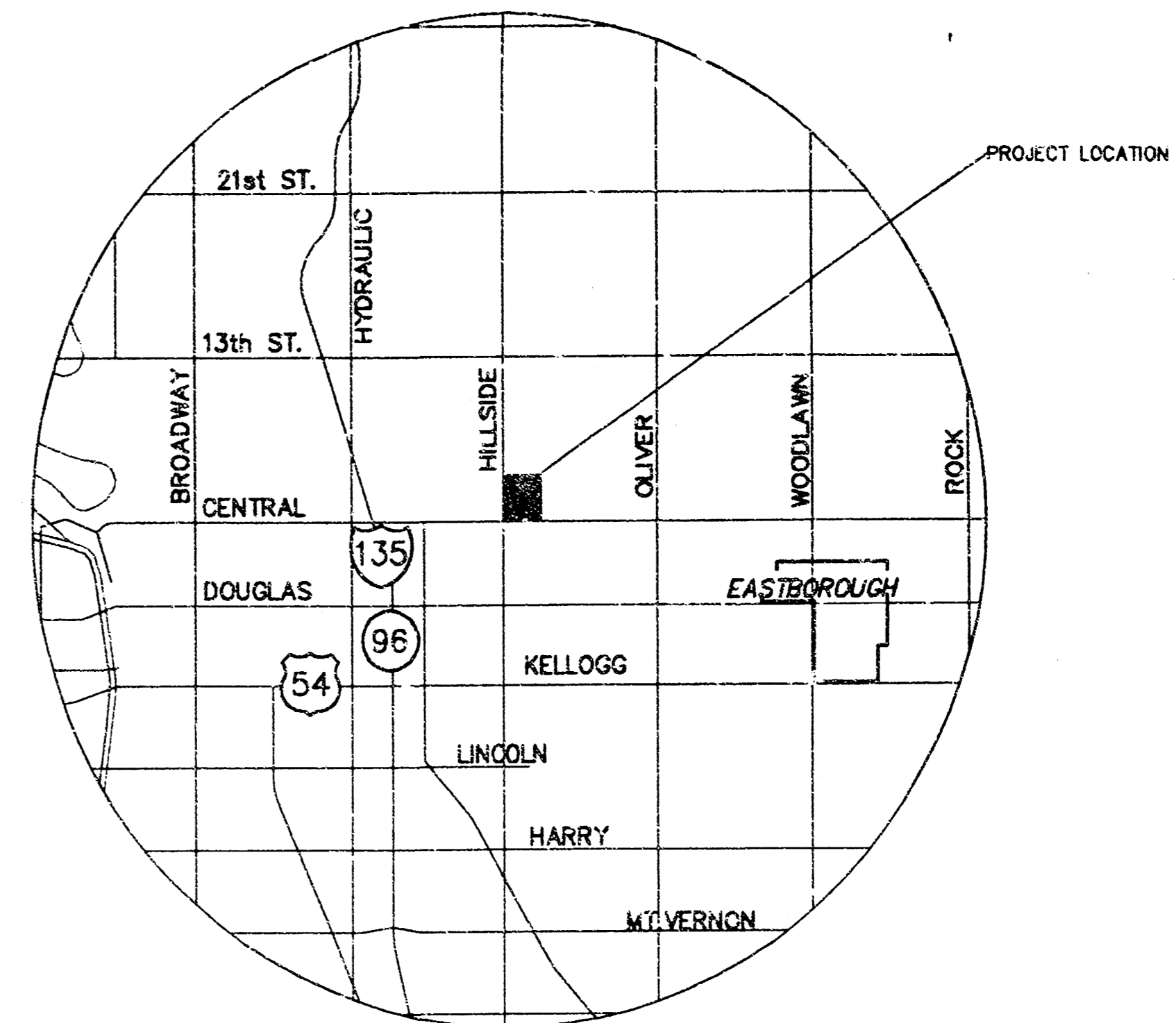

LOCATION MAP

IMPROVEMENT DISTRICT

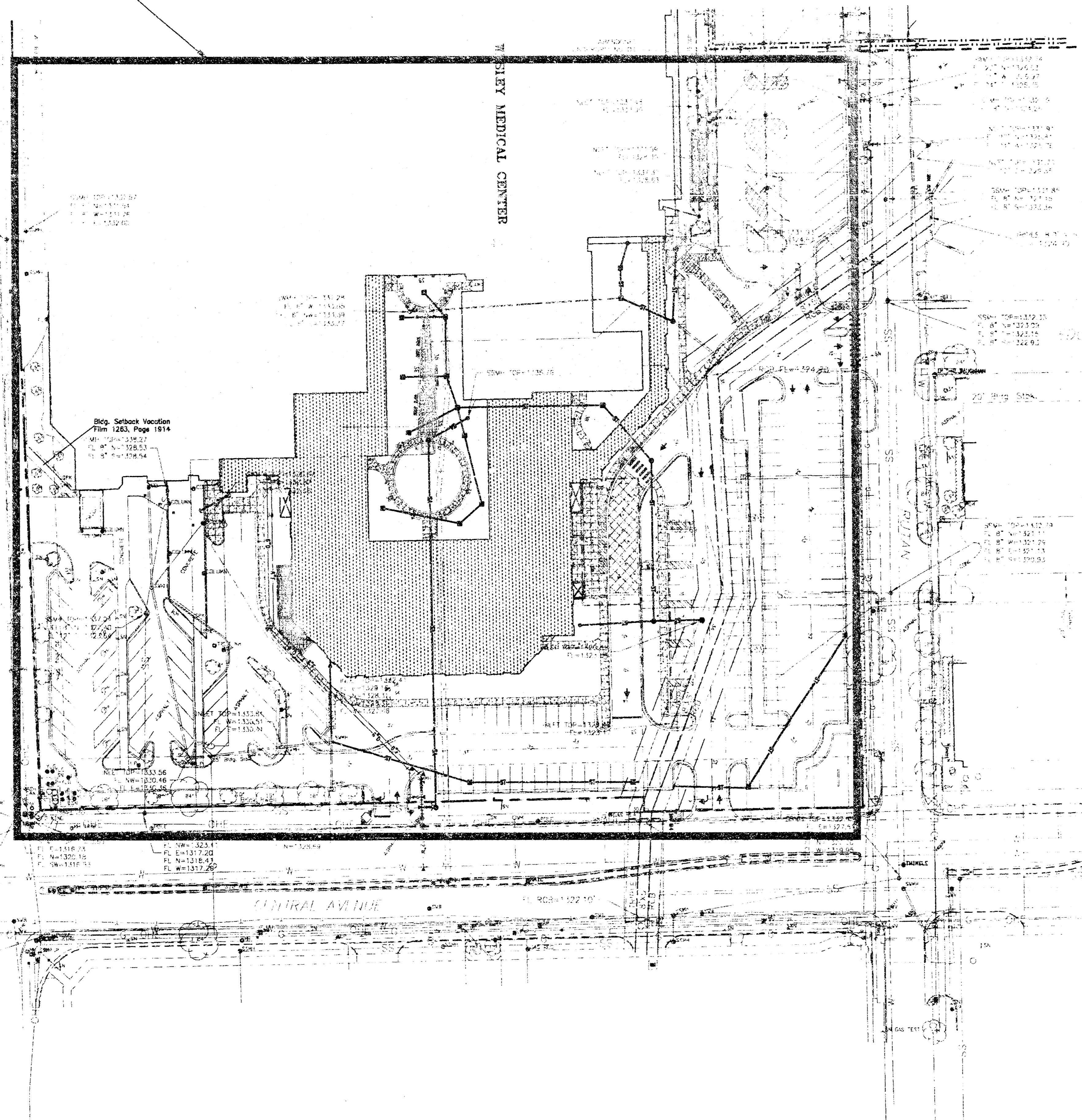

## INDEX TO DRAWINGS

SHEET NO.	DESCRIPTION
C1.0	COVER SHEET
C2.0	DETAILS & NOTES
C3.0-C3.1	GRADING / DRAINAGE PLAN & PROFILE
C4.0	SANITARY SEWER PLAN & PROFILE

## BENCHMARKS

- " cut Northwest corner of traffic signal base Southeast corner Hillside & Murdock.  
Elevation = 150.135'
- " cut on crosswalk signal base, Northeast corner of Hillside & Central.  
Elevation = 144.096'
- " cut Northeast corner of light pole base at the Southeast corner of Hillside & Murdock.  
Elevation = 145.32'
- " cut on the East end of concrete hand rail North side of Central  
±164' West of Ruton.  
Elevation = 145.506'
- Disk in North end of ROBC  
Elevation = 145.376'
- " on top of curb, North return Southeast corner Lot 3, Wesley Medical  
3rd Addition.  
Elevation = 154.551'

SS Booked  
4/20/02  
RDL PDF

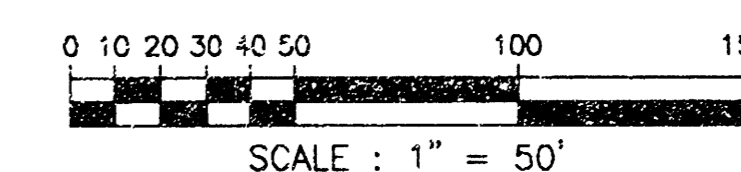

**LITTLEJOHN ENGINEERING**  
ENGINEERING AND LAND PLANNING  
1025 Twenty-First Avenue South Nashville, Tennessee 37212 Phone 615-385-4144

REVISIONS  
DATE  
MARCH 14, 2002

GOULD TURNER GROUP, P.C.  
ARCHITECTS & PLANNERS  
4400 HARDING ROAD, SUITE 1000  
NASHVILLE, TENNESSEE 37205

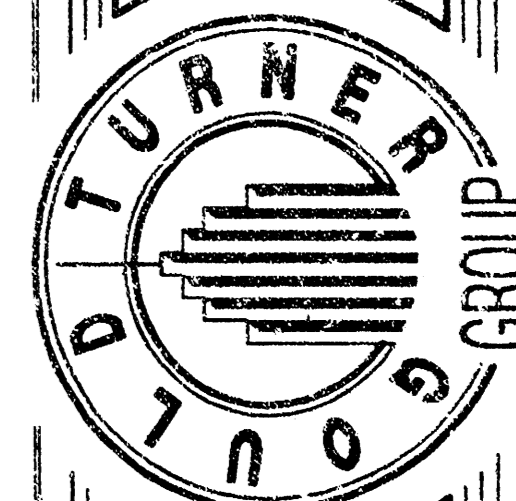

WESLEY MEDICAL CENTER  
ICU ADDITION & RENOVATION  
WICHITA, KANSAS  
OWNER'S PROJECT # 1221PPS(607861)

COVER SHEET  
C1.0

18 14 03 19

**NOTE TO CONTRACTOR**  
INSPECTION AND TESTING FOR THIS PROJECT IS TO BE PROVIDED BY A LICENSED CONSULTING ENGINEER FIRM UNDER CONTRACT WITH THE OWNER/DEVELOPER. SAID INSPECTION TO BE IN ACCORDANCE WITH THE CITY OF WICHITA STANDARD CONSTRUCTION ENGINEERING PRACTICES AND CERTIFIED BY A LICENSED PROFESSIONAL ENGINEER. NO WORK SHALL BE PERFORMED IN DEDICATED EASEMENTS OR THE PUBLIC RIGHT-OF-WAY BY THE CONTRACTOR WITHOUT SUCH INSPECTION NOR SHALL ANY WORK BE COMMENCED IN DEDICATED EASEMENTS OR PUBLIC RIGHT-OF-WAY WITHOUT WRITTEN AUTHORIZATION BY THE CITY ENGINEER.

APPROVED AS NOTED  
CITY ENGINEER OF WICHITA

SANITARY SEWERS VRH 4/15/02  
STORM SEWERS VRH 4/15/02  
DRIVEWAY APPROACHES \_\_\_\_\_  
WATER MAINS \_\_\_\_\_  
PAVING \_\_\_\_\_

LUCCOV.DWG



~~EXIST. MANHOLE REPLACE CASTING W/AIR-TIGHT MANHOLE A-1 STA. 0+00 T.C. 1330.76 INVO. 1318.03 (ASSUMED) CONTRACTOR TO FIELD VERIFY DEPTH. N:1669052.781 E:1660575.304 BEGIN LINE A~~

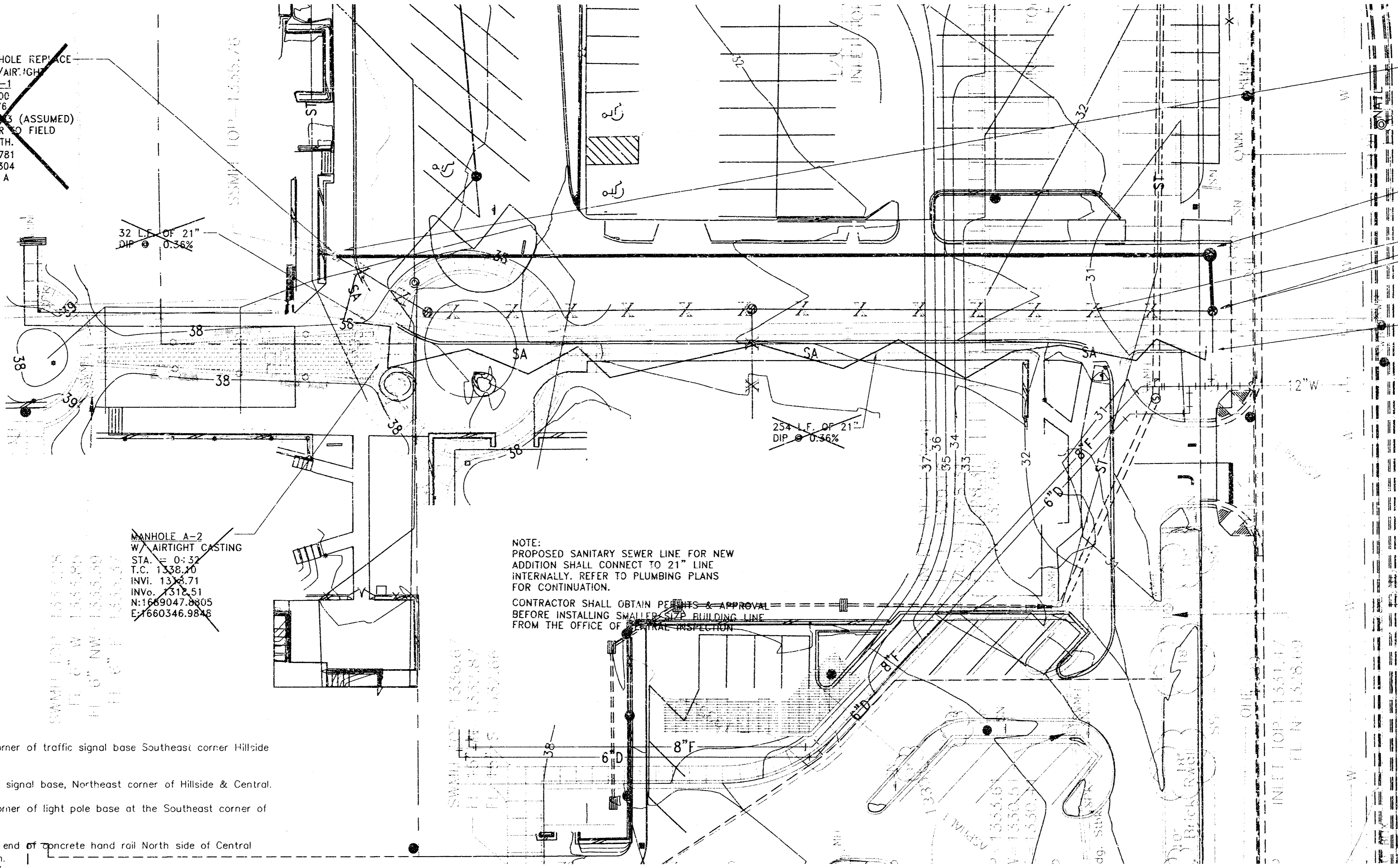

MANHOLE A-1  
STA 2+84.1 EXISTING MANHOLE  
TOP = 1337.73 AB  
FL IN = 1319.65 AB  
FL OUT = 1319.37 AB U  
N:1661257.71  
E:1661197.53

MANHOLE A-3  
STA 0+16.4 INSTALL MANHOLE  
TOP = 1330.36 AB  
FL IN = 1318.30 AB  
FL OUT = 1318.10 AB  
N:1668889.25  
E:1661197.53

MANHOLE STA 0+00 EXISTING MANHOLE  
TOP = 1330.36 AB  
FL IN = 1318.00 AB  
FL OUT = 1317.33 AB

EXISTING SANITARY SEWER MANHOLE AND LINE TO BE REMOVED. NEW SANITARY SEWER LINE SHALL BE OPERATIONAL PRIOR TO TAKING THE EXISTING LINE OUT OF SERVICE.

MANHOLE A-2  
STA = 0+32  
T.C. 1330.20  
INVO. 1318.51  
N:1669047.8805  
E:1660346.9848

NOTE:  
PROPOSED SANITARY SEWER LINE FOR NEW ADDITION SHALL CONNECT TO 21" LINE INTERNALLY. REFER TO PLUMBING PLANS FOR CONTINUATION.  
CONTRACTOR SHALL OBTAIN PERMITS & APPROVAL BEFORE INSTALLING SMALLER SIZE BUILDING LINE FROM THE OFFICE OF PUBLIC INSPECTION

**BENCHMARKS**

- cut Northwest corner of traffic signal base Southeast corner Hillside & Murdock.  
Elevation = 150.135'
- cut on crosswalk signal base, Northeast corner of Hillside & Central.  
Elevation = 144.096'
- cut Northeast corner of light pole base at the Southeast corner of Hillside & Murdock.  
Elevation = 145.32'
- cut on the East end of concrete hand rail North side of Central ±164' West of Ruten.  
Elevation = 145.506'
- Disk in North end of RCBC ±71' North of Edgenort, East side of Ruten.  
Elevation = 145.376'
- cut on top of curb, North return Southeast corner Lot 3, Wesley Medical 3rd Addition.  
Elevation = 154.551'

**EXISTING FEATURES LEGEND**

- |                                 |                                 |
|---------------------------------|---------------------------------|
| ●GM - GAS METER                 | ●POLE - POLE                    |
| ●YLD - YARD LIGHT 0'-2'         | — G - GATE                      |
| ●ELEC MH - ELECTRIC MANHOLE     | △ - SECTION CORNER              |
| ●SIG LIGHT - SIGNAL LIGHT       | ●SPK - SPRINKLER HEAD           |
| ●DN - TREE AND DIAMETER         | — RW - RETAINING WALL           |
| ●IN - TREE AND DIAMETER         | ●LP - LIGHT POLE 10'-HIGHER     |
| ●SN - SIGN                      | ●FH - FIRE HYDRANT              |
| ●IP - IRON BAR                  | ●WV - WATER VALVE               |
| ●O - BUSH                       | ●WM - WATER METER               |
| ●PP - POWER POLE AND DEADMAN    | ●ICV - IRRIGATION CONTROL VALVE |
| ●E - ELECTRIC BOX               | ■ - GRATE INLET                 |
| ●CO - CLEANOUT                  | ■TR - TELEPHONE RISER           |
| — E - UNDERGROUND ELECTRIC LINE | — SPS - STORM SEWER PIPE        |
| — X - FENCE                     | — W - WATER LINE                |
| ●BM - BENCHMARK                 | — S - SANITARY SEWER LINE       |
| ●SWMH - STORM WATER MANHOLE     | — G - GAS LINE                  |
| ●SSMH - SANITARY SEWER MANHOLE  | — T - TELEPHONE LINE            |
| ●SWB - TELEPHONE MANHOLE        | — I - INLET                     |
| — B - BUILDINGS                 | — RB - ROW OF BUSHES            |
| — OHE - OVERHEAD ELECTRIC LINE  | ●RD - ROOF DRAIN                |
| — P - POST                      | ●LP - LIGHT POLE 2'-10"         |
| — X - CHISELED "X" CUT          | — OHTV - OVERHEAD CABLE TV LINE |
| — O - OVERHANG                  | ●MS - MONITORING SENSOR         |

**PROPOSED FEATURES LEGEND**

- |                                   |        |
|-----------------------------------|--------|
| DOMESTIC SERVICE                  | — 2" W |
| FIRE SERVICE                      | — 6" F |
| GAS LINE                          | — G    |
| WATER LINE WITH 90° THRUST BLOCK  | — T    |
| SANITARY SEWER LINE WITH CLEANOUT | — S    |
| NEW FIRE HYDRANT                  | — H    |
| UNDERGROUND ELECTRIC              | — UGE  |

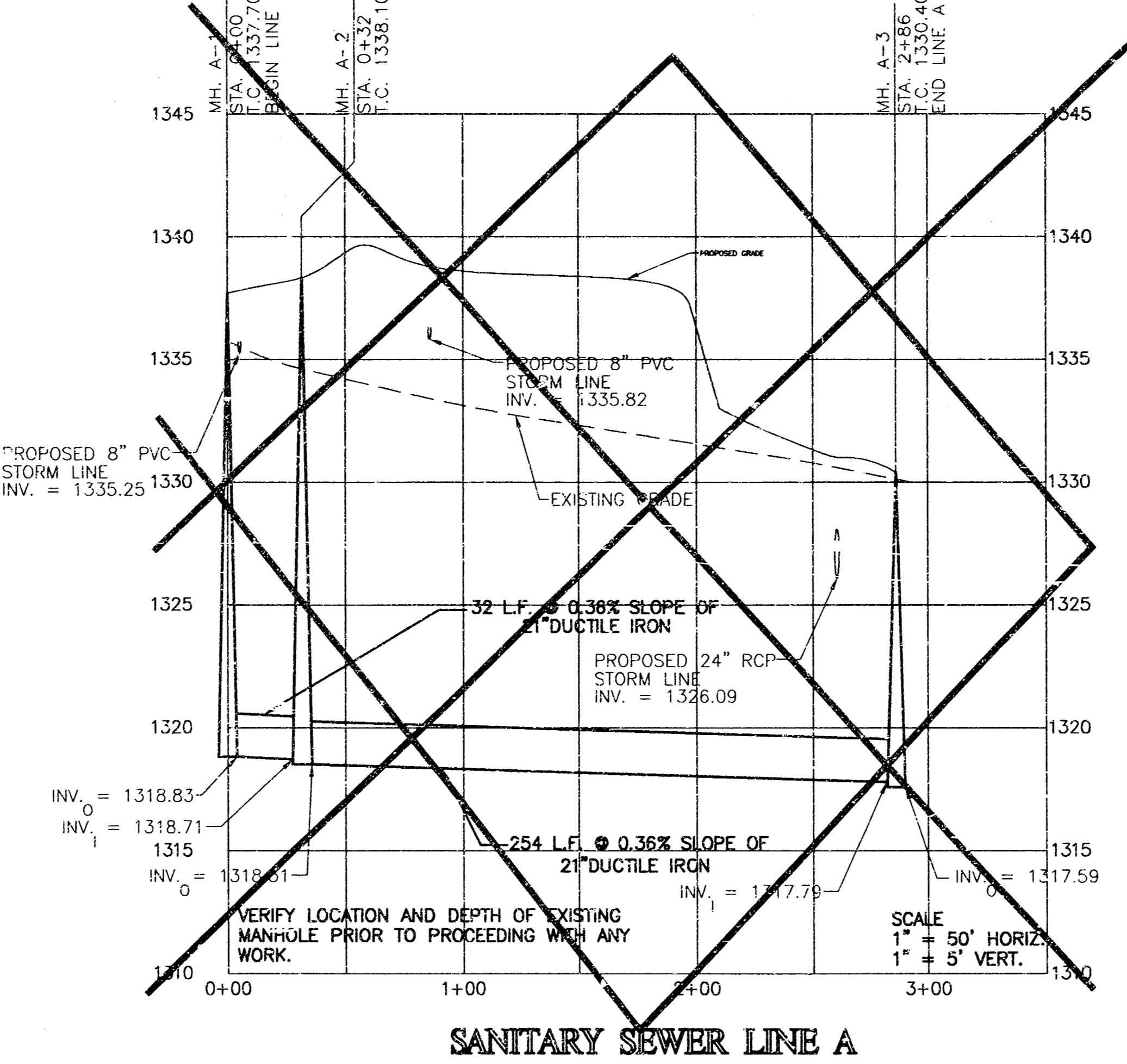

NOTE:  
THE CONTRACTOR SHALL FIELD VERIFY THE EXACT HORIZONTAL AND VERTICAL LOCATION OF THE EXISTING SANITARY SEWER MANHOLE PRIOR TO COMMENCEMENT OF ANY CONSTRUCTION. REPORT ANY DISCREPANCIES TO THE ENGINEER.

**PRIVATE SS FOR WESLEY MEDICAL CENTER ICU ADDITION AND RENOVATION**

1221PPS

NOTE  
SEE SHEET C2.0 FOR GENERAL NOTES.

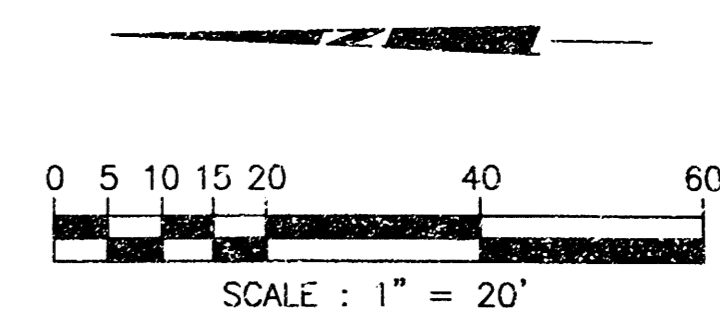

AS BUILT DEC 2003

**LITTLEJOHN ENGINEERING**  
ENGINEERING AND LAND PLANNING  
1895 Twenty-Fifth Avenue South Nashville, Tennessee 37212 Phone 615-385-1144

REVISIONS:  
DATE: MARCH 14, 2002

**GOULD TURNER GROUP, P.C.**  
ARCHITECTS & PLANNERS  
4400 HARDING ROAD, SUITE 1000  
NASHVILLE, TENNESSEE 37205

**WESLEY MEDICAL CENTER ICU ADDITION & RENOVATION**  
WICHITA, KANSAS  
OWNER: 3160B001  
LE# 2018E

**TURNER GROUP**

SANITARY SEWER PLAN & PROFILE  
C4.0

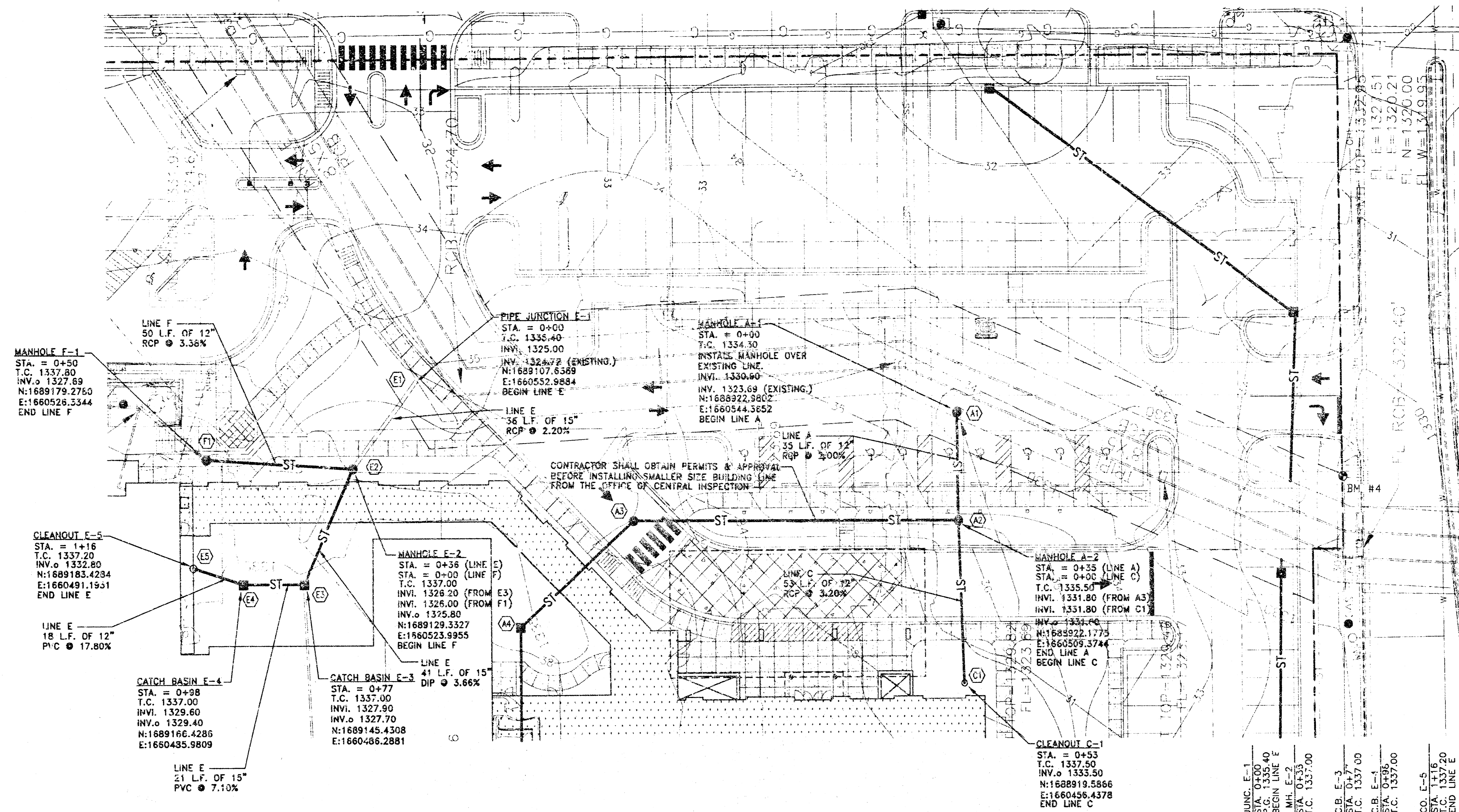

**EXISTING FEATURES LEGEND**

● G.M.	● G.M.	● G.M.	● G.M.
○ Y.L.C.	○ Y.L.C.	○ Y.L.C.	○ Y.L.C.
○ E.M.H.	○ E.M.H.	○ E.M.H.	○ E.M.H.
○ S.L.	○ S.L.	○ S.L.	○ S.L.
○ T.D.	○ T.D.	○ T.D.	○ T.D.
○ S.I.	○ S.I.	○ S.I.	○ S.I.
○ R.B.	○ R.B.	○ R.B.	○ R.B.
○ P.	○ P.	○ P.	○ P.
○ B.	○ B.	○ B.	○ B.
○ P.P.	○ P.P.	○ P.P.	○ P.P.
○ E.D.	○ E.D.	○ E.D.	○ E.D.
○ C.	○ C.	○ C.	○ C.
— E —	— E —	— E —	— E —
— X —	— X —	— X —	— X —
○ B.M.	○ B.M.	○ B.M.	○ B.M.
○ S.W.M.H.	○ S.W.M.H.	○ S.W.M.H.	○ S.W.M.H.
○ S.S.M.H.	○ S.S.M.H.	○ S.S.M.H.	○ S.S.M.H.
○ S.W.B.	○ S.W.B.	○ S.W.B.	○ S.W.B.
— B —	— B —	— B —	— B —
— O.H.E. —	— O.H.E. —	— O.H.E. —	— O.H.E. —
○ P.	○ P.	○ P.	○ P.
— X —	— X —	— X —	— X —
— O.H.W. —	— O.H.W. —	— O.H.W. —	— O.H.W. —
○ M.S.	○ M.S.	○ M.S.	○ M.S.

**BENCHMARKS**

1. " cut Northwest corner of traffic signal base Southeast corner Hillside & Murdock. Elevation = 150.135'
2. " cut on crosswalk signal base, Northeast corner of Hillside & Central. Elevation = 144.096'
3. " cut Northeast corner of light pole base at the Southeast corner of Hillside & Murdock. Elevation = 145.32'
4. " cut on the East end of concrete hand rail North side of Central ±164' West of Ruton. Elevation = 145.506'
5. Disk in North end of RCBC ±71' North of Edgemont, East side of Ruton. Elevation = 145.376'
6. " on top of curb, North return Southeast corner Lot 3, Wesley Medical 3rd Addition. Elevation = 154.55'

**PROPOSED FEATURES LEGEND**

— S.P. —	— S.P. —	— S.P. —	— S.P. —
— P.C. —	— P.C. —	— P.C. —	— P.C. —
— D.S. —	— D.S. —	— D.S. —	— D.S. —
— F.S. —	— F.S. —	— F.S. —	— F.S. —
— G.L. —	— G.L. —	— G.L. —	— G.L. —
— W.L. —	— W.L. —	— W.L. —	— W.L. —
— S.S.L. —	— S.S.L. —	— S.S.L. —	— S.S.L. —
— N.F.H. —	— N.F.H. —	— N.F.H. —	— N.F.H. —
— U.E. —	— U.E. —	— U.E. —	— U.E. —

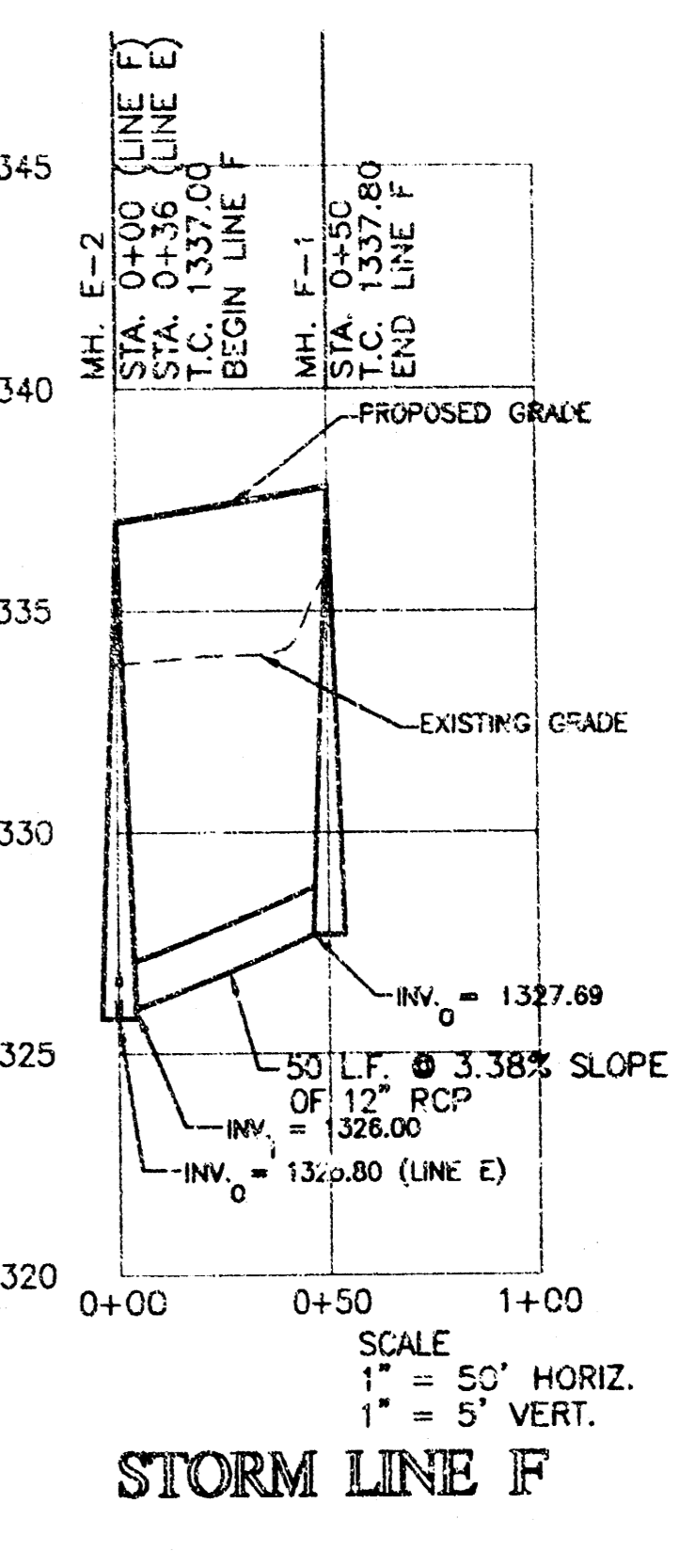
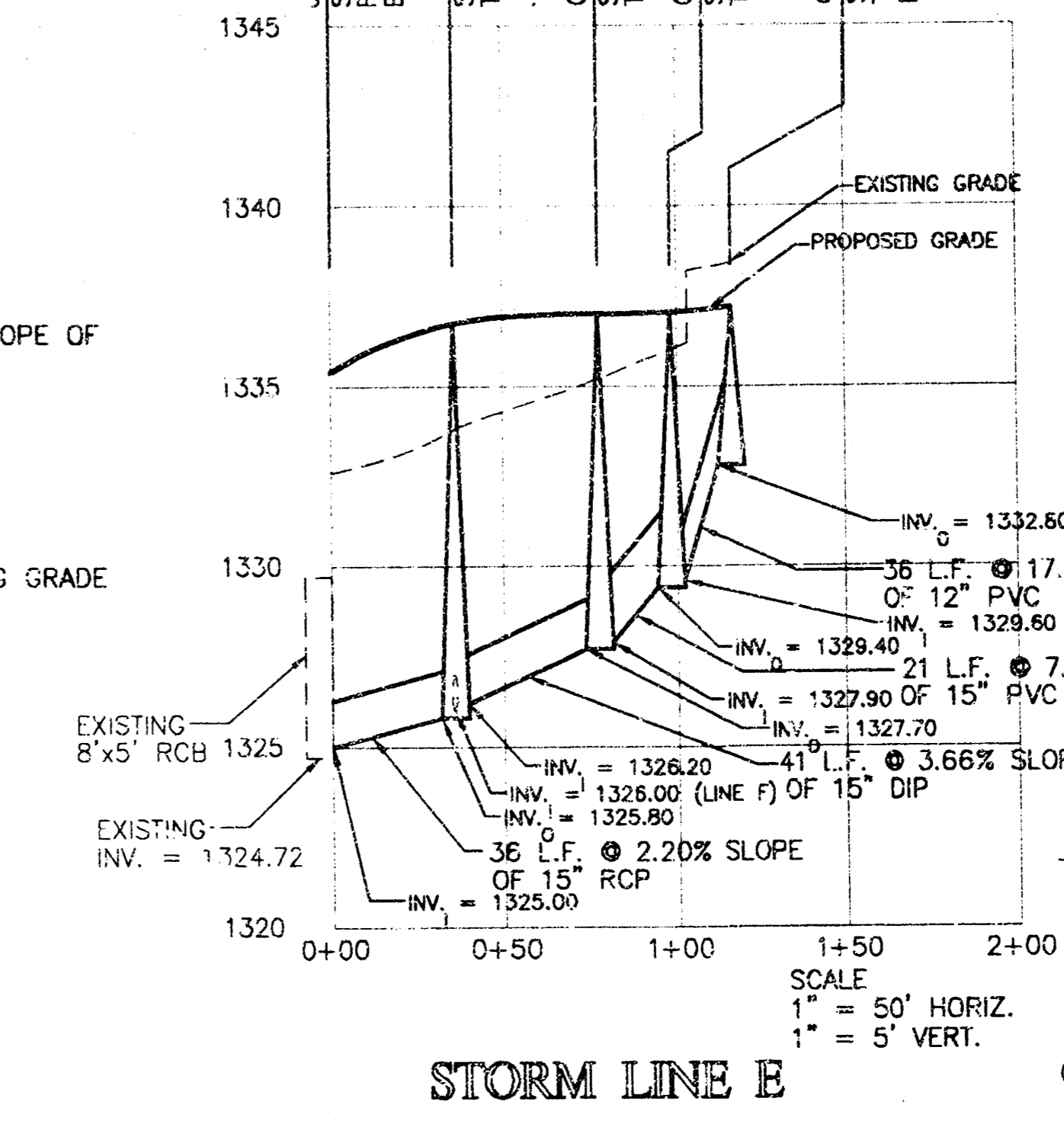
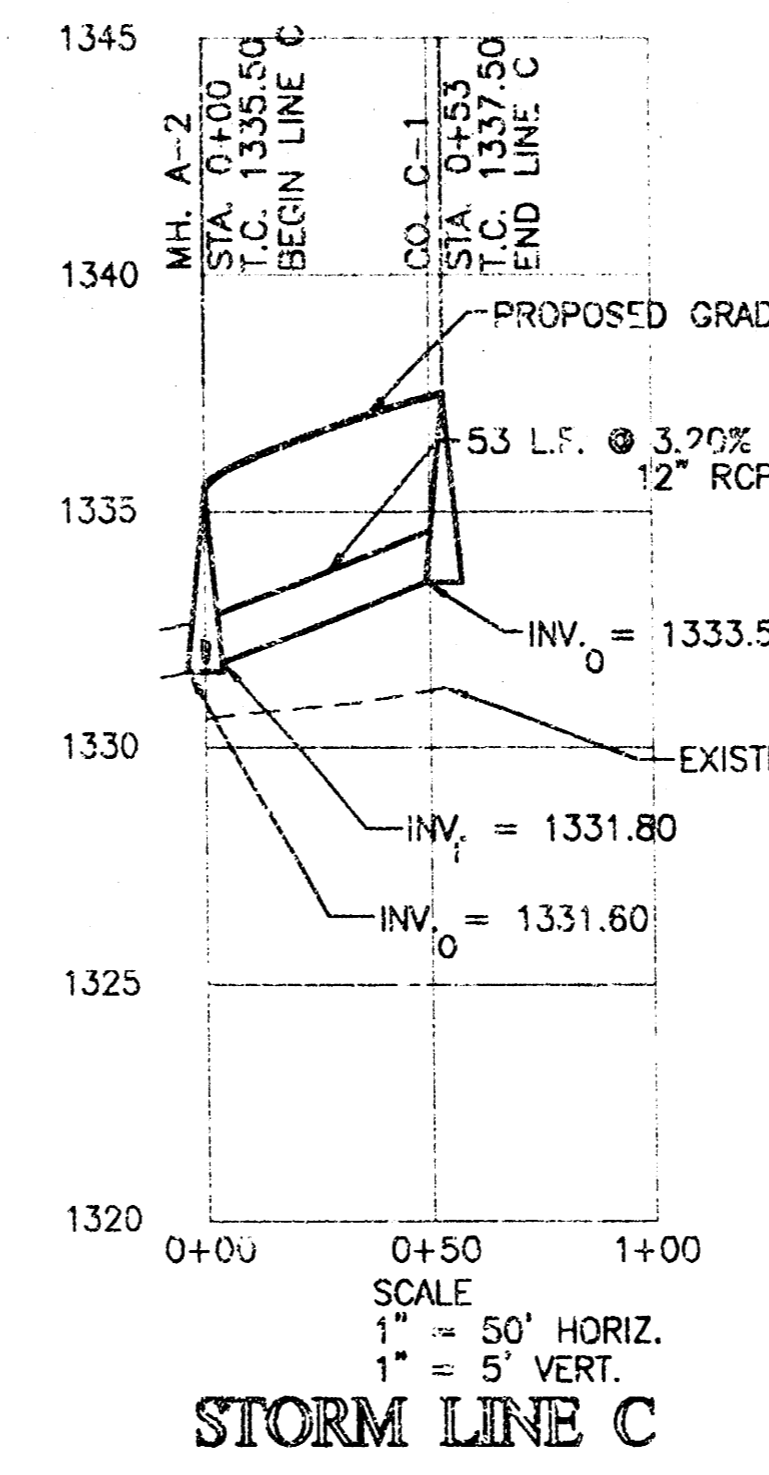
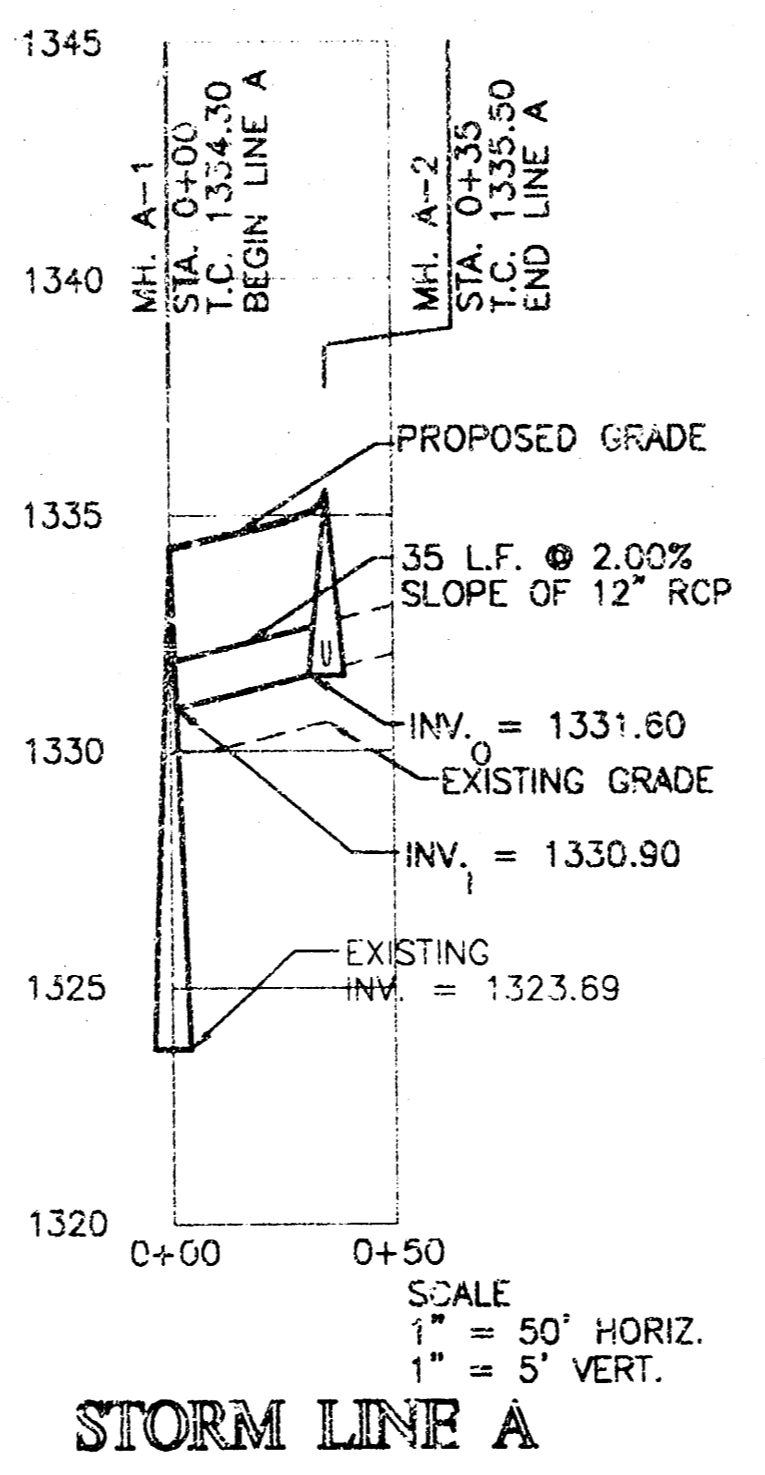

**NOTE**  
SEE SHEET C2.0 FOR GENERAL NOTES.

SCALE: 1" = 20'

**LITTLEJOHN ENGINEERING**  
ENGINEERING AND LAND PLANNING  
195 Twenty-First Avenue South Nashville, Tennessee 37203 Phone 615-385-6144

REVISIONS:  
DATE  
MARCH 14, 2002

**GOULD TURNER GROUP, P.C.**  
ARCHITECTS & PLANNERS  
4400 HARRISON ROAD, SUITE 1002  
NASHVILLE, TENNESSEE 37205

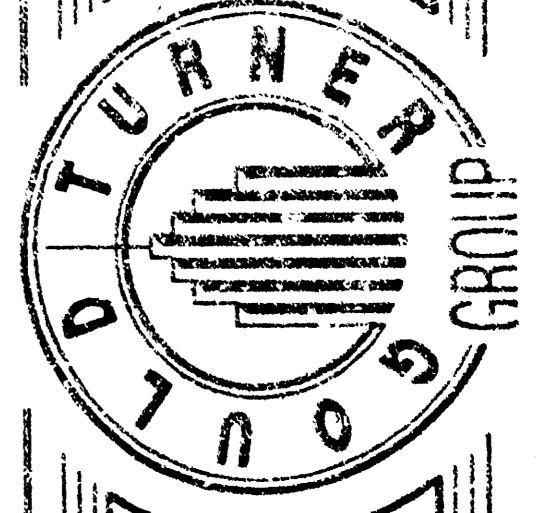

**WESLEY MEDICAL CENTER**  
ICU ADDITION & RENOVATION  
WICHITA, KANSAS  
OWNER'S SUBMITTAL  
1308 2018

GRADING & DRAINAGE  
PLAN & PROFILE  
**C3.0**

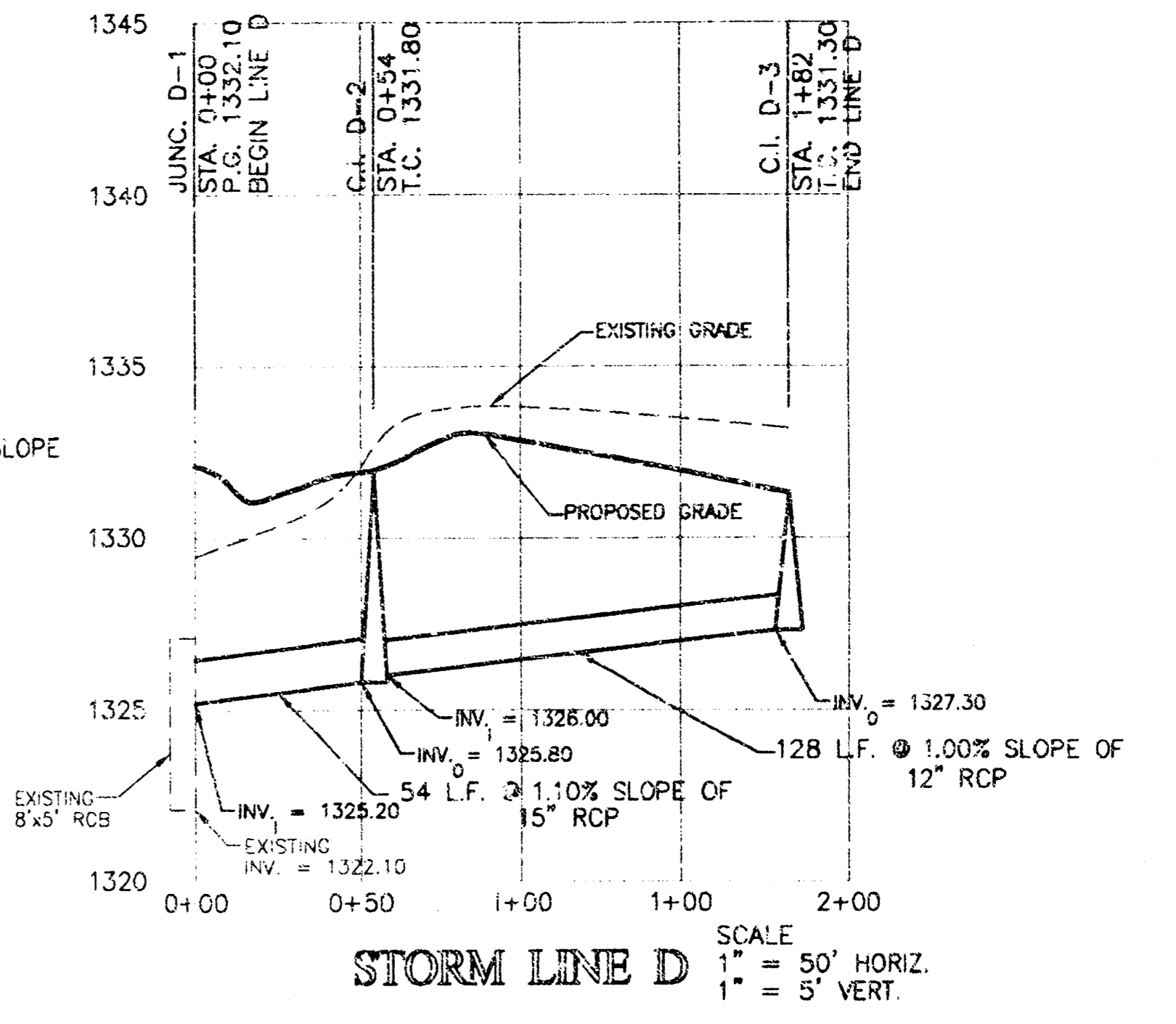
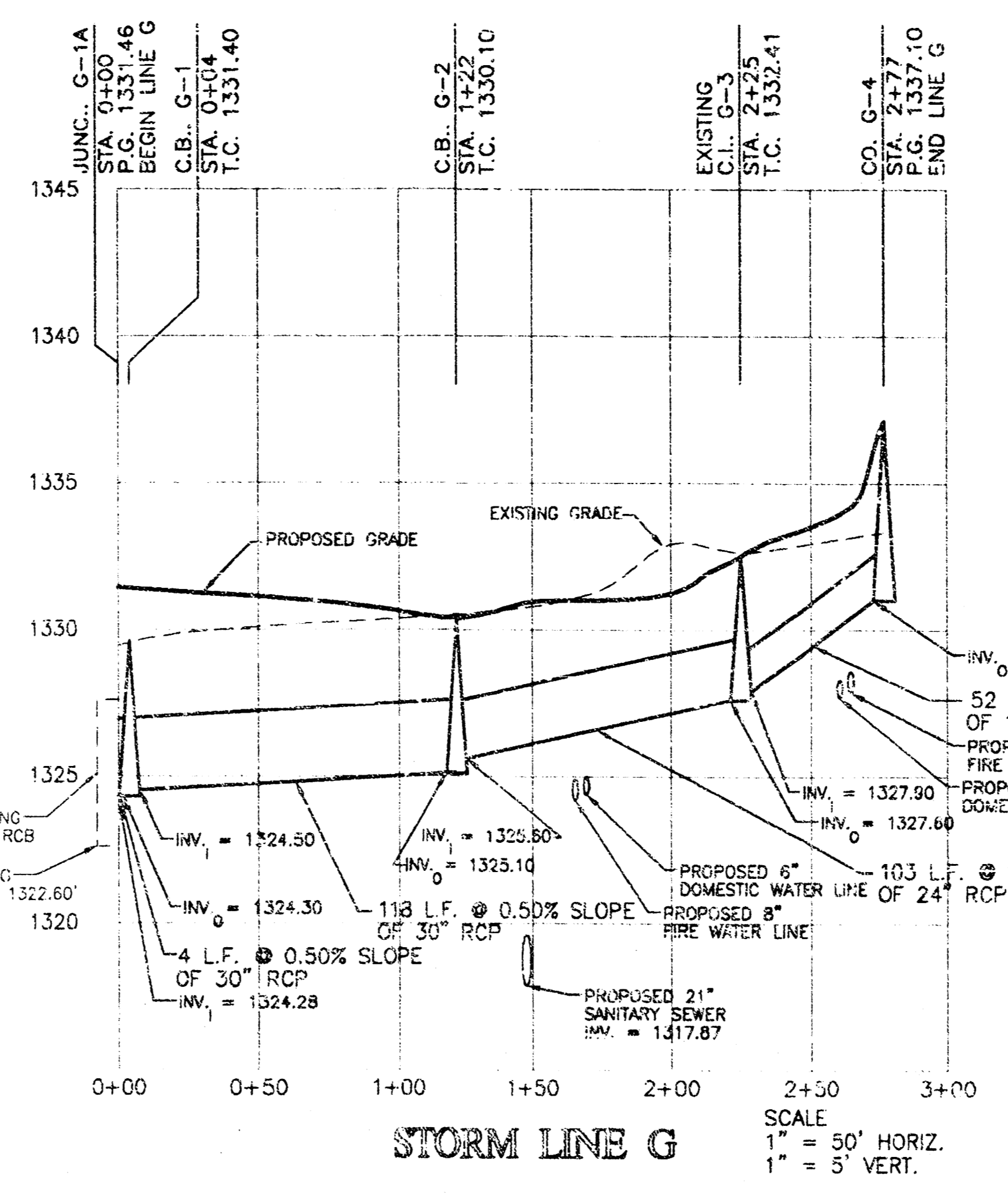
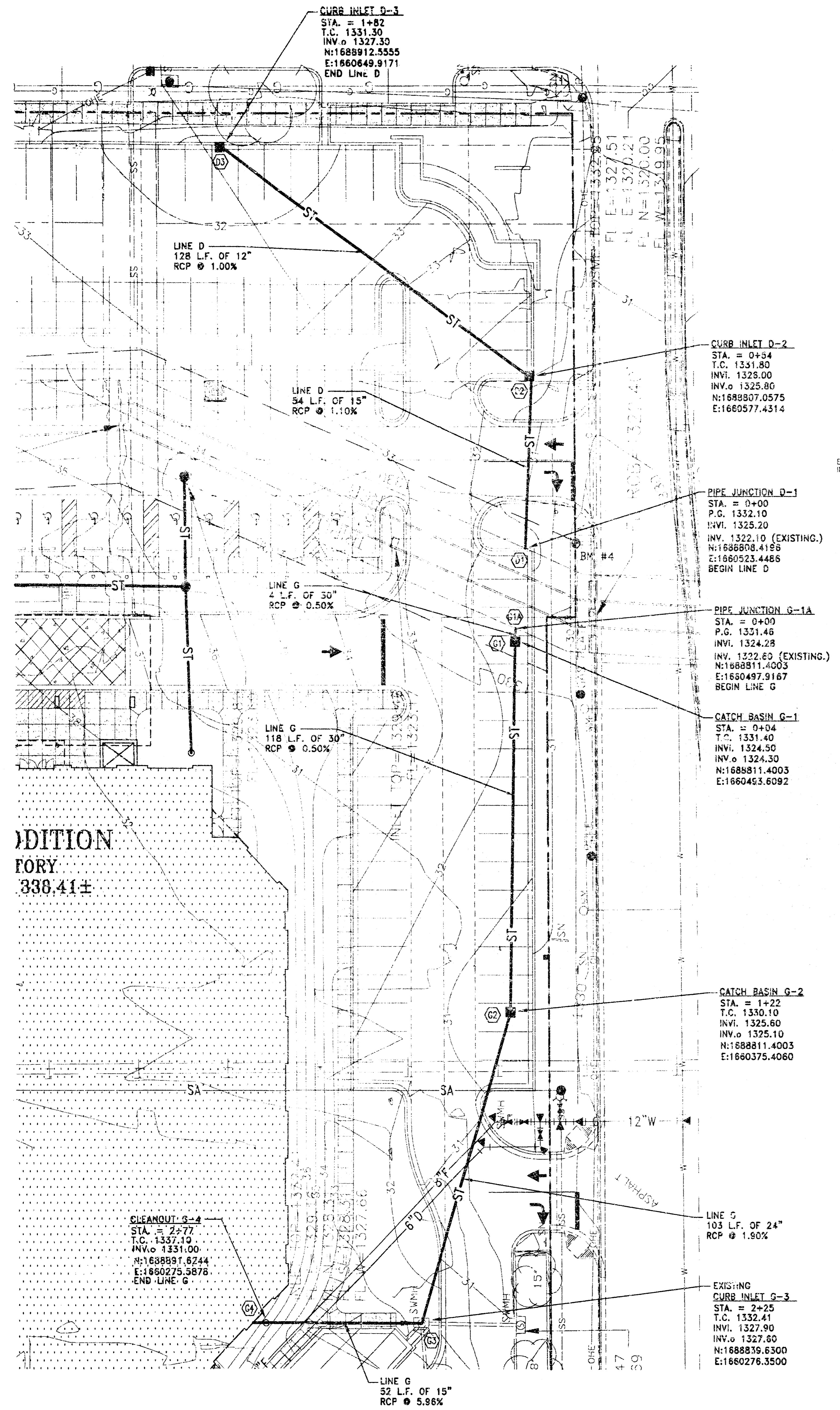

**PROPOSED FEATURES LEGEND**

- STORM PIPE & INLET
- PROPOSED CONTOUR
- DRAINAGE STRUCTURE
- DOMESTIC SERVICE
- FIRE SERVICE
- GAS LINE
- WATER LINE WITH 90° THRUST BLOCK
- SANITARY SEWER LINE WITH CLEANOUT
- NEW FIRE HYDRANT
- UNDERGROUND ELECTRIC

**EXISTING FEATURES LEGEND**

- BM BENCHMARK
- C/S CURB INLET
- E/M ELECTRIC MANHOLE
- S/L SIGNAL LIGHT
- T/D TREE AND DIAMETER
- S/D SIGN
- R/B RAIL BAR
- B/B BUSH
- P/W POWER POLE AND DEADEND
- E/B ELECTRIC BOX
- C/F CLEANOUT
- U/E UNDERGROUND ELECTRIC LINE
- F/F FENCE
- B/B BENCHMARK
- S/W STORM WATER MANHOLE
- S/SW SANITARY SEWER MANHOLE
- T/M TELEPHONE MANHOLE
- B/B BUILDINGS
- O/E OVERHEAD ELECTRIC LINE
- P/ POST
- C/C OVERHEAD "X" CURB
- O/H OVERHANG
- P/R POLE
- T/S TRAFFIC SIGNAL MANHOLE
- S/C SECTION CORNER
- S/H SPRINKLER HEAD
- R/W RETAINING WALL
- L/P LIGHT POLE TO HIGHWAY
- F/P FIRE PIPING
- W/V WATER VALVE
- W/M WATER METER
- I/CV IRRIGATION CONTROL VALVE
- G/I GRATE INLET
- T/P TELEPHONE RISER
- S/P STORM SEWER PIPE
- W/W WATER LINE
- S/S SANITARY SEWER LINE
- G/G GAS LINE
- T/T TELEPHONE LINE
- I/I INLET
- R/D ROW OF DISHES
- R/D ROOF DRAIN
- R/P RIGHT POLE 2'-10"
- O/CV OVERHEAD CABLE TV LINE
- M/S MONITORING SENSOR

**BENCHMARKS**

1. " cut Northwest corner of traffic signal base Southeast corner Hillside & Murdock. Elevation = 150.135'
2. " cut on crosswalk signal base, Northeast corner of Hillside & Central. Elevation = 144.096'
3. " cut Northeast corner of light pole base at the Southeast corner of Hillside & Murdock. Elevation = 145.32'
4. " cut on the East end of concrete hand rail North side of Central ±164' West of Rutan. Elevation = 145.506'
5. Disk in North end of RCBC Elevation = 145.378 ±71' North of Edgemont, East side of Rutan.
6. " on top of curb, North return Southeast corner Lot 3, Wesley Medical 3rd Addition. Elevation = 154.551'

**NOTE**

SEE SHEET C2.0 FOR GENERAL NOTES.

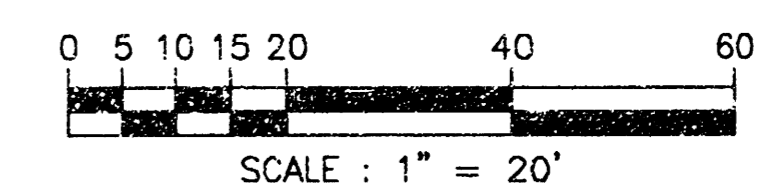

**LITTLEJOHN ENGINEERING**  
 1885 Twenty-Third Avenue South Nashville, Tennessee 37212 Phone 615-386-4144

REVISIONS:  
 DATE: MARCH 14, 2007

**GOULD TURNER GROUP, P.C.**  
 ARCHITECTS & PLANNERS  
 4400 HARRIS ROAD, SUITE 1000  
 NASHVILLE, TENNESSEE 37205

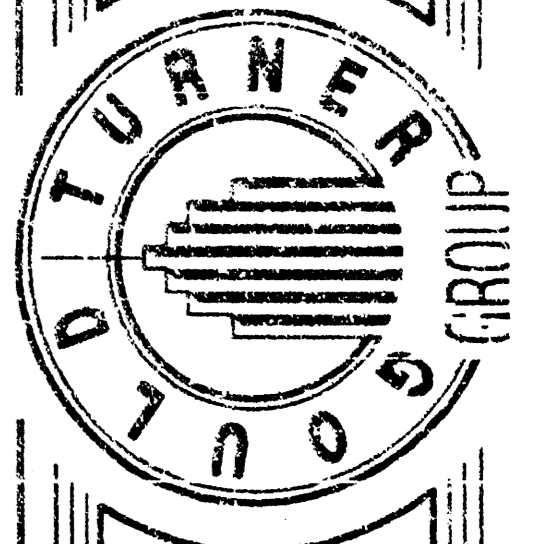

**WESLEY MEDICAL CENTER**  
 ICU ADDITION & RENOVATION  
 WICHITA, KANSAS  
 OWNED BY: J. THOMAS  
 LEW 2006



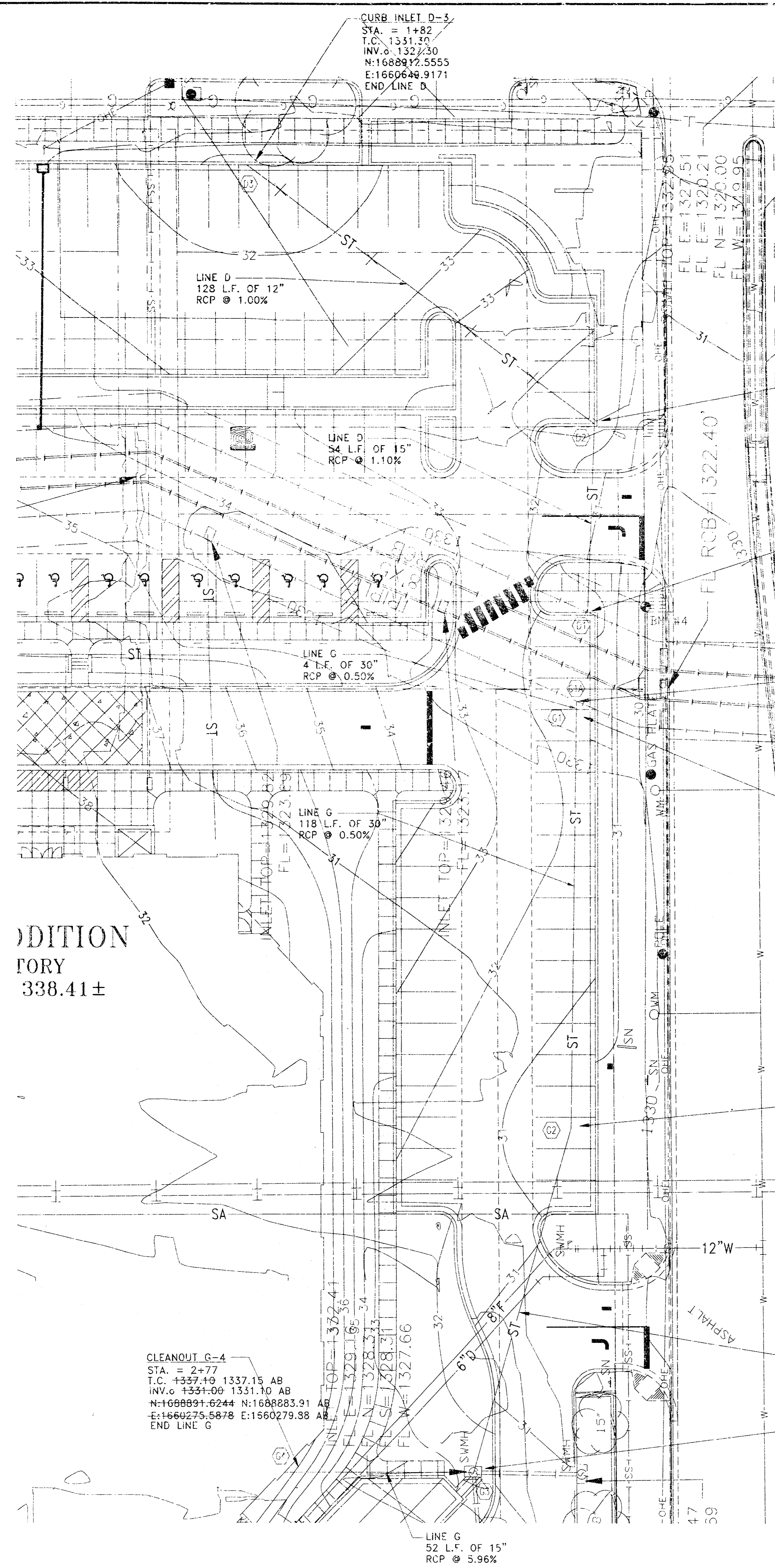

ADDITION  
FOR  
338.41±

**CURB INLET D-3**  
STA. = 1+82  
T.C. = 1331.40  
INV. = 1327.30  
N:1688912.5553  
E:1660648.9171  
END LINE D

**CURB INLET D-2**  
STA. = 0+54  
T.C. = 1331.60 1331.64 AB  
INV. = 1326.00  
INV. = 1325.80 1326.14 AB  
N:1688897.9575 N:1688807.97 AB  
E:1660577.4514 E:1660578.28 AB

**PIPE JUNCTION D-1**  
STA. = 0+00  
P.G. = 1332.10  
INV. = 1325.20  
INV. = 1322.10 (EXISTING.)  
N:1688308.4198  
E:1660523.4486  
BEGIN LINE D

**PIPE JUNCTION G-1A**  
STA. = 0+00  
P.G. = 1331.46  
INV. = 1324.28  
INV. = 1322.60 (EXISTING.)  
N:1688811.4003  
E:1660497.9167  
BEGIN LINE G

**CATCH BASIN G-1**  
STA. = 0+04  
T.C. = 1331.40 1331.42 AB  
INV. = 1324.30 1323.57 AB  
INV. = 1324.30 1323.57 AB  
N:1688811.4003 N:1688816.74 AB  
E:1660493.6992 E:1660486.46 AB

**CATCH BASIN G-2**  
STA. = 1+22  
T.C. = 1330.40 1330.20 AB  
INV. = 1325.60 1324.25 AB  
INV. = 1325.10 1323.95 AB  
N:1688811.4003 N:1688813.50 AB  
E:1660375.4060 E:1660372.77 AB

**CLEANOUT G-4**  
STA. = 2+77  
T.C. = 1337.10 1337.15 AB  
INV. = 1331.00 1331.10 AB  
N:1688891.6244 N:1688883.91 AB  
E:1660275.5878 E:1560279.38 AB  
END LINE G

**LINE G**  
103 L.F. OF 24"  
RCP @ 1.90%

**EXISTING CURB INLET G-3**  
STA. = 2+25  
T.C. = 1332.41 1332.24 AB  
INV. = 1327.90 1327.79 AB  
INV. = 1327.60 1327.59 AB  
N:1688839.6300 N:1688839.75 AB  
E:1660276.3500 E:1660275.94 AB

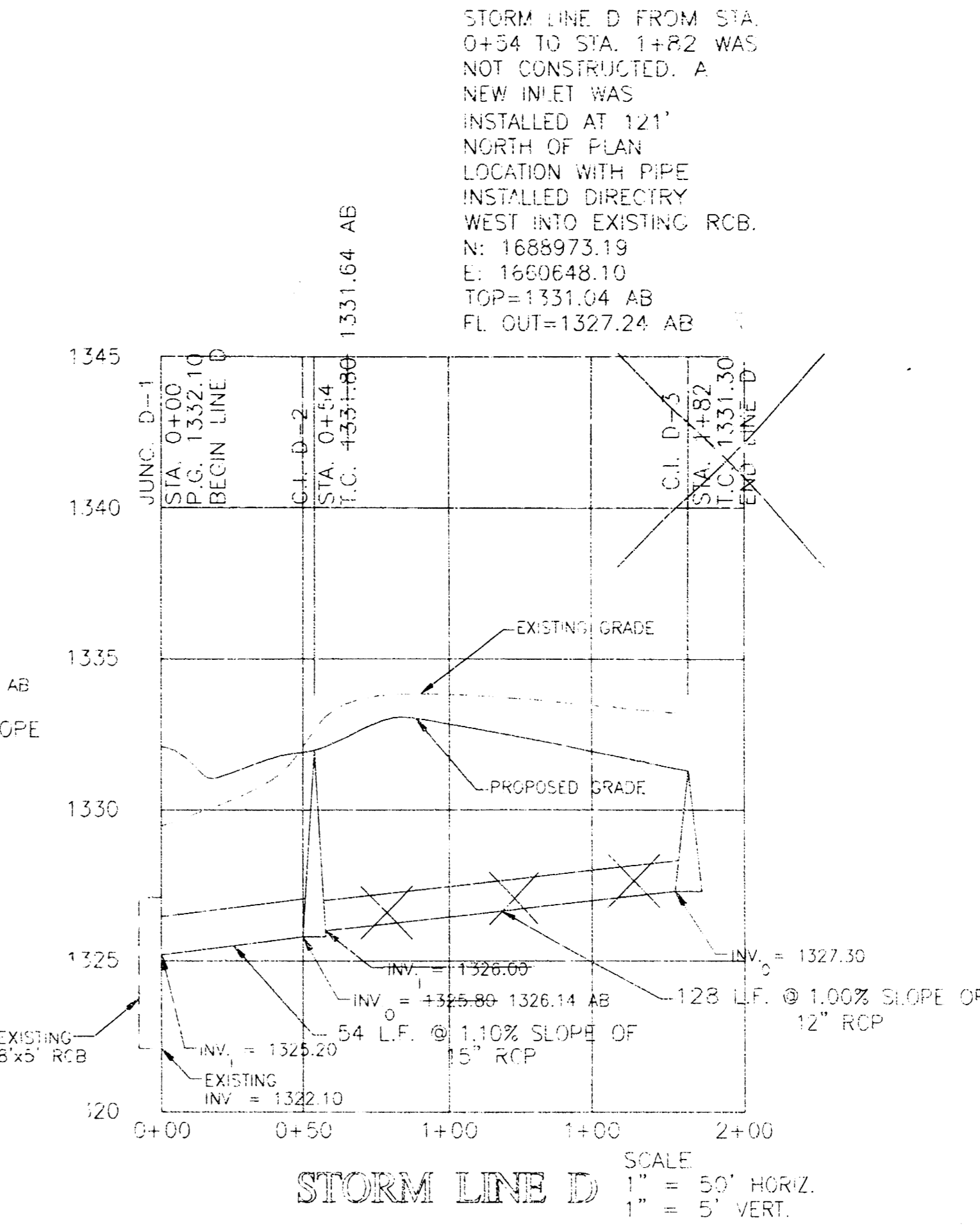
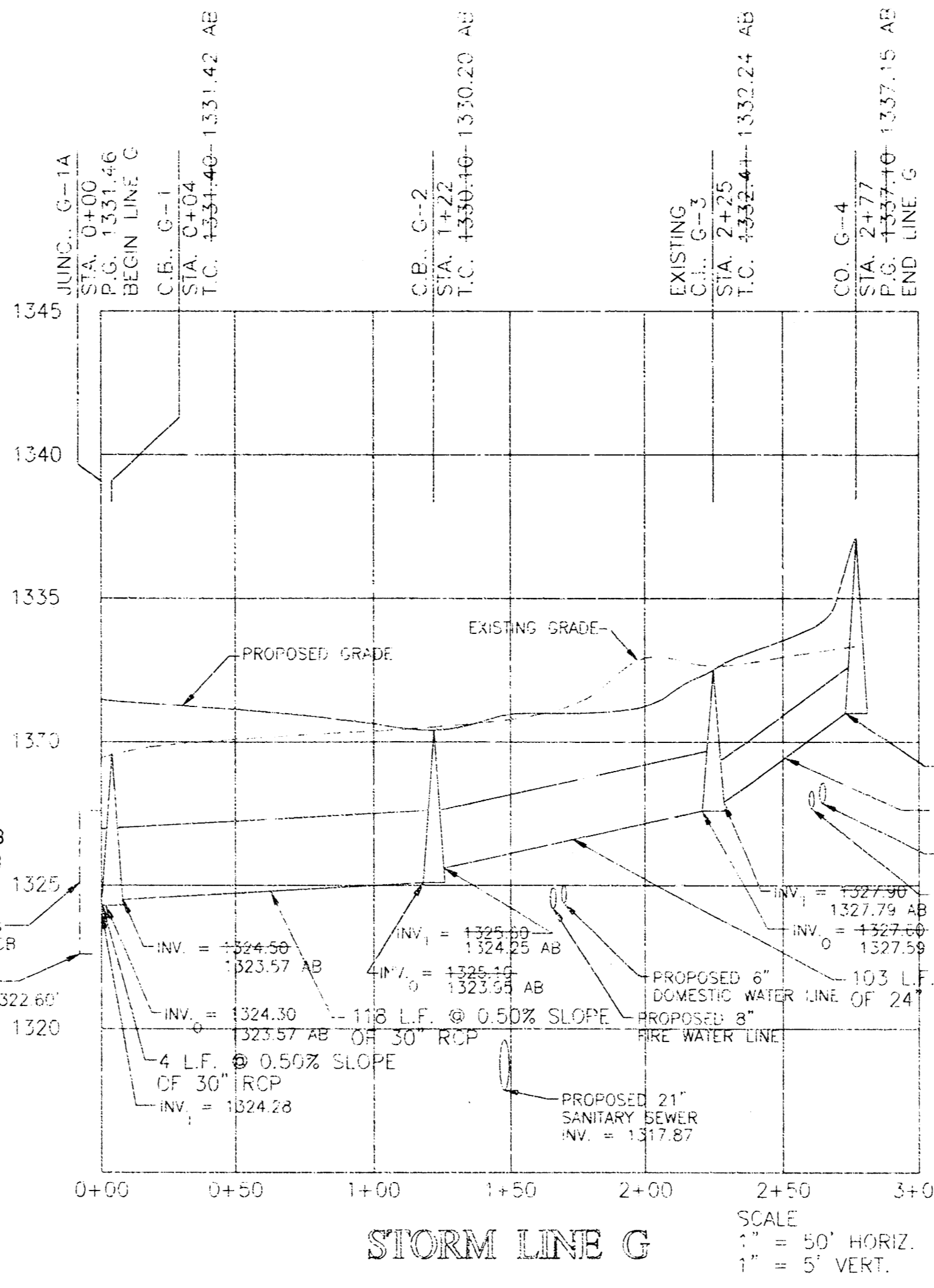

**PROPOSED FEATURES LEGEND**

- STORM PIPE & INLET
- PROPOSED CONTOUR
- DRAINAGE STRUCTURE
- DOMESTIC SERVICE
- FIRE SERVICE
- GAS LINE
- WATER LINE WITH 90° THRUST BLOCK
- SANITARY SEWER LINE WITH CLEANOUT
- NEW FIRE HYDRANT
- UNDERGROUND ELECTRIC

**EXISTING FEATURES LEGEND**

- LM - GAS METER
- TLG - YARD LIGHT 0'-2'
- ELEC MH - ELECTRIC MANHOLE
- SIG LIGHT - SIGNAL LIGHT
- TR - TREE AND DIAMETER
- SN - SIGN
- IR - IRON BAR
- BUSH - BUSH
- PPM - POWER POLE AND DEADMAN
- EBOX - ELECTRIC BOX
- CDO - CLEANOUT
- UEL - UNDERGROUND ELECTRIC LINE
- FENCE
- BM - BENCHMARK
- SWMH - STORM WATER MANHOLE
- SSMH - SANITARY SEWER MANHOLE
- SWB - TELEPHONE MANHOLE
- BLDG - BUILDINGS
- OHE - OVERHEAD ELECTRIC LINE
- POST
- CHUTE - CHIMNEY "X" CUT
- OVERHANG
- POLE - POLE
- UATE - UTE
- TRAF. MH - TRAFFIC SIGNAL MANHOLE
- SC - SECTION CORNER
- SPK - SPRINKLER HEAD
- RW - RETAINING WALL
- LP - LIGHT POLE 10'-HICHER
- FH - FIRE HYDRANT
- WV - WATER VALVE
- WM - WATER METER
- ICI - IRRIGATION CONTROL VALVE
- GR - GRATE INLET
- TR - TELEPHONE RISER
- SPS - STORM SEWER PIPE
- W - WATER LINE
- SSS - SANITARY SEWER LINE
- G - GAS LINE
- TEL - TELEPHONE LINE
- INLET
- ROW OF BUSHES
- RD - ROOF DRAIN
- LP - LIGHT POLE 2'-10"
- UCV - UNDERHEAD CABLE TV LINE
- MS - MONITORING SENSOR

**BENCHMARKS**

1. " cut Northwest corner of traffic signal base Southeast corner Hillside & Murdock. Elevation = 150.135'
2. " cut on crosswalk signal base, Northeast corner of Hillside & Central. Elevation = 144.096'
3. " cut Northeast corner of light pole base at the Southeast corner of Hillside & Murdock. Elevation = 145.32'
4. " cut on the East end of concrete hand rail North side of Central ±164' West of Rutan. Elevation = 145.506'
5. Disk in North end of RCBC. Elevation = 145.376'
6. " on top of curb, North return Southeast corner Lot 3, Wesley Medical 3rd Addition. Elevation = 154.531'

**NOTE**

SEE SHEET C2.0 FOR GENERAL NOTES.

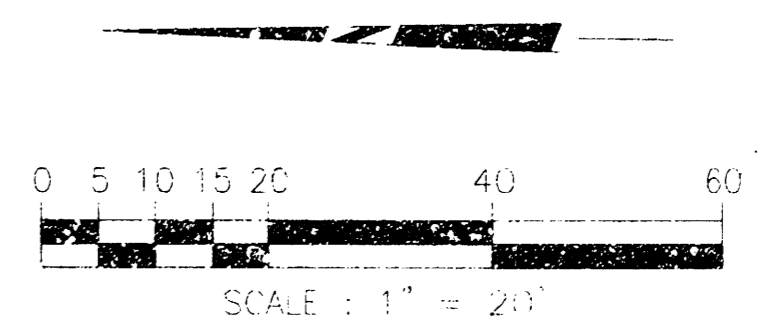

AS-BUILT DECEMBER 2003

**LITTLEJOHN ENGINEERING**  
ENGINEERING AND LAND PLANNING  
198 Twenty-First Avenue South Nashville, Tennessee 37212 Phone 615-385-4144

REVISIONS:  
DATE: MARCH 14, 2003

GOULD TURNER GROUP, P.C.  
ARCHITECTS & PLANNERS  
1400 HANSON AVENUE SUITE 100  
NASHVILLE, TENNESSEE 37203

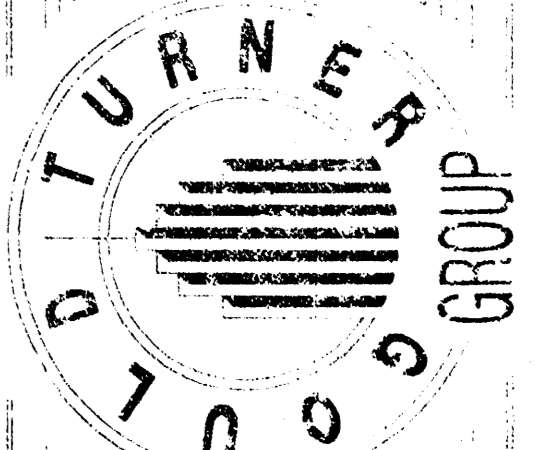

WESLEY MEDICAL CENTER  
ICU ADDITION & RENOVATION  
NASHVILLE, TENNESSEE  
DATE: MARCH 14, 2003

GRADING & DRAINAGE  
PLAN & PROFILE  
**C3.1**