

B.M. 94.755 ST. CLAIR E.S. T.P. S.E. COR. WEBSTER & GLENN  
 B.M. 95.65 STANDARD N.E. COR. 31ST ST. SO. & GLENN  
 B.M. 98.06 STANDARD S.W. COR. 27TH ST. SO. & GLENN

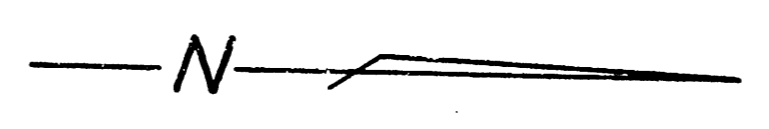

NOTE:  
 ALL EXCAVATION IS TO  
 BE DUMPED IN THIS AREA.

NOTE TO FIELD ENGINEER & CONTRACTOR  
 NO EXCAVATED MATERIAL TO BE DUMPED  
 IN PROPOSED FUTURE ST. AREAS



STORM WATER DRAIN #10  
 CITY OF WICHITA, KANSAS  
 B.E. SMITH - CITY ENGINEER  
 APRIL, 1955 PROJ. C25-23

1/13

1/2" = 10' PLAN  
 1/4" = 10' SECTION



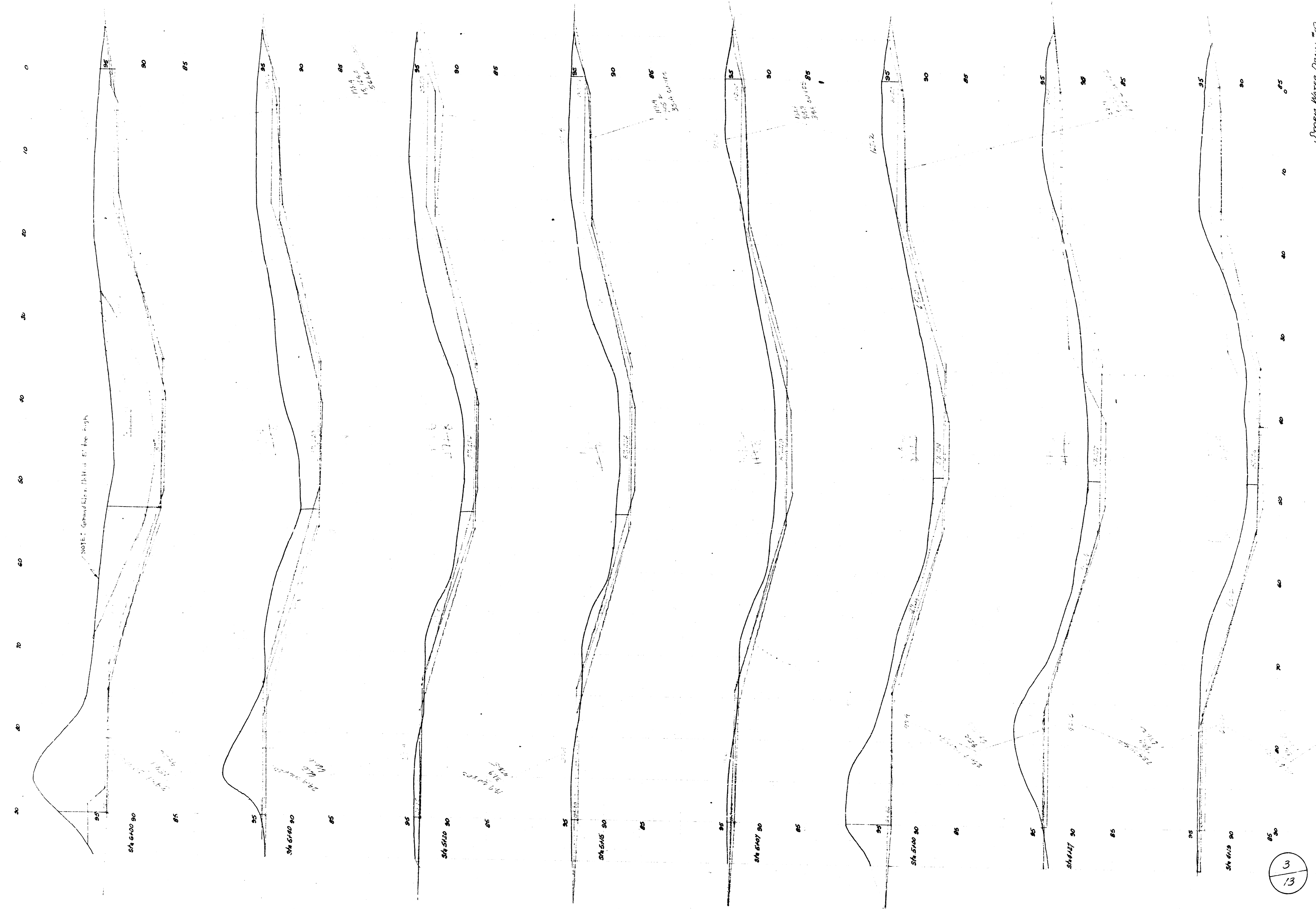

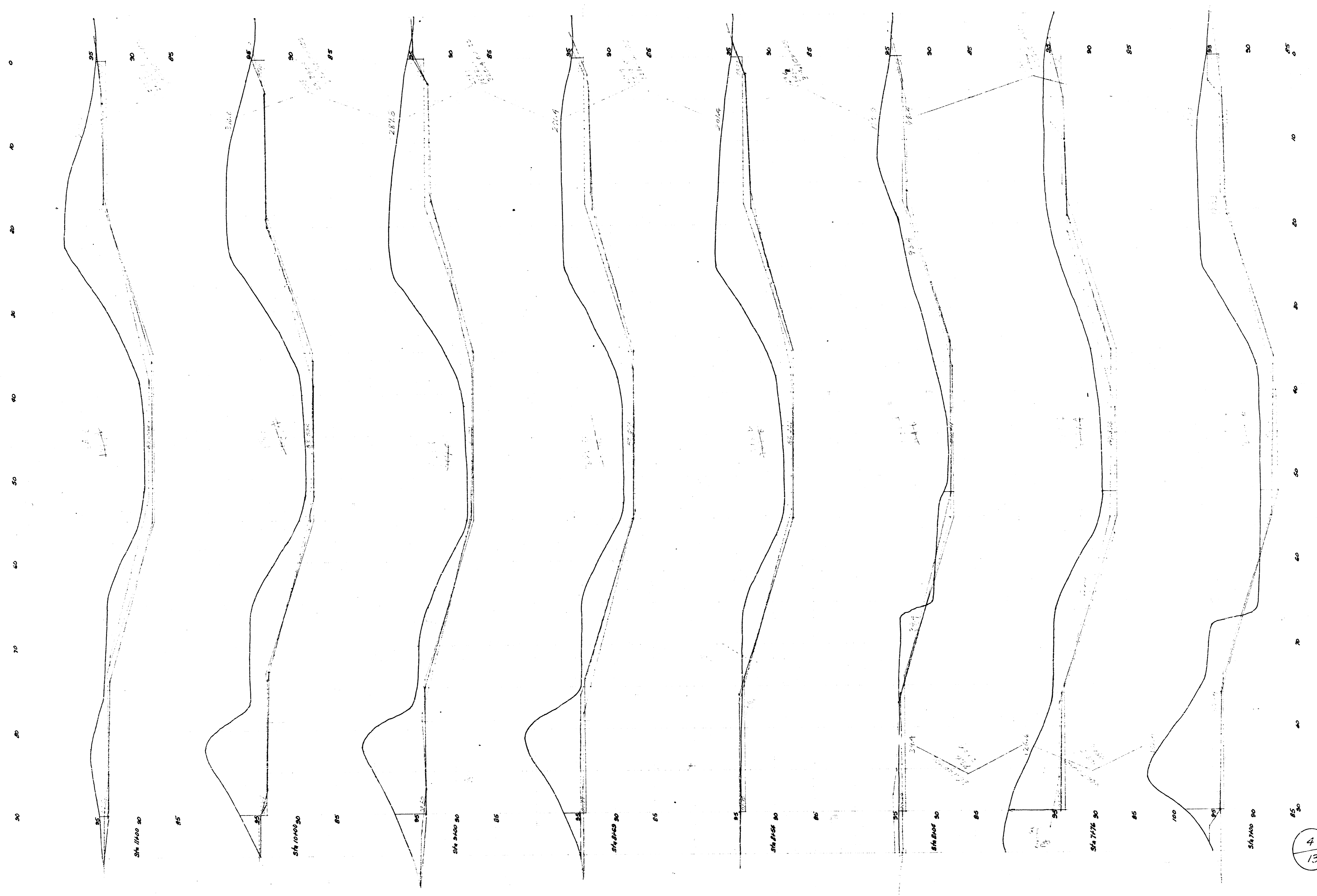

STONY WATER DAM #10  
 DRAW C-25-23

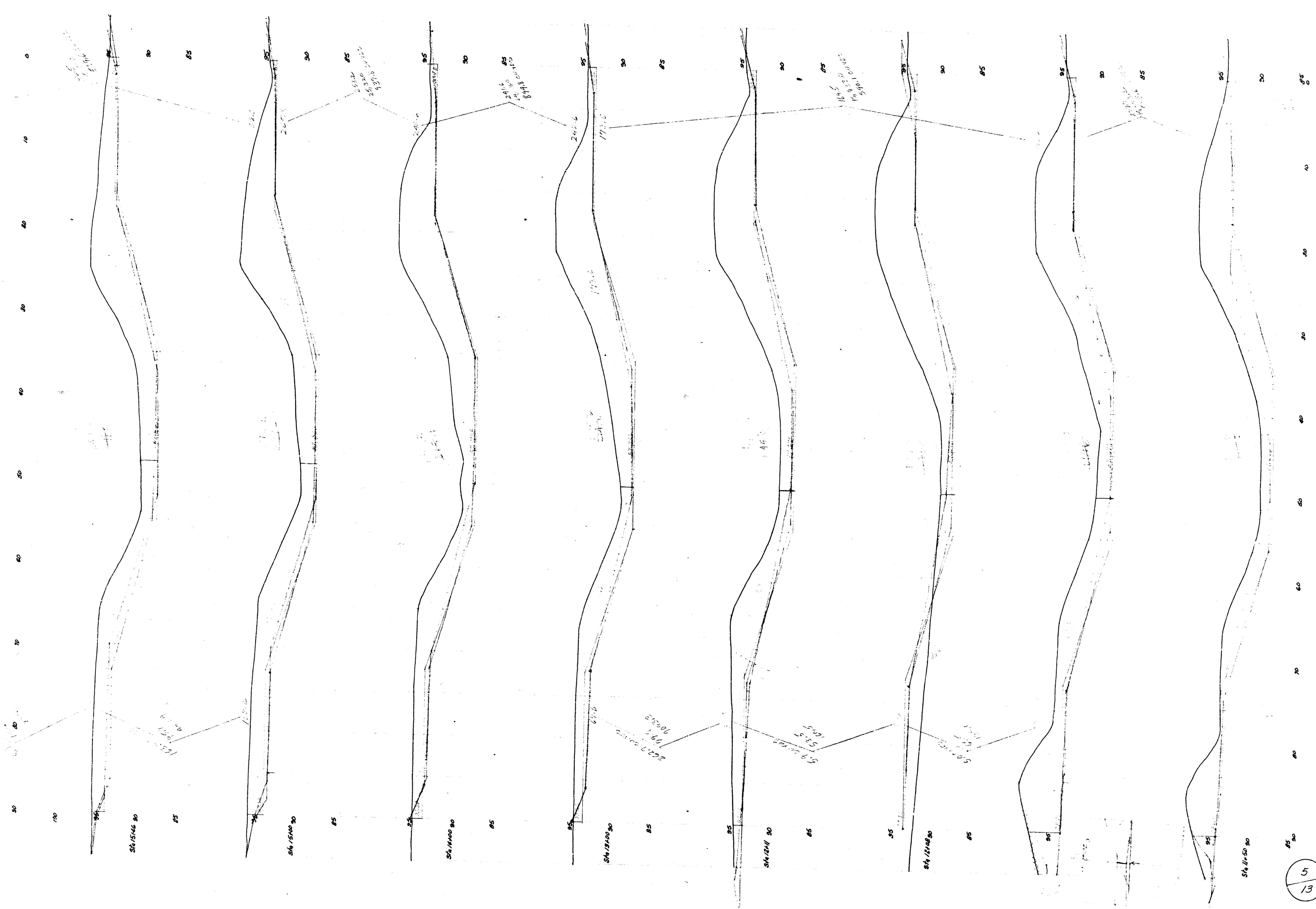

STARA WATROŃ  
PRAC. C.25.23

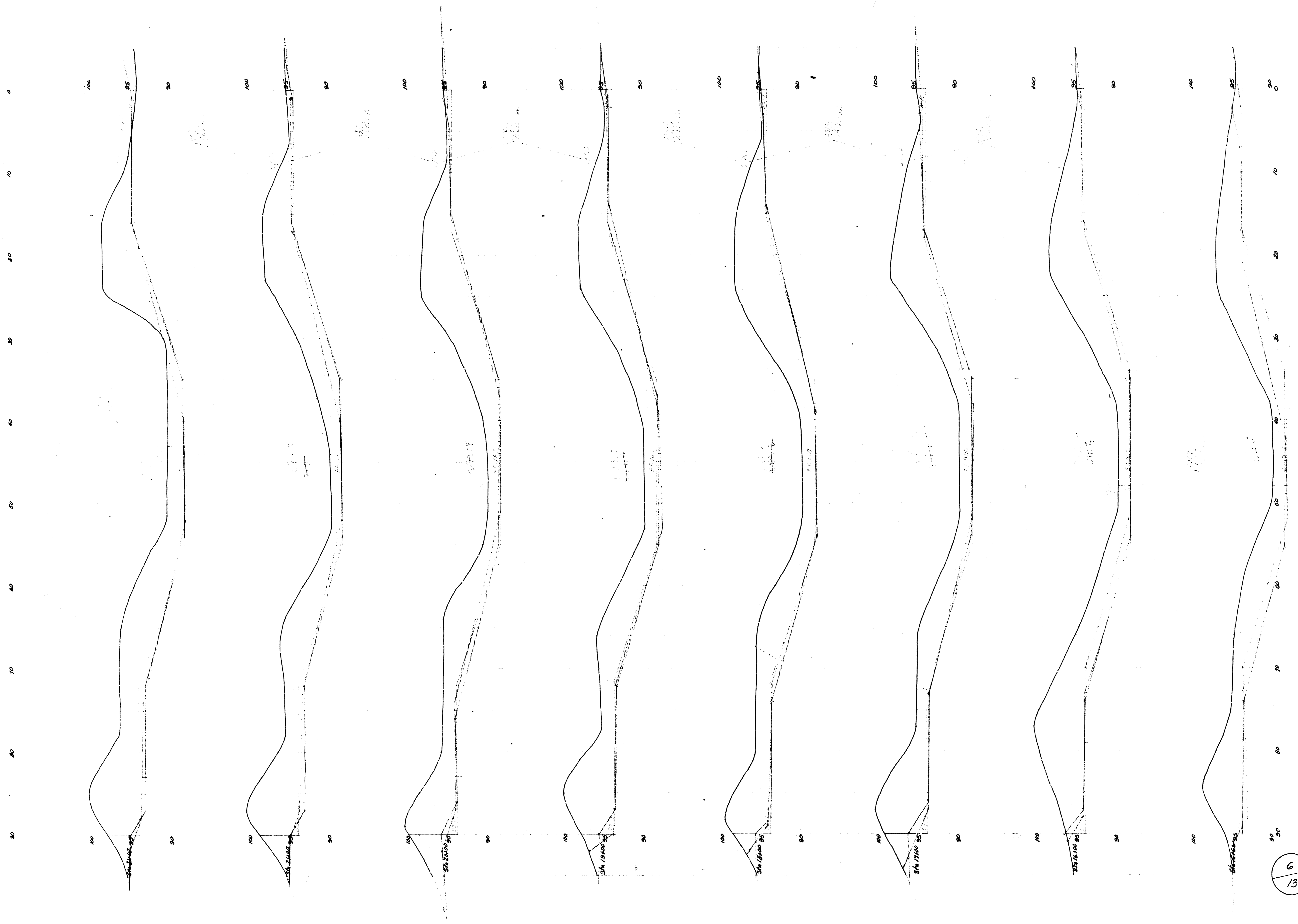

STORM WATER BASIN #4  
 PROJ. C-25-23



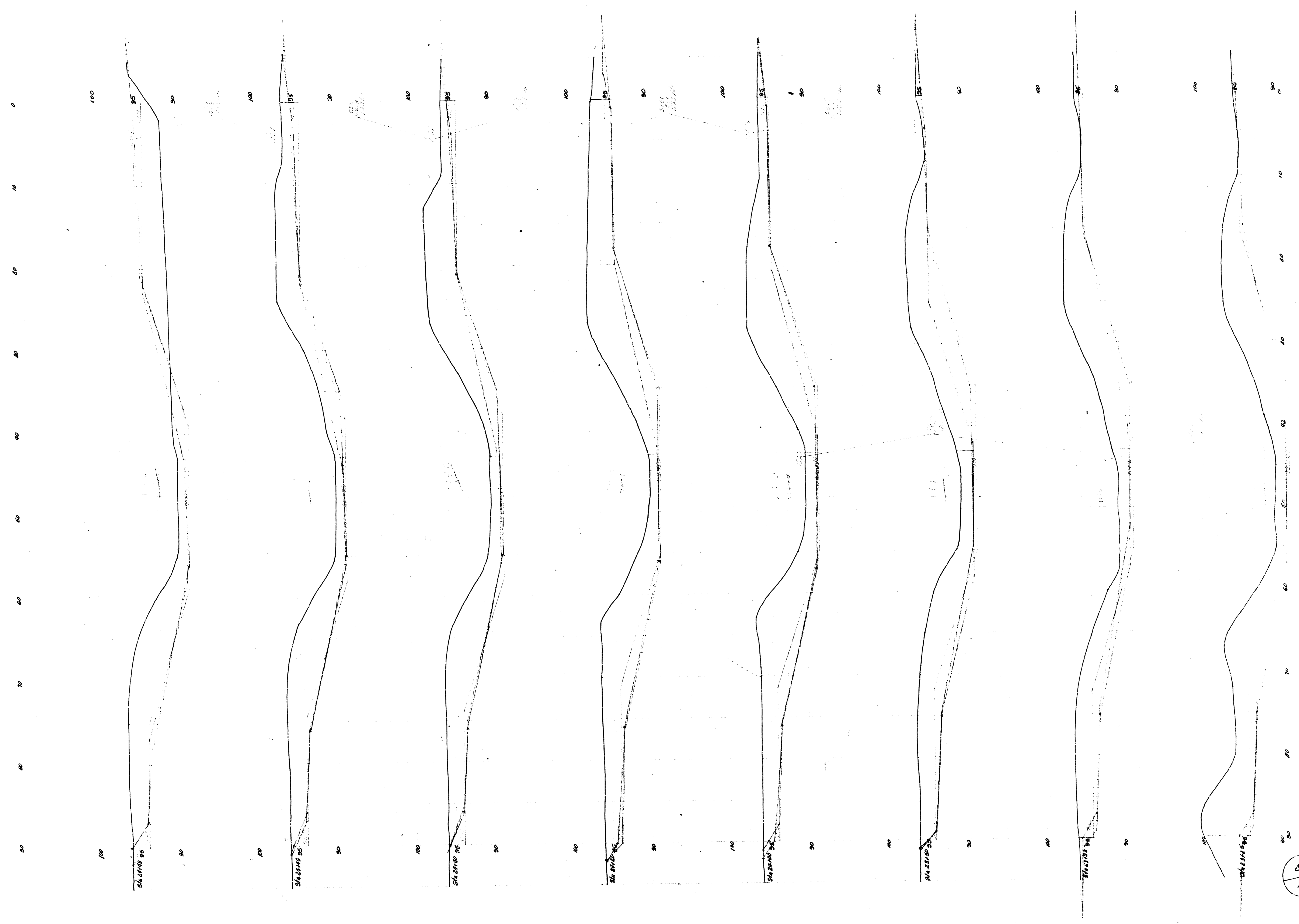

Stream Water Drain #10  
REV. 2-25-23

30 40 50 60 70 80 90 100 110 120 130

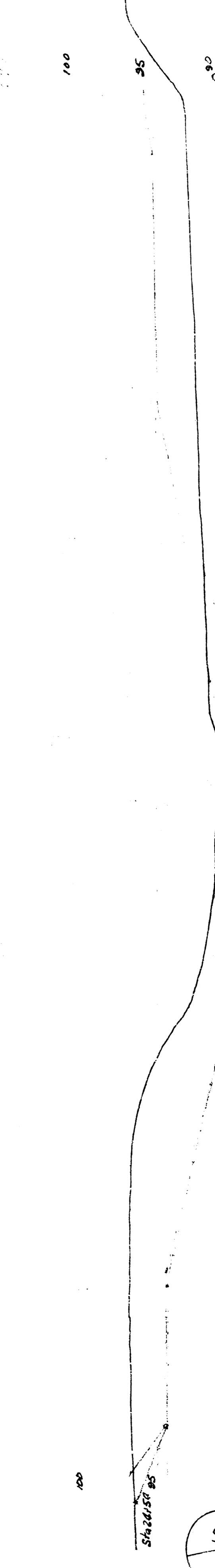
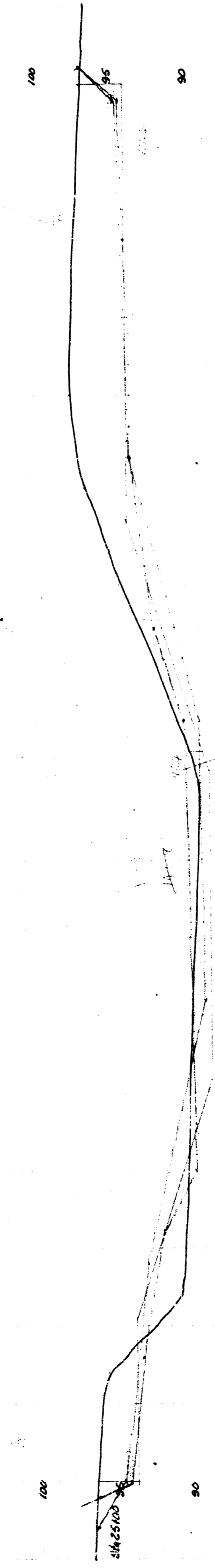
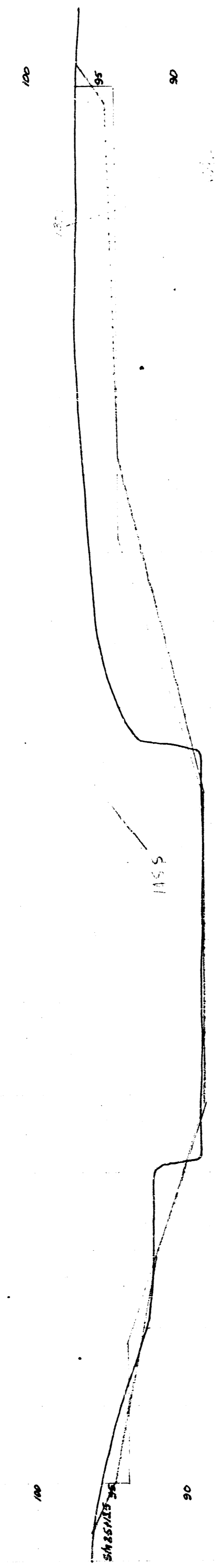

Stream Water Down #10  
REC. C-25-125

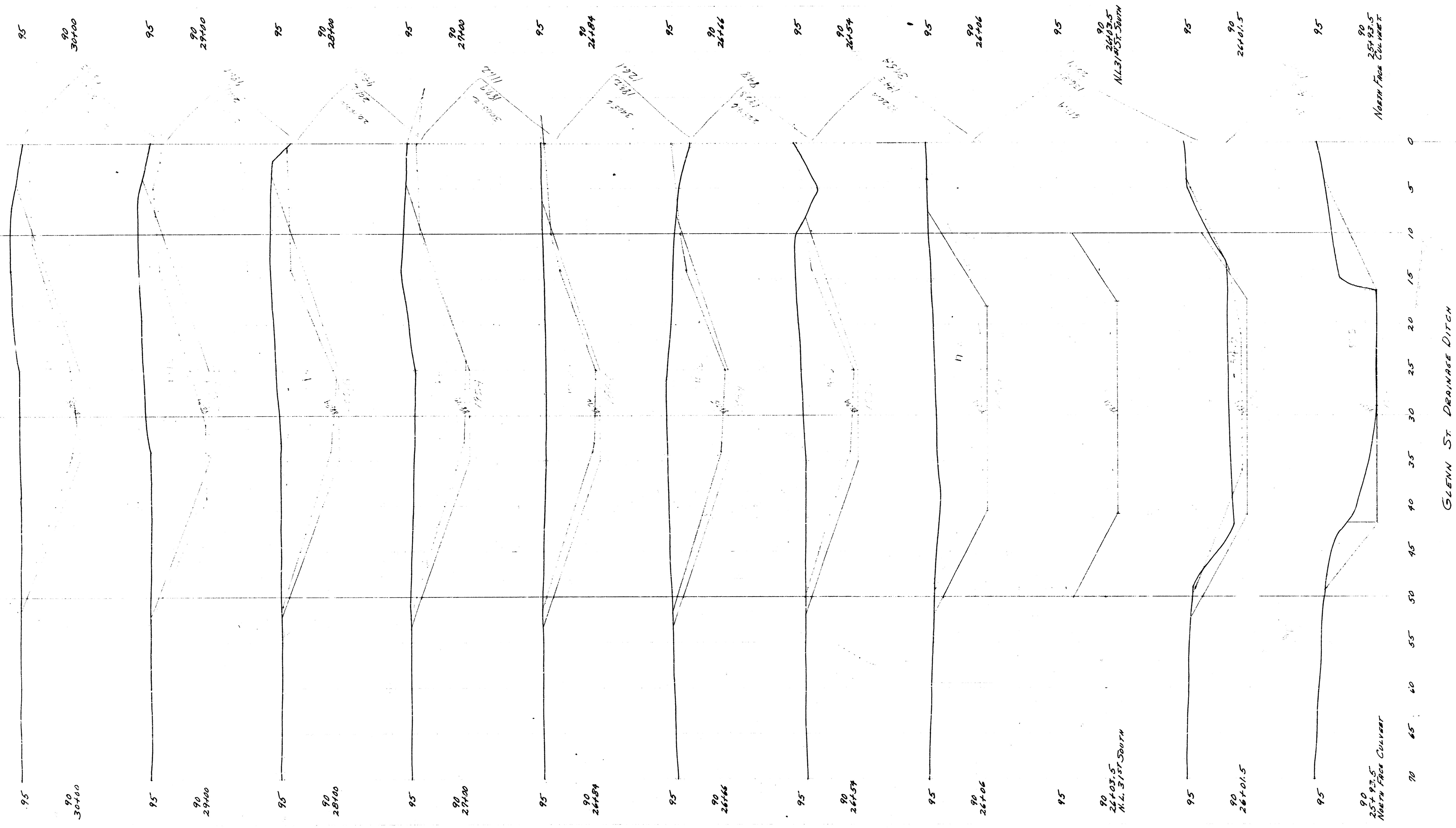

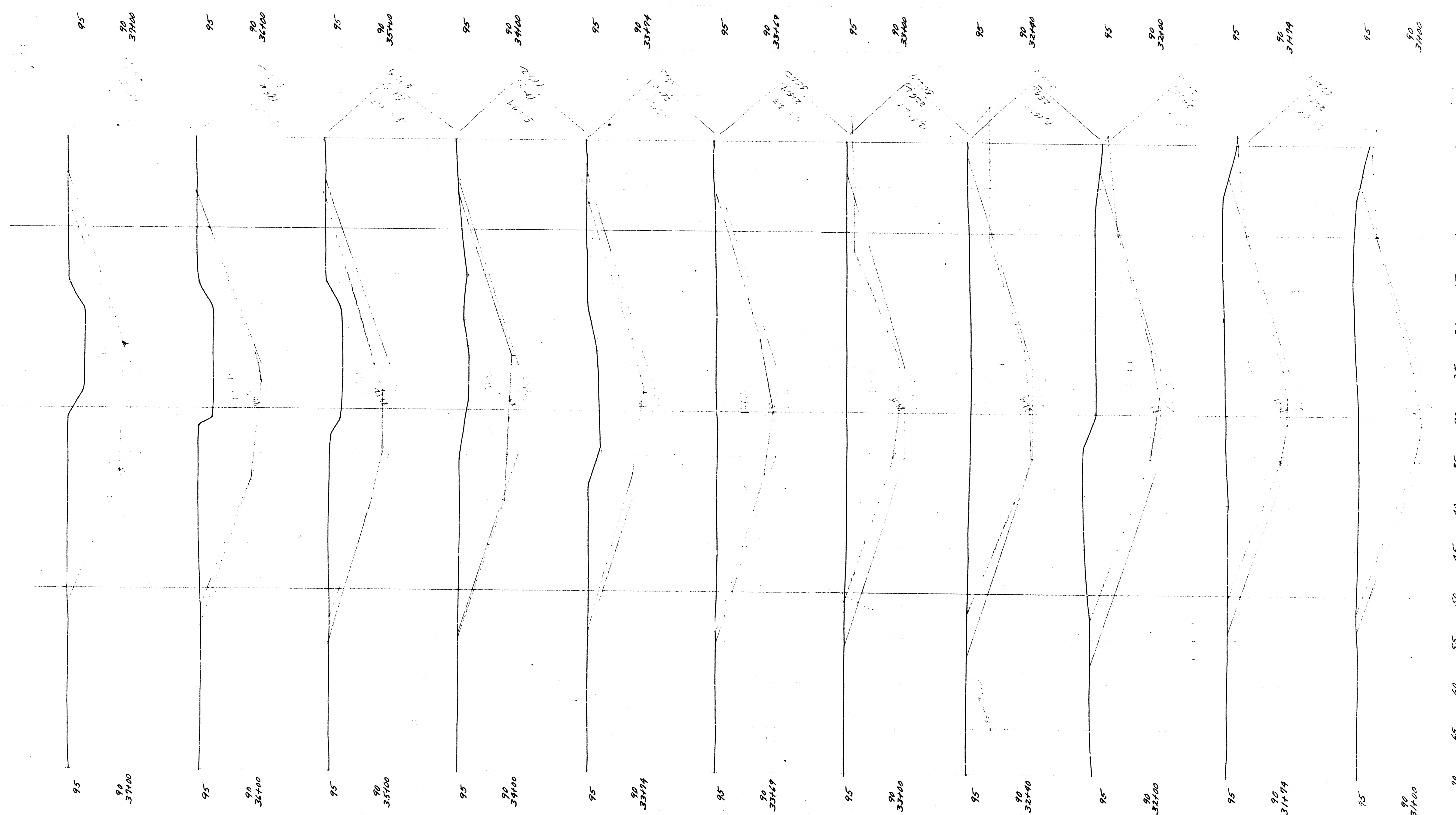

70 65 60 55 50 45 40 35 30 25 20 15 10 5 0  
 GLENN ST. DRAINAGE DITCH

STORM WATER DRAIN #10  
 P. 21, C25-23

11  
 13



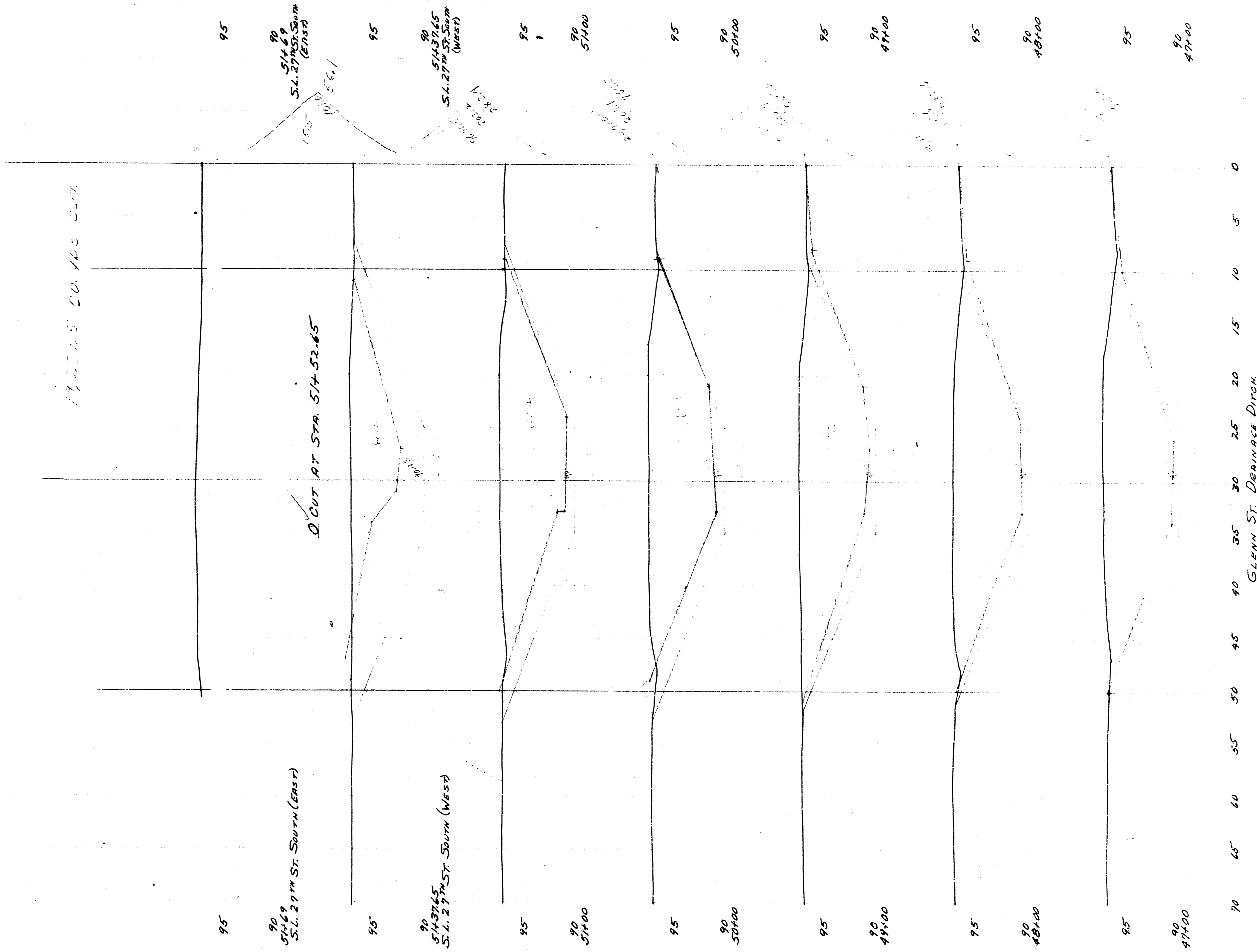

STORM WATER DRAIN #10  
 PROJ. C25-23

13  
 13