

STORM WATER DRAIN NO. 37

CITY OF WICHITA, KANSAS

R. W. LINN CITY ENGINEER

PROJECT NO. 468-76-245-80582-000-000-002

DATE: _____

GENERAL NOTES

- 1.) CLEARING RIGHT-OF-WAY SHALL INCLUDE TREE REMOVAL WHERE SHOWN ON PLANS, REMOVAL OF FENCE, BRUSH, DEBRIS, ROCK, ABANDONED PIPE CULVERTS, AND REMOVAL OF ANY OTHER INCIDENTAL ITEMS AS DIRECTED BY THE FIELD ENGINEER.
- 2.) THE DEVELOPER OF THE PROPERTY HAS BEEN INFORMED ABOUT THE ADDITIONAL EXCAVATION TO BE PERFORMED IN LOTS 2-11 OF BLOCK 7. SUCH EXCAVATION IS REQUIRED TO BE COMPLETED SIMULTANEOUSLY WITH THE CONSTRUCTION OF THE CHANNEL. THE CONTRACTOR AND FIELD ENGINEER SHALL ENSURE THAT WORK FOR THIS EXCAVATION IS COMPLETED DURING THE SAME PERIOD THE DITCH IS CONSTRUCTED. IN ORDER TO FULFILL THIS REQUIREMENT THE CONTRACTOR AND THE DEVELOPER MAY EXECUTE A MUTUAL AGREEMENT FOR THE WORK TO BE DONE. THE QUANTITIES FOR THIS ADDITIONAL EXCAVATION ARE NOT INCLUDED IN THE QUANTITIES FOR THE PROJECT; STORM WATER DRAIN NO. 37 AND COST OF SUCH EXCAVATION SHALL NOT BE CONSIDERED IN ANY WAY AS PART OF THE CONSTRUCTION COST OF THE STORM WATER DRAIN NO. 37.
- 3.) FIELD ENGINEER SHALL TAKE TIES TO ALL IRONS WHICH MAY BE DESTROYED DURING CONSTRUCTION. FIELD ENGINEER SHALL REPLACE ALL IRONS WHICH ARE DESTROYED.
- 4.) TREES TO BE REMOVED ARE MARKED WITH . EXCEPT THAT ANY TREE MARKED FOR SUCH REMOVAL SHALL BE SAVED IN THE OPINION OF THE FIELD ENGINEER.
- 5.) ALL CONTRACTORS SHALL COORDINATE THEIR WORK EFFORTS WITH UTILITY COMPANIES, AND OTHER AGENCIES RELATED WITH THE PROJECT SITE DEVELOPMENT.
- 6.) THE QUANTITIES SHOWN ON SHEETS 4-10 ARE FOR "INFORMATION PURPOSES ONLY". THE CONTRACTOR MUST SATISFY HIMSELF AS TO THE "QUANTITIES". THE ENGINEER DOES NOT ASSUME ANY RESPONSIBILITY WHATSOEVER FOR THEIR ACCURACY. THE CONTRACTOR SHALL BE RESPONSIBLE FOR PROVIDING ALL MATERIALS REQUIRED AS SHOWN ON DETAILED PLANS NECESSARY TO COMPLETE THE PROJECT.
- 7.) ALL FILL IN THE EXISTING ROADSIDE DITCH SHALL BE COMPACTED IN 6" LIFT TO THE FINISHED GRADE SHOWN IN THE CROSS-SECTIONS; DRAWING NOS. 4-10. COMPACTED DENSITY OF THE SOIL SHALL BE EQUAL TO OR GREATER THAN NINETY (90) PERCENT OF STANDARD DENSITY AT OPTIMUM MOISTURE CONTENT AS PER ASTM D-698 AND LATEST REVISIONS THEREOF.

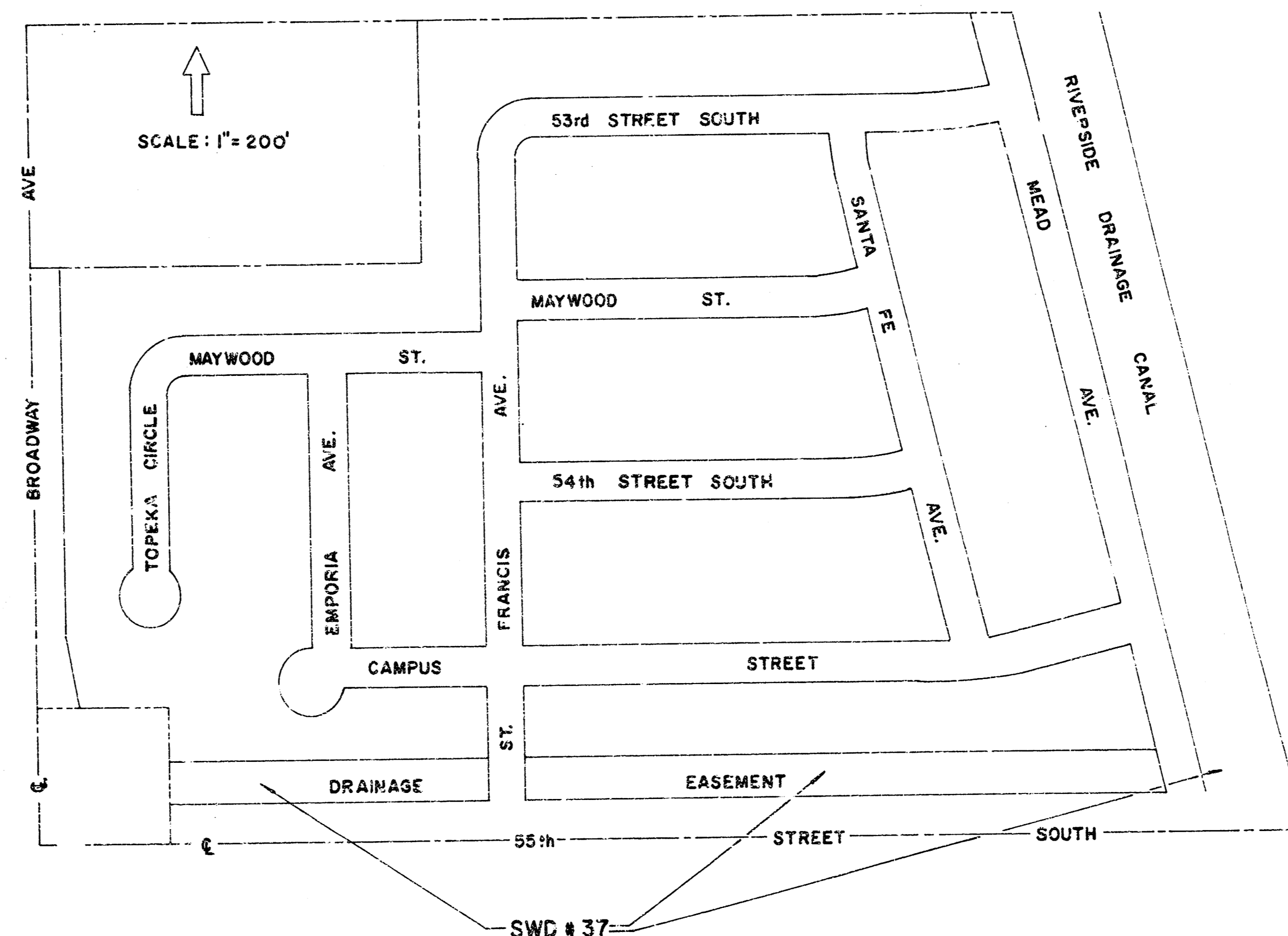

INDEX

- 1 Cover
- 2-3 Plan-Profile
- 4-10 Cross Sections

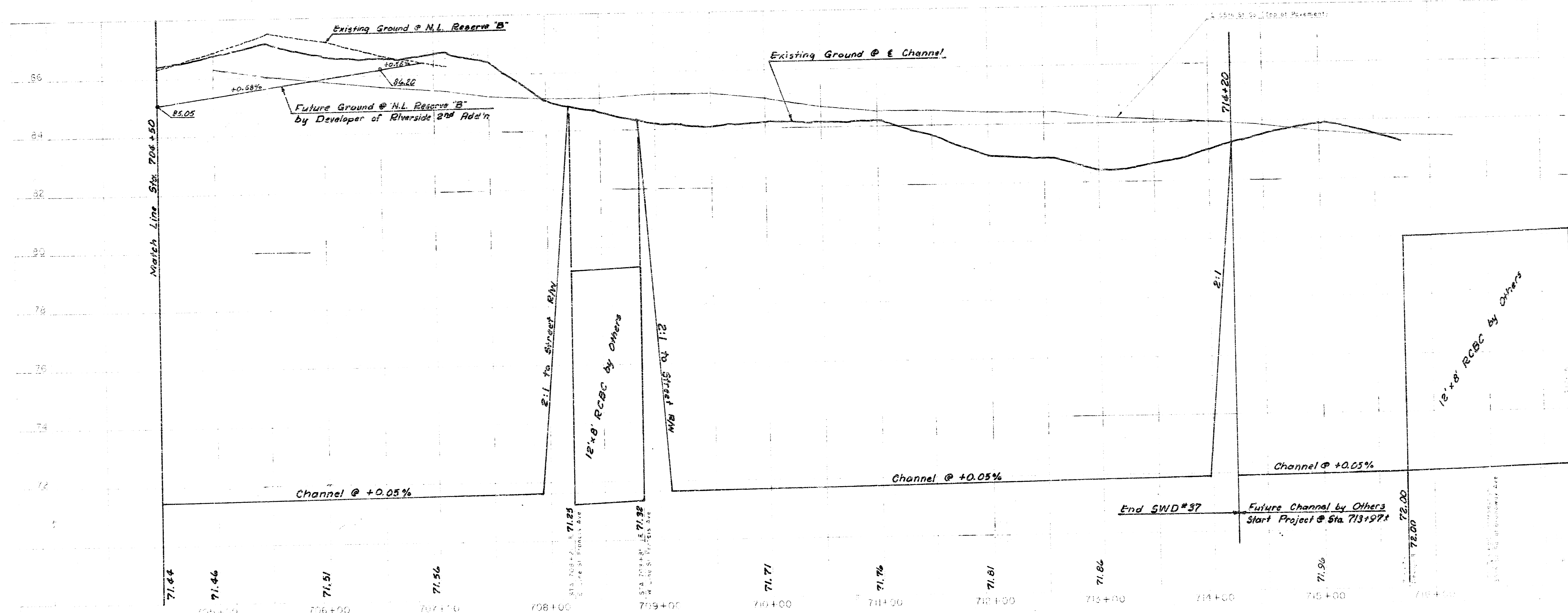
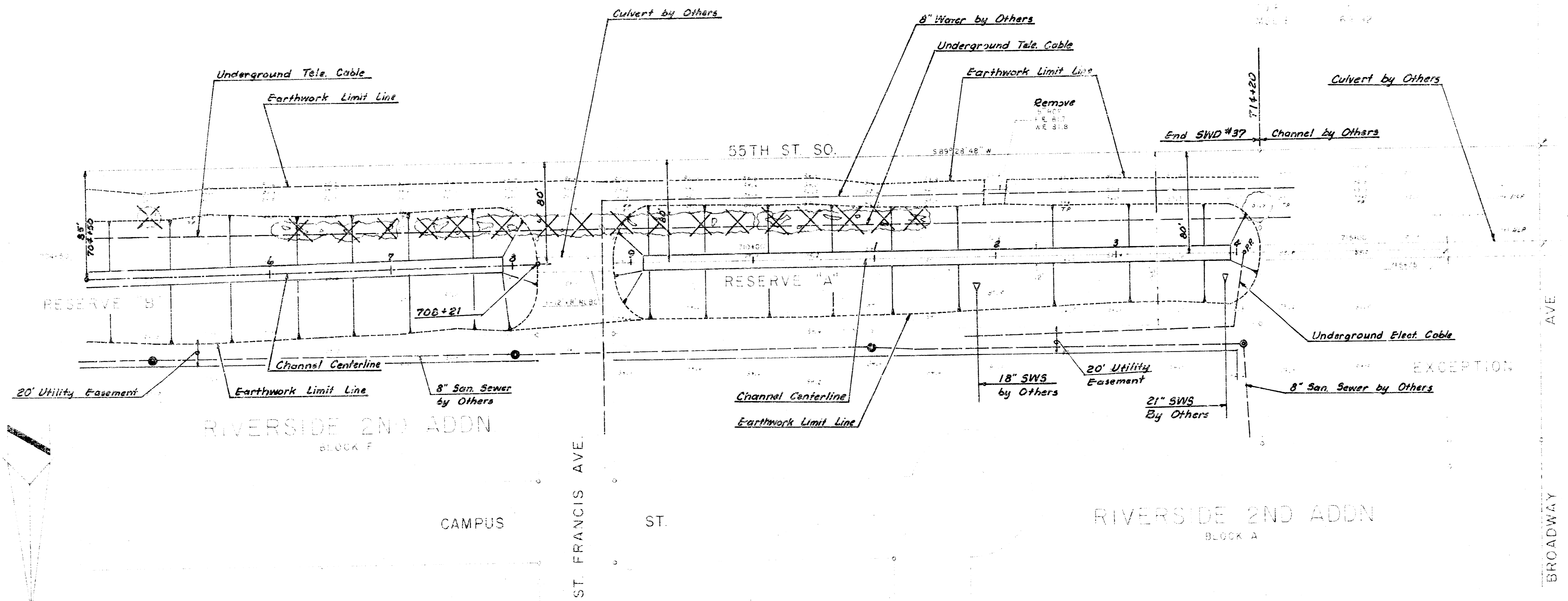

DRAINAGE IN SIDE 55TH ST. SO
 E. of BROADWAY AVE
 SEC 21-1-20-0 R-1-E