

B.M. 190.22 "S" IN S. GLOBE, W. Co. LIGHTING, N.L.L. 9TH
 B.M. 199.74 DOUBLE SPIKE, W.S. ELM TREE, 30' N. OF N.L.L. FOLD, 30' E. OF $\frac{1}{2}$ OF EASEMENT
 $\frac{1}{2}$ IS BASELINE

N
 SCALE: 1" = 60'

9TH ST

40'

20'

552.45'

$\Delta = 36^{\circ}45'$

L = 125.51'
 R = 195.08'

172.45'

L = 198.10'
 R = 301.05'

$\Delta = 36^{\circ}45'$

662.53'

60' FOLD DE.

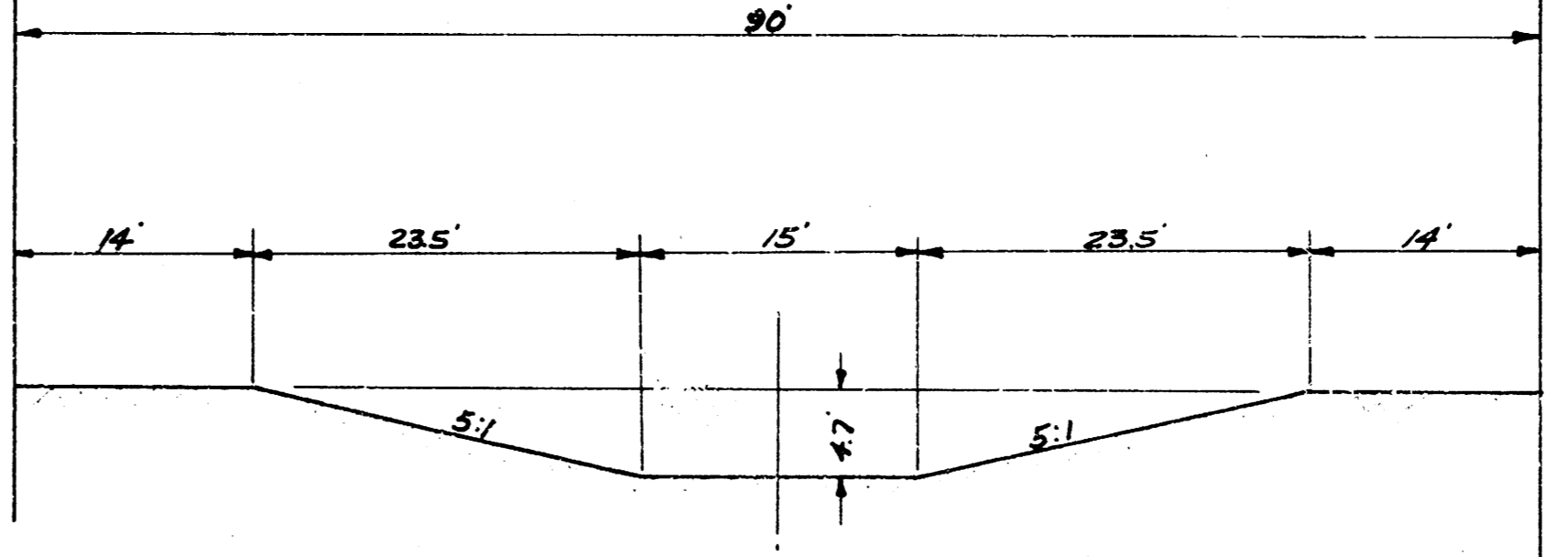

TYPICAL SECTION
 Scale: 1" = 10'

DRAINAGE EASEMENT
 McEWEN 2ND & 3RD ADDITION

$\frac{1}{5}$

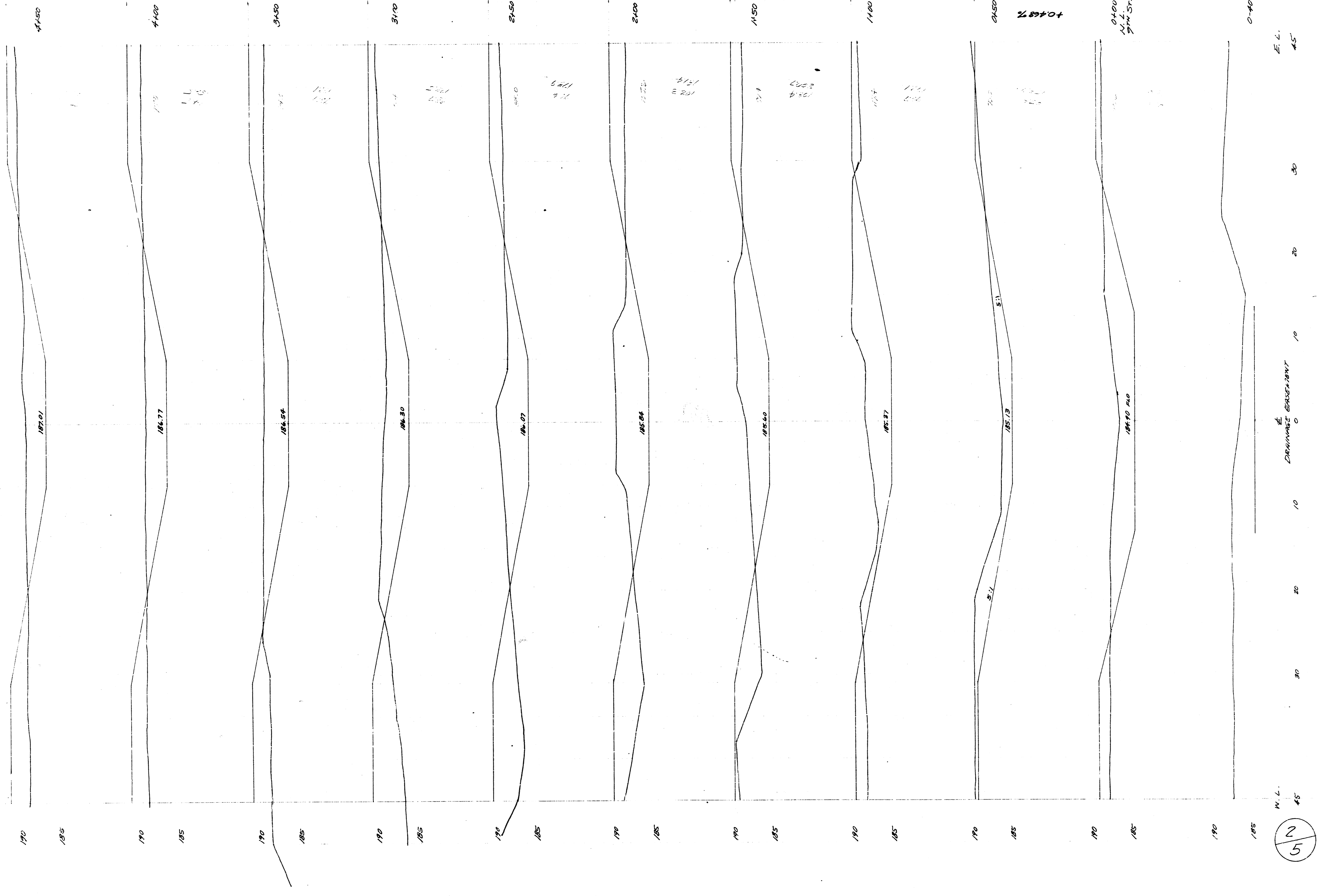

W.L. 45
 2
 5
 45 30 20 10 0 10 20 30 45
 E. L. 45
 DRAWING EASTERN

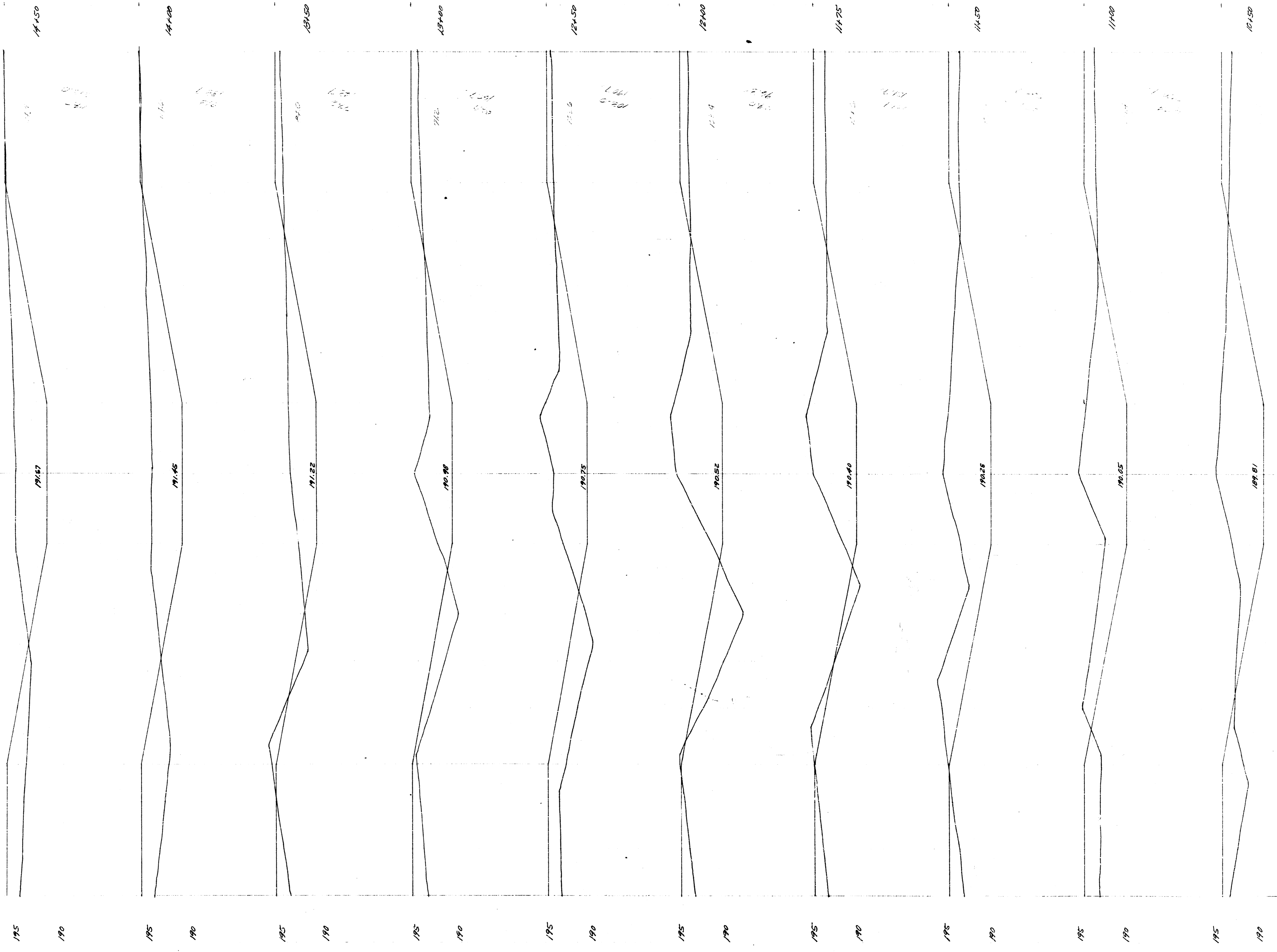

45
 30
 20
 10
 0
 10
 20
 30
 45

4/5

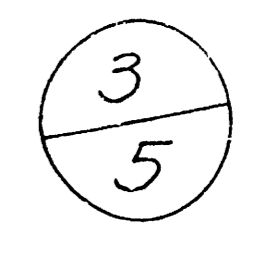
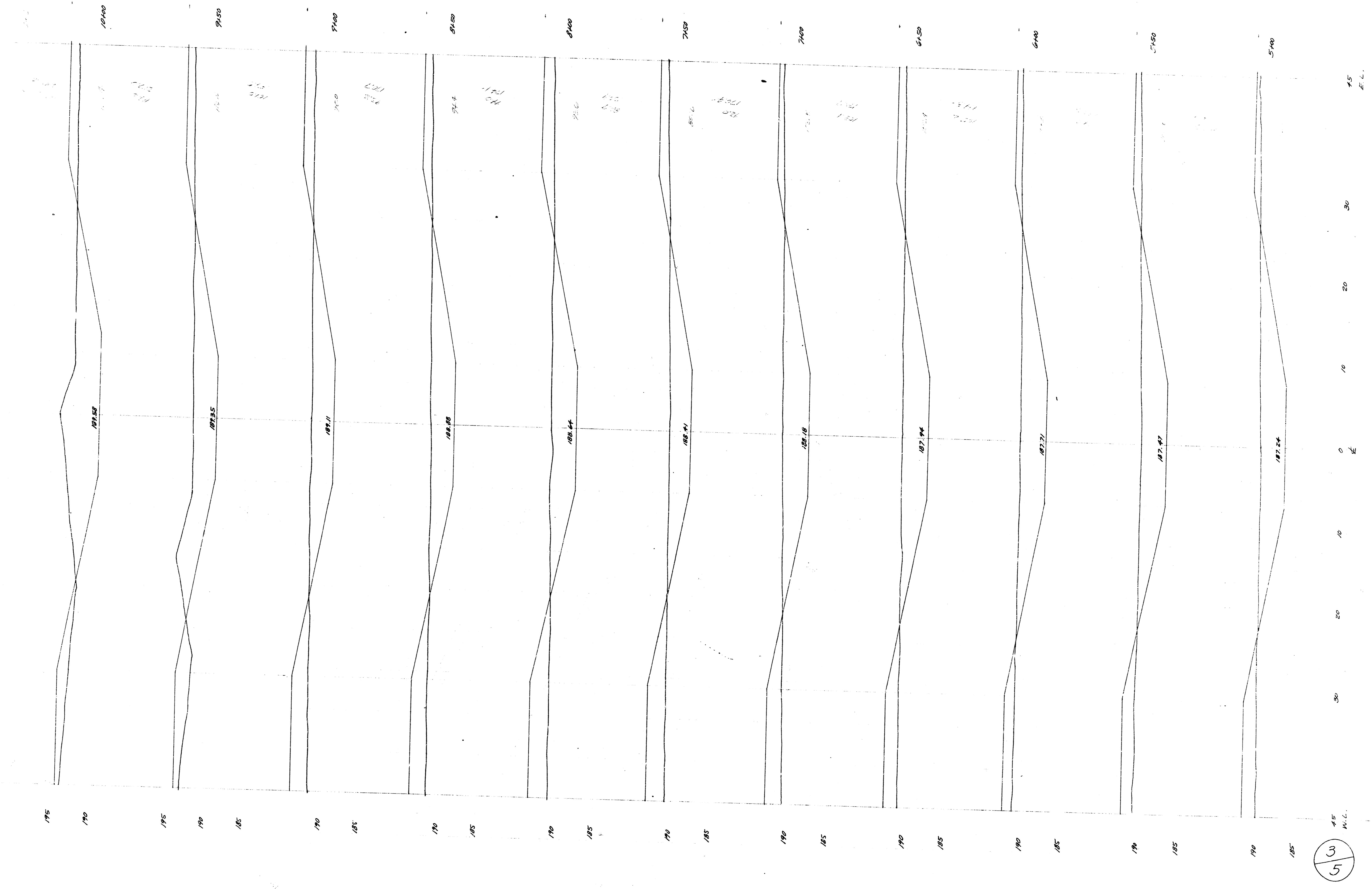

45' No. 1.

7.5 E.C.