

CHERRY CREEK STA 1+44 TO STA 2+04, 26' RT.  
 INSTALL 40 LF 15" PVC CASING  
 MARK ENDS OF CASING PIPE FOR RELOCATION  
 PURPOSES DURING WATER LINE CONSTRUCTION.

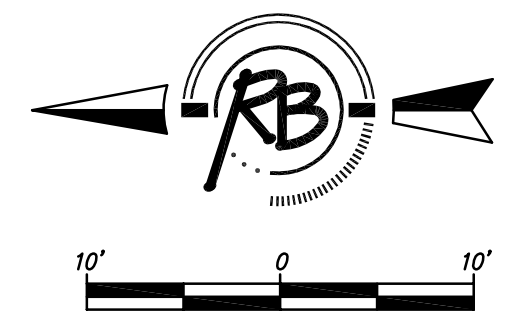
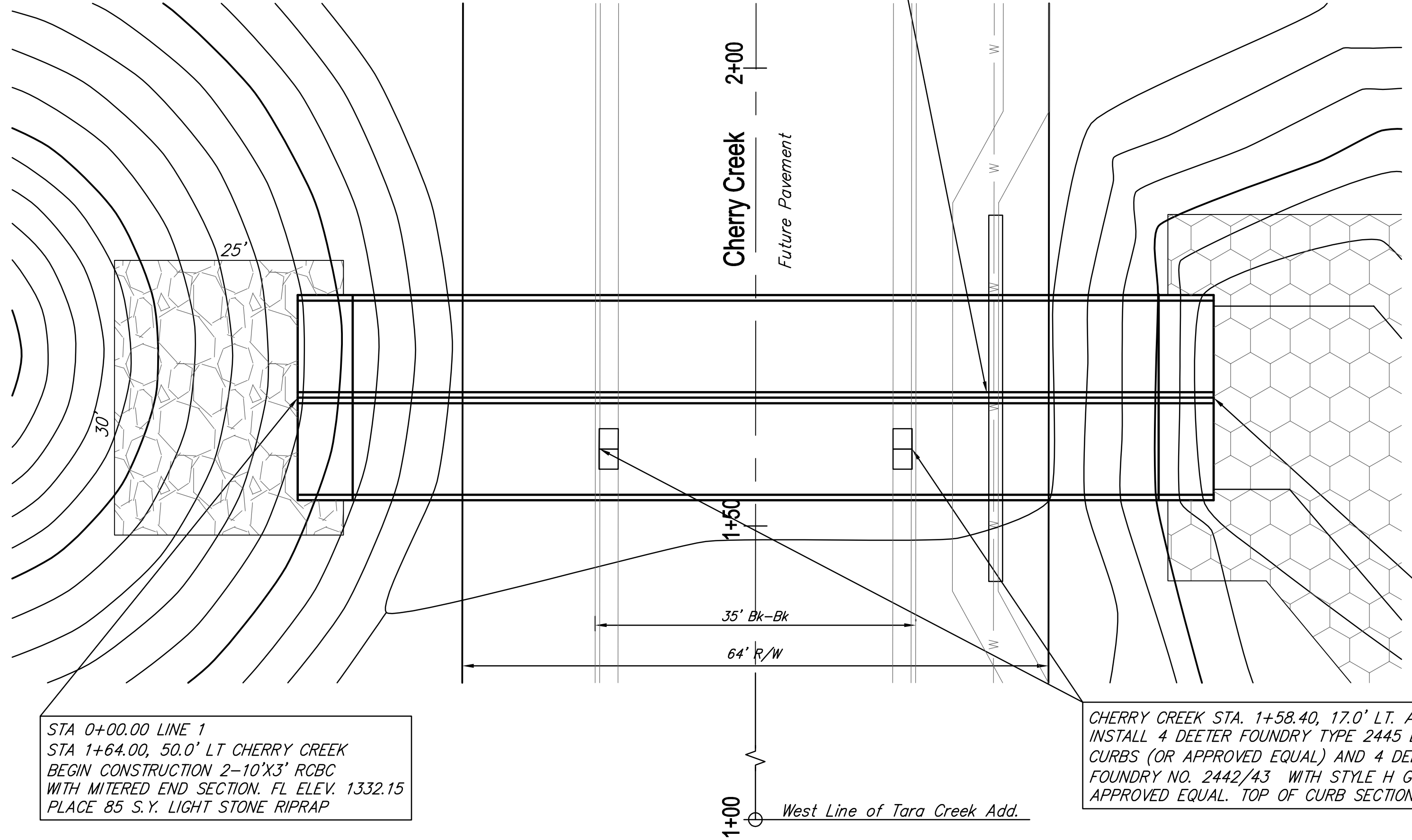

ALL WORK AND MATERIAL ON THIS SHEET  
 SHALL BE BID UNDER 'LUMP SUM'  
 FOR RCB CONSTRUCTION.

STA 0+00.00 LINE 1  
 STA 1+64.00, 50.0' LT CHERRY CREEK  
 BEGIN CONSTRUCTION 2-10'X3' RCBC  
 WITH MITERED END SECTION. FL ELEV. 1332.15  
 PLACE 85 S.Y. LIGHT STONE RIPRAP

CHERRY CREEK STA. 1+58.40, 17.0' LT. AND 17.0' RT.  
 INSTALL 4 DEETER FOUNDRY TYPE 2445 BARRIER  
 CURBS (OR APPROVED EQUAL) AND 4 DEETER  
 FOUNDRY NO. 2442/43 WITH STYLE H GRATES OR  
 APPROVED EQUAL. TOP OF CURB SECTION 1338.50

STA 1+00.00 LINE 1  
 STA 1+64.00, 50.0' RT CHERRY CREEK  
 END CONSTRUCTION 2-10'X3' RCBC  
 WITH MITERED END SECTION. FL ELEV. 1332.45

Ruggles & Bohm, P.A.  
 Engineering, Surveying, Land Planning  
 804 South Main  
 Wichita, Kansas 67203  
 (316) 264-4600  
 www.ruggles.com  
 E-mail: info@ruggles.com

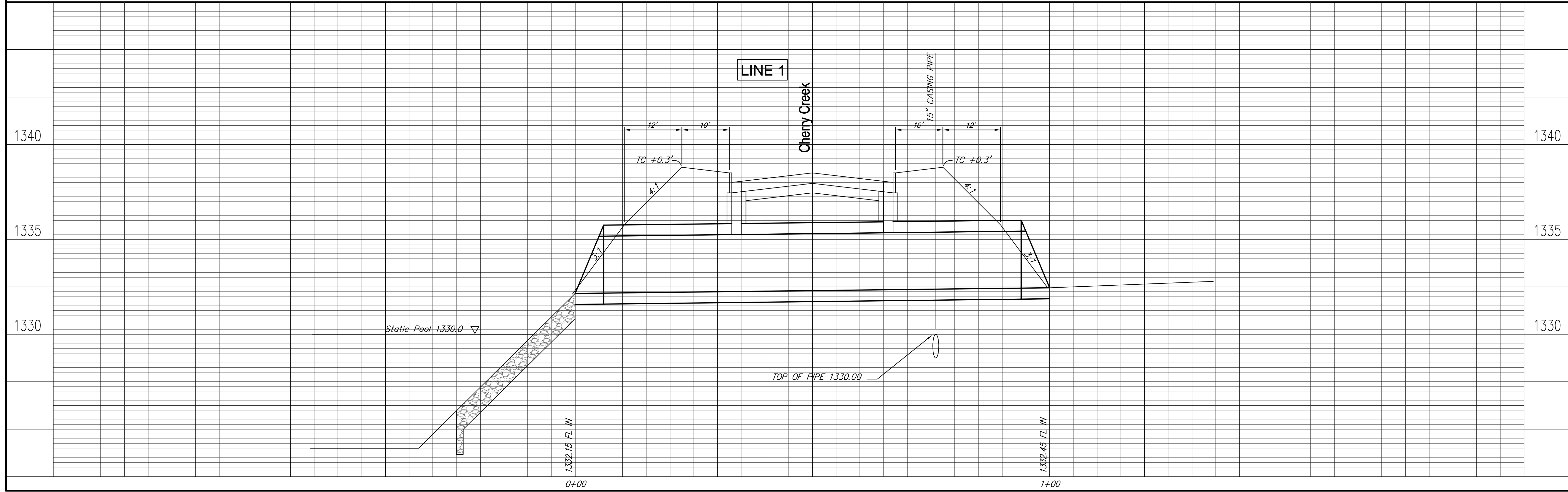

REVISION  
 DRAWN RA  
 DATE Sept. 26, 2007  
 REVIEW

DESIGN CMB  
 UTILITY  
 PROJECT NUMBER 468-84358  
 DRAWING FILE RCB Layout

TARA CREEK ADDITION  
 RCB DETAILS  
 WICHITA KANSAS

RB JOB 3032P  
 SHEET 5  
 OF 5  
 16