

Index of Sheets:

- 1 Cover Sheet
- 2 Line 1 Plan and Profile
- 3. Lines 2&3 Plan and Profile
- 4. Fire Hydrant Details

# FIRE LINE TO SERVE DAVIS MOORE MAZDA

1308 PPW 607853  
CITY OF WICHITA, KANSAS  
Jim Armour, P.E., City Engineer

GENERAL NOTES

1. Contractor will be required to provide notice to utility companies a minimum of twenty-four (24) hours prior to any excavation, as follows:  

Kansas One-Call	687-2470
-----------------	----------

The Contractor must notify the following in case of an emergency:

Cox Communications	262-4270
or	263-2061
Westar Energy/	
Kansas Gas & Electric Company	1-888-482-4950
Southwestern Bell Telephone Company	1-571-2611
City of Wichita Water Department	268-4908
City of Wichita Sewer Department	268-4071
Aquila Natural Gas	942-8811
or	1-800-303-0357
2. Exist. utilities and their locations, as shown on the plans, represent the best information obtainable for design. Location information has been obtained from the various utility companies and is either from company record drawings or company-provided field locations. The Contractor will be required to work around existing utilities which do not conflict with proposed construction.
3. The Contractor to verify utility locations prior to construction of this project.
4. Utility service and installation shall be coordinated with the respective utility owners. Contacts are:  

Kansas Gas Service	Jim Coe	832-3126
Westar Energy	Miles Capps	261-6251
Aquila Networks	Calvin Briggs	942-8811
Wichita Water	Paul Bryant	268-4555
Southwestern Bell	Jim Toben	268-2759
Cox Communications	Brian Ring	262-4270
5. All lawn/turf areas disturbed by construction of proposed improvements shall be restored with seed. All seeding work shall be in accordance with the City of Wichita standard specifications and the City of Wichita administrative regulation No. AR78 which governs cleanup and replacement following construction. All costs for this work shall be subsidiary to the lump sum price bid for "Site Restoration."
6. Traffic affected by the construction of this project shall be handled in accordance with the latest edition of the Manual on Uniform Traffic Control Devices.
7. All commercial signs to be moved by others prior to construction.
8. Properties within the project may have underground irrigation systems (lawn sprinklers) which conflict with new construction. Contractor shall remove such components as needed during construction of the project. The irrigation system shall be reinstalled in like kind before project completion. Any irrigation system modifications required because of project improvements shall be coordinated with the property owner. Portions of underground irrigation systems not in conflict with new construction shall be protected from damage and shall remain in place. All work related to underground irrigations/sprinklers shall be subsidiary to Site Restoration.

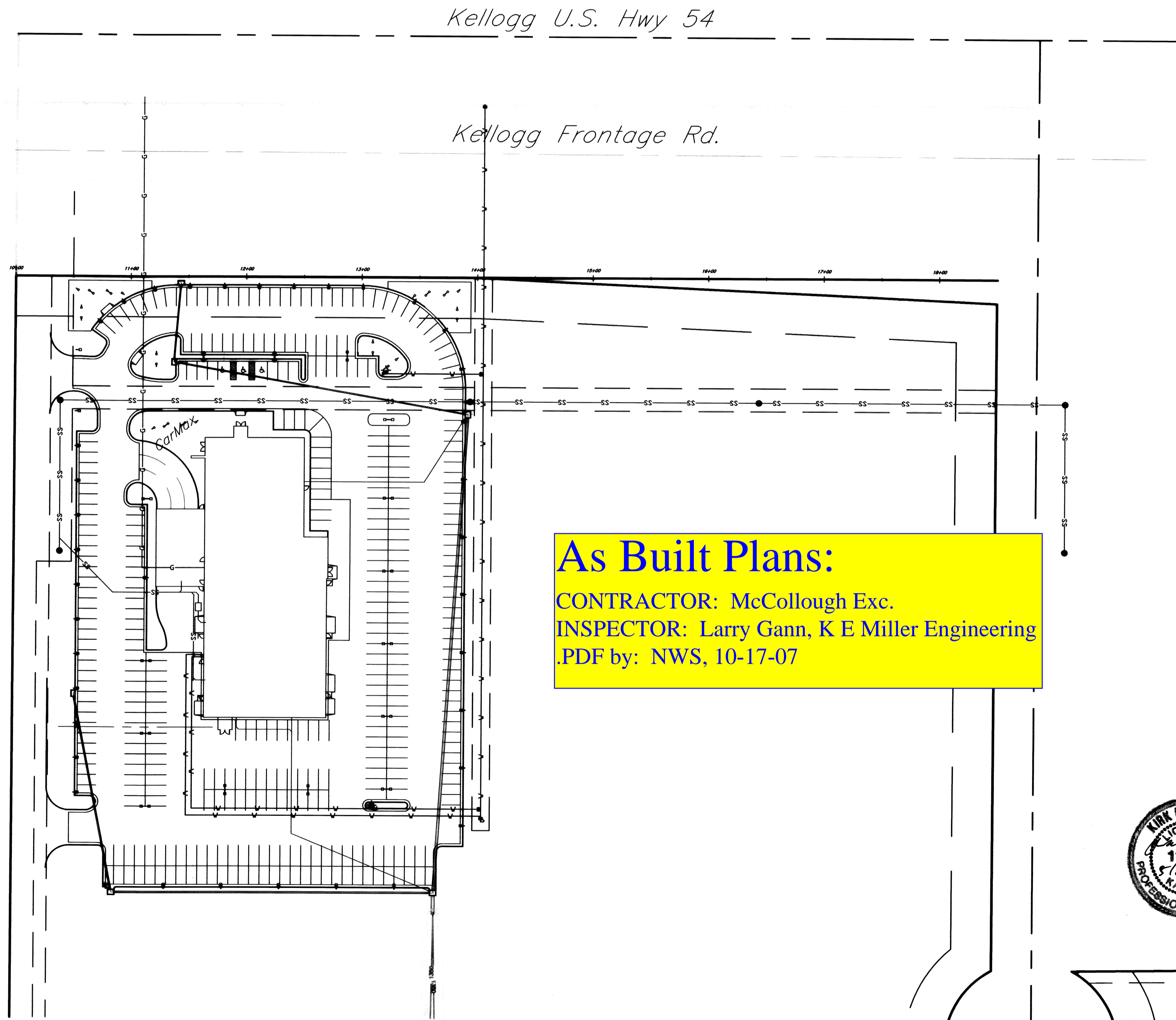

**As Built Plans:**  
**CONTRACTOR: McCollough Exc.**  
**INSPECTOR: Larry Gann, K E Miller Engineering**  
**.PDF by: NWS, 10-17-07**

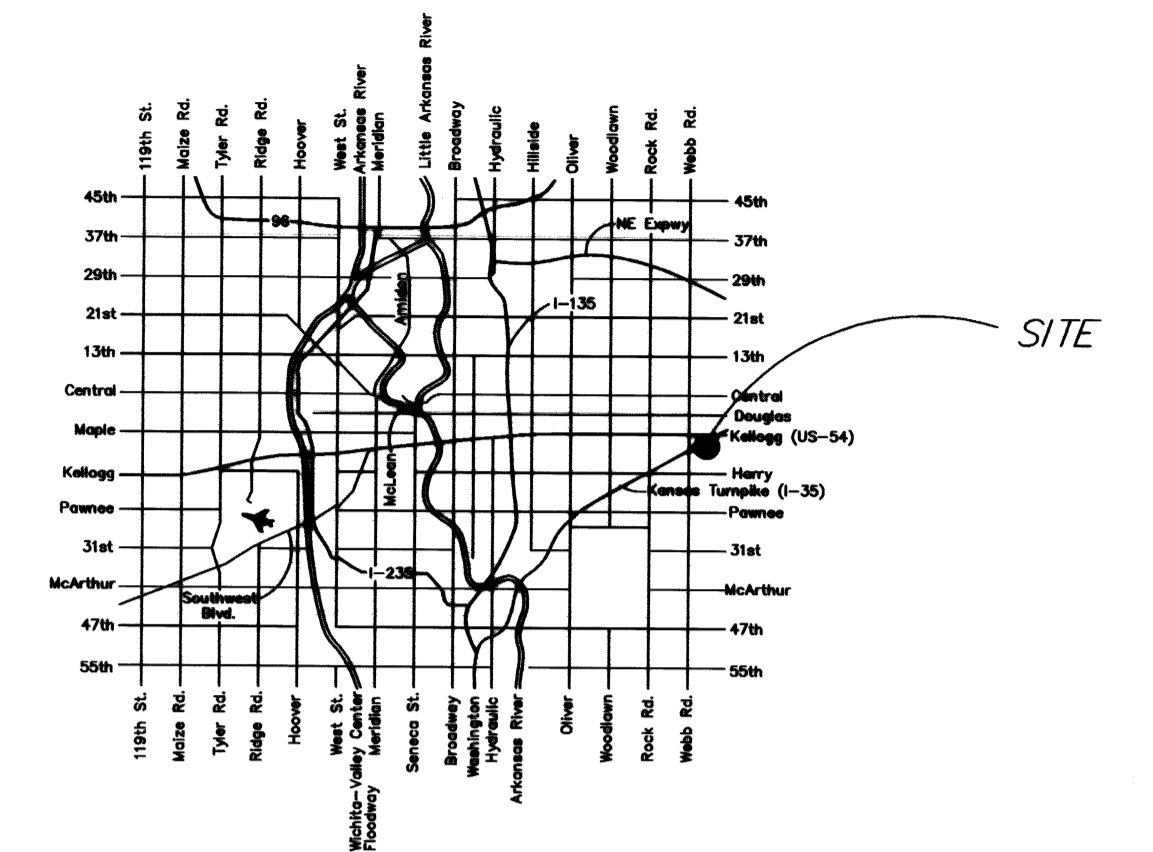

City of Wichita

Benchmark:  
 "A" cut N. top of curb,  
 N. median of access Road.  
 Elev. 1360.60

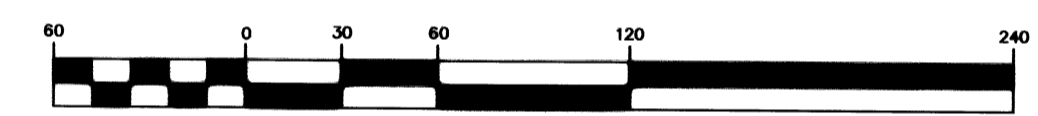

APPROVED AS NOTED  
 BY CITY ENGINEER OF WICHITA,  
 BY WICHITA WATER & SEWER DEPARTMENT,  
 & BY WICHITA FIRE DEPARTMENT

Public Works: SMC 5/11/07  
 Water & Sewer: WWS 5/11/07  
 Fire: WED/PCT 5-01-07

NOTE TO CONTRACTORS

**Public Property:**  
 Inspection and testing for the waterline is to be provided by a Licensed Consulting Engineering Firm under contract with the Owner/Developer. Said inspection to be in accordance with the City of Wichita standard construction engineering practices and certified by a Professional Engineer Licensed in the state of Kansas. No work shall be performed in dedicated easements or public right-of-way by the Contractor without such inspection nor shall any work be commenced without written authorization by the City Engineer. All Construction and Materials shall comply with the City or Wichita Specifications and Standards (on file and available in the City Engineer's Office).

**Private Property:**  
 Installation and testing for the fire protection line is to be performed by a City of Wichita licensed fire protection contractor in accordance with the fire codes as adopted by the City of Wichita. All material and construction practices for the fire protection line shall comply with the fire codes as adopted by the City of Wichita (available from the City of Wichita Fire Department). The Contractor shall not commence work without notification and approval of the Wichita Fire Department. Inspection of the fire protection line is to be provided by a licensed Engineering Firm under contract with the Owner/Developer and the Fire Department. The contractor shall not start work until the project inspector is assigned to the project and present on the site. Any work done without inspection will be required to be uncovered for inspection.



**MARCH, 2007**



516 S. Market,  
 Wichita, KS 67202      316/264-0242