

**BENCHMARKS:**

BM #7 - RR Spike in West face of HLP, East side of Hydraulic,  
South of Alta Street. Sta. 155+07, 41' Rt.  
Elev. = 86.12 (City Datum)

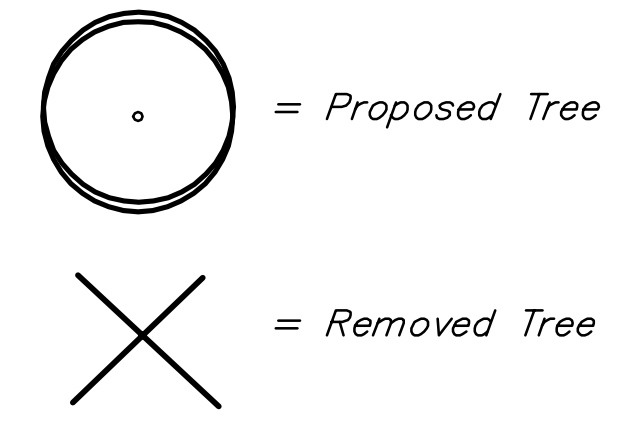
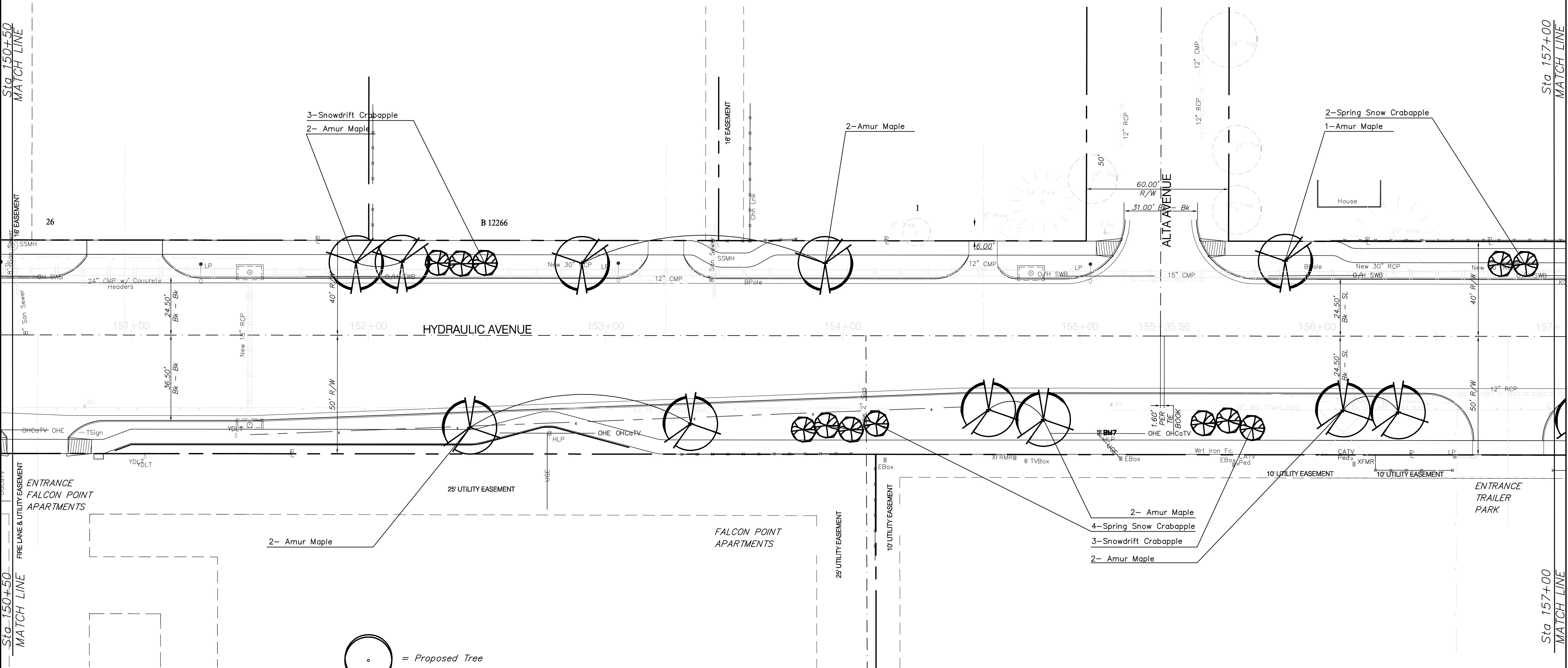
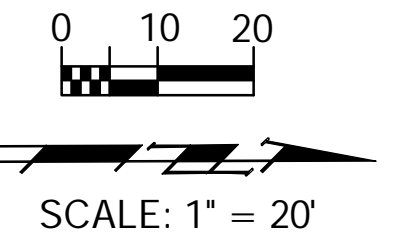

**PLANT SCHEDULE-This sheet only**

QTY	BOTANICAL NAME	COMMON NAME	SIZE	CONDITION	REMARKS
<b>ORNAMENTAL TREES</b>					
11	<i>Acer ginnala</i>	Amur Flame Maple	2" Cal.	B&B	Single Stem Only
6	<i>Malus 'Snowdrift'</i>	Snowdrift Crabapple	2" Cal.	B&B	Single Stem Only
6	<i>Malus 'Spring Snow'</i>	Spring Snow Crabapple	2" Cal.	B&B	Single Stem Only

PROJECT NUMBER 472-84118a		SHEET NAME Phase1 LS		ENGINEERING DIRECTORY E:\Hydraulic LS\	
DESIGN BDT	DRAWN BDT	APPROVED BDT/PJM	DATE Mar 07	SCALE 1"=20'	BAUGHMAN NO 99-09-E453

CAPITAL IMPROVEMENT PROJECT  
**LANDSCAPE PLAN - SEGMENT 1**  
47th STREET SOUTH to MacARTHUR ROAD

**BAUGHMAN COMPANY, P.A.**  
ENGINEERING, SURVEYING, & PLANNING  
316-262-7271 • 315 ELLIS • WICHITA, KANSAS 67211

SHEET  
7  
OF  
30