

BENCHMARK

BM#4 - Railroad Spike in Southwest Face of 24" Elm Tree
 Located at the Northeast Corner of 60th & Hydraulic
 Intersection.
 Elev. = 1265.12 MSL (77.72 City Datum)

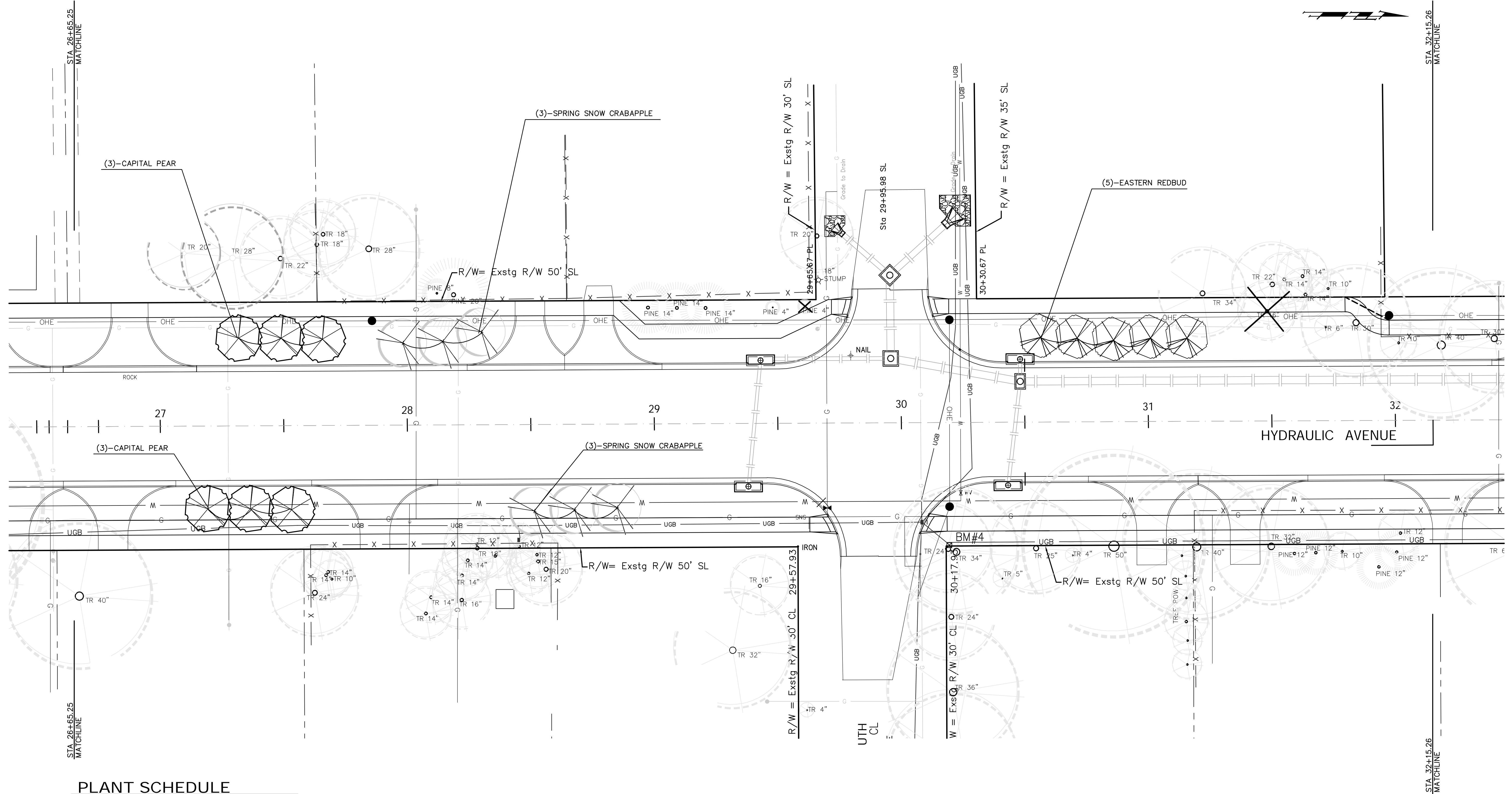

PLANT SCHEDULE

QTY	BOTANICAL NAME	COMMON NAME	SIZE	CONDITION	REMARKS
ORNAMENTAL TREES					
5	<i>Cercis canadensis</i>	Eastern Redbud	2" Cal.	B&B	Single Stem Only
6	<i>Malus 'Spring Snow'</i>	Spring Snow Crabapple	2" Cal.	B&B	Single Stem Only
6	<i>Pyrus calleryana 'Capital'</i>	Capital Pear	2" Cal.	B&B	Single Stem Only

PROJECT NUMBER 472-84118a		SHEET NAME LS 5		ENGINEERING DIRECTORY E:\HYDRAULIC LS\	
DESIGN DML	APPROVED	DATE Mar 07	SCALE 1" = 20'	BAUGHMAN NO. 05-10-E399	

CAPITAL IMPROVEMENT PROJECT
LANDSCAPE PLAN- SEGMENT 3
 Hydraulic Avenue - City Limits to 63rd

BAUGHMAN COMPANY, P.A.
 ENGINEERING, SURVEYING, & PLANNING
 316-262-7271 • 315 ELLIS • WICHITA, KANSAS 67211