

BENCHMARK

BM#5 - Railroad Spike in East Face of the Power Pole,
 Station 43+10 Hydraulic, 39' Left.
 Elev. = 1266.33 MSL (78.93 City Datum)

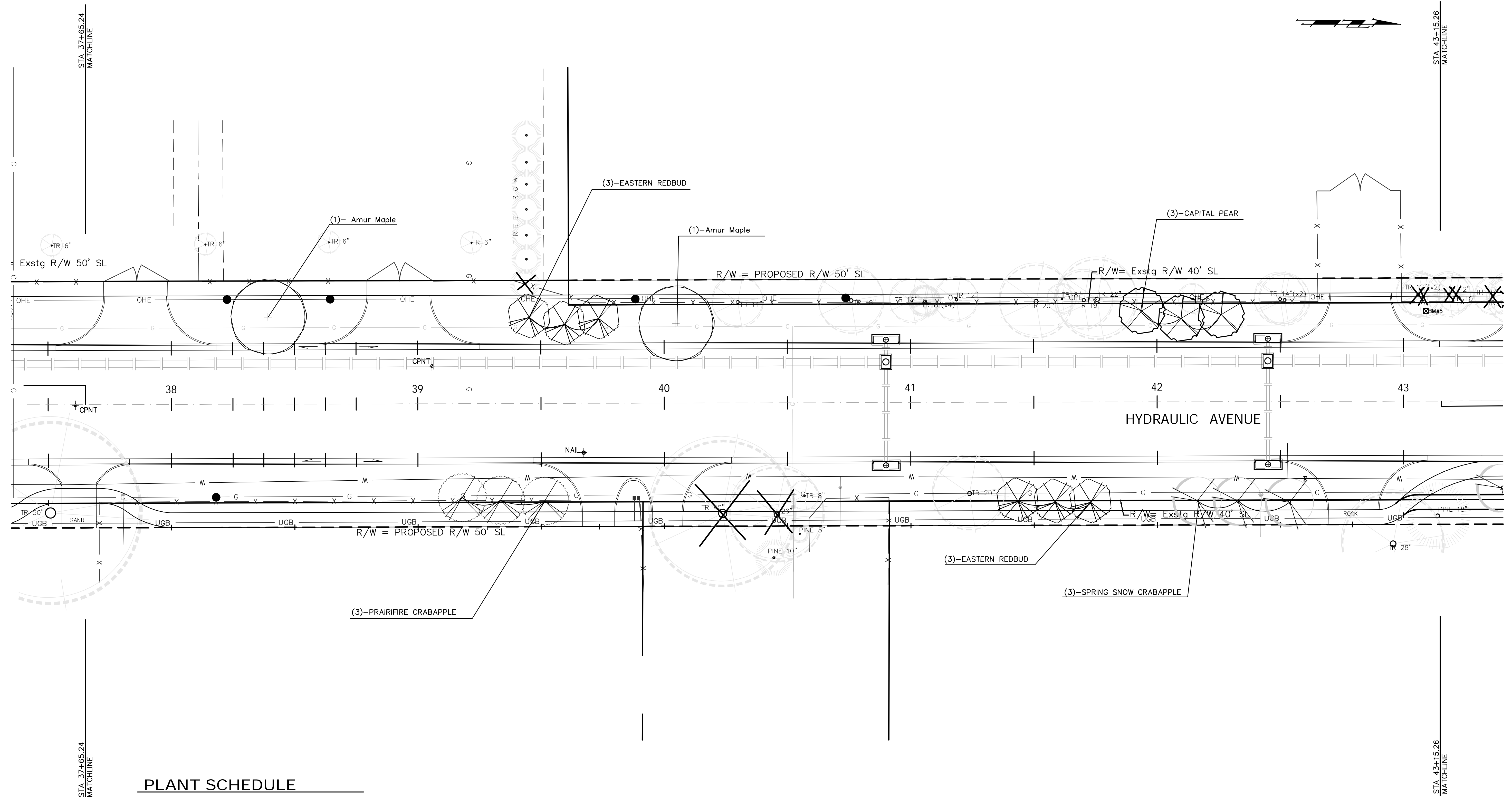

PLANT SCHEDULE

QTY	BOTANICAL NAME	COMMON NAME	SIZE	CONDITION	REMARKS
ORNAMENTAL TREES					
2	<i>Acer ginnala</i>	Amur Flame Maple	2" Cal.	B&B	Single Stem Only
6	<i>Cercis canadensis</i>	Eastern Redbud	2" Cal.	B&B	Single Stem Only
3	<i>Malus 'Prairifire'</i>	Prairifire Crabapple	2" Cal.	B&B	Single Stem Only
3	<i>Malus 'Spring Snow'</i>	Spring Snow Crabapple	2" Cal.	B&B	Single Stem Only
3	<i>Pyrus calleryana 'Capital'</i>	Capital Pear	2" Cal.	B&B	Single Stem Only

PROJECT NUMBER 472-84118a		SHEET NAME LS 5		ENGINEERING DIRECTORY E:HYDRAULIC LSI	
DESIGN	DRAWN DML	APPROVED	DATE Mar 07	SCALE 1" = 20'	BAUGHMAN NO 05-10-E399

CAPITAL IMPROVEMENT PROJECT
LANDSCAPE PLAN- SEGMENT 3
 Hydraulic Avenue - City Limits to 63rd

BAUGHMAN COMPANY, P.A.
 ENGINEERING, SURVEYING, & PLANNING
 316-262-7271 • 315 ELLIS • WICHITA, KANSAS 67211

SHEET
28
OF
30