

GENERAL NOTES

Utility service lines, poles, valve boxes, meters, and etcetera are to be adjusted as necessary by others prior to construction unless the plans specifically call for their adjustment by the Contractor. Existing utilities and their location, as shown on the plans, represent the best information obtainable for design. The Contractor will be required to work around existing utilities within the right-of-way which do not conflict with proposed construction.

A saw cut of at least one-half the depth of existing surface course or one-fourth the depth of the existing total pavement thickness shall be provided at locations where proposed construction abuts an existing surface course or pavement for which partial removal of that surface or pavement is required. Sawed joint to facilitate removal within three (3) feet of existing joints will not be permitted and for such instances the limits of removal shall extend to the existing joint. Such saw cuts will not be paid for directly and this cost shall be considered as subsidiary to the removal of the surface or pavement.

Rubble from the removal of miscellaneous structures and excess excavation which is to be wasted shall be disposed of on sites to be provided by the Contractor. These sites shall be approved by the Engineer as to suitability, appearance and site location. Locations that in the opinion of the Engineer, will leave an unsightly appearance will not be approved.

The City of Wichita's Sewer Maintenance Division of the Department of Water and Water Pollution Control has televised sewers within the limits of the project and have found no defects requiring repair. The Division shall be notified and afforded the opportunity to reteleviser sewer lines after subgrade work has been completed and prior to pavement construction to determine if such sewer lines have been damaged by the Contractor's operations. Damaged sewer lines will be repaired by the Contractor, as directed by the Engineer, at the Contractor's expense. Television logs are available for inspection by the Contractor during normal office hours at the Sewer Maintenance Division's office at City Hall.

Trees and shrubs in public right-of-way which are in direct conflict with proposed new construction shall be removed by the Contractor with the Engineer's approval. Trees and shrubs which are not in direct conflict with proposed new construction shall be saved and protected from damage.

The City shall adjust Water Valve Boxes as required by construction. Water valves, water valve boxes or fire hydrants damaged during construction shall be repaired by the Contractor at his own expense.

The City will remove existing signing as needed.

All disposal sites must be approved by the Kansas Department of Health and Environment. Material either stockpiled or disposed of in a flood plain would require a Kansas State Board of Agriculture permit. Any material dumped in water of the United States or wetlands is subject to U.S. Corps of Engineers permitting regulations.

Any material buried or stockpiled beyond approved construction limits would require additional geotechnical investigations unless buried in a previously approved borrow location.

All elevations shown in these plans are based on City of Wichita datum. To obtain elevation based on U.S.G.S. datum, add 1187.4 feet to the given elevations.

FYMA REGION NO.	STATE	PROJECT NO.	YEAR	SHEET NO.	TOTAL SHEETS
7	KANSAS		1993	6	35

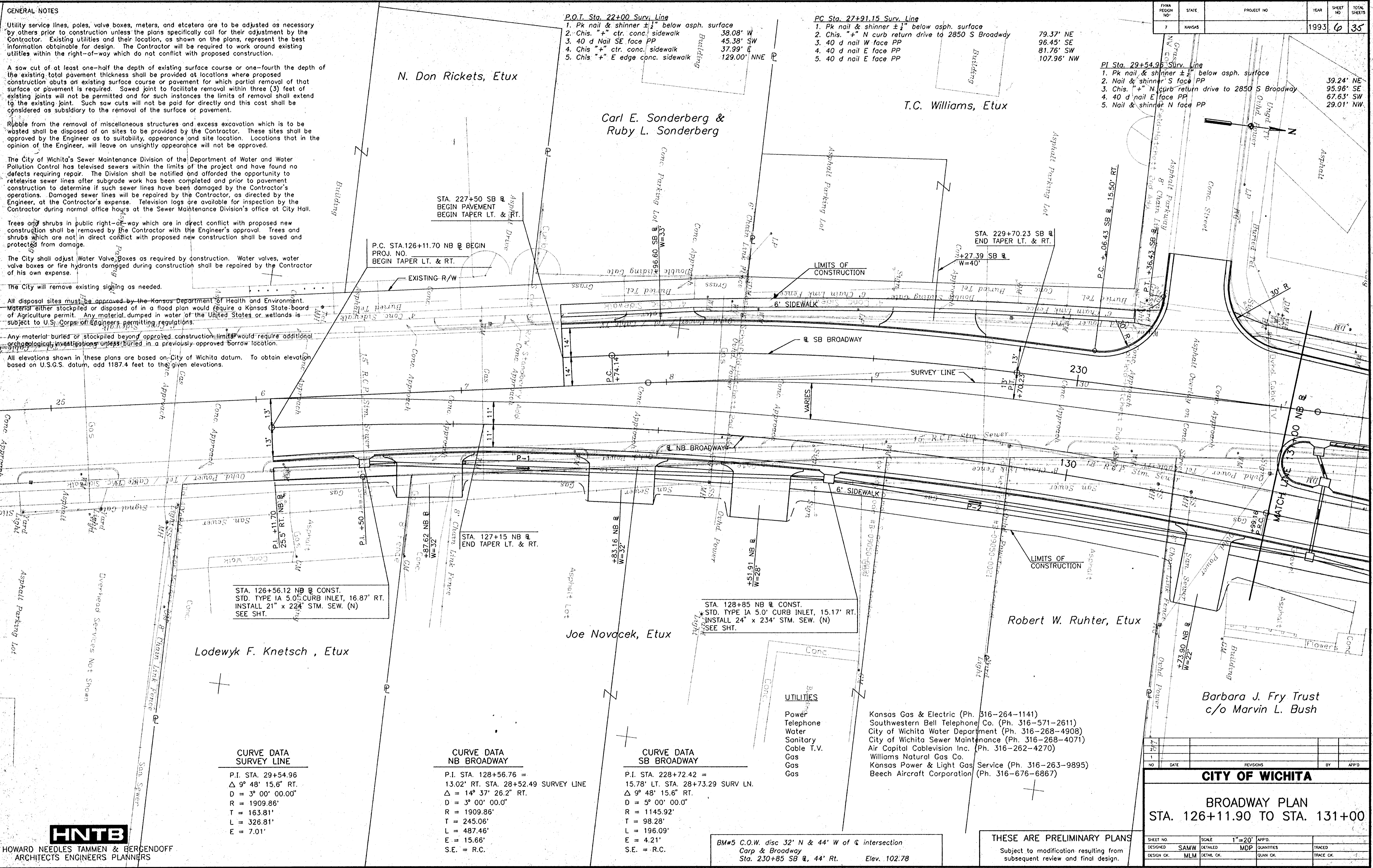

- P.O.T. Sta. 22+00 Surv. Line**
1. Pk nail & shinner ± 1" below asph. surface
 2. Chis. "+ ctr. conc. sidewalk 38.08' W
 3. 40 d nail SE face PP 45.38' SW
 4. Chis. "+ ctr. conc. sidewalk 37.99' E
 5. Chis. "+ E edge conc. sidewalk 129.00' NNE

- PC Sta. 27+91.15 Surv. Line**
1. Pk nail & shinner ± 1" below asph. surface
 2. Chis. "+ N curb return drive to 2850 S Broadway 79.37' NE
 3. 40 d nail W face PP 96.45' SE
 4. 40 d nail E face PP 81.76' SW
 5. 40 d nail E face PP 107.96' NW

- PI Sta. 29+54.96 Surv. Line**
1. Pk nail & shinner ± 1" below asph. surface
 2. Nail & shinner S face PP 39.24' NE
 3. Chis. "+ N curb return drive to 2850 S Broadway 95.96' SE
 4. 40 d nail E face PP 67.63' SW
 5. Nail & shinner N face PP 29.01' NW

STA. 126+56.12 NB CONST.
STD. TYPE IA 5.0' CURB INLET, 16.87' RT.
INSTALL 21" x 224' STM. SEW. (N)
SEE SHT.

STA. 127+15 NB B
END TAPER LT. & RT.

STA. 128+85 NB B CONST.
STD. TYPE IA 5.0' CURB INLET, 15.17' RT.
INSTALL 24" x 234' STM. SEW. (N)
SEE SHT.

STA. 227+50 SB B
BEGIN PAVEMENT
BEGIN TAPER LT. & RT.

STA. 229+70.23 SB B
END TAPER LT. & RT.

CURVE DATA SURVEY LINE

P.I. STA.	29+54.96
Δ	9° 48' 15.6" RT.
D	3° 00' 00.00"
R	1909.86'
T	163.81'
L	326.81'
E	7.01'

CURVE DATA NB BROADWAY

P.I. STA.	128+56.76 =
13.02' RT. STA.	28+52.49 SURV LN.
Δ	14° 37' 26.2" RT.
D	3° 00' 00.0"
R	1909.86'
T	245.06'
L	487.46'
E	15.66'
S.E.	= R.C.

CURVE DATA SB BROADWAY

P.I. STA.	228+72.42 =
15.78' LT. STA.	28+73.29 SURV LN.
Δ	9° 48' 15.6" RT.
D	5° 00' 00.0"
R	1145.92'
T	98.28'
L	196.09'
E	4.21'
S.E.	= R.C.

BM#5 C.O.W. disc 32' N & 44' W of Q intersection
Corp & Broadway
Sta. 230+85 SB B, 44' Rt. Elev. 102.78

- UTILITIES**
- Power
 - Telephone
 - Water
 - Sanitary
 - Cable T.V.
 - Gas
 - Gas
 - Gas
- Kansas Gas & Electric (Ph. 316-264-1141)
Southwestern Bell Telephone Co. (Ph. 316-571-2611)
City of Wichita Water Department (Ph. 316-268-4908)
City of Wichita Sewer Maintenance (Ph. 316-268-4071)
Air Capital Cablevision Inc. (Ph. 316-262-4270)
Williams Natural Gas Co.
Kansas Power & Light Gas Service (Ph. 316-263-9895)
Beech Aircraft Corporation (Ph. 316-676-6867)

THESE ARE PRELIMINARY PLANS
Subject to modification resulting from subsequent review and final design.

CITY OF WICHITA

BROADWAY PLAN
STA. 126+11.90 TO STA. 131+00

DESIGNED	SAW	SCALE	1"=20'	APP'D.	
DESIGN CK.	MLM	DETAILED	MDP	QUANTITIES	TRACED
		DETAIL CK.		QUAN CK.	TRACE CK.

HNTB
HOWARD NEEDLES TAMMEN & BERGENOFF
ARCHITECTS ENGINEERS PLANNERS

141061 PLAN 1