

FWHA REGION NO.	STATE	PROJECT NO.	YEAR	SHEET NO.	TOTAL SHEETS
7	KANSAS		1993	26	35

- PI Sta. 40+88.8 Surv. Line
1. Pk nail & shinner ctr. Broadway ±1' S of edge wearing surface at North end of bridge
  2. Chis "+" found N and E hand rail (Parapet) 25.60' NE
  3. Chis "+" Top W hand rail 40.77' SW
  4. Chis "+" N end W hand rail 41.48' NW
  5. #4 rebar 87.33' NNW

- P.O.T. Sta. 51+00 Surv. Line
1. Chis "+" in conc. 80.50' NW
  2. Spk in NE face PP 92.54' N
  3. Chis "D" SW cor top curb S end conc. island
  4. Chis "+" W side conc. base to light pole 63.56' E
  5. Chis "+" NW cor. mall sign base 113.18' SE

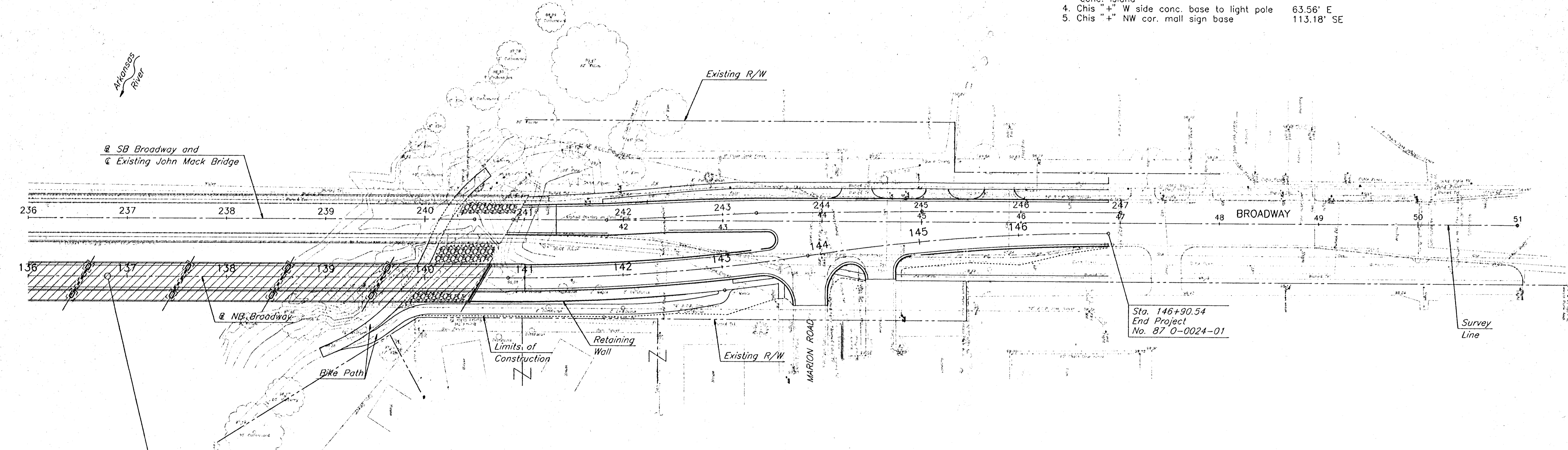

STA. 136+80.14 CONSTRUCT  
 BR. NO. 5304008700AR31  
 50'-100'-7 1/2"; 100'-7 1/2"; 100'-7 1/2"; 100'-7 1/2"; 100'-7 1/2";  
 100'-7 1/2"; 99'-8"; Prestressed Concrete Beam Spans  
 Pile Bent Abutments, Pedestal Type Piers  
 26'-8" Roadway; 9'-8" Sidewalk, 30°31' Skew Rt.

Sta. 146+90.54  
 End Project  
 No. 87 0-0024-01

Notes:  
 For General Notes, Roadway Geometry, and Hydraulic Data,  
 see Sheets 27 and 28.

K:\B14106\P3 06/03/93 15:33

**HNTB**  
 HOWARD NEEDLES TAMMEN & BERGENDOFF  
 ARCHITECTS ENGINEERS PLANNERS

THESE ARE PRELIMINARY PLANS  
 Subject to modification resulting from  
 subsequent review and final design.

3					
2					
1					
NO.	DATE	REVISIONS	BY	APP'D	
<b>CITY OF WICHITA</b>					
BR. NO. 5304008700AR31			STA. 136+80.14		
<b>CONTOUR MAP</b>					
N.B. BROADWAY OVER THE ARKANSAS RIVER					
SHEET NO.	SCALE As Shown	APP'D.	QUANTITIES	TRACED	
DESIGNED	FWG				
DESIGN CK.	WCC	QUAN. CK.		TRACE CK.	