

**GENERAL NOTES**

1. ALL ELEVATIONS SHOWN ARE BASED ON "CITY DATUM" (MEAN SEA LEVEL-1187.4)
2. CONTRACTOR WILL BE REQUIRED TO PROVIDE A MINIMUM ADVANCE NOTICE OF FORTY-EIGHT(48)HOURS TO UTILITY COMPANIES PRIOR TO STARTING ANY EXCAVATION AS FOLLOWS:

KANSAS ONE CALL (800) 344-7233

THE CONTRACTOR MUST NOTIFY THE FOLLOWING IN CASE OF AN EMERGENCY:

Cox Communications 262-4270 or 263-2061  
 SBP 1-800-870-8390  
 Kansas Gas Service 1-888-482-4950  
 Westar 1-800-383-1183  
 Aquila 1-800-303-0752  
 City of Wichita(Water & Sewer) 268-4555

THE CONTRACTOR SHALL NOTIFY PIPELINE COMPANIES AT LEAST 24 HOURS IN ADVANCE OF ANY WORK BEING PERFORMED ACROSS AND/OR ADJACENT TO PIPELINES.

3. COST OF EXCAVATION, HAULING AND DUMPING OF EXCESS EXCAVATION SHALL BE SUBSIDIARY TO OTHER ITEMS OF WORK.

4. THE CONTRACTOR SHALL NOTIFY THE INSPECTOR FOR THIS PROJECT 48 HOURS PRIOR TO BEGINNING CONSTRUCTION. THE CONTRACTOR SHALL NOT START WORK ON THE PROJECT UNTIL THE PROJECT INSPECTOR ASSIGNED TO THE PROJECT IS PRESENT ON SITE. ANY WORK DONE WITHOUT INSPECTION WILL BE REQUIRED TO BE UNCOVERED FOR INSPECTION.

5. THE CONTRACTOR SHALL GIVE ALL PROPERTY OWNERS AND/OR TENANTS OF DEVELOPED PROPERTY DIRECTLY ADJUTING THE CONSTRUCTION OF THIS PROJECT A MINIMUM OF TEN (10) DAYS ADVANCE NOTICE PRIOR TO START OF CONSTRUCTION.

6. THE CONTRACTOR SHALL BE RESPONSIBLE FOR PRESERVING PROPERTY IRONS. THE CONTRACTOR WILL BE REQUIRED TO REESTABLISH ANY PROPERTY IRONS WHICH ARE DAMAGED OR DESTROYED BY HIS CONSTRUCTION OPERATIONS SUCH IRONS SHALL BE REESTABLISHED BY A LICENSED LAND SURVEYOR IN ACCORDANCE WITH STATE LAWS.

7. THE CONTRACTOR SHALL RESTORE ALL DITCHES, SWALES, ROAD SHOULDERS, ENTRANCES AND BANK LINES TO THEIR ORIGINAL SLOPES AND GRADES EXCEPT AS SHOWN OTHERWISE.

8. INTERURBAN TRAFFIC GENERATED OUTSIDE THE PROJECT AREA SHALL NOT BE CARRIED THROUGH CONSTRUCTION.

9. UNDERGROUND UTILITY SERVICE LINES AND OVERHEAD UTILITY POLE LINES ARE TO BE ADJUSTED AS NECESSARY BY OTHERS PRIOR TO CONSTRUCTION UNLESS THE PLANS SPECIFICALLY CALL FOR THEIR ADJUSTMENT BY THE CONTRACTOR OR UNLESS THE PLANS SPECIFICALLY IDENTIFY A UTILITY TO BE ADJUSTED BY ITS OWNER DURING CONSTRUCTION. EXISTING UTILITIES AND THEIR LOCATION, AS SHOWN ON THE PLANS, REPRESENT THE BEST INFORMATION OBTAINABLE FOR DESIGN. LOCATION INFORMATION HAS BEEN OBTAINED FROM THE VARIOUS UTILITY COMPANIES AND IS EITHER FROM COMPANY RECORD DRAWINGS OR COMPANY PROVIDED FIELD LOCATIONS. THE CONTRACTOR WILL BE REQUIRED TO WORK AROUND EXISTING UTILITIES WITHIN THE RIGHT-OF-WAY WHICH DO NOT CONFLICT WITH PROPOSED CONSTRUCTION.

10. RUBBLE FROM THE REMOVAL OF MISCELLANEOUS STRUCTURES AND EXCESS EXCAVATION WHICH IS TO BE DESTROYED OR ON SITES TO BE PROVIDED BY THE CONTRACTOR. THESE SITES SHALL BE APPROVED BY THE ENGINEER AS TO SUITABILITY, APPEARANCE AND SITE LOCATION. LOCATIONS, THAT IN THE OPINION OF THE ENGINEER, WILL LEAVE AN UNSIGHTLY APPEARANCE WILL NOT BE APPROVED. ALL DISPOSAL SITES MUST BE APPROVED BY THE KANSAS DEPARTMENT OF HEALTH AND ENVIRONMENT. MATERIAL EITHER STOCKPILED OR DISPOSED OF IN A FLOODPLAIN WOULD REQUIRE A KANSAS STATE BOARD OF AGRICULTURE PERMIT. ANY MATERIAL DUMPED IN WATERS OF THE UNITED STATES OR WETLANDS IS SUBJECT TO U.S. CORPS OF ENGINEERS PERMITTING REGULATIONS. ANY MATERIAL BURIED OR STOCKPILED BEYOND APPROVED CONSTRUCTION LIMITS WOULD REQUIRE ADDITIONAL ARCHAEOLOGICAL INVESTIGATIONS UNLESS BURIED IN A PREVIOUSLY APPROVED BORROW LOCATION.

11. PROPERTIES WITHIN THE PROJECT LIMITS MAY HAVE UNDERGROUND SPRINKLER SYSTEMS IN THE PUBLIC RIGHT-OF-WAY WHICH CONFLICT WITH NEW CONSTRUCTION. CONTRACTOR WILL BE REQUIRED TO REMOVE SUCH IMPROVEMENTS SHOULD THEY NOT BE REMOVED BY THEIR OWNER AT THE TIME OF CONSTRUCTION OF THE PROJECT. THE CONTRACTOR WILL BE REQUIRED TO SALVAGE ALL SPRINKLER HEADS AND/OR VALVES AND GIVE SUCH MATERIAL TO THEIR OWNER. PORTIONS OF UNDERGROUND SPRINKLER SYSTEMS NOT IN CONFLICT WITH NEW CONSTRUCTION SHALL BE PROTECTED FROM DAMAGE AND SHALL REMAIN IN PLACE. ALL WORK IN CONNECTION WITH UNDERGROUND SPRINKLER SYSTEMS SHALL BE CONSIDERED AS SUBSIDIARY TO THE CONTRACT PAY ITEMS OF WORK.

12. ALL PROPOSED STUBS AND PLUGGED PIPES SHALL BE LOCATED WITH GREEN PLASTIC TAPE.

14. THE CONTRACTOR MUST EXAMINE THE CONSTRUCTION SITE PRIOR TO BIDDING AND BE SATISFIED AS TO THE WORK SHOWN FOR COMPLETION. AFTER BIDS HAVE BEEN RECEIVED, THE CONTRACTOR SHALL NOT ASSERT THAT THERE WAS A MISUNDERSTANDING OF THE QUANTITIES OF WORK OR OF THE NATURE FOR THE WORK TO BE COMPLETED.

15. EXISTING UTILITIES AND THEIR LOCATION, AS SHOWN ON THE PLANS, REPRESENT THE BEST INFORMATION AVAILABLE FOR DESIGN. LOCATION INFORMATION HAS BEEN OBTAINED FROM THE VARIOUS UTILITY COMPANIES AND IS EITHER FROM COMPANY RECORD DRAWINGS OR COMPANY PROVIDED FIELD LOCATIONS. THE PLAN LOCATIONS ARE NOT GUARANTEED. ADDITIONAL EXISTING UTILITIES MAY ALSO BE ENCOUNTERED. THE CONTRACTOR WILL BE REQUIRED TO WORK AROUND EXISTING UTILITIES WHICH ARE ENCOUNTERED ON THIS PROJECT. THE CONTRACTOR SHALL EXERCISE EXTREME CAUTION DURING TRENCHING OPERATIONS TO AVOID DAMAGING THESE LINES. ANY LINES DAMAGED SHALL BE REPLACED OR REPAIRED IMMEDIATELY AS DIRECTED BY THE ENGINEER AT THE CONTRACTOR'S EXPENSE.

17. THE CONTRACTOR SHALL CONTAIN HIS OPERATIONS TO PERMIT TRAFFIC THROUGH AND ACROSS EXISTING ROADWAYS AT ALL TIMES. THE CONTRACTOR SHALL ERECT WARNING SIGNS, FLASHING LIGHTS, AND BARRICADES IN COMPLIANCE WITH THE MANUAL ON UNIFORM TRAFFIC CONTROL DEVICES TO ENSURE SAFETY AS DIRECTED IN THE GENERAL CONDITIONS. THE CONTRACTOR SHALL LIMIT THE EXTENT OF TRENCH TO REMAIN OPEN OVERNIGHT AND WEEKENDS TO LESS THAN 50 FEET.

18. ALL LAWN/TURF AREAS DISTURBED BY CONSTRUCTION OF THE PROPOSED IMPROVEMENTS SHALL BE RESTORED WITH THE SAME GRASS/SOD AS EXISTING. RESTORATION OF DISTURBED AREAS SHALL INCLUDE, BUT NOT BE LIMITED TO, TOP SOIL PREPARATION, SEEDING, MULCH, AND/OR RESEEDING. ALL SEEDING/SODDING WORK SHALL BE IN ACCORDANCE WITH THE CITY OF SALINA STANDARD SPECIFICATIONS. ALL COSTS FOR THIS WORK SHALL BE SUBSIDIARY TO THE LUMP SUM PRICE BID FOR 'SITE RESTORATION'.

19. CUTS MADE TO PAVED SURFACES ON PUBLIC PROPERTY WILL BE REPAIRED BY THE CITY'S CONTRACTOR AND CHARGED AGAINST THE OWNER/APPLICANT. UNIT REPAIR PRICES ARE AVAILABLE FROM THE CITY AT 268-4418. A SURCHARGE MAY BE APPLICABLE. CALL 268-4418 FOR DETAILS. REPAIR COSTS TO BE PAID PRIOR TO RELEASE OF WATER SERVICE IF WATER SERVICE IS AFFECTED.

# SANITARY SEWER IMPROVEMENTS TO SERVE

## WESLEY MEDICAL OFFICE BUILDING LOCATED AT 3226 E. MURDOCK, (PART OF LOT 1, BLOCK 1, WESLEY MEDICAL CENTER 5TH ADDITION), WICHITA, KANSAS COW PRIV. PROJ. NO. 1759 PPS (607861) JAMES L. ARMOUR, P.E., CITY ENGINEER APRIL 2007

**INDEX OF SHEETS**

- C3.1 Title Sheet
- C3.2 Site Plan
- C3.3 SS Plan/Profile
- C3.4 SS Manhole Details

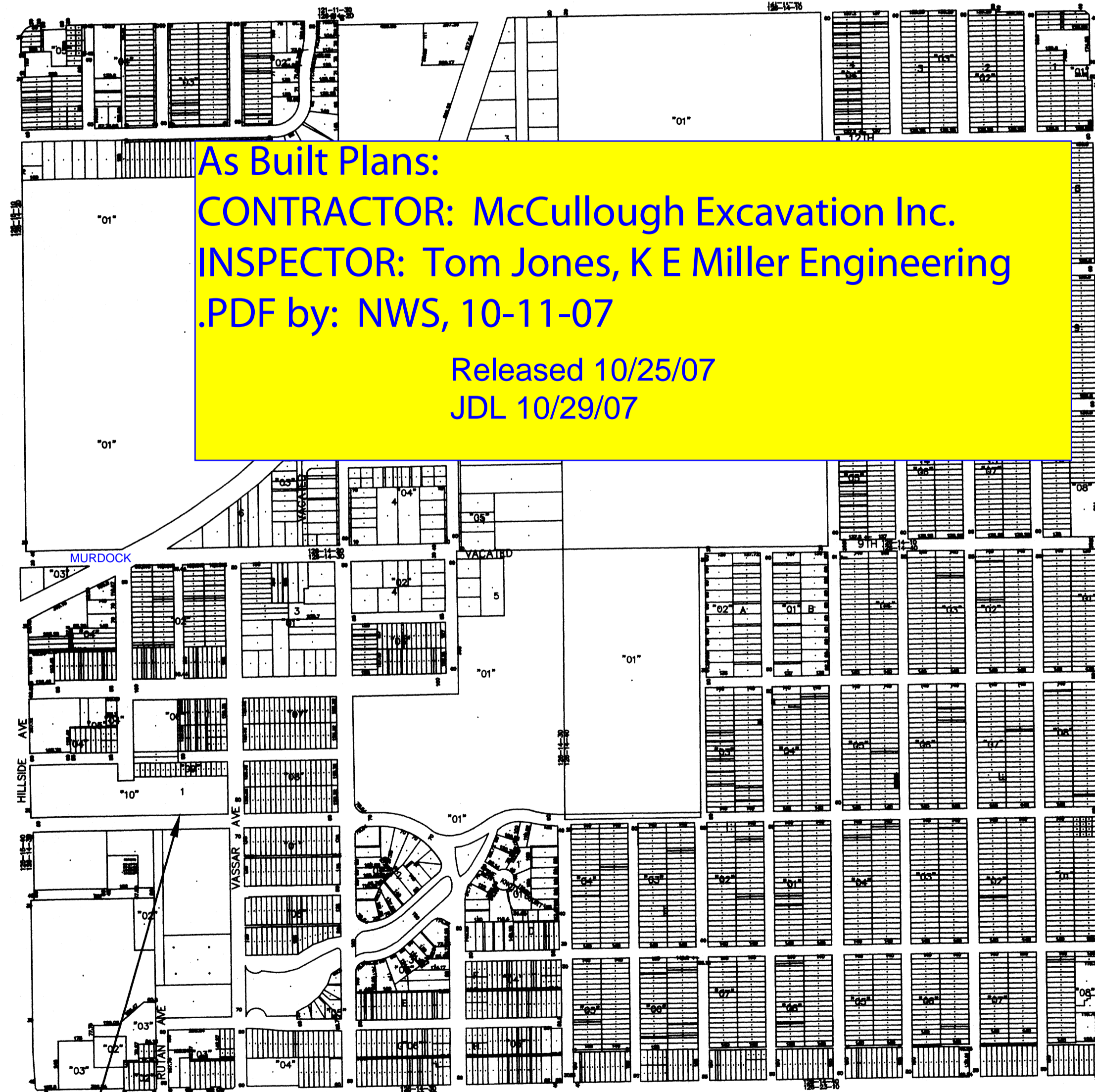
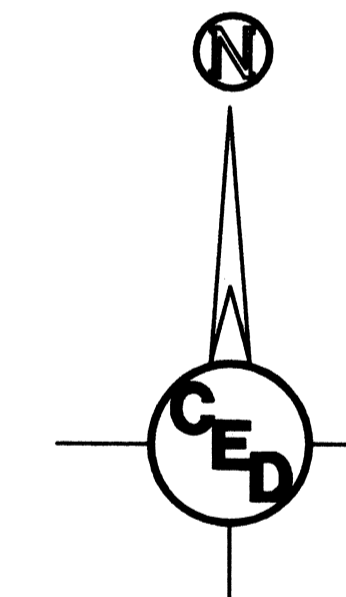
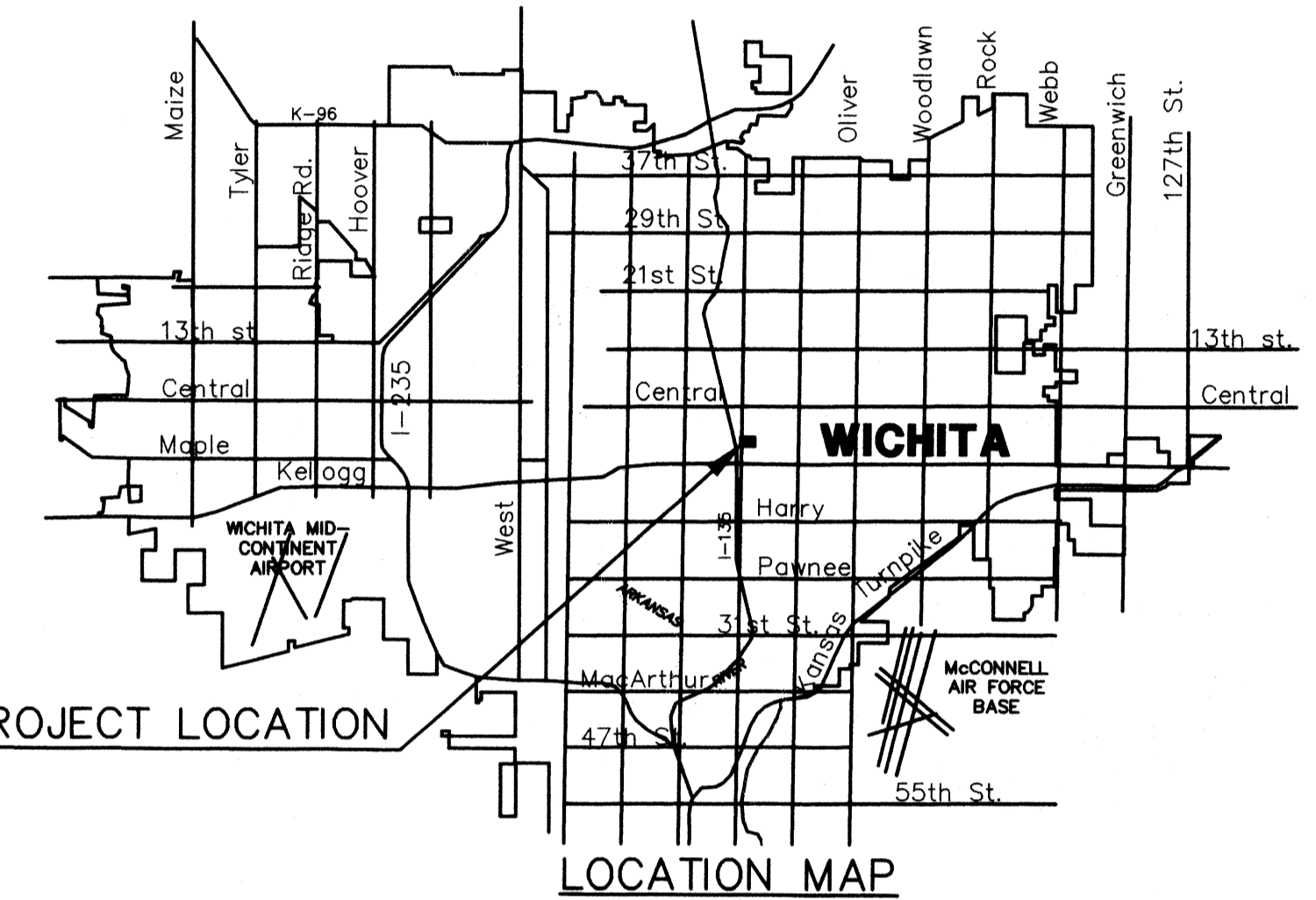

**As Built Plans:**  
**CONTRACTOR: McCullough Excavation Inc.**  
**INSPECTOR: Tom Jones, K E Miller Engineering**  
**.PDF by: NWS, 10-11-07**  
**Released 10/25/07**  
**JDL 10/29/07**

BENEFIT DISTRICT

PROJECT LOCATED IN THE  
N.E.1/4, SEC. 21, T.27S., R.1E.  
WICHITA, SEDGWICK COUNTY, KANSAS

APPROVED AS NOTED  
By CITY ENGINEER OF WICHITA  
 Sanitary Sewers IRH 4/6/07  
 Storm Sewers \_\_\_\_\_  
 Driveway Approaches \_\_\_\_\_  
 Water Mains \_\_\_\_\_  
 Paving \_\_\_\_\_

**NOTE TO CONTRACTOR**

INSPECTION AND TESTING FOR THIS PROJECT IS TO BE PROVIDED BY A LICENSED CONSULTING ENGINEERING FIRM UNDER CONTRACT WITH THE OWNER/DEVELOPER. SAID INSPECTION TO BE IN ACCORDANCE WITH THE CITY OF WICHITA STANDARD CONSTRUCTION ENGINEERING PRACTICES AND CERTIFIED BY A LICENSED PROFESSIONAL ENGINEER. NO WORK SHALL BE PERFORMED IN DEDICATED EASEMENTS OR THE PUBLIC RIGHT-OF-WAY BY THE CONTRACTOR WITHOUT SUCH INSPECTION NOR SHALL ANY WORK BE COMMENCED IN DEDICATED EASEMENTS OR PUBLIC RIGHT-OF-WAY WITHOUT WRITTEN AUTHORIZATION BY THE CITY ENGINEER.

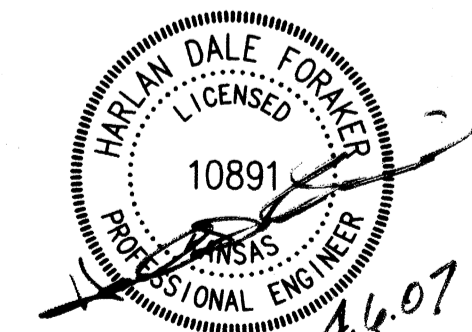

COW PROJ. NO.: 1759 PPS (607861)  
**CERTIFIED ENGINEERING DESIGN, P.A.**  
 810 WEST DOUGLAS, SUITE C  
 WICHITA, KANSAS 67203  
 PH: (316) 262-8808  
 FAX: (316) 262-1669

SHEET C3.1  
 TOTAL C3.4

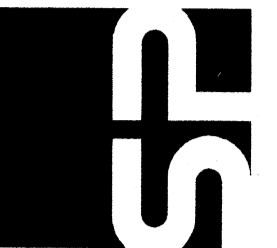

**SPANGENBERG PHILLIPS  
ARCHITECTURE**  
 121 N. Mead, Suite 201, Wichita, KS 67202  
 TEL: 316.267.4002 FAX: 316.2657.1509  
 www.spangenbergphillips.com

WESLEY MEDICAL OFFICE BUILDING  
SANITARY SEWER IMPROVEMENTS  
 3226 E. MURDOCK, WICHITA, KS

CONSTRUCTION SET  
APRIL 07

TITLE SHEET

C3.1

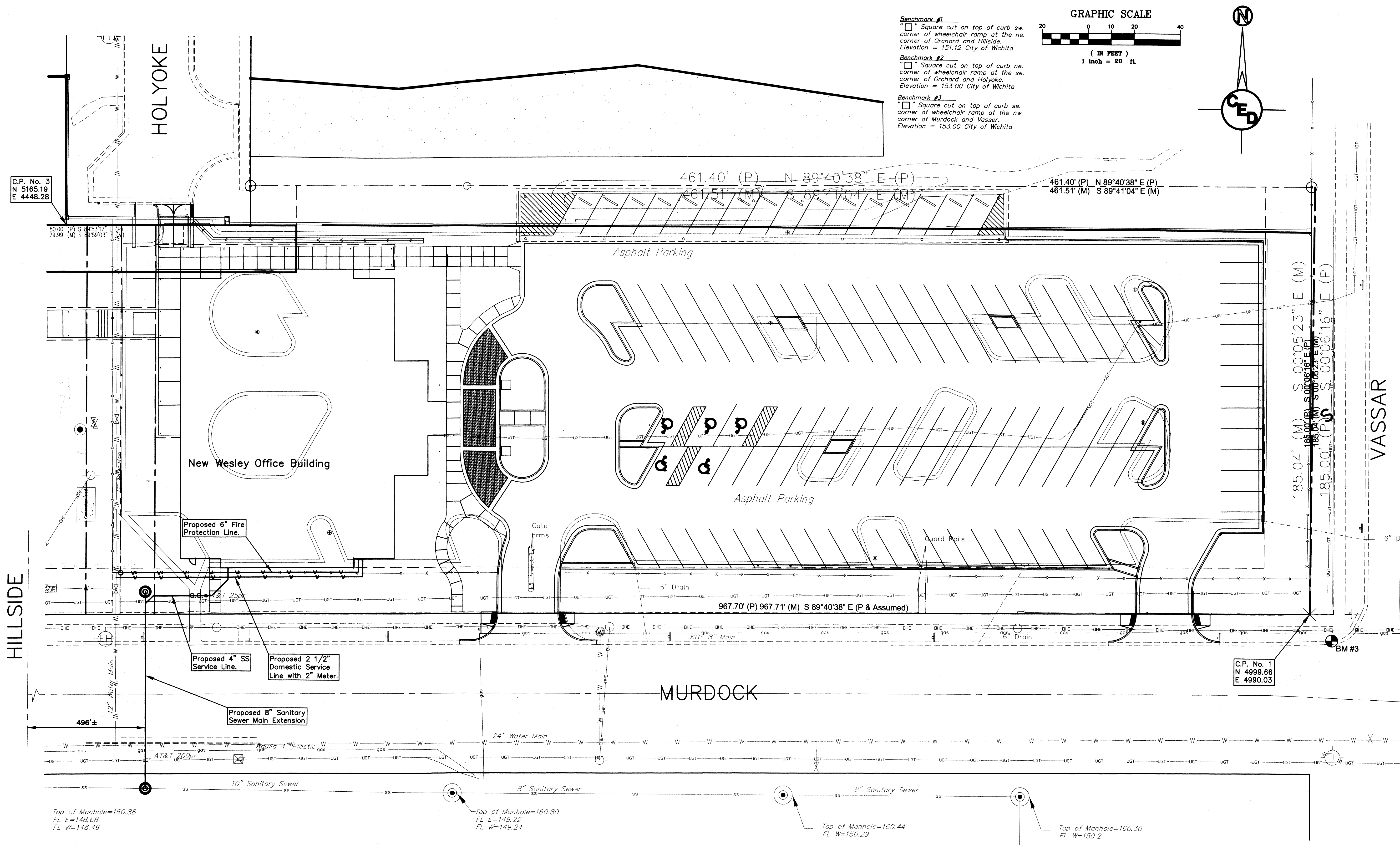

**Benchmark #1**  
 Square cut on top of curb sw. corner of wheelchair ramp at the ne. corner of Orchard and Hillside. Elevation = 151.12 City of Wichita

**Benchmark #2**  
 Square cut on top of curb ne. corner of wheelchair ramp at the se. corner of Orchard and Holyoke. Elevation = 153.00 City of Wichita

**Benchmark #3**  
 Square cut on top of curb se. corner of wheelchair ramp at the nw. corner of Murdock and Vassar. Elevation = 153.00 City of Wichita

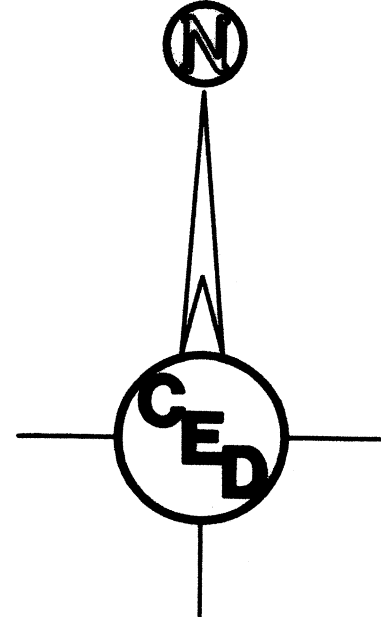
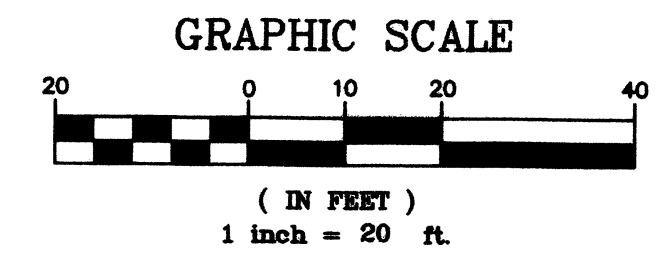

C.P. No. 3  
 N 5165.19  
 E 4448.28

C.P. No. 1  
 N 4999.66  
 E 4990.03

**SURVEY DISCLAIMER:**  
 TOPOGRAPHIC SURVEY USED IN PREPARING PLANS WAS PROVIDED BY ARROWHEAD LAND SURVEYING, 13110 E. MAPLE GROVE ROAD, MT. HOPE, KS 67108 (316-445-2221). ENGINEER DOES NOT GUARANTEE SURVEY ELEVATIONS FOR ACCURACY. CONTRACTOR SHALL VERIFY ELEVATIONS AND NOTIFY ENGINEER OF ANY DISCREPANCIES.

UTILITIES SHOWN REPRESENT THE BEST INFORMATION AVAILABLE FOR DESIGN. ADDITIONAL UTILITIES MAY BE PRESENT ON THIS PROJECT. THE CONTRACTOR SHALL BE RESPONSIBLE FOR DETERMINING THE EXACT LOCATION, DEPTH AND SIZE OF ALL UNDERGROUND UTILITIES PRIOR TO CONSTRUCTION. THE CONTRACTOR SHALL BE LIABLE FOR ANY DAMAGE CAUSED BY THE FAILURE TO DO SO.

HORIZONTAL CONTROL POINTS		
C.P. NO. 1	N 4999.66 E 4990.03	"X" Cut (Found) in sidewalk (SE Cor. of Lot 1, Block 1)
C.P. NO. 2	N 4994.45 E 4022.33	"X" Cut (Found) in sidewalk (SW Cor. of Lot 1, Block 1)
C.P. NO. 3	N 5165.19 E 4448.28	5/8" Rebar w/RLS 1294 Cap (SW R/W Cor. of Holyoke, N. side of Lot.)

CED PROJ. NO.: 20061463		SHEET	
<b>CERTIFIED ENGINEERING DESIGN, P.A.</b>		C3.2	
810 WEST DOUGLAS, SUITE C		TOTAL C3.4	
WICHITA, KANSAS 67203			
PH: (316) 262-8808			
FAX: (316) 262-1669			

**SPANGENBERG PHILLIPS ARCHITECTURE**  
 121 N. Mead, Suite 201, Wichita, KS 67202  
 TEL: 316.267.4002 FAX: 316.267.1509  
 www.spangenbergphillips.com

WESLEY MEDICAL CENTER  
 MEDICAL OFFICE BUILDING

SITE PLAN  
 C3.2

**SURVEY DISCLAIMER:**  
 TOPOGRAPHIC SURVEY USED IN PREPARING PLANS WAS PROVIDED BY ARROWHEAD LAND SURVEYING, 13110 E. MAPLE GROVE ROAD, MT. HOPE, KS 67108 (316-445-2221). ENGINEER DOES NOT GUARANTEE SURVEY ELEVATIONS FOR ACCURACY. CONTRACTOR SHALL VERIFY ELEVATIONS AND NOTIFY ENGINEER OF ANY DISCREPANCIES.

UTILITIES SHOWN REPRESENT THE BEST INFORMATION AVAILABLE FOR DESIGN. ADDITIONAL UTILITIES MAY BE PRESENT ON THIS PROJECT. THE CONTRACTOR SHALL BE RESPONSIBLE FOR DETERMINING THE EXACT LOCATION, DEPTH AND SIZE OF ALL UNDERGROUND UTILITIES PRIOR TO CONSTRUCTION. THE CONTRACTOR SHALL BE LIABLE FOR ANY DAMAGE CAUSED BY THE FAILURE TO DO SO.

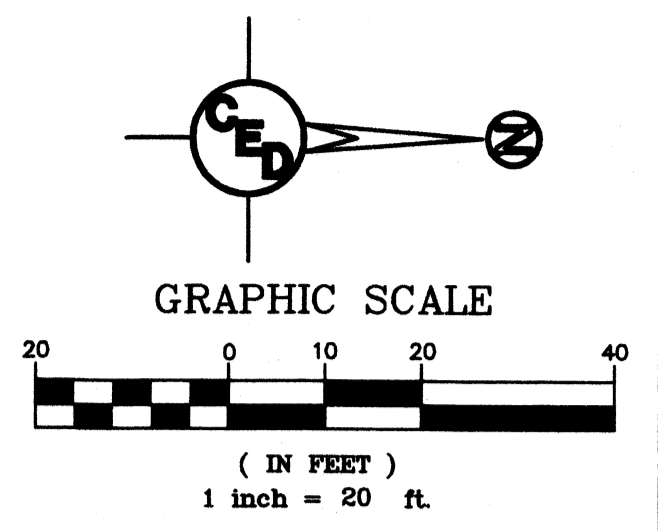
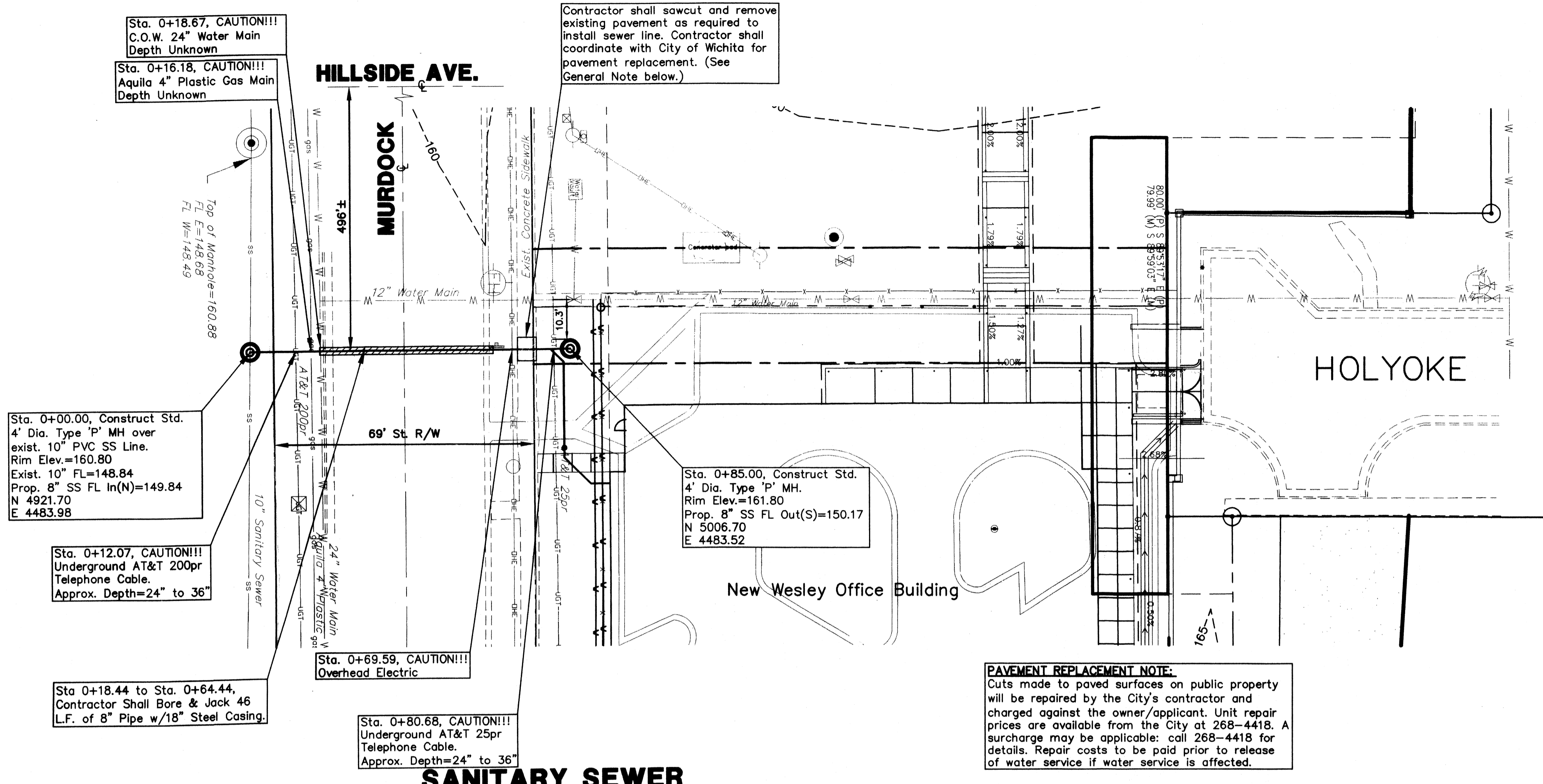

**Benchmark #1**  
 Square cut on top of curb sw. corner of wheelchair ramp at the ne. corner of Orchard and Hillside. Elevation = 151.12 City of Wichita

**Benchmark #2**  
 Square cut on top of curb ne. corner of wheelchair ramp at the se. corner of Orchard and Holyoke. Elevation = 153.00 City of Wichita

**Benchmark #3**  
 Square cut on top of curb se. corner of wheelchair ramp at the nw. corner of Murdock and Vasser. Elevation = 153.00 City of Wichita

**HORIZONTAL CONTROL POINTS**

C.P. NO. 1	N 4999.86 E 4990.03	"X" Cut (Found) in sidewalk (SE Cor. of Lot 1, Block 1)
C.P. NO. 2	N 4994.45 E 4022.33	"X" Cut (Found) in sidewalk (SW Cor. of Lot 1, Block 1)
C.P. NO. 3	N 5165.19 E 4448.28	5/8" Rebar w/RLS 1294 Cap (SW R/W Cor. of Holyoke, N. side of Lot.)

Sta. 0+00.00, Construct Std. 4' Dia. Type 'P' MH over exist. 10" PVC SS Line. Rim Elev.=160.80  
 Exist. 10" SS FL In(N)=149.84  
 N 4921.70  
 E 4483.98

Sta. 0+12.07, CAUTION!!!  
 Underground AT&T 200pr Telephone Cable.  
 Approx. Depth=24" to 36"

Sta 0+18.44 to Sta. 0+64.44,  
 Contractor Shall Bore & Jack 46 L.F. of 8" Pipe w/18" Steel Casing.

Sta. 0+69.59, CAUTION!!!  
 Overhead Electric

Sta. 0+85.00, Construct Std. 4' Dia. Type 'P' MH. Rim Elev.=161.80  
 Prop. 8" SS FL Out(S)=150.17  
 N 5006.70  
 E 4483.52

**PAVEMENT REPLACEMENT NOTE:**  
 Cuts made to paved surfaces on public property will be repaired by the City's contractor and charged against the owner/applicant. Unit repair prices are available from the City at 268-4418. A surcharge may be applicable: call 268-4418 for details. Repair costs to be paid prior to release of water service if water service is affected.

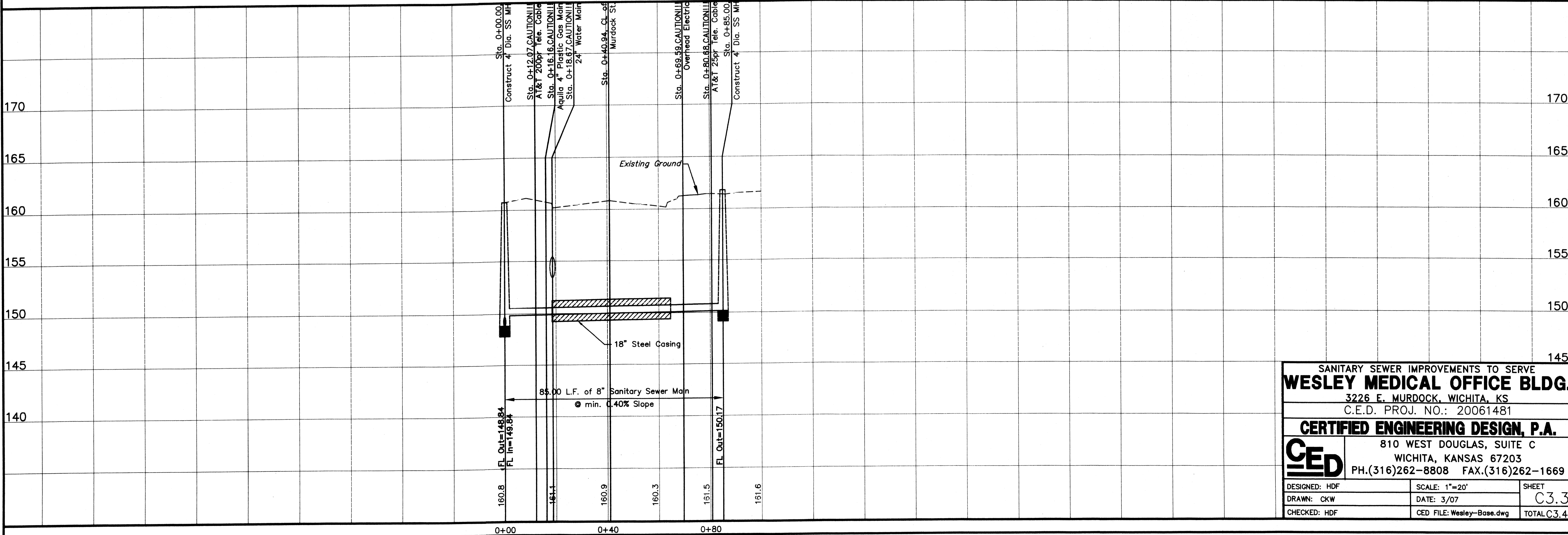

SANITARY SEWER IMPROVEMENTS TO SERVE  
**WESLEY MEDICAL OFFICE BLDG.**  
 3226 E. MURDOCK, WICHITA, KS  
 C.E.D. PROJ. NO.: 20061481

**CERTIFIED ENGINEERING DESIGN, P.A.**  
 810 WEST DOUGLAS, SUITE C  
 WICHITA, KANSAS 67203  
 PH.(316)262-8808 FAX.(316)262-1669

DESIGNED: HDF SCALE: 1"=20' SHEET  
 DRAWN: CKW DATE: 3/07 C3.3  
 CHECKED: HDF CED FILE: Wesley-Base.dwg TOTAL C3.4