

B.M. 73581 "X" on E Elm MH W.S. Madison S. So. of North Ch. Wassall  
 B.M. 9867 "4" in top 1' c/c outfall str. 30' So. of 6.5 W. N.W. cor. Jennings Ad. 2

Excav.  
 X- Sect 21.6  
 171.2  
 202.8  
 +10% 26.2  
 Total 233.1 Cu. Yds.

NOTE: The removal & resetting of guard posts will be a non-pay item, & shall be considered in the price bid for excavation

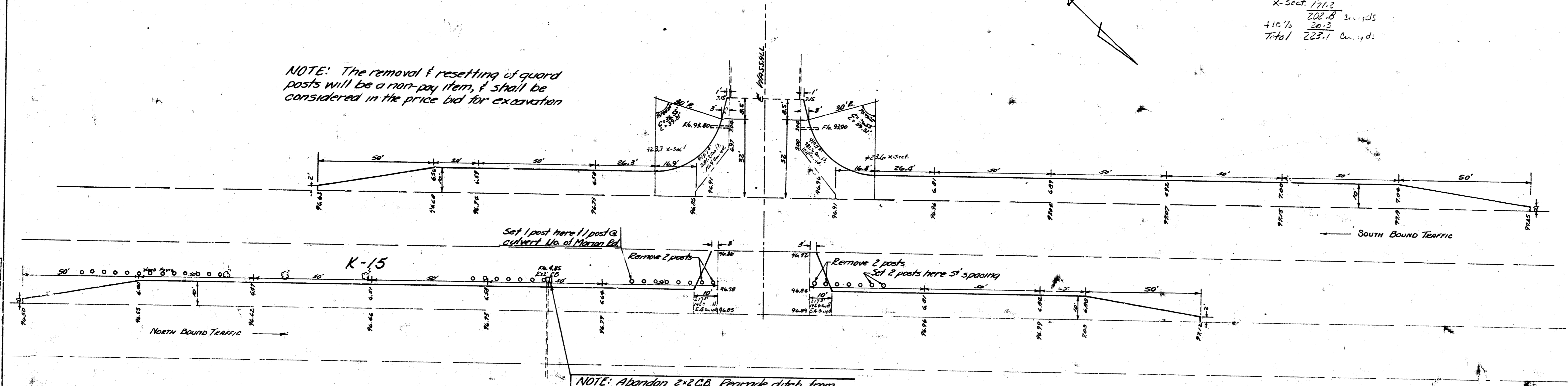

NOTE: Abandon 2x2 C.C. Regrade ditch from crossover S.S. Wassall to 250' S. of crossover. Ditch bottom to be 1" below elev. of edge of new pit. & of ditch to be 5" W. of edge of new pit. Regrading ditch will be a non-pay item; shall be considered in the price bid for excavation.

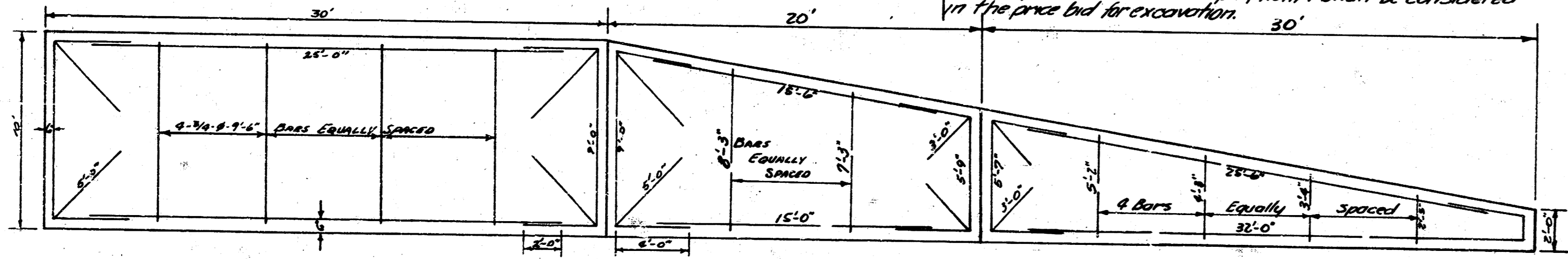

STEEL PATTERN

1/3

K-15  
 INTERSECTION AT WASSALL  
 INTERSECTION AT MARION RD.  
 WASSALL 8' CONC. MARION RD 6' CONC.  
 CITY OF WICHITA KANSAS  
 BE SMITH CITY ENGINEER  
 SEPT. 1955 GAS TAX RECORD 81-351-36

