

1-21 ICE-25 VE for Concrete Signal L.H. S.E. Cor. Geo. Wash. & Harry
 1-22 11-25 for Mankin stop sign at N.E. Cor. Geo. Wash. & Harry
 1-23 11-25 for N.E. Cor. Geo. Wash. & Harry
 1-24 11-25 for N.E. Cor. Geo. Wash. & Harry
 1-25 11-25 for N.E. Cor. Geo. Wash. & Harry

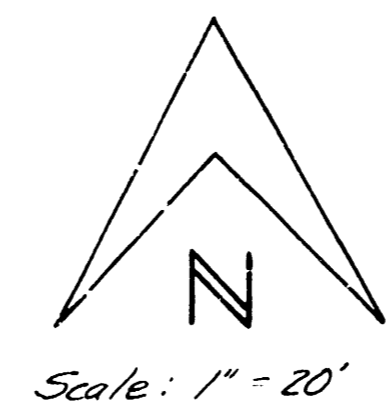
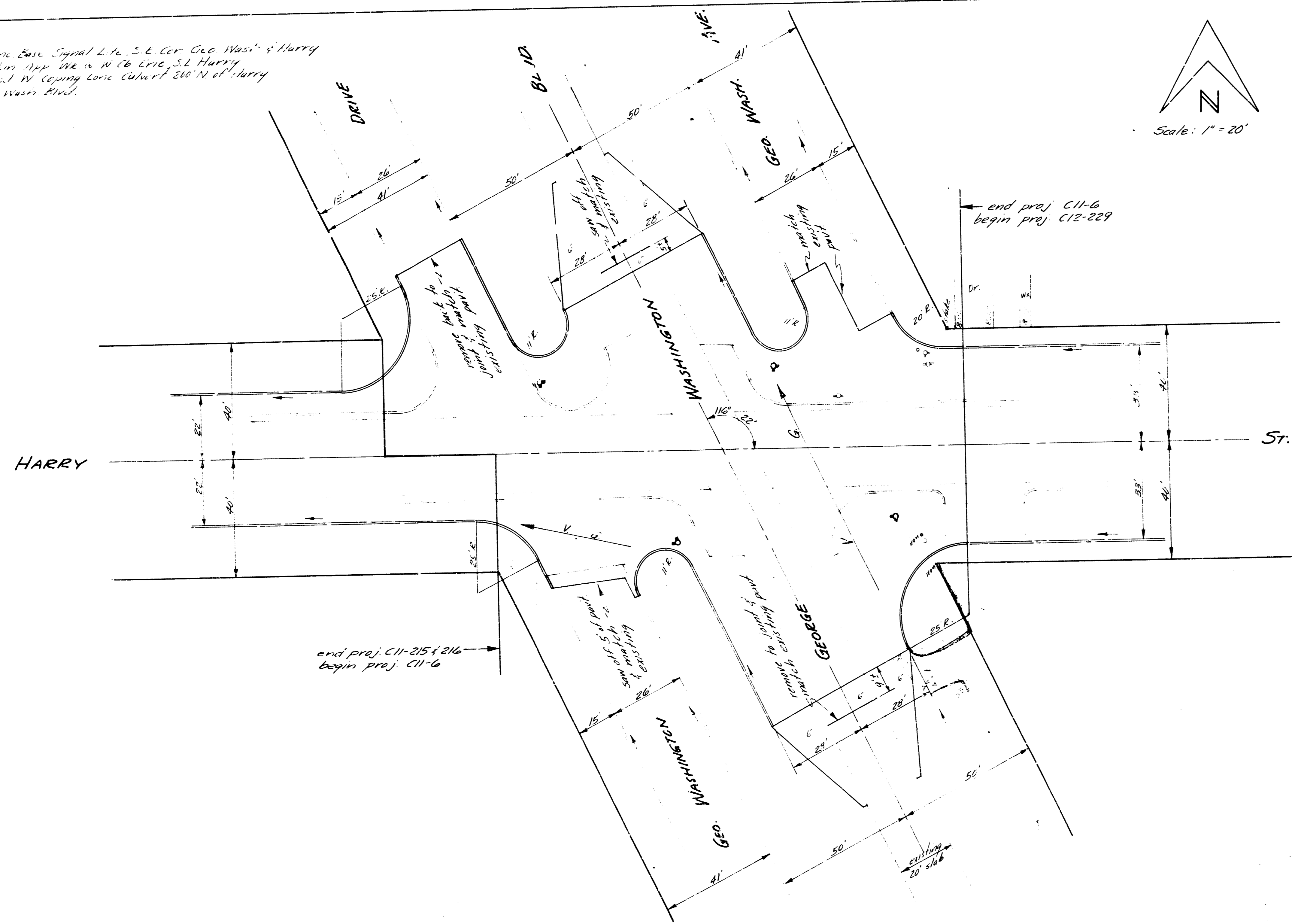

NOTE TO CONTRACTOR & FIELD ENGINEER:
 The City Engineer is to approve schedule of work.
 This project is to be completed & open to
 traffic in as short of construction time as
 possible. If early cement used to be utilized
 in any place of 28 days prior.
 The Field Engineer is to measure & record all
 removal preliminary & final sections etc.
 to be taken for final excavation quantities.

INTERSECTION
 GEO. WASH. BLVD. & HARRY ST.
 8" CONCRETE
 CITY OF WICHITA, KANSAS
 B. E. SMITH - CITY ENGINEER
 AUG 1957 Proj. No. C11-6

1
 2

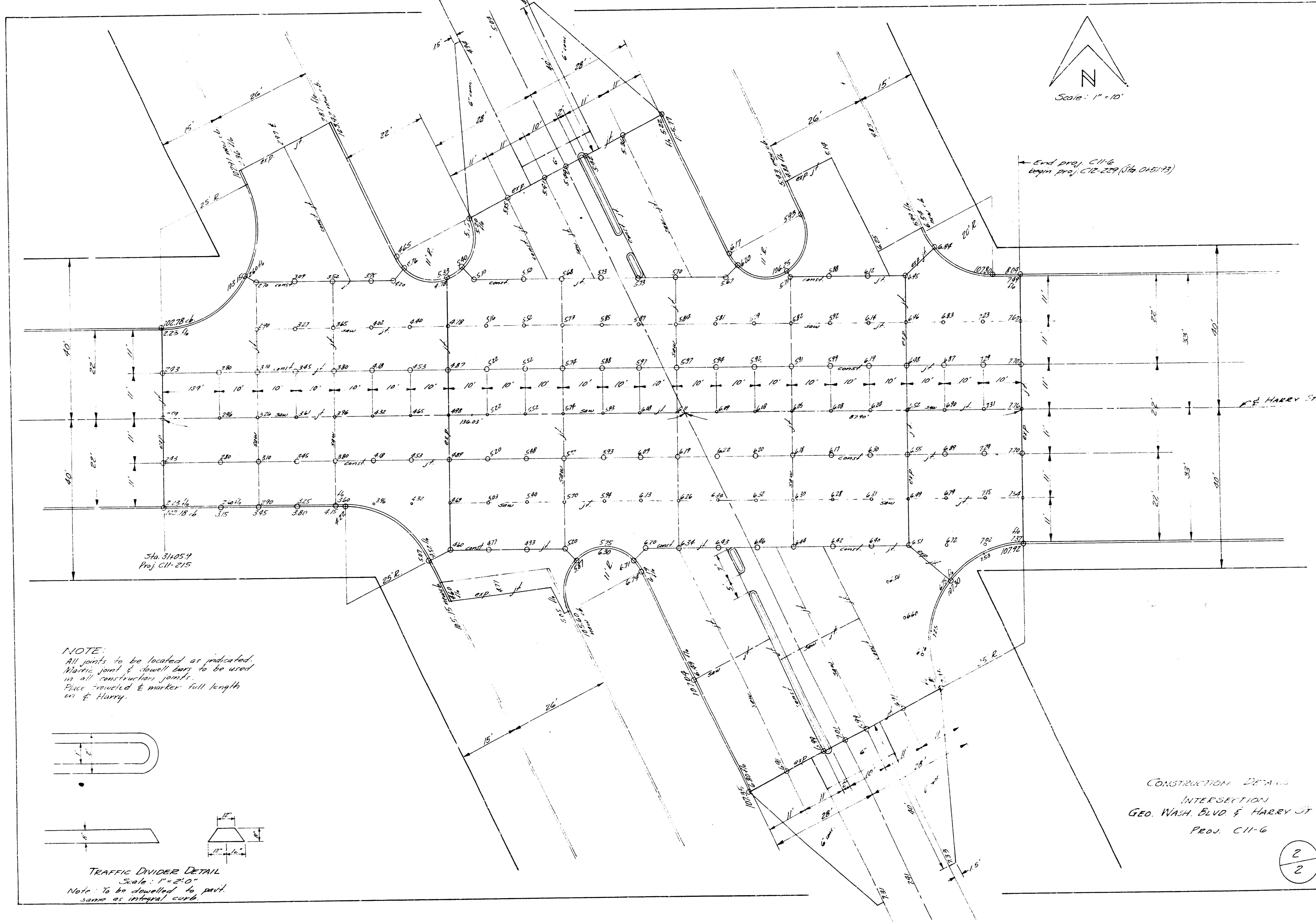

NOTE:
 All joints to be located as indicated.
 Planing joint & dowel bars to be used
 in all construction joints.
 Place traveled & marker full length
 on E Harry.

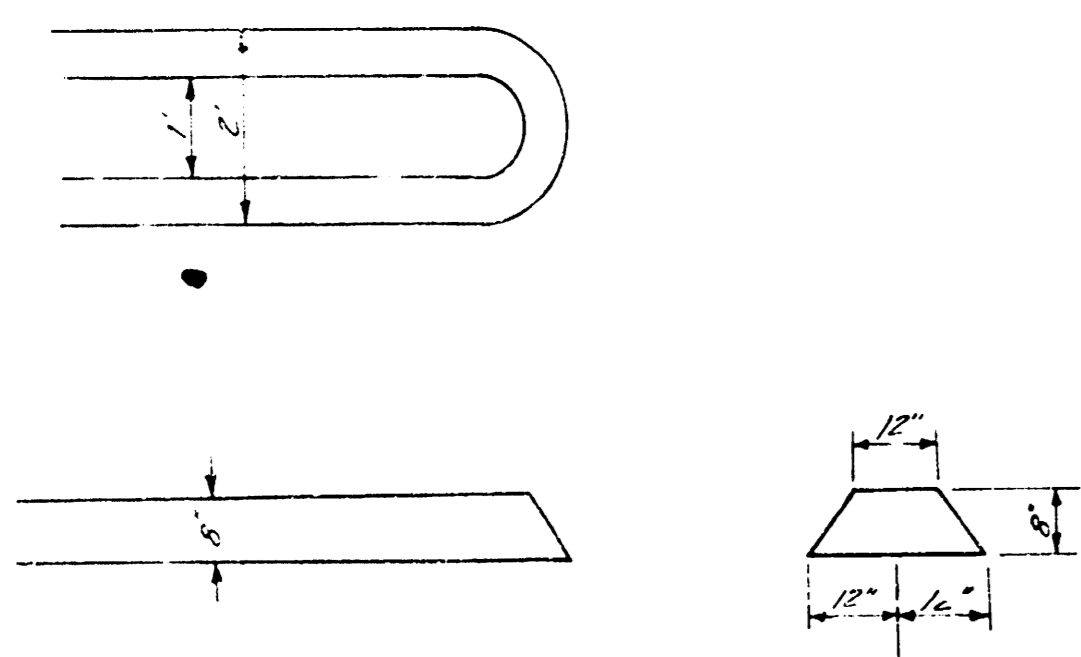

TRAFFIC DIVIDER DETAIL
 Scale: 1" = 2'-0"
 Note: To be identical to part
 same as integral curb.

CONSTRUCTION DETAILS
 INTERSECTION
 GEO. WASH. BLVD & HARRY ST
 PROJ. C11-6

2
 2