

Note:

1. Contractor to notify Mr. C. R. Rogers, District Supervisor, State Highway Commission, El Dorado, Kansas prior to construction & after completion of construction. Drainage requirements on State Highway ROW to be determined by the State Highway Commission Division.
2. By Staging Construction Contractor Shall Provide Access To Paul Burnett's Business - At All Times During Construction.
3. All Construction South Of U.S. 54 Right-Of-Way To Be Constructed By Others.
4. Field Engineer To Determine Location Of Construction Joints & Expansion Joints On Kellogg Avenue & Match New Construction To These Joints. Maximum Distance Between Expansion Joints To Be 120'.
5. All Reinforcing Shall Conform To Section 619 & 617 OF THE STANDARD SPECIFICATIONS FOR STATE ROAD & BRIDGE CONSTRUCTION (1966 EDITION) OF THE STATE HIGHWAY COMMISSION OF KANSAS.
6. End Posts To Be 2.375" O.D. (3.625 I.D./in. Ht.), Diagonal Brace To Be 1.640" O.D. (2.27 I.D./in. Ht.), Barbed Wire, Tension Wire, & Woven Wire Fabric Shall Be Either Zinc Coated (Galvanized) Or Aluminum Coated.
7. All Concrete Used In Fence Installation Shall Be Class B Concrete Conforming To The STANDARD SPECIFICATIONS FOR STATE ROAD & BRIDGE CONSTRUCTION (1966 EDITION) OF THE STATE HIGHWAY COMMISSION OF KANSAS.
8. Contractor To Remove 3' Woven Wire Fence From Sta. 2+05 To Sta. 2+65 & Salvage.
9. Contractor To Install Salvaged 3' Woven Wire Fence From Sta. 3+25 To Sta. 3+65.

B. M. 176.92 "4" ON S. S. MANHOLE RIM N. W. COR. WEBB RD. & U.S. 54. 5' W. OF E. WEBB RD. & 55' N. OF SEC. LINE.
 B. M. 189.38 STEP B. M. ON S. S. TELE. POLE S. S. U.S. 54 5' W. OF W. L. WILDCAT LANE.

11/27/71
 R. W. Linn
 City Engineer
 Checked: [Signature]

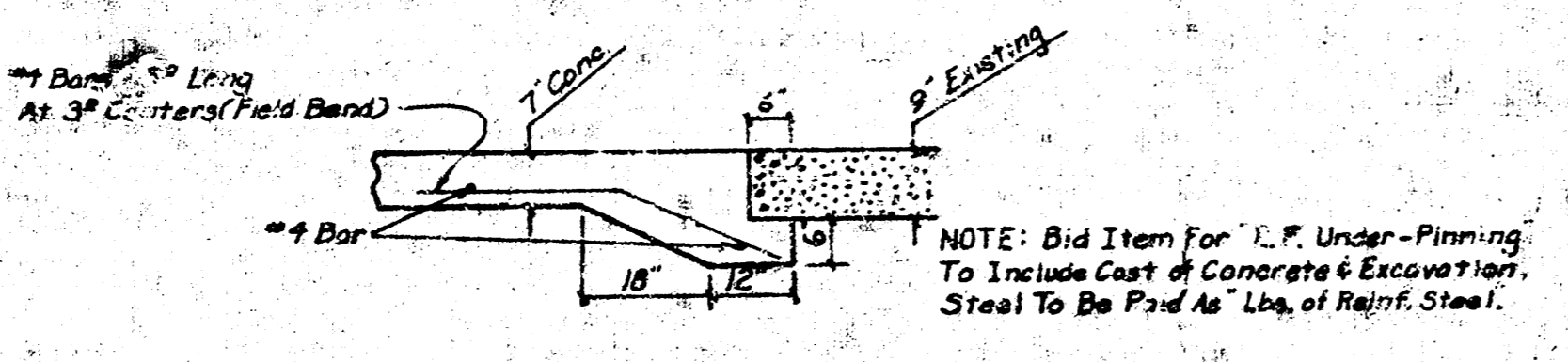
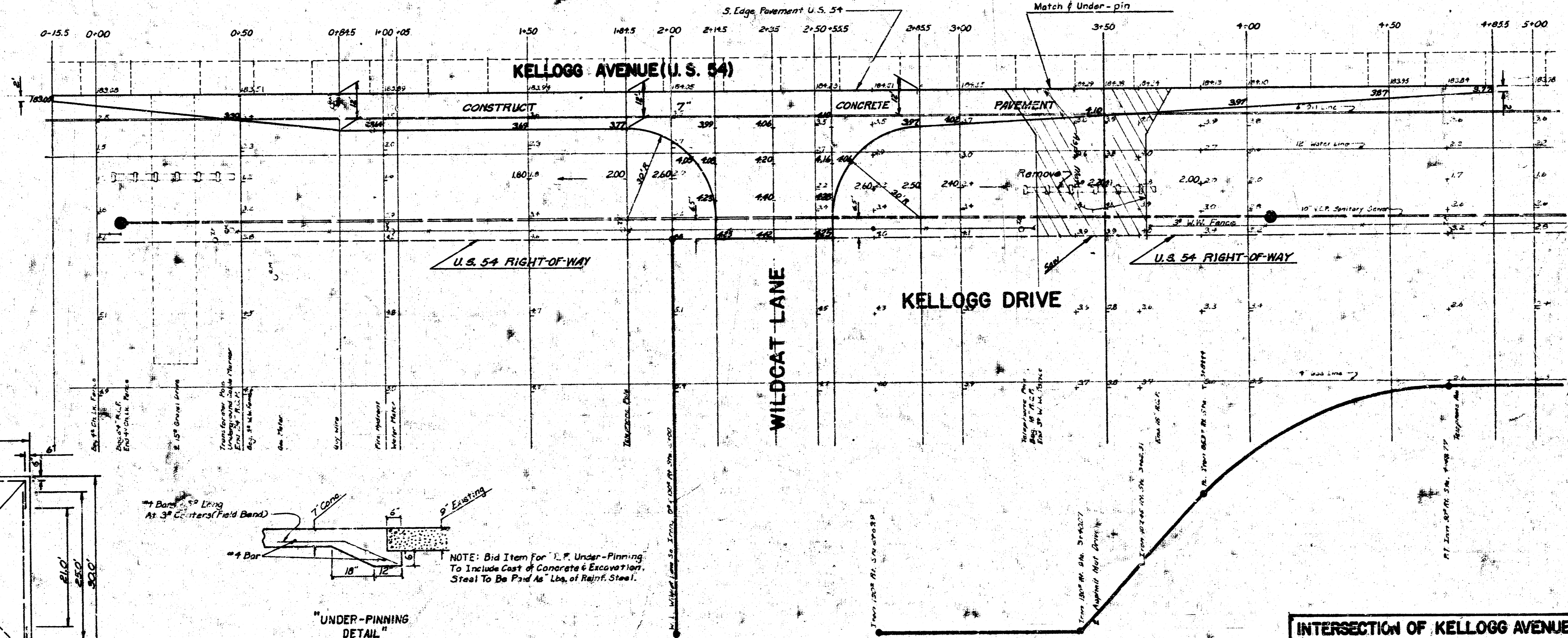
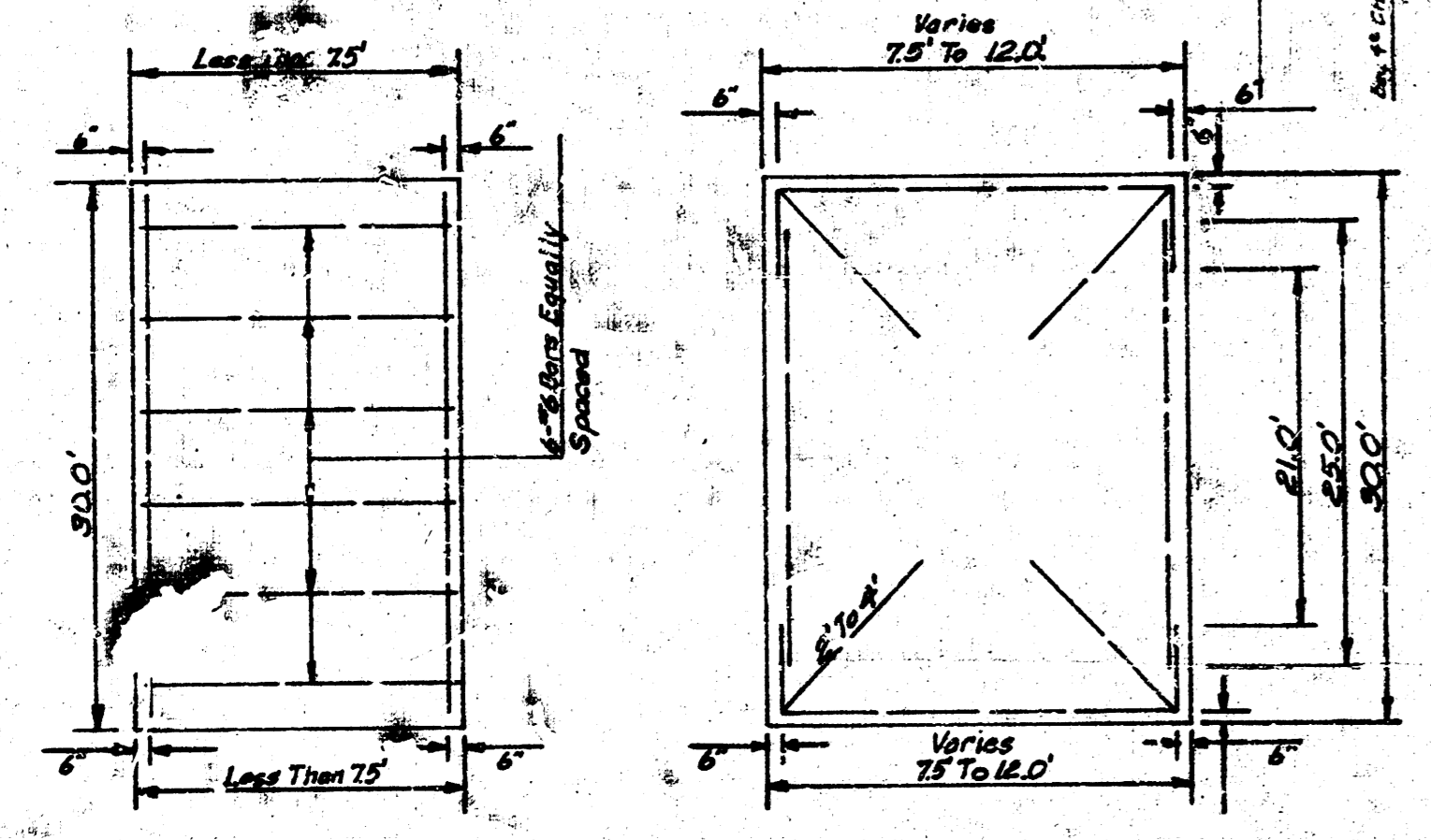
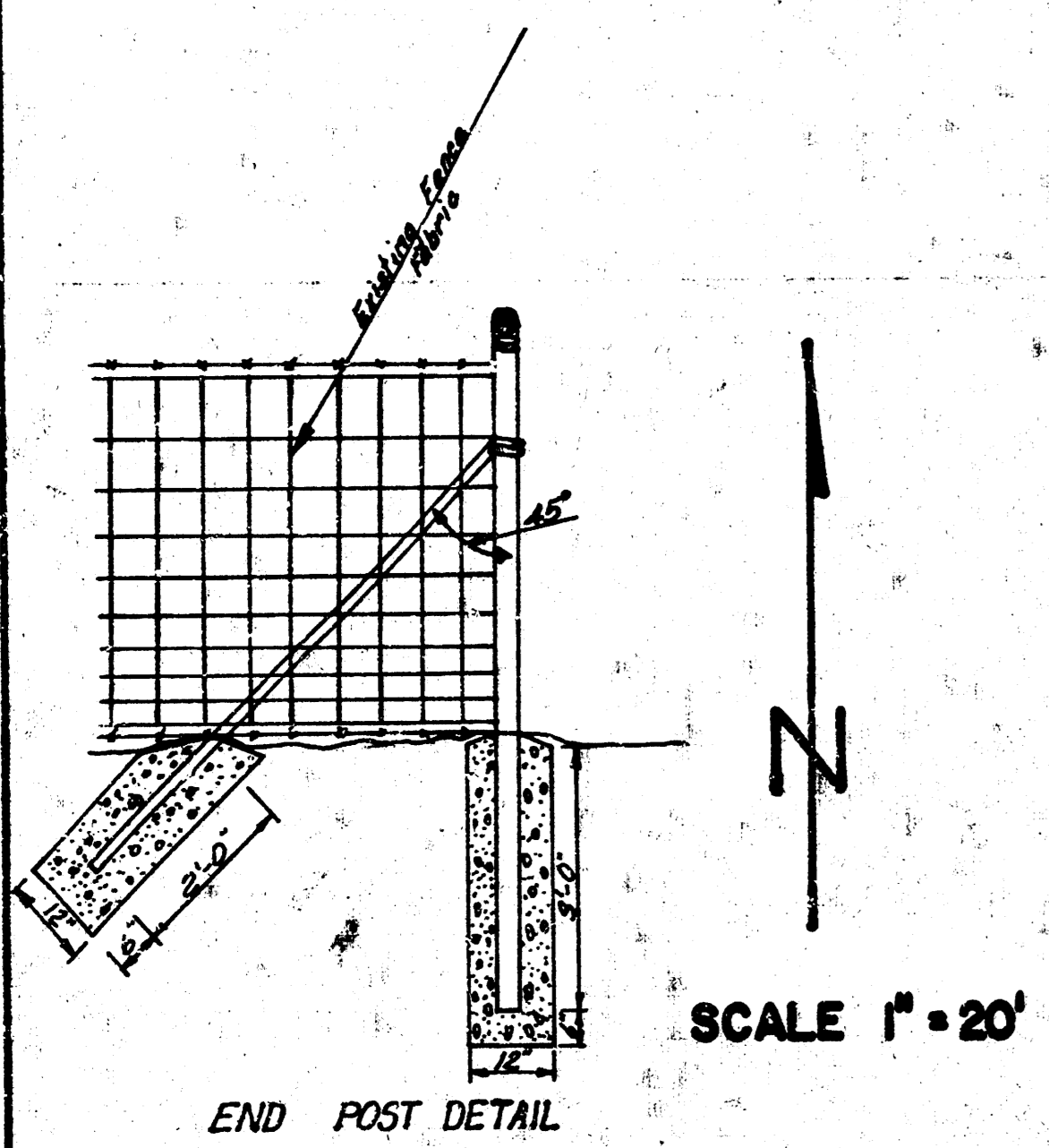

EARTHWORK QUANTITIES	
EXCAVATION	174.8 CU. YDS.
BORROW DITCH	1.7 CU. YDS.
TOTAL	176.5 CU. YDS.
FILL	174.8 CU. YDS.
TOTAL	176.5 CU. YDS.

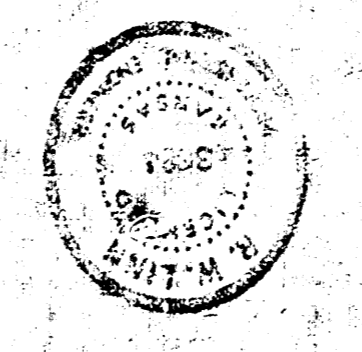

INTERSECTION OF KELLOGG AVENUE
 AND KELLOGG DRIVE AT WILDCAT
 LANE.
 7" CONCRETE PAVEMENT
 CITY OF WICHITA, KANSAS
 R. W. LINN, CITY ENGINEER
 PROJ. NO. DAKS 571046
 DATE: DEC. 1971