

BM 108.72 T in Top Top No. NW Cor. LINCOLN & ST FRANCIS

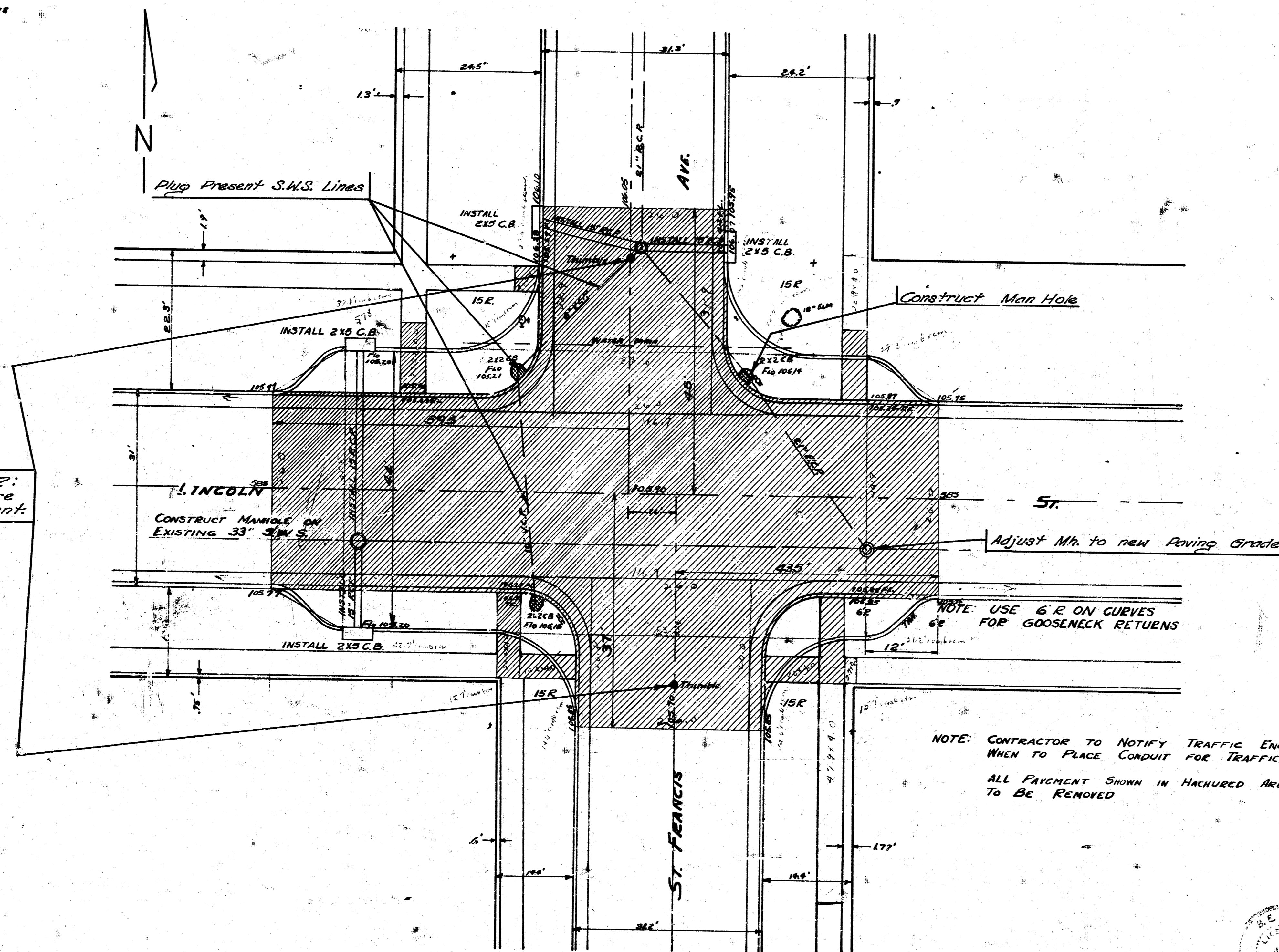

NOTE TO FIELD ENGINEER:  
Get ties to THIMBLES before  
removal of present pavement.

NOTE: CONTRACTOR TO NOTIFY TRAFFIC ENGINEER  
WHEN TO PLACE CONDUIT FOR TRAFFIC SIGNALS  
ALL PAVEMENT SHOWN IN HATCHED AREA  
TO BE REMOVED

**INTERSECTION OF  
LINCOLN & ST. FRANCIS**  
 REPAVE 8" CONC.  
 CITY OF WICHITA KANSAS  
 L.K. WHITE CITY ENGINEER  
 JUNE 1952 PDD. No. CI-102

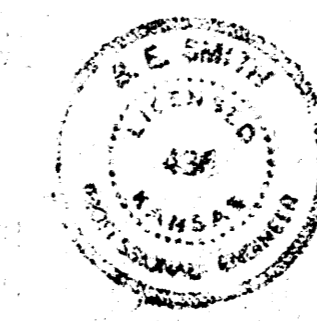

Surveyed by  
 Plan No.  
 Exc. Aff'd.  
 Checked by