

B.M. 127.15 N/R Spk. S. side 24' True
 N.W. cor. Park Place So. & 17th
 B.M. 125.99 Step N. side 14' True
 S.W. cor. Park Place N. & 17th

Base Line for Curve Data is 80' offset, face Rt. Curb

Station	Point	Alignment	Deflection Angle	Chord	Arc
7+43.93	P.T.	A=49°17'	24°38'30"	18.93	18.93
7+25		R=280.00'	22°42'17"	24.99	25'
7+00		T=128.44'	30°08'46"		
6+75		L=240.88'	17°35'18"		
6+50			15°01'30"		
6+25			12°28'22"		
6+00			9°54'58"		
5+75			7°21'26"		
5+50			4°47'58"	14.99	25'
5+25			2°14'30"	2.97	21.91'
5+03.09	P.R.C.				

Base Line for Curve Data is 80' offset, face Rt. Curb

Station	Point	Alignment	Deflection Angle	Chord	Arc
5+03.09	P.T.	A=49°17'	24°38'30"	3.05	3.09
5+00		R=280.00'	22°42'17"	24.99	25'
4+75		T=128.44'	30°08'46"		
4+50		L=240.88'	17°35'18"		
4+25			15°01'30"		
4+00			12°28'22"		
3+75			9°54'58"		
3+50			7°21'26"		
3+25			4°47'58"	24.99	25'
3+03.09	P.R.C.		2°14'30"	2.97	21.91'

Cu. Yds. Excavation 866.4
 +10% 96.6
 Total 963.0 Cu. Yds.

NOTE: Field Engineer is to set
 Pa. Grades for Inlets
 & 12" R.C.P.

17th & PARK PLACE INTERSECTION
 RE-ALIGNMENT
 44" 8" Conc. & Integral Curb
 B.E. SMITH CITY ENGINEER
 CITY OF WICHITA KANSAS
 Project No. C.11-7

5/8

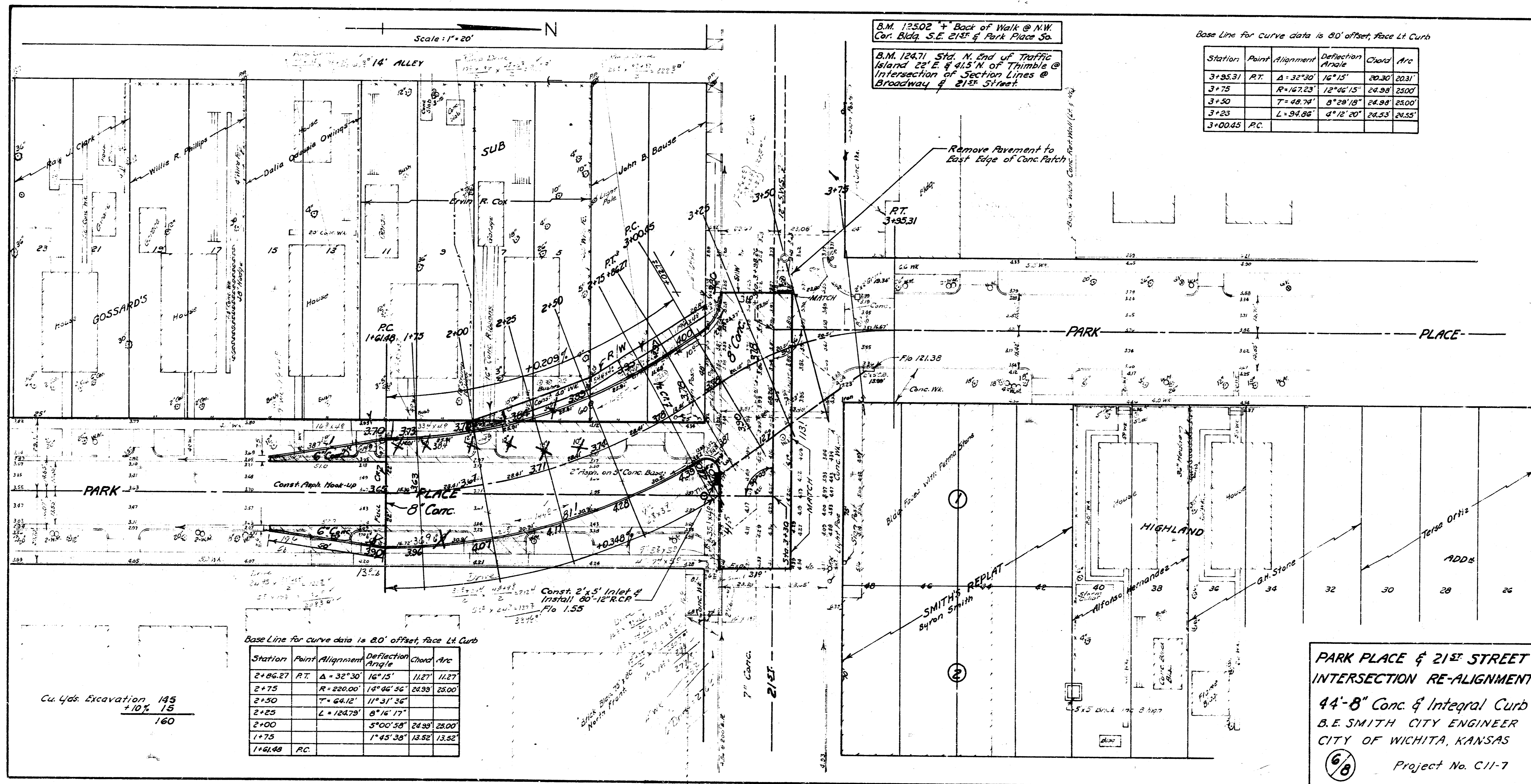

B.M. 12502 4' Back of Walk @ N.W. Cor. Bldg. S.E. 21st & Park Place So.
 B.M. 12471 Std. N. End of Traffic Island 22' E & 415' N. of Thimble @ Intersection of Section Lines @ Broadway & 21st Street.

Base Line for Curve data is 80' offset, Face Lt. Curb

Station	Point	Alignment	Deflection Angle	Chord	Arc
3+85.31	P.T.	$\Delta = 32^{\circ}30'$	$16^{\circ}15'$	20.30	20.31
3+75		$R = 167.23'$	$12^{\circ}06'15''$	24.98	25.00
3+50		$T = 48.76'$	$8^{\circ}29'18''$	24.98	25.00
3+25		$L = 94.86'$	$4^{\circ}12'20''$	24.33	24.35
3+00.45	P.C.				

Base Line for curve data is 80' offset, Face Lt. Curb

Station	Point	Alignment	Deflection Angle	Chord	Arc
2+86.27	P.T.	$\Delta = 32^{\circ}30'$	$16^{\circ}15'$	11.27	11.27
2+75		$R = 220.00'$	$14^{\circ}46'36''$	24.98	25.00
2+50		$T = 64.12'$	$11^{\circ}31'36''$		
2+25		$L = 124.79'$	$6^{\circ}16'17''$		
2+00			$5^{\circ}00'58''$	24.98	25.00
1+75			$1^{\circ}45'36''$	13.52	13.52
1+61.48	P.C.				

Cu. Yds. Excavation 145
 +10% 15
 160

PARK PLACE & 21st STREET INTERSECTION RE-ALIGNMENT
 44'-8" Conc. & Integral Curb
 B.E. SMITH CITY ENGINEER
 CITY OF WICHITA, KANSAS
 Project No. C11-7