

Drawn by: R. J. ...
 Plan by: ...
 Checked by: ...

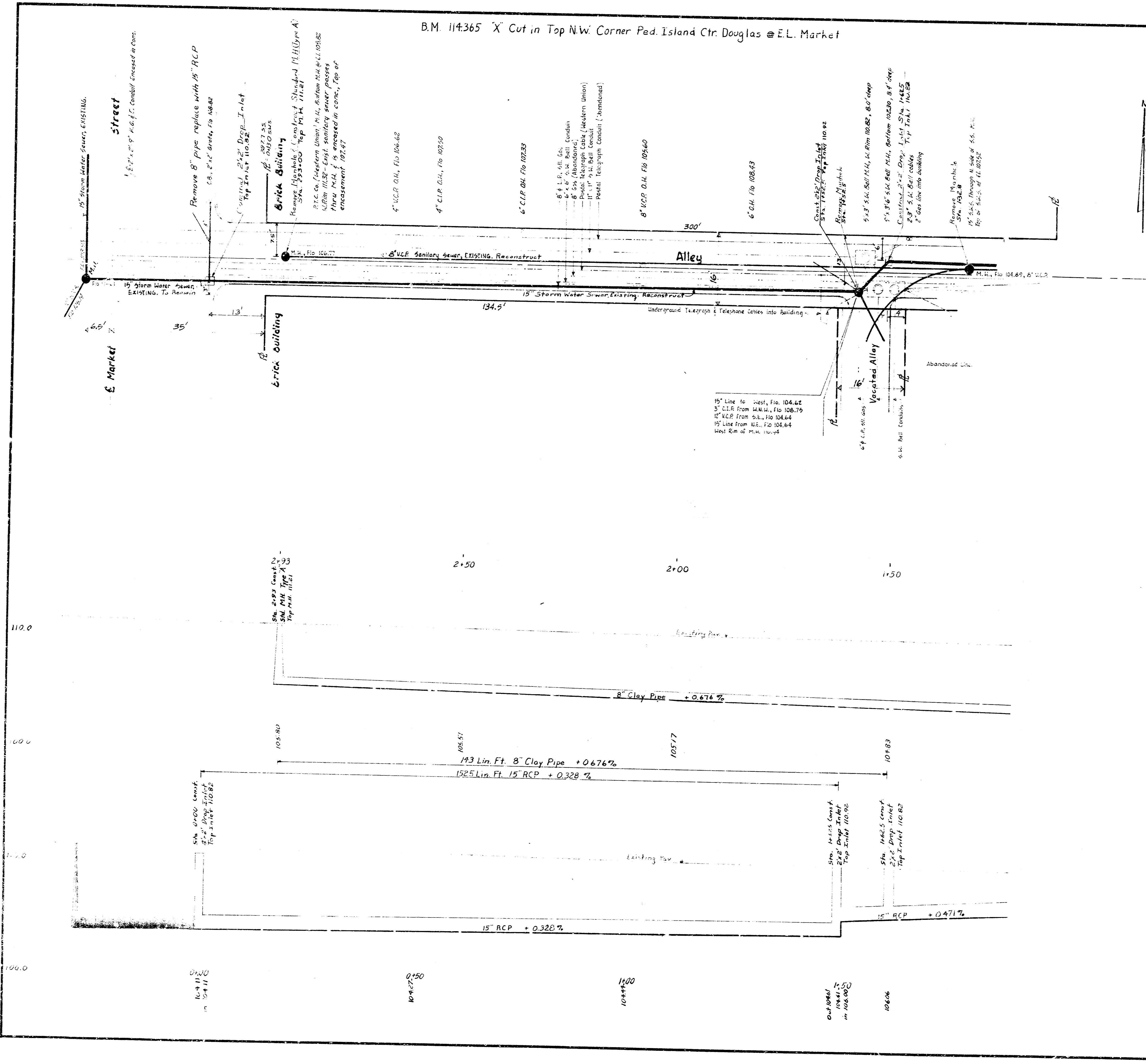

B.M. 114365 'X' Cut in Top NW Corner Ped. Island Ctr. Douglas @ E.L. Market

NOTE TO CONTRACTOR & FIELD ENGINEER

1. All backfill to be sandfilled, flushed, & vibrated.
2. Pipe plugs to be incidental to bid price of lin ft. pipe.
3. Removal of O.H.'s to be incidental to bid price of lin ft. pipe.
4. Contractor will be required to purchase permits for each service connection made.
5. After removal of manhole at sta. 2+92.0 construct a Standard Manhole (Type A) as for East as service connections will permit.
6. Engineer to locate drop inlets at sta. 1+49 and 1+61.5 where new SWS will clear S.W. Bell manholes if possible.
7. Service Connection will consist of cost of y and purchase of permit. Service Line will be paid as lineal feet.

REBUILDING & RECONSTRUCTION OF PORTION OF WEST SUBDIVISION, S.S. 101, & PORTION OF LATERAL DISTRICT 3 OF S.W.S. NO. 8, ALL LYING IN THE ALLEY SOUTH OF DOUGLAS AVENUE FROM EL OF MARKET STREET TO WL OF BROADWAY.
 CITY OF WICHITA, KANSAS
 B.E. SMITH, CITY ENGINEER
 DATE
 PROJ. NO. C29-44

