

S.W.S. #29 WICHITA, KANSAS

PLAN	DATE	BY
APPROVED		
NOTED		
BY		
NO.		

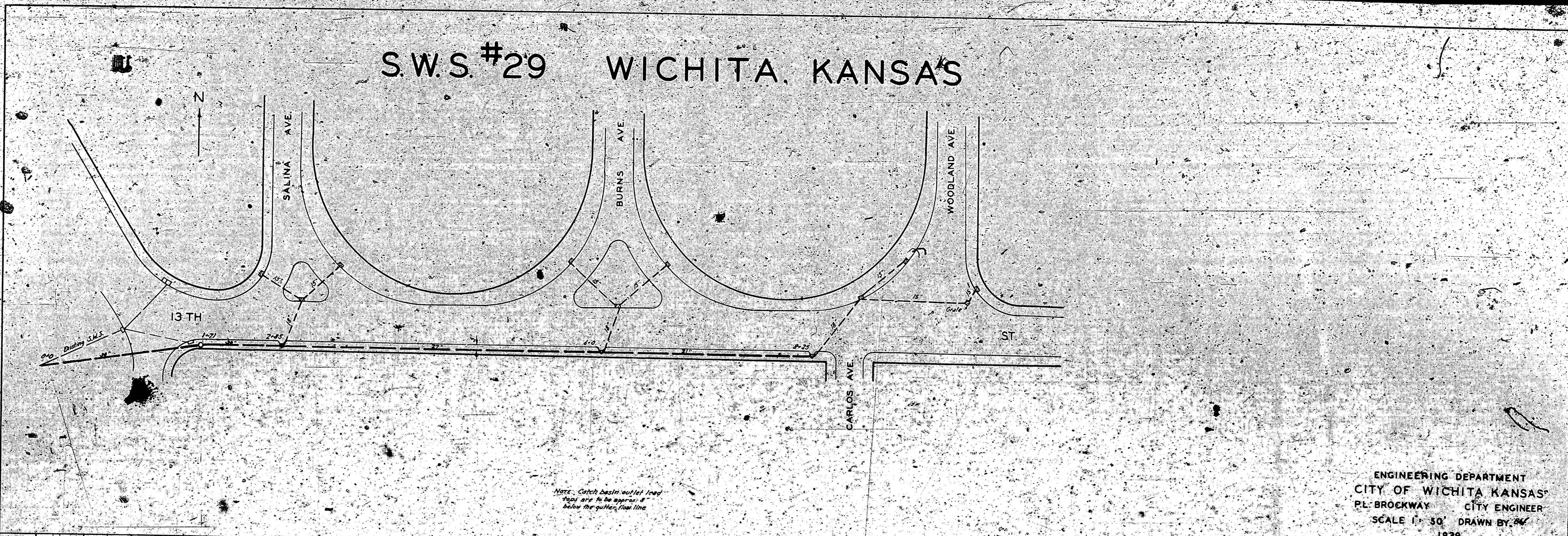

ENGINEERING DEPARTMENT
 CITY OF WICHITA, KANSAS
 PL. BROCKWAY CITY ENGINEER
 SCALE 1" = 50' DRAWN BY: [Signature]
 1939

PROFILE	DATE	BY
APPROVED		
NOTED		
BY		
NO.		

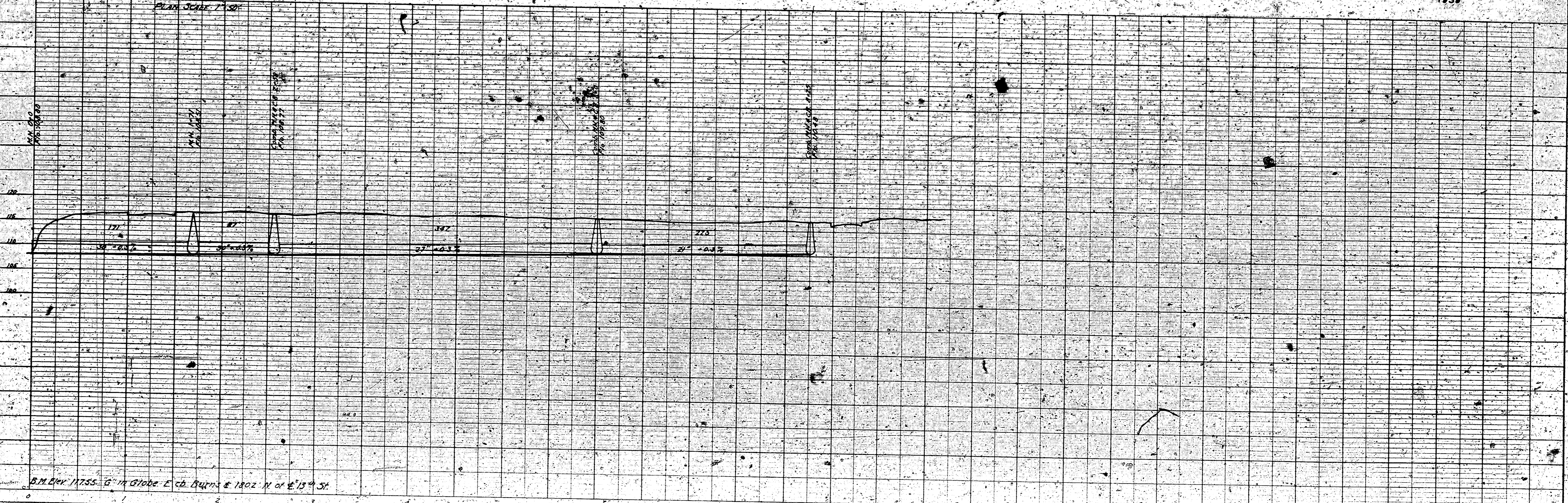

S.W.S. #29 WICHITA, KANSAS

PLAN	DATE
DESIGNED	
CHECKED	
NOTED	
BY	

PROFILE	DATE
DESIGNED	
CHECKED	
NOTED	
BY	

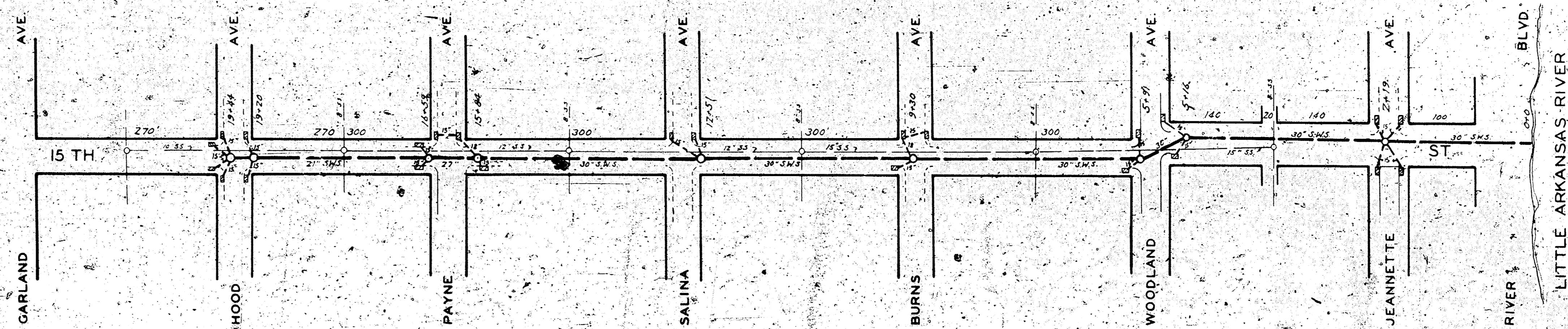

Note: Top of Catch Basin/Pavement embankment of 30" minimum slope across the east side of 15th St which is 2.5' higher.

SCALE OF PLAN 1" = 100'

