

B.M. 19642 Top thimble @ 17th & Yale

NOTE: Contractor is to protect sidewalk of trees from damage during construction. All point & sidewalk cuts are to be sand backfilled & flushed.

NOTE: Field Engineer to take permanent ties to iron before construction and replace same.

Scale: 1"=40'

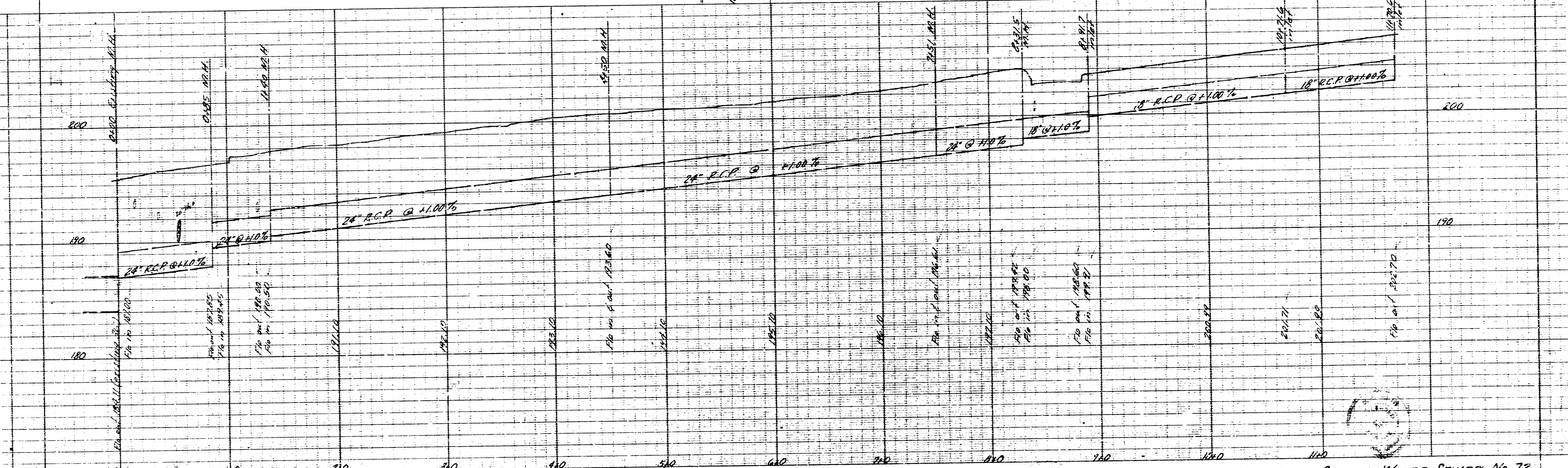
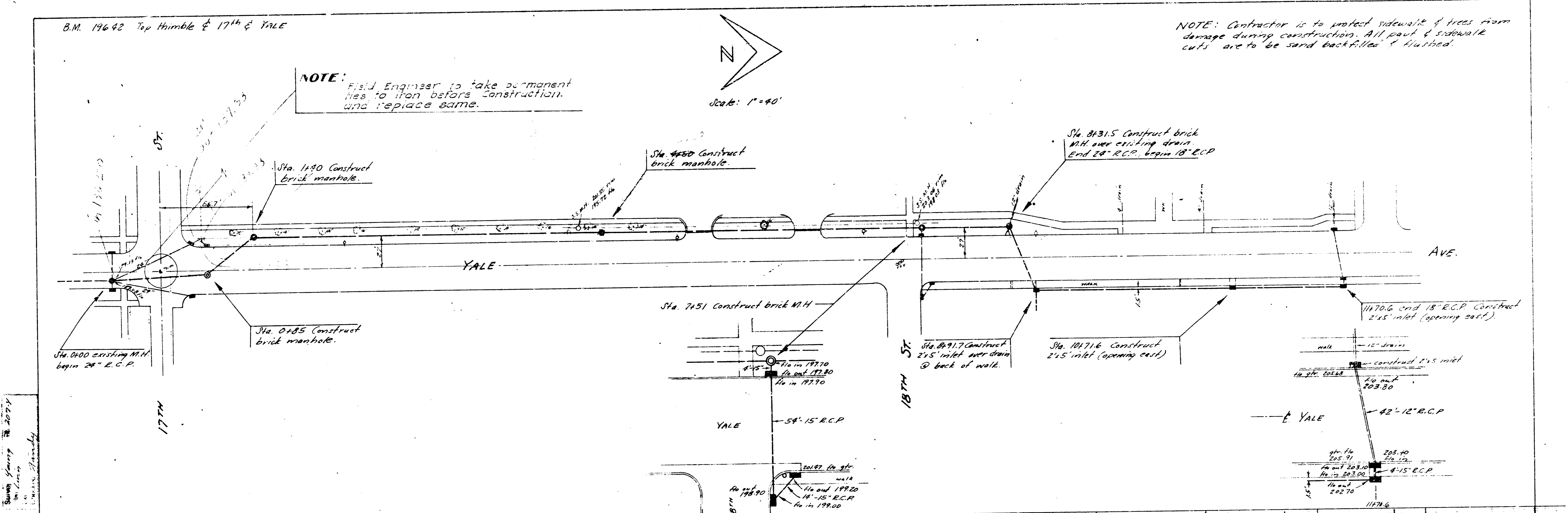

Surveyed by 2024  
in  
L. Smith

2012

Integral

Integral

STORM WATER SEWER No. 72  
CITY OF WICHITA, KANSAS  
B.E. SMITH - CITY ENGINEER  
MAY, 1963 PROJ. C22-36

B.M. 156.92 Top of curb @ 17th & Yale



NOTE: Contractor to be careful not to damage existing conduits. All cut & cover cuts are to be suitably reinforced.

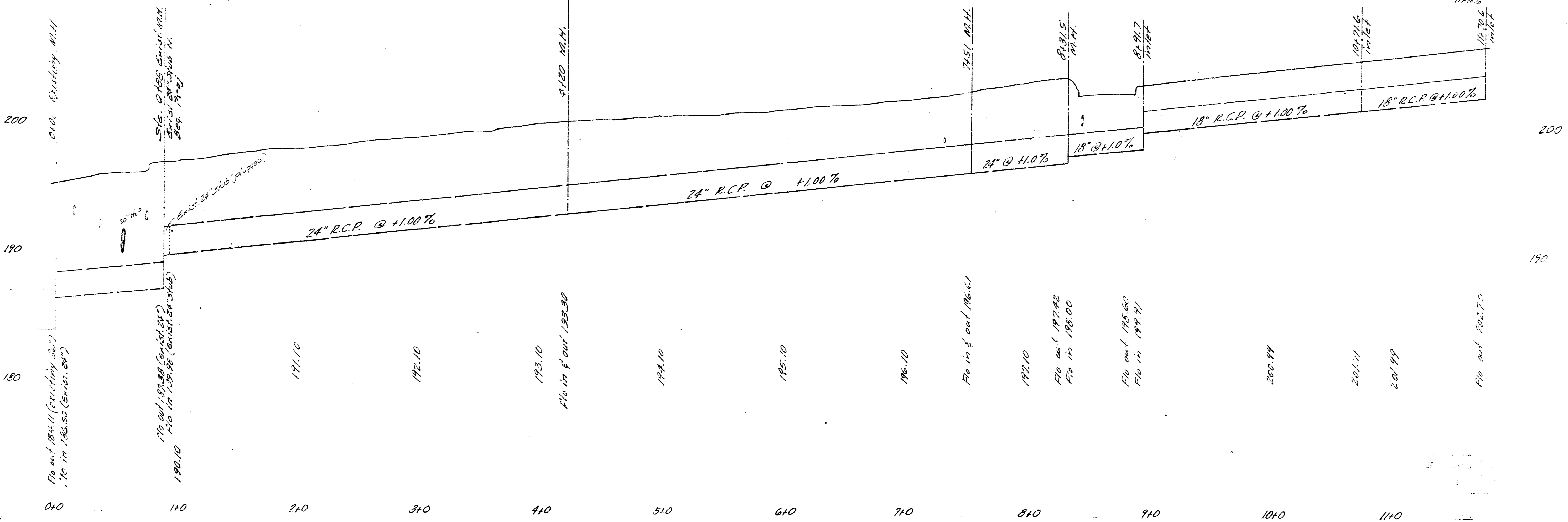
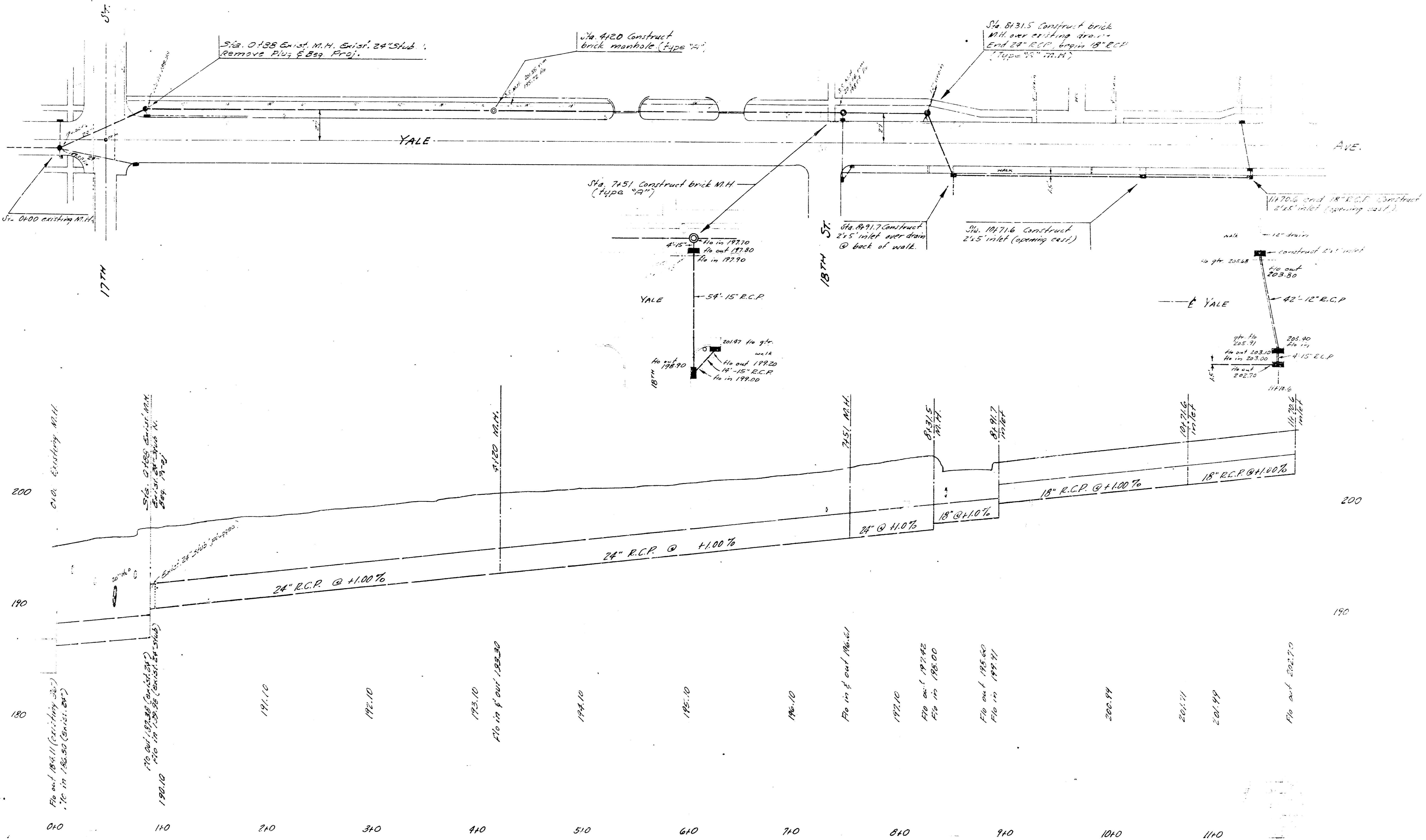

STORM WATER SEWER No. 72  
CITY OF WICHITA, KANSAS  
B.E. SMITH - CITY ENGINEER  
MAY, 1963 Proj. C22-36