

**STORM WATER SEWER NO. 83**

CITY OF WICHITA, KANSAS - B.E. SMITH, CITY ENGINEER

1/18

PROJECT NO. C28-3

DATE: 10/1/18



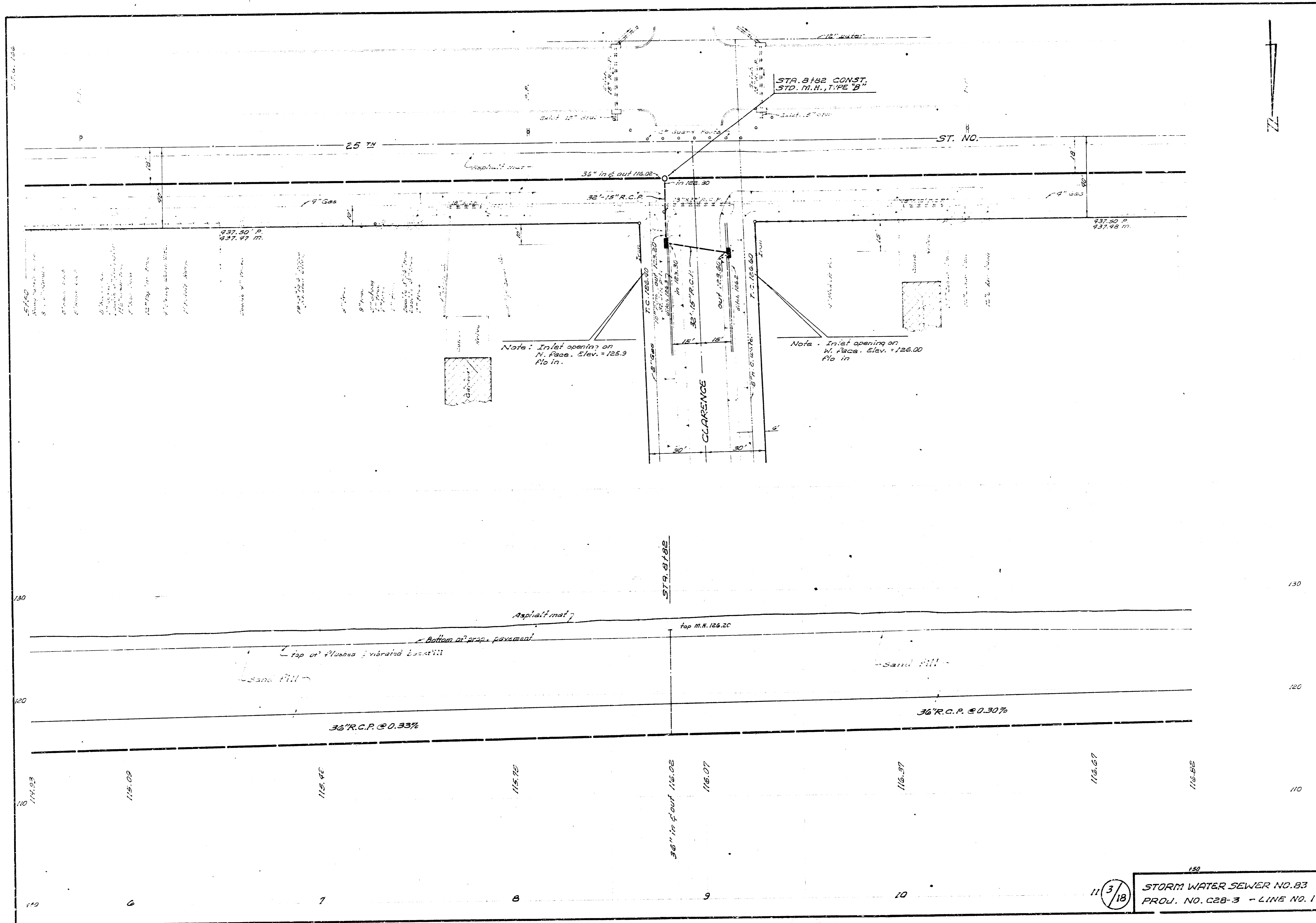

11 3/18  
 STORM WATER SEWER NO. 83  
 PROJ. NO. C28-3 - LINE NO. 1

4.5.6.156

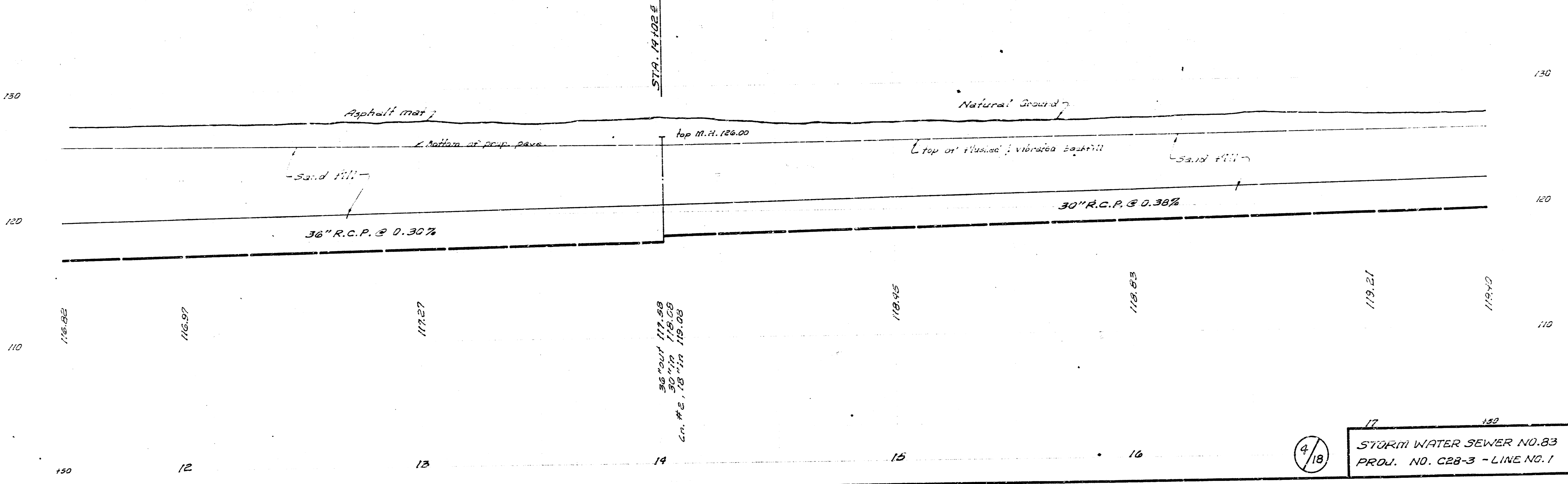
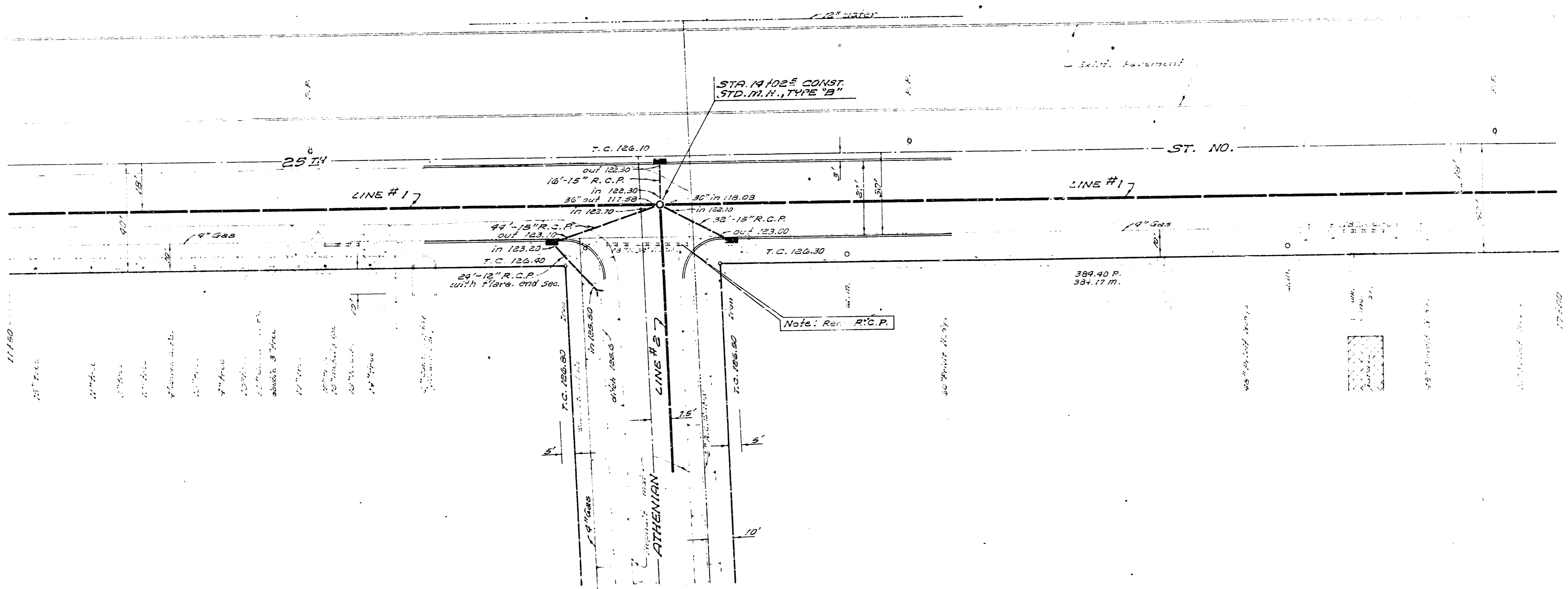

9/18

STORM WATER SEWER NO. 83  
PROJ. NO. C28-3 - LINE NO. 1

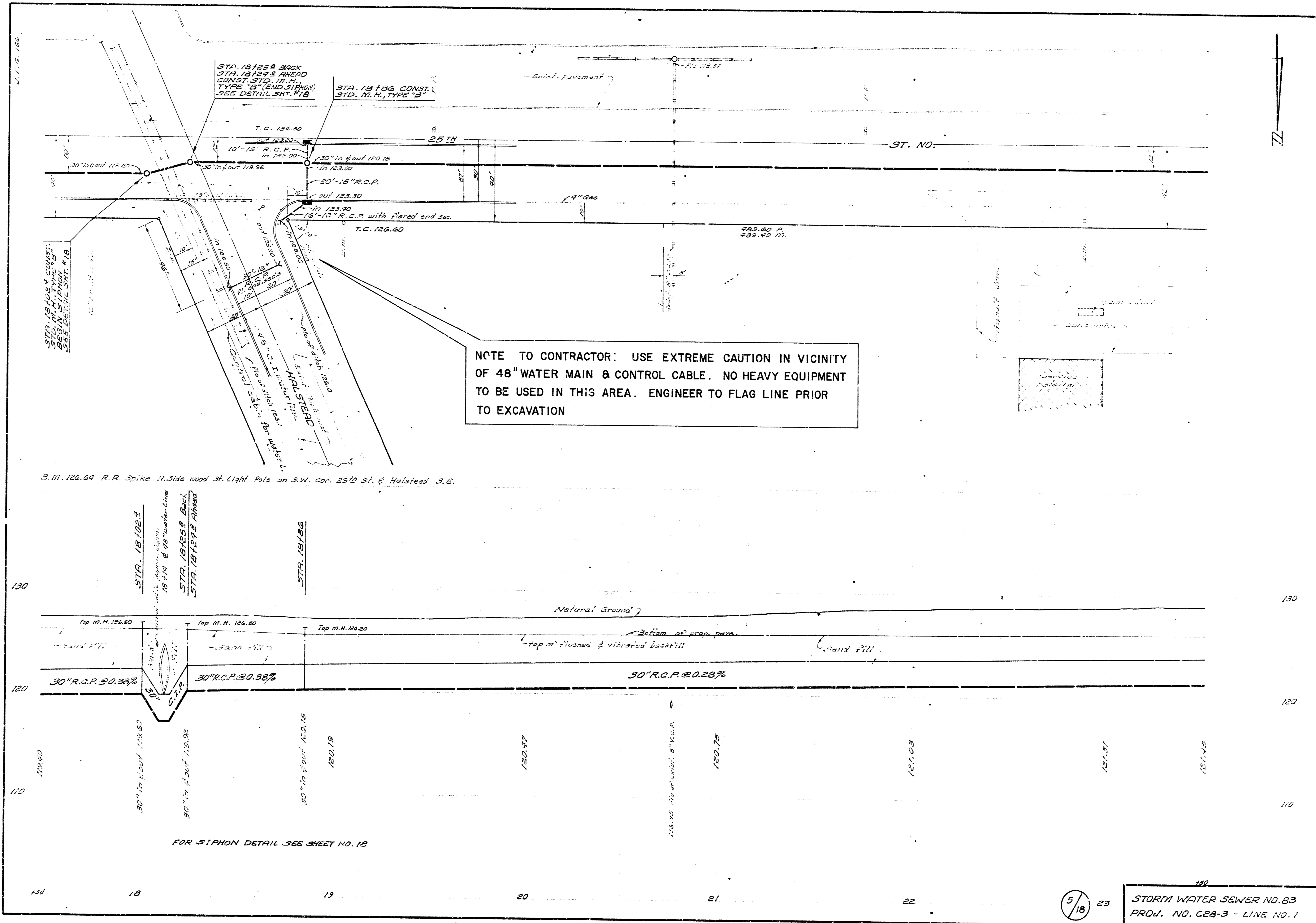

STA. 18+125.8 BACK  
 STA. 18+129.8 AHEAD  
 CONST. STD. M.H.  
 TYPE "B" (END SIPHON)  
 SEE DETAIL SH. # 18

STA. 18+130 CONST.  
 STD. M.H., TYPE "B"

NOTE TO CONTRACTOR: USE EXTREME CAUTION IN VICINITY OF 48" WATER MAIN & CONTROL CABLE. NO HEAVY EQUIPMENT TO BE USED IN THIS AREA. ENGINEER TO FLAG LINE PRIOR TO EXCAVATION

B.M. 126.64 R.R. Spike N. Side Wood St. Light Pole on S.W. cor. 25th St. & Helstead S.E.

STA. 18+102.8  
 STA. 18+129.8 BACK  
 STA. 18+134 AHEAD

FOR SIPHON DETAIL SEE SHEET NO. 18

5/18 23

STORM WATER SEWER NO. 83  
 PROJ. NO. C28-3 - LINE NO. 1

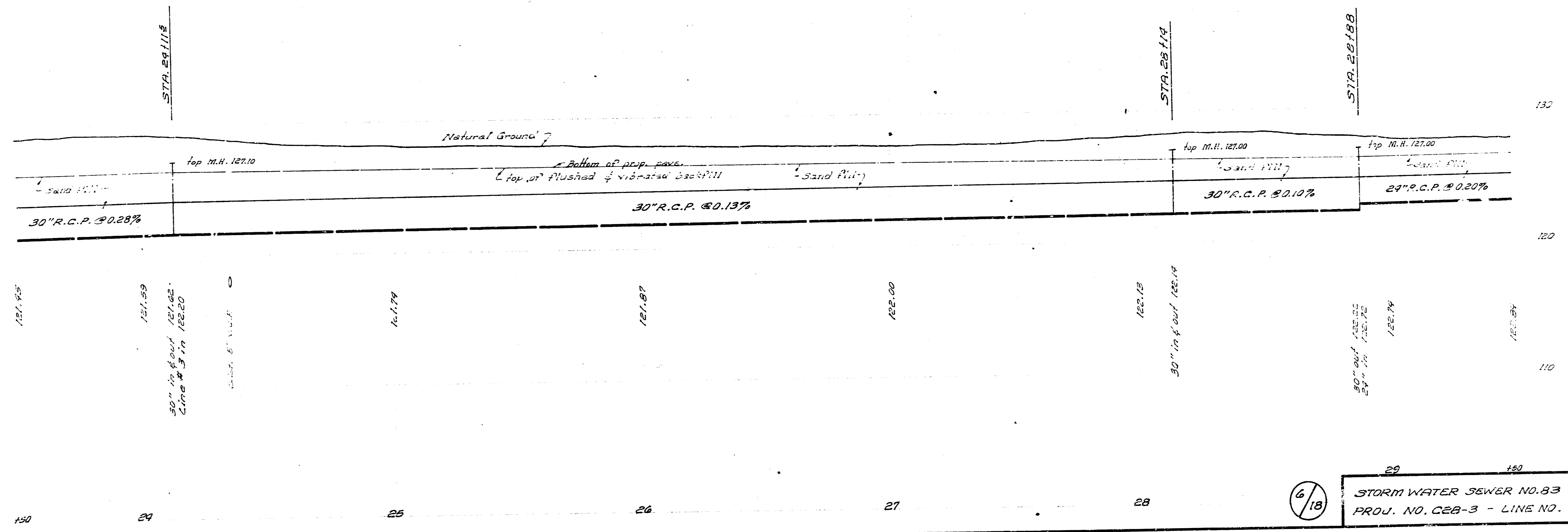
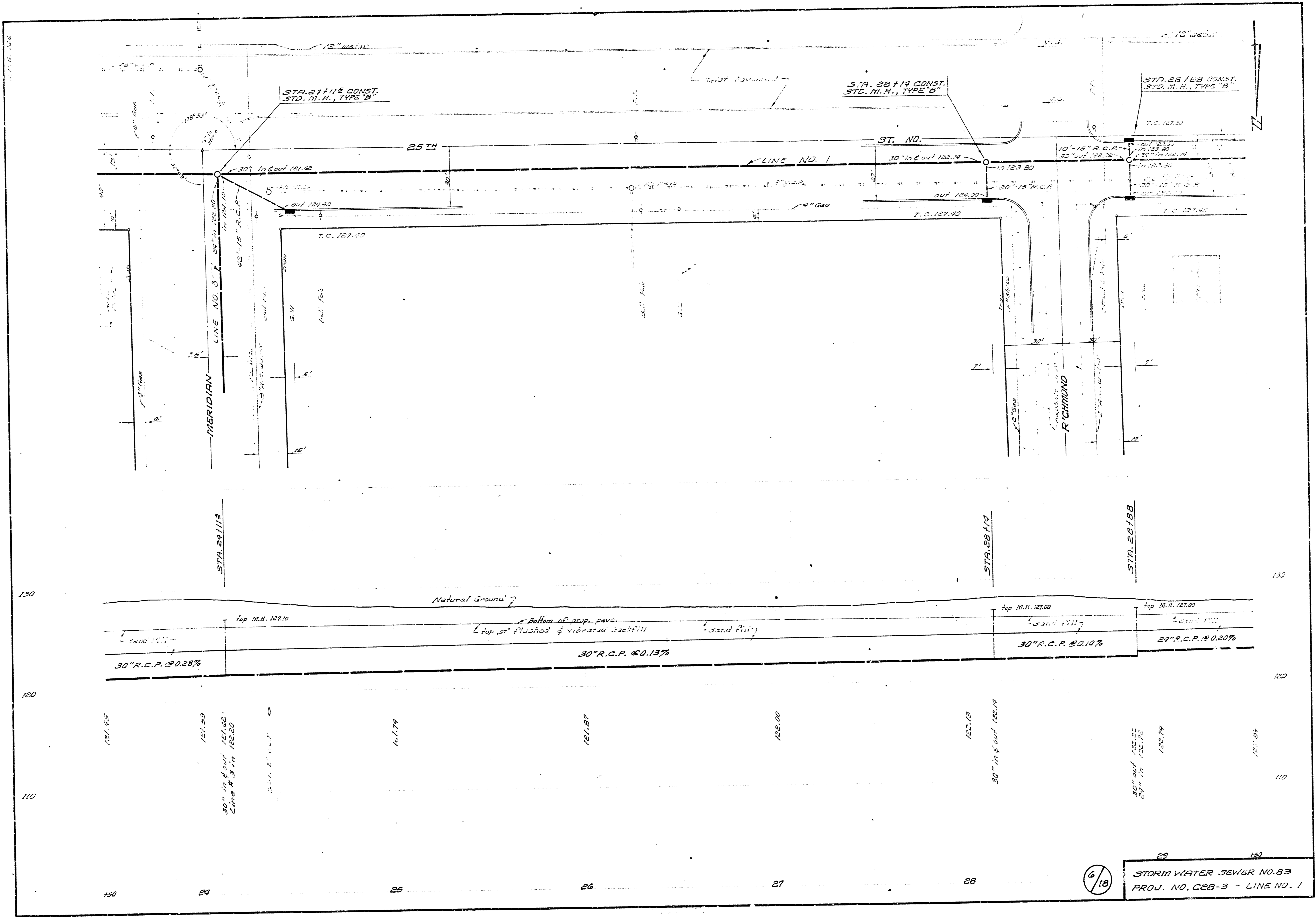

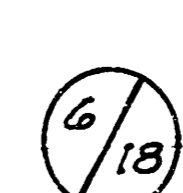

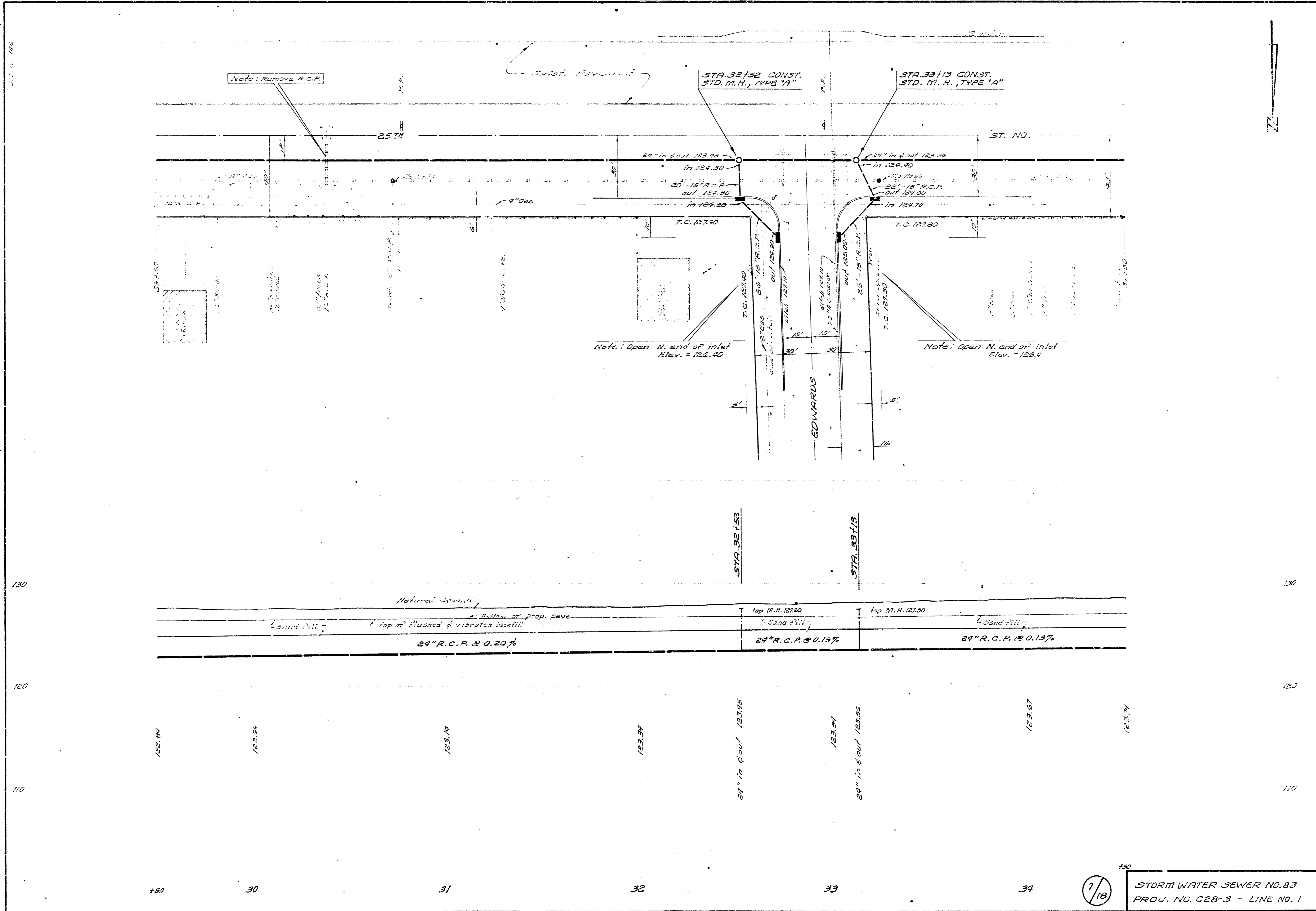
 STORM WATER SEWER NO. B3  
 PROJ. NO. CEB-3 - LINE NO. 1

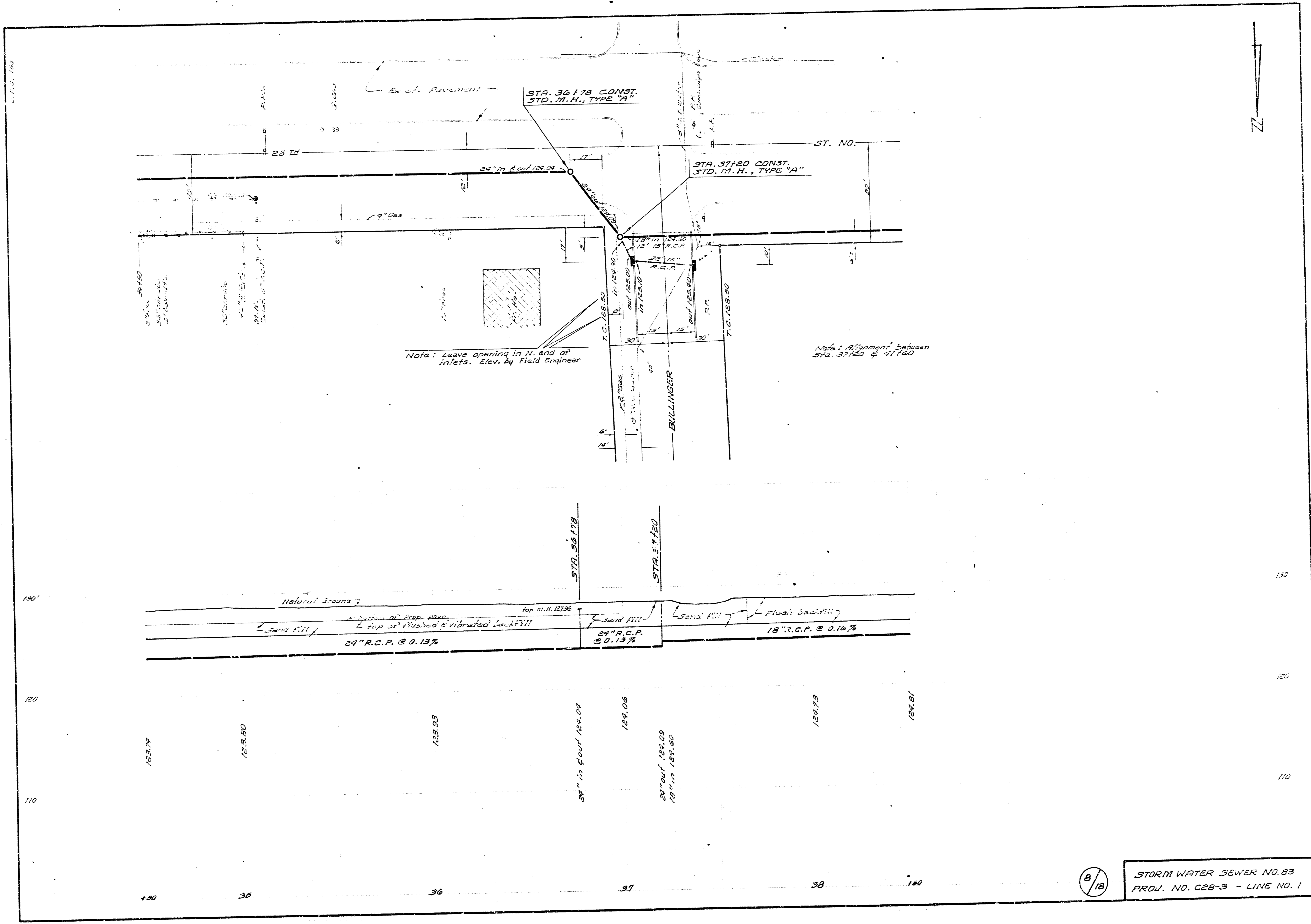

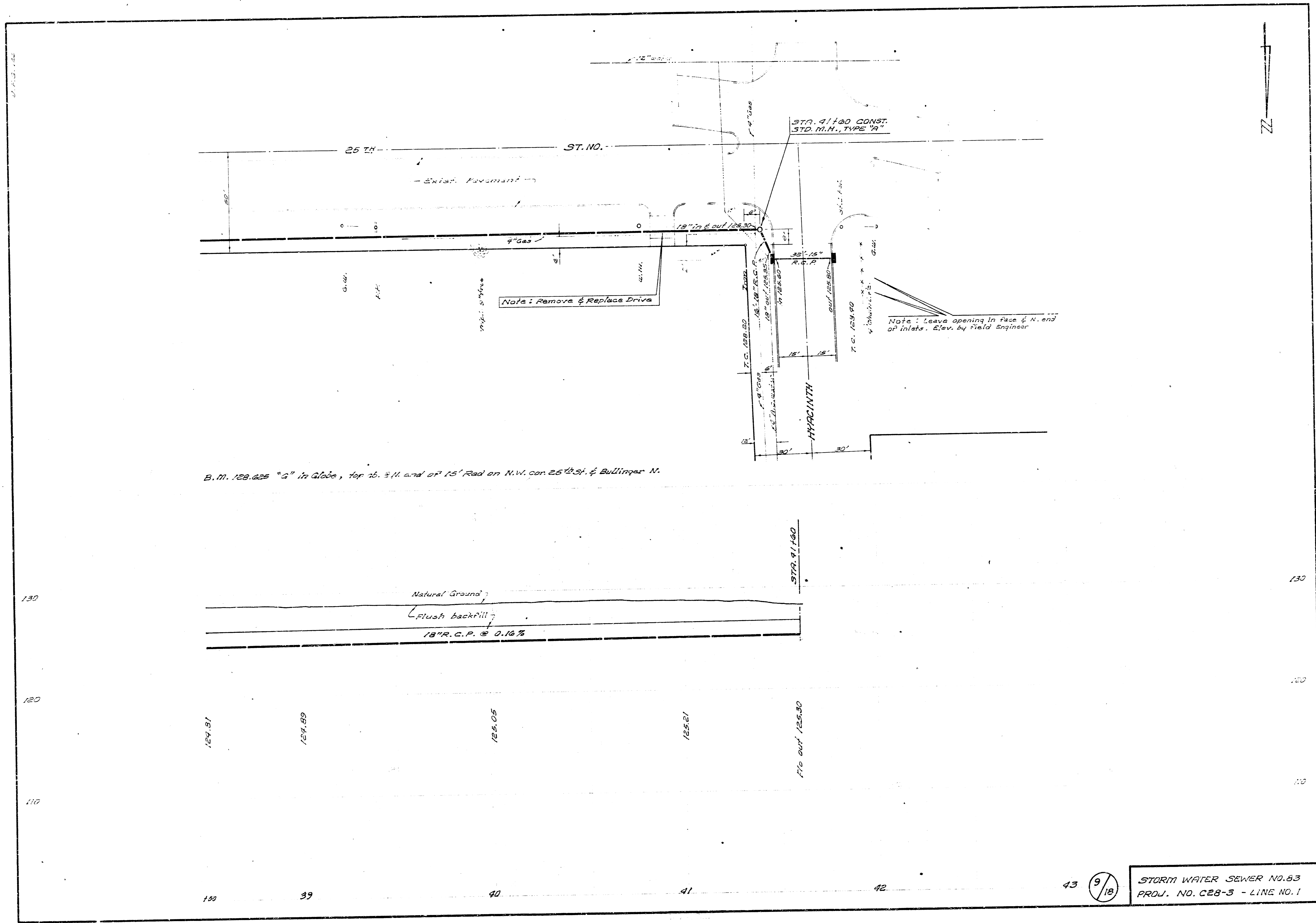

8/18

STORM WATER SEWER NO. 83  
 PROJ. NO. C28-3 - LINE NO. 1



B.M. 128.625 "S" in Globe, top 16. 3/4" end of 15' Rad on N.W. cor. 25th St. & Bullinger N.

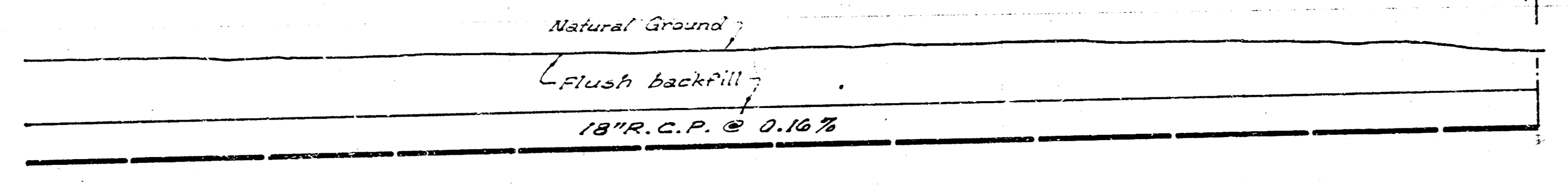

124.91  
 124.89  
 125.05  
 125.21  
 125.30  
 STR. 41140

100 39 40 41 42

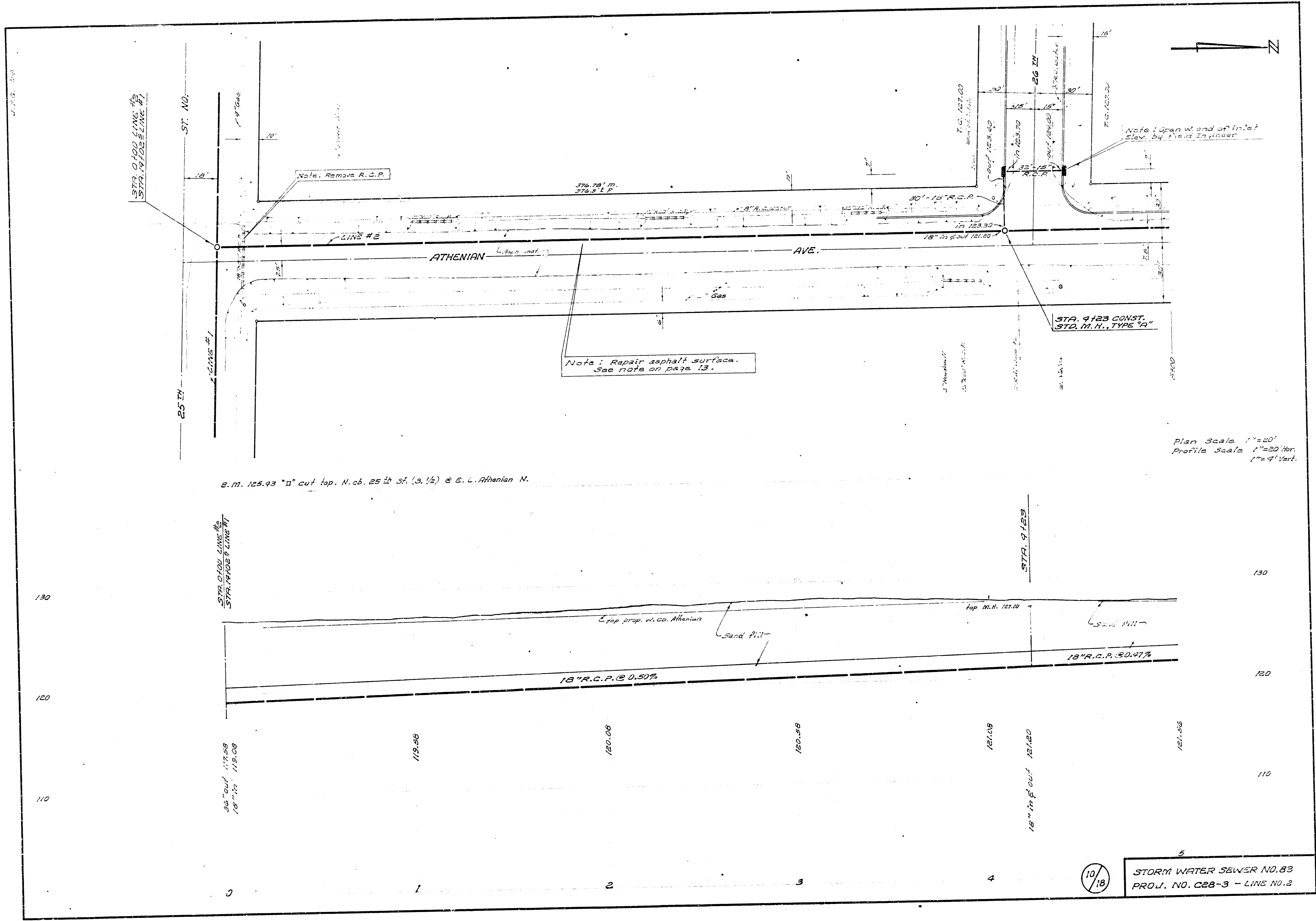

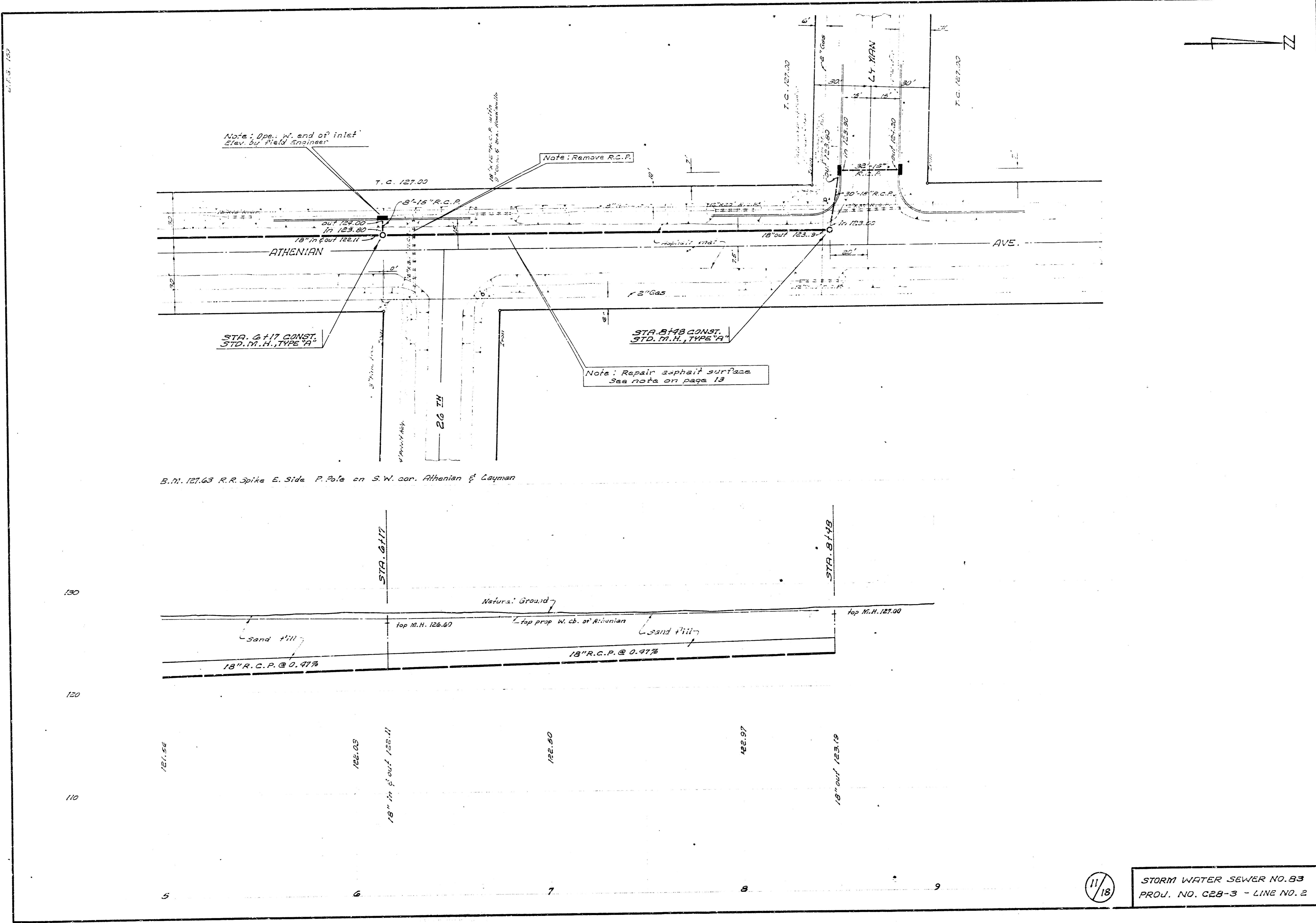

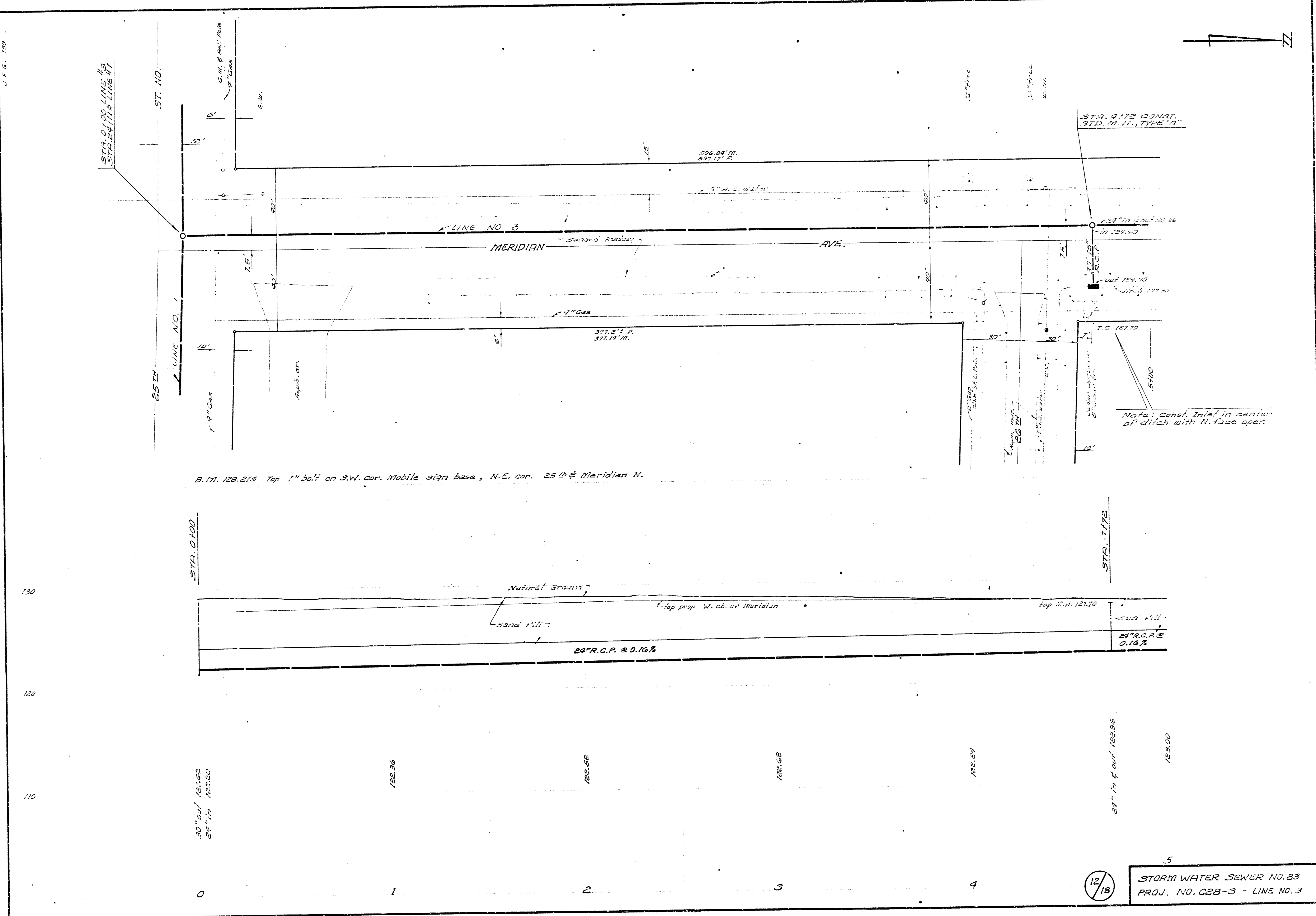

B.M. 128.215 Top 1" bolt on S.W. cor. Mobile sign base, N.E. cor. 25th & Meridian N.

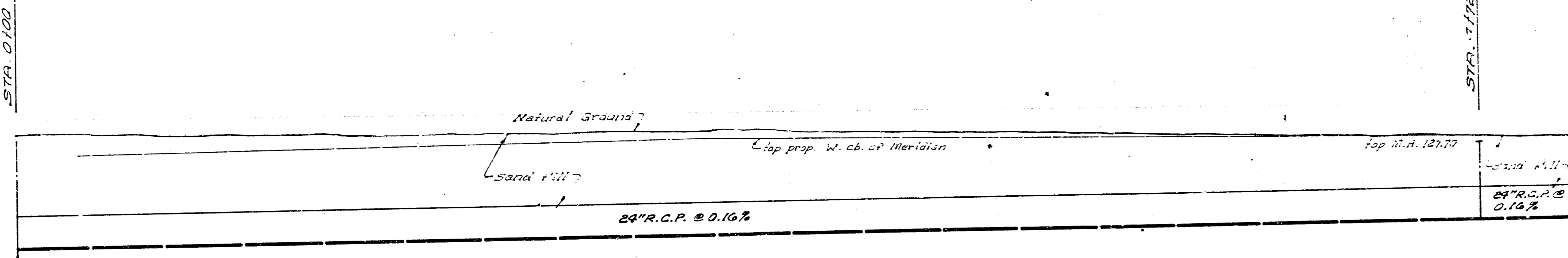

12/18

5  
STORM WATER SEWER NO. 83  
PROJ. NO. C28-3 - LINE NO. 3

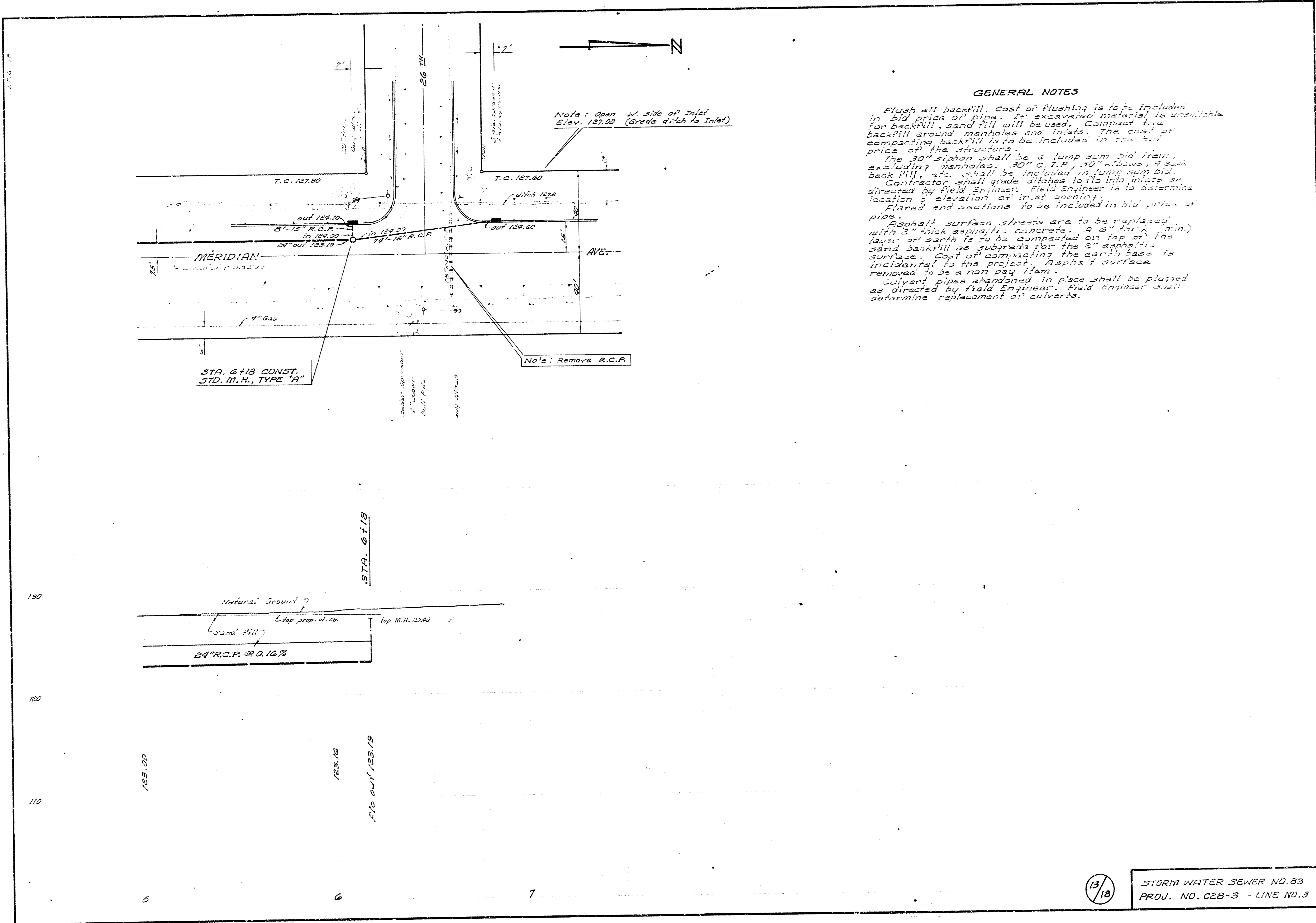

**GENERAL NOTES**

Flush all backfill. Cost of flushing is to be included in bid price of pipe. If excavated material is unavailable for backfill, sand fill will be used. Compact the backfill around manholes and inlets. The cost of compacting backfill is to be included in the bid price of the structure.

The 20" siphon shall be a lump sum bid item, excluding manholes. 30" C.I.P., 30" elbows, 4 sack back fill, etc. shall be included in lump sum bid.

Contractor shall grade ditches to tie into inlets as directed by field engineer. Field Engineer is to determine location & elevation of inlet opening.

Flared end sections to be included in bid price of pipe.

Asphalt surface streets are to be replaced with 2" thick asphaltic concrete. A 2" thick (min.) layer of earth is to be compacted on top of the sand backfill as subgrade for the 2" asphaltic surface. Cost of compacting the earth base is incidental to the project. Asphalt surface removed to be a non pay item.

Culvert pipes abandoned in place shall be plugged as directed by field engineer. Field engineer shall determine replacement of culverts.

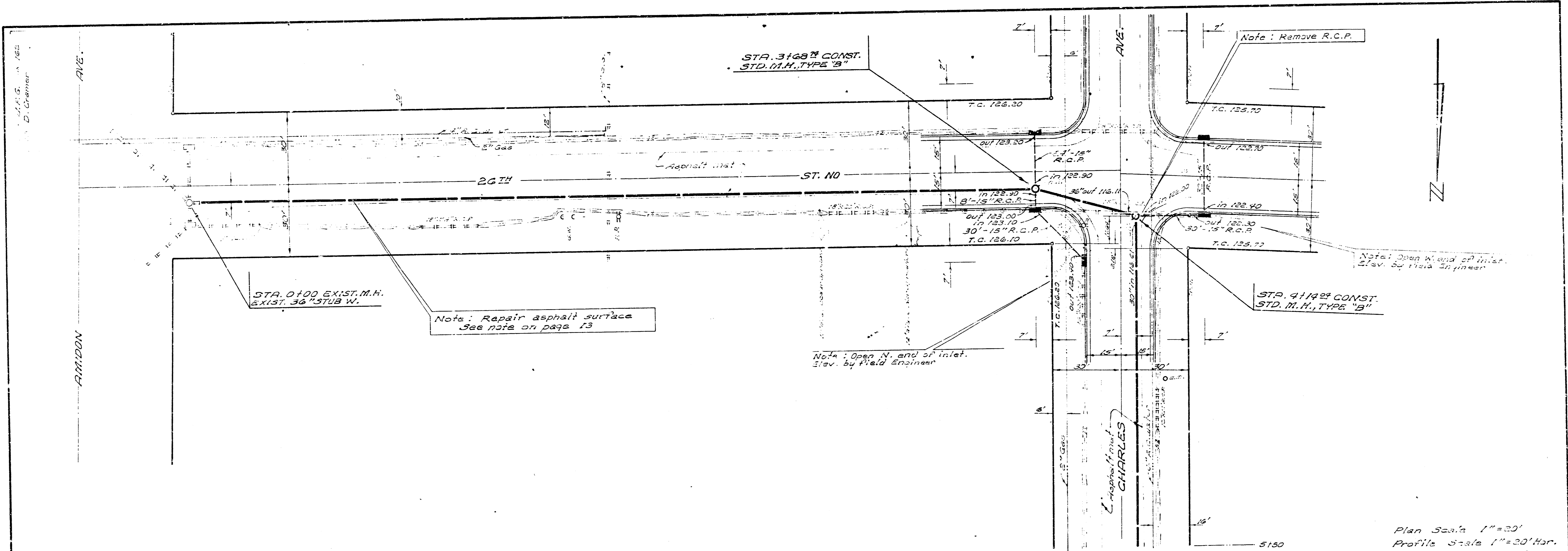

B.M. 125.39 City Sta. @ Amidon & 25th  
 B.M. 126.33 "x" cut on N.W. cor. conc. sign base on S.E. cor. Amidon & 26th St.  
 B.M. 125.85 R.R. Spike on N.E. side R. Pole N.E. cor. 25th St. & Charles

Plan Scale 1"=20'  
 Profile Scale 1"=20' Hor.  
 1"=4' Vert.

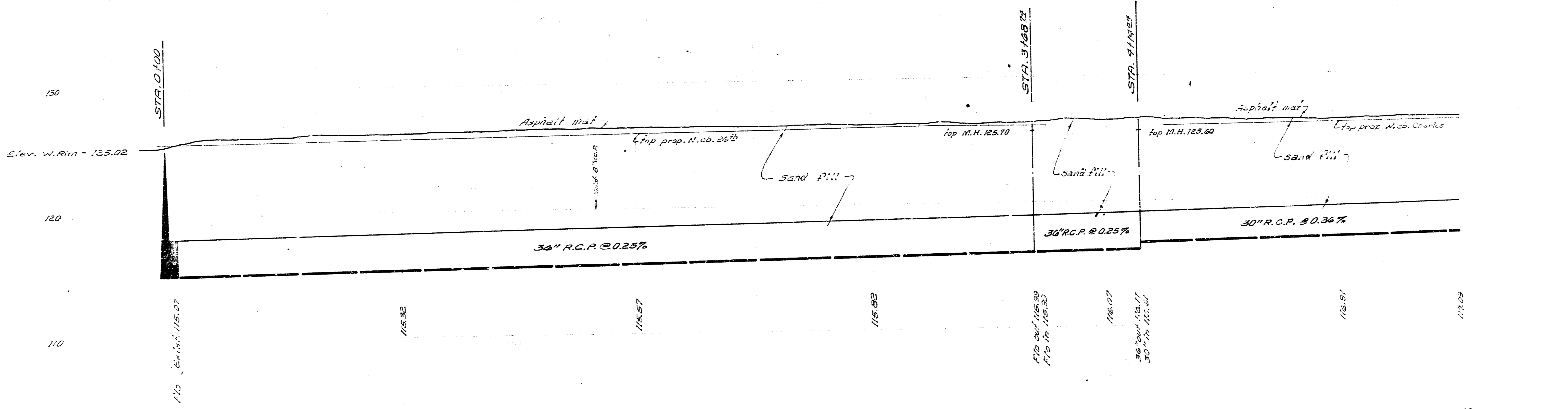

14/18  
 STORM WATER SEWER NO. 83  
 PRDU. NO. C28-3 -- LINE NO. 4

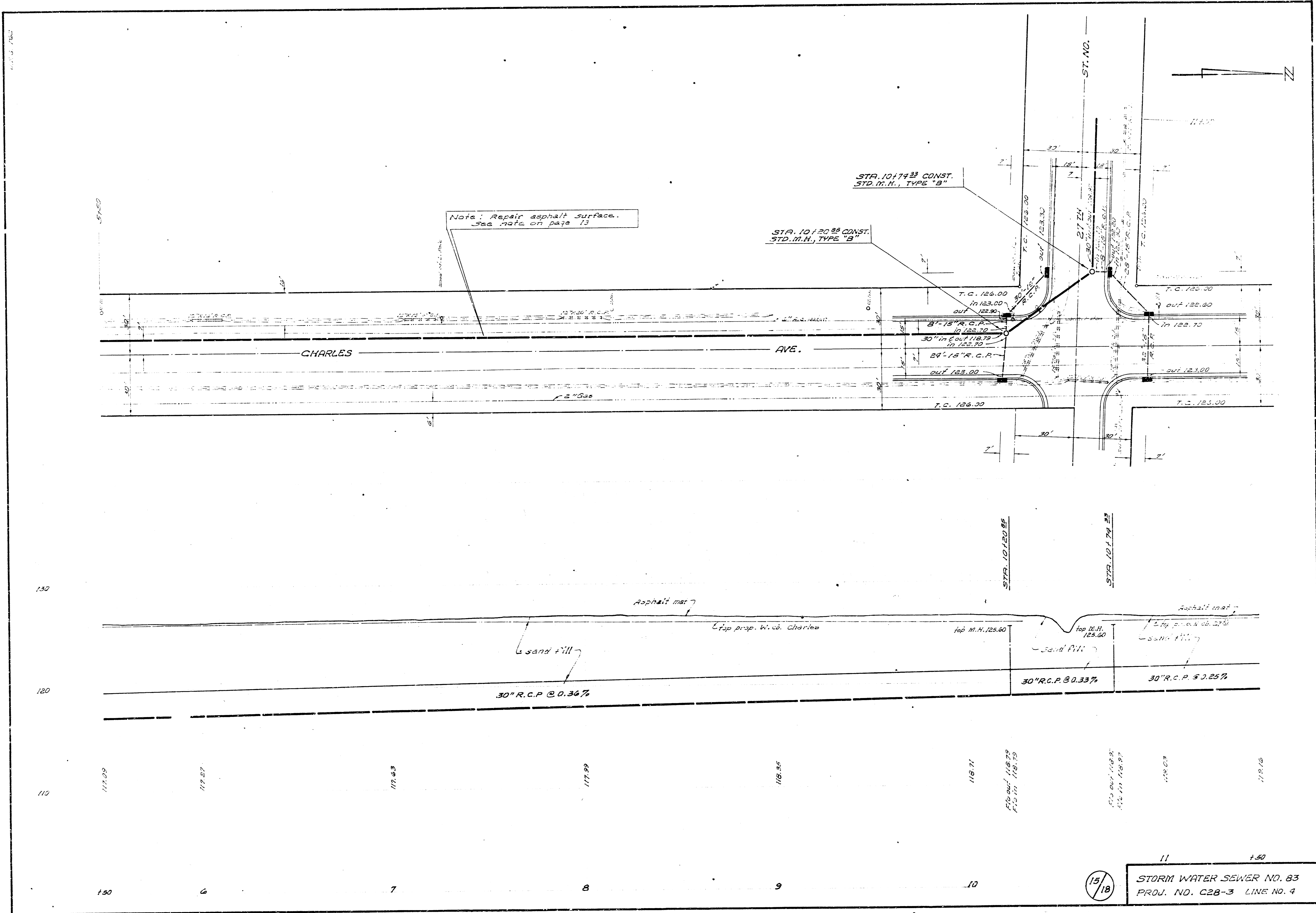

15/18

STORM WATER SEWER NO. 83  
 PROJ. NO. C28-3 LINE NO. 4

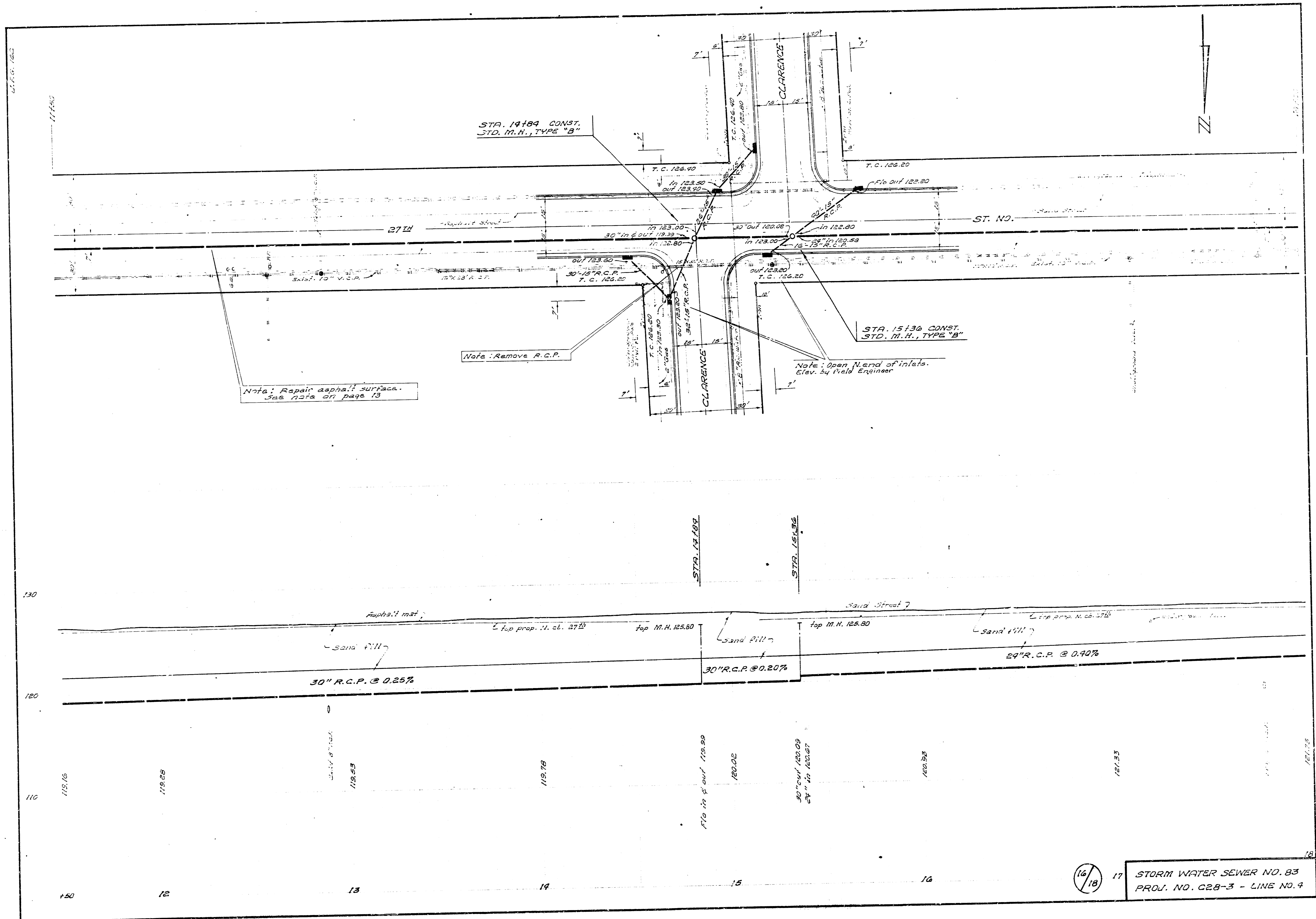

16/18

STORM WATER SEWER NO. 83  
 PROJ. NO. C28-3 - LINE NO. 4

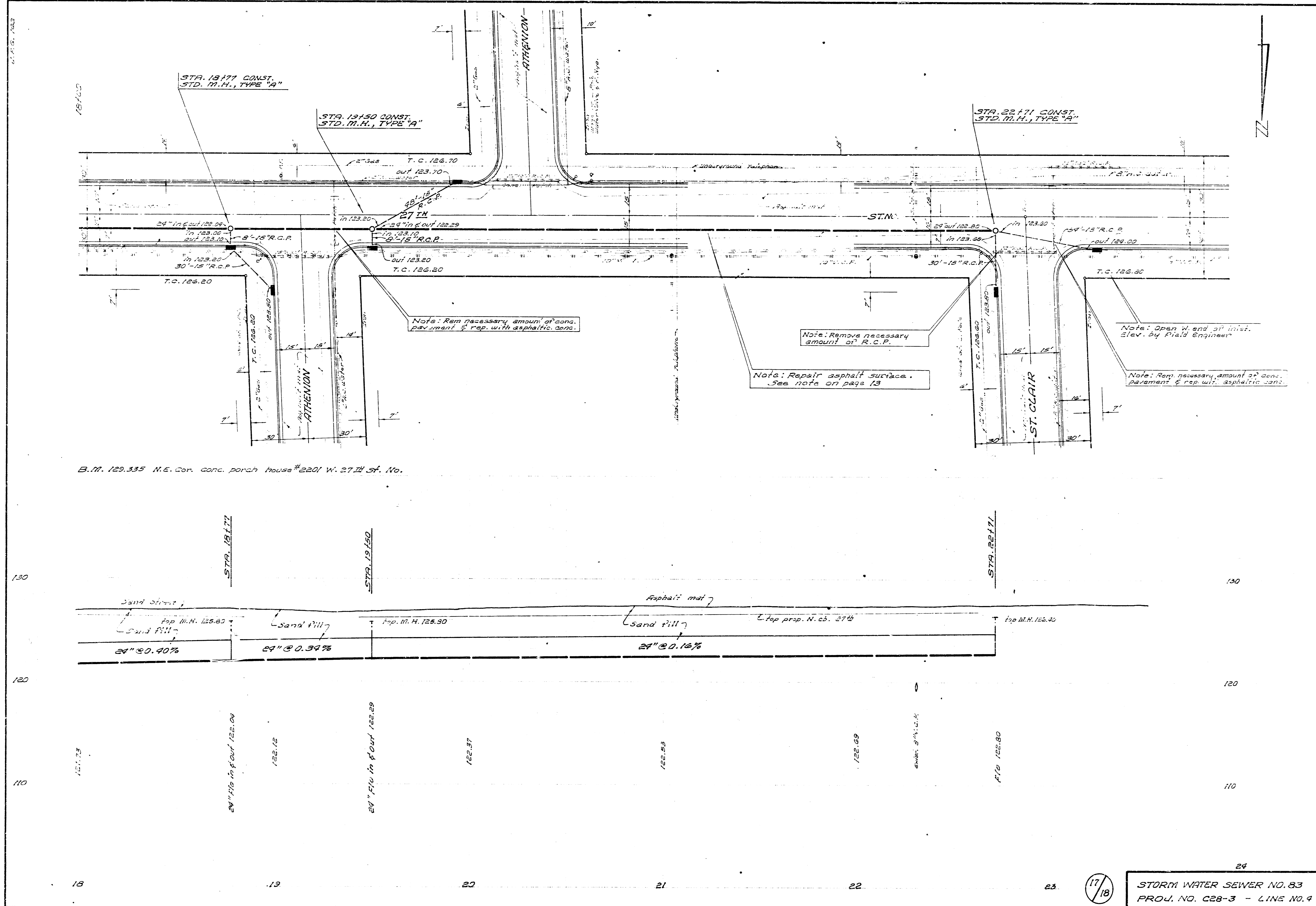

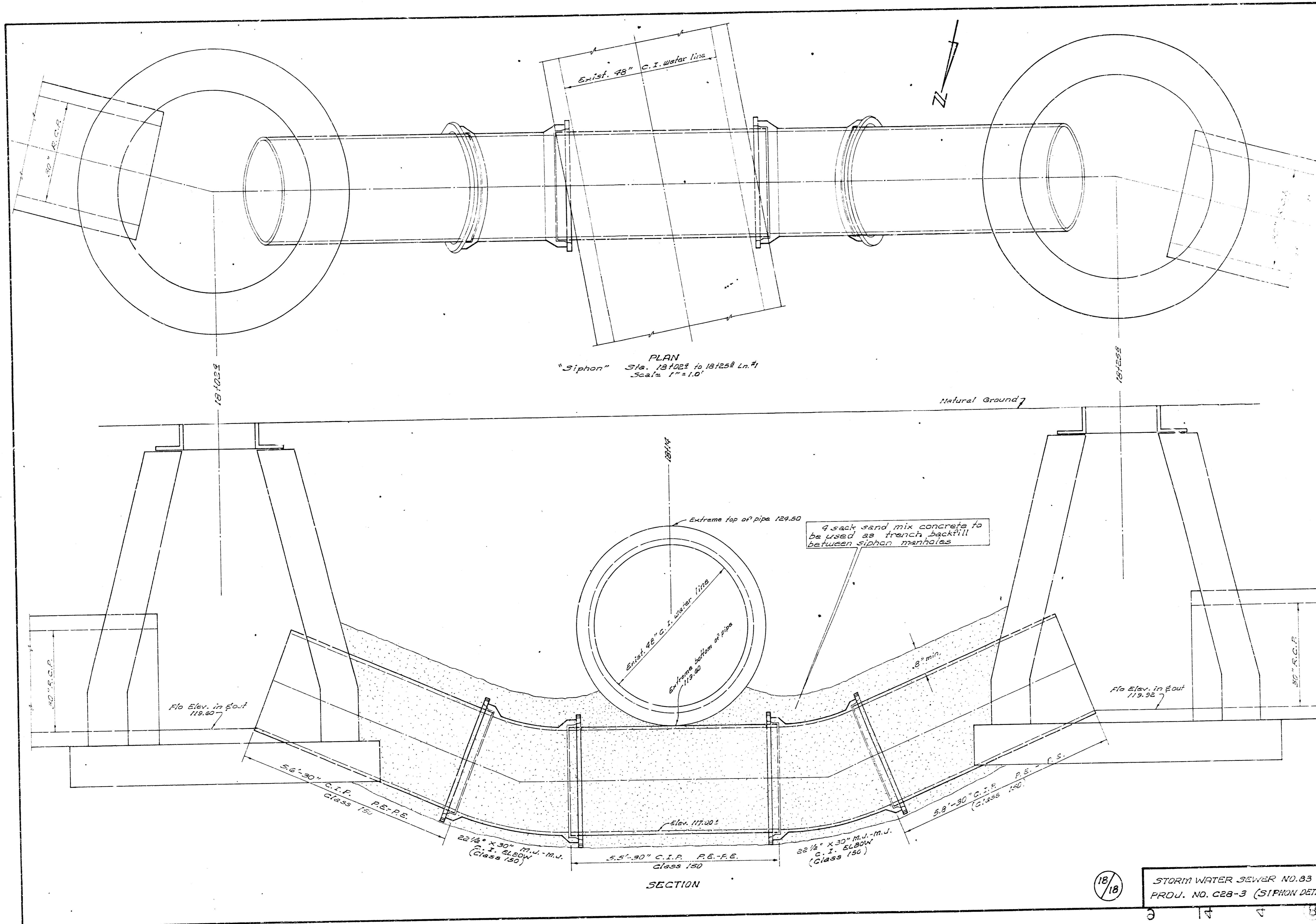

PLAN  
 "Siphon" Sta. 181023 to 181253 Ln.#1  
 Scale 1"=10'

SECTION

18/18

STORM WATER SEWER NO. 83  
 PROJ. NO. C28-3 (SIPHON DETAIL)