

B.M. 144.36 N.W. corner conc. Po. House N.E. corner Dellrose & Kinkaid.  
 Chaining from W. to E. on offset line 7' S. of N. P.L.

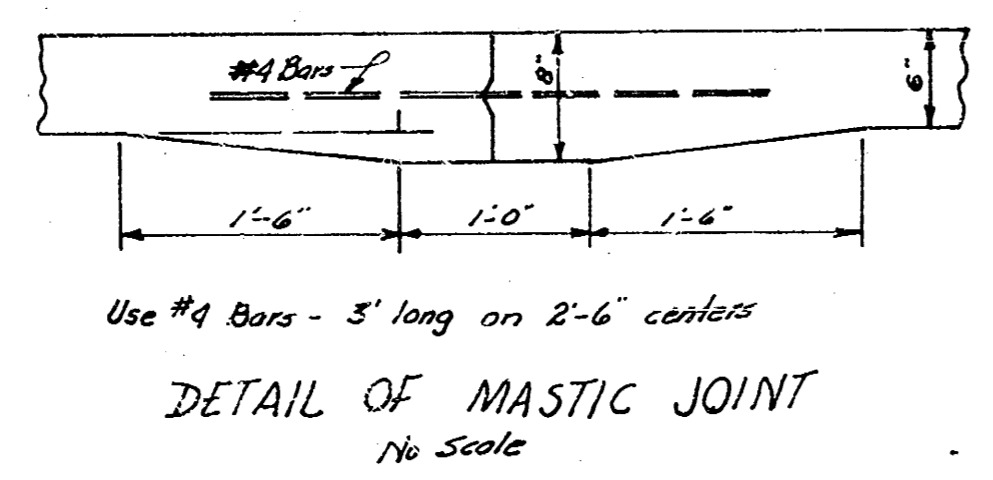

**KINKAID ST.**  
 EL DELLROSE TO EL OLIVER  
 30 Conc. & Cb.  
 CITY OF WICHITA, KANSAS  
 B. E. SMITH CITY ENGINEER  
 PROJ. NO. C-17-18

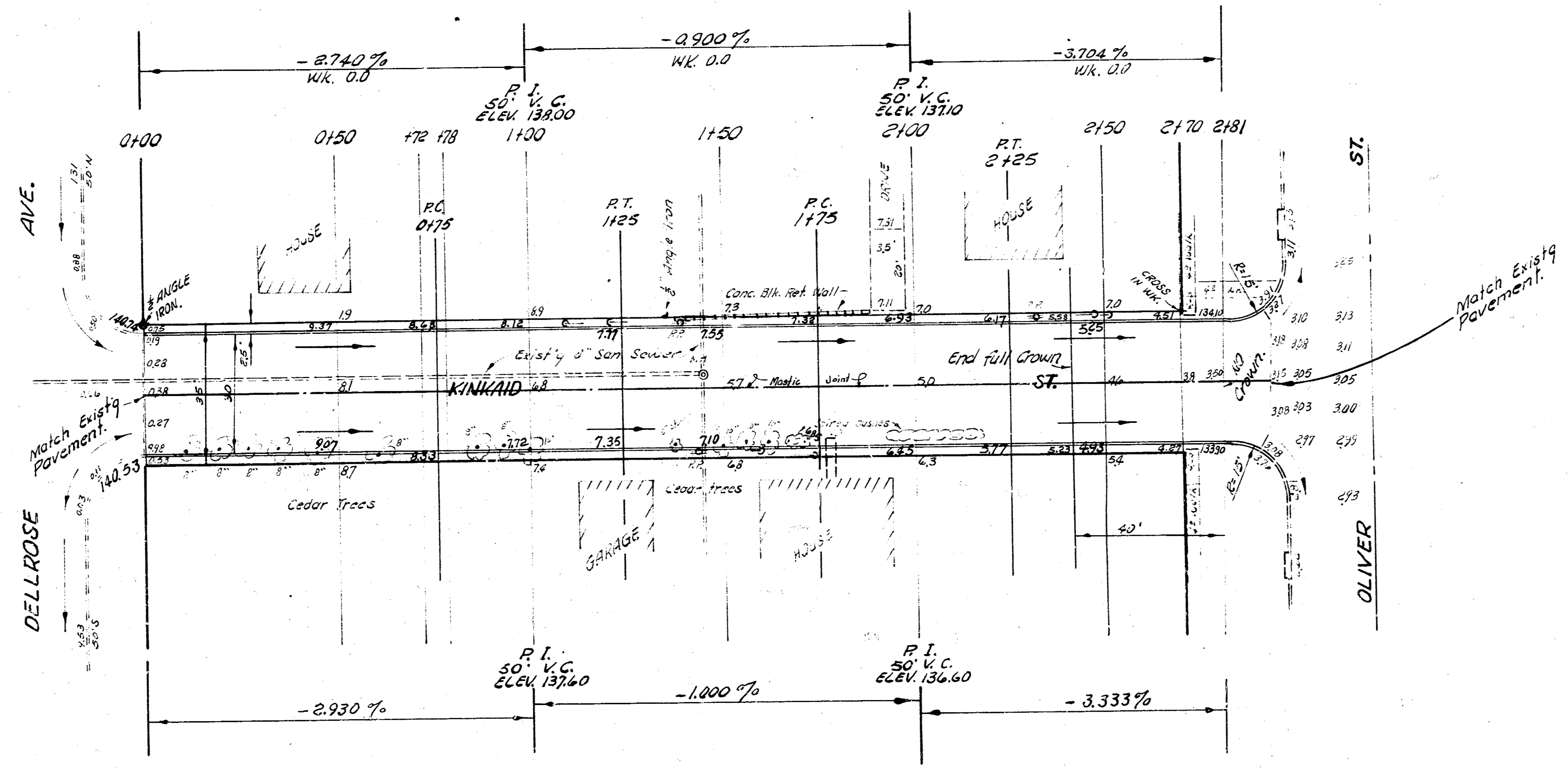
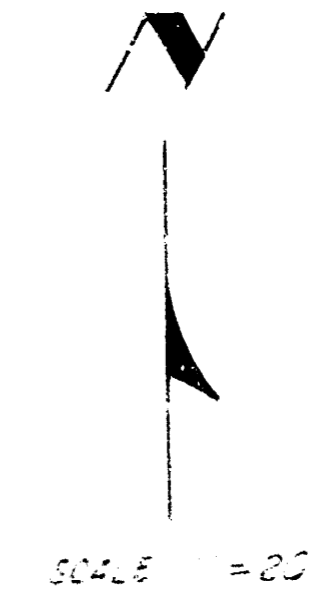
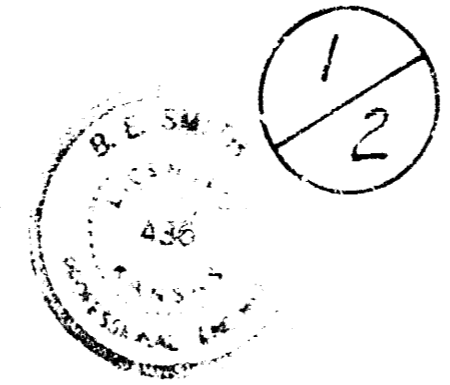

REVIEWED BY: [Signature]  
 DATE: 12/1/18