

B.M. + TOP C.B. SO. SIDE SWS. HEADWALL, 5' E. OF EAST C.B. AT WEST ARMOUR DR. & 385' NO. OF N. RAD. AT W. ARMOUR DR & LINCOLN. ELEV. 139.76

TIES TO IRON & LINCOLN & STA 1+68

89.60' N.W. TO NAIL IN N.E. FACE OF P.P.
82.85' N.E. TO S.W. COR. OF FOUNDATION BRICK LEDGE AT 4TH HOUSE.
E. OF EAST ARMOUR DR. ON LINCOLN FACING SOUTH.

EXCAV. (S.W.)			EXCAV. (S.E.)		
PROP.	CITY	CITY WIDENING	PROP.	CITY	CITY WIDENING
14.138 Cu.Yds.	3.852 Cu.Yds.	1.226 Cu.Yds.	278.8 Cu.Yds.	182.3 Cu.Yds.	218 Cu.Yds.

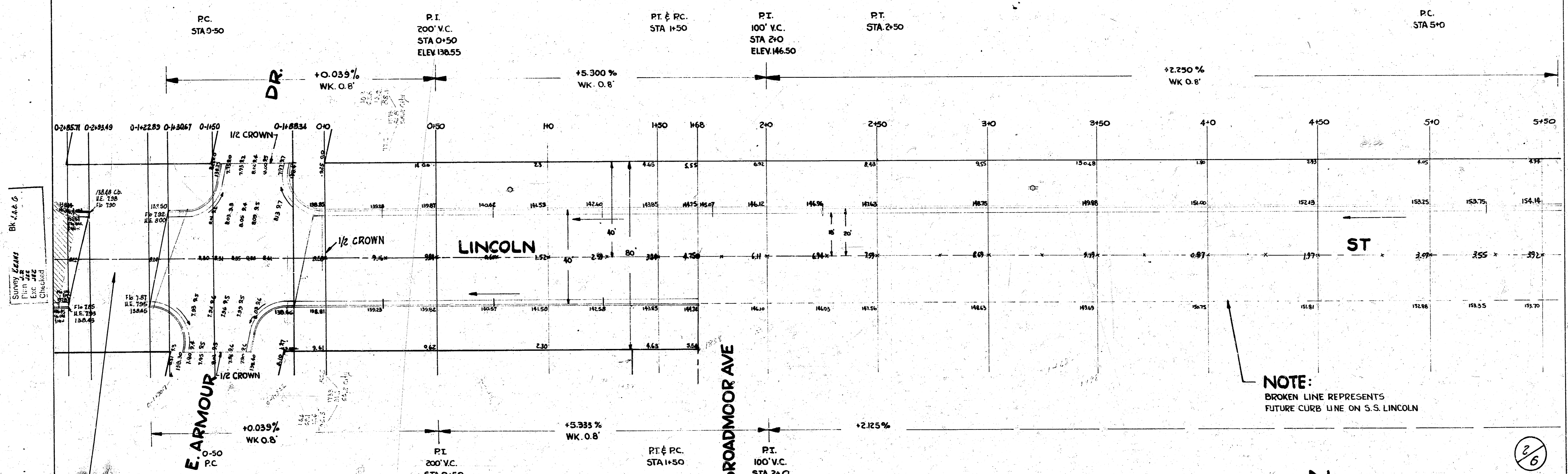

NOTE:
BROKEN LINE REPRESENTS
FUTURE CURB LINE ON S.S. LINCOLN

NOTE:
Location of 4-barrel
rein. conc. box culvert.

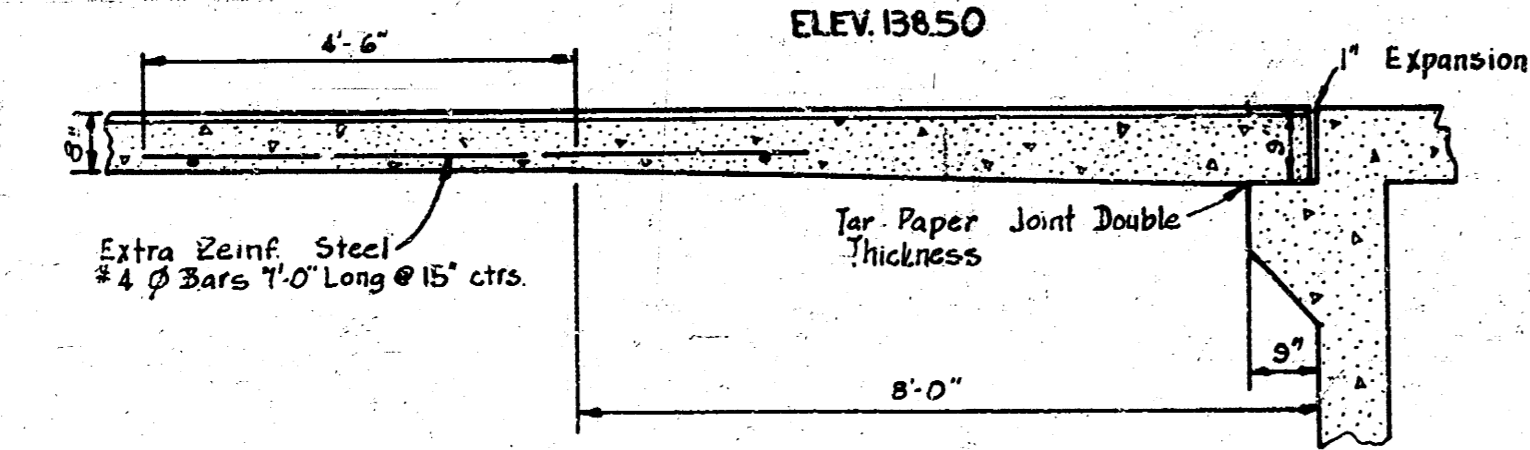

DETAIL SHOWING INCREASED
PAVEMENT THICKNESS AT CULVERT APPROACH
NOT TO SCALE

TOTAL EXCAV. (S.W.)			TOTAL EXCAV. (S.E.)		
PROP.	CITY	CITY WIDENING	PROP.	CITY	CITY WIDENING
57.8	22.3	9.8	242.7	527.3	589.1
+10% 38.0	+10% 12.2	+10% 3.8	+10% 267.3	+10% 527.3	+10% 589.1
217.8 Cu.Yds.	138.3 Cu.Yds.	107.6 Cu.Yds.	2943.0 Cu.Yds.	589.0 Cu.Yds.	748.0 Cu.Yds.



S 1/2 LINCOLN ST
E.L. W. ARMOUR DR TO E. BROADMOOR
13-2-15 AC PROJ. NO. C15-58
WIDEN TO 20', 6" CONC. BASE C15-59
B.E. SMITH CITY ENGINEER
MAR 1955

N 1/2 LINCOLN ST
E.L. W. ARMOUR DR TO W.L. ROCK RD.
13-2-15 AC PROJ. NO. C14-161
WIDEN TO 20' AC, 6" CONC.
BASE, & CULVERT PROJ. NO. C15-35
B.E. SMITH CITY ENGINEER
MAR 1955

B.M. 1/2" SPIKE IN N. FACE PP. N.S. LINCOLN 67' W. OF W.L. LONGFELLOW ELEV. 15735

EXCISE
 DATE: 11/15/1954
 BY: [illegible]
 FOR: [illegible]

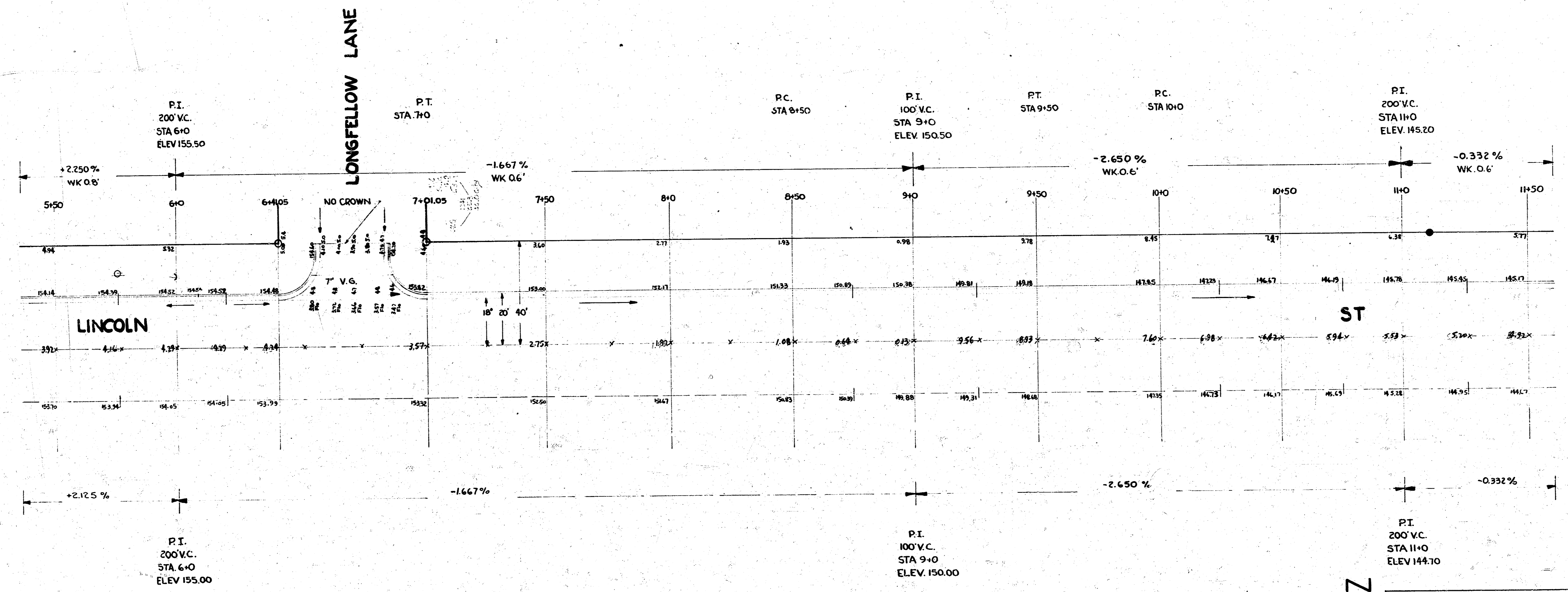

LINCOLN

ST

P.I.
 200' V.C.
 STA 6+0
 ELEV. 155.00

P.I.
 100' V.C.
 STA 9+0
 ELEV. 150.00

P.I.
 200' V.C.
 STA 11+0
 ELEV. 144.70

3/6

N

N 1/2 LINCOLN ST.
 PROJ. NOS. C14-161 & C15-35

