

# LONGFELLOW LANE

FROM N.L. OSIE STREET TO S.L. HARRY STREET  
 B.E. SMITH CITY ENGINEER CITY OF WICHITA KANSAS

PROJECT NO. C 16 - 55

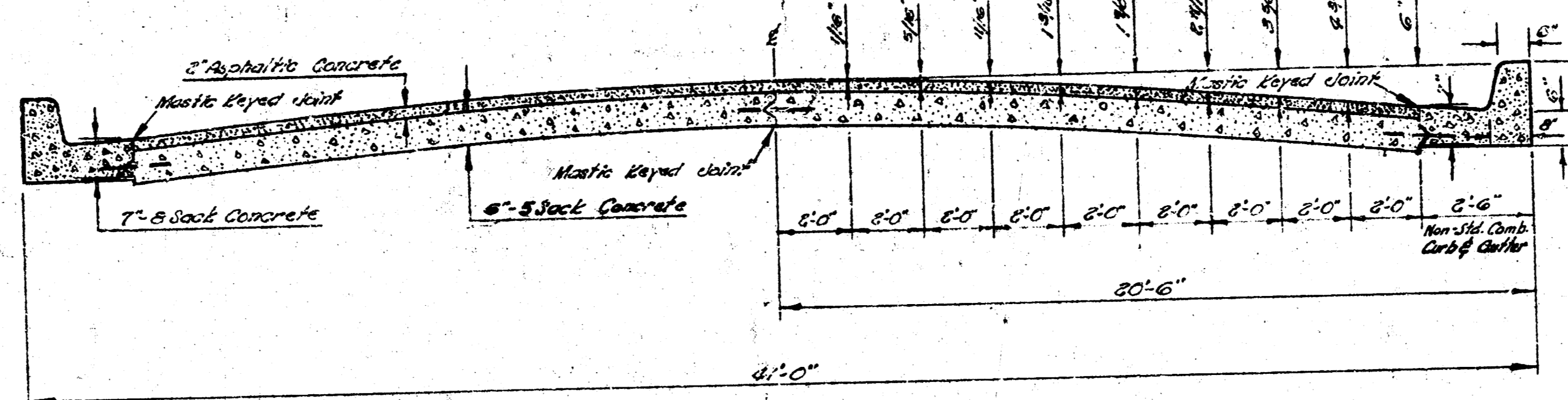

TYPICAL SECTION  
 NOT TO SCALE

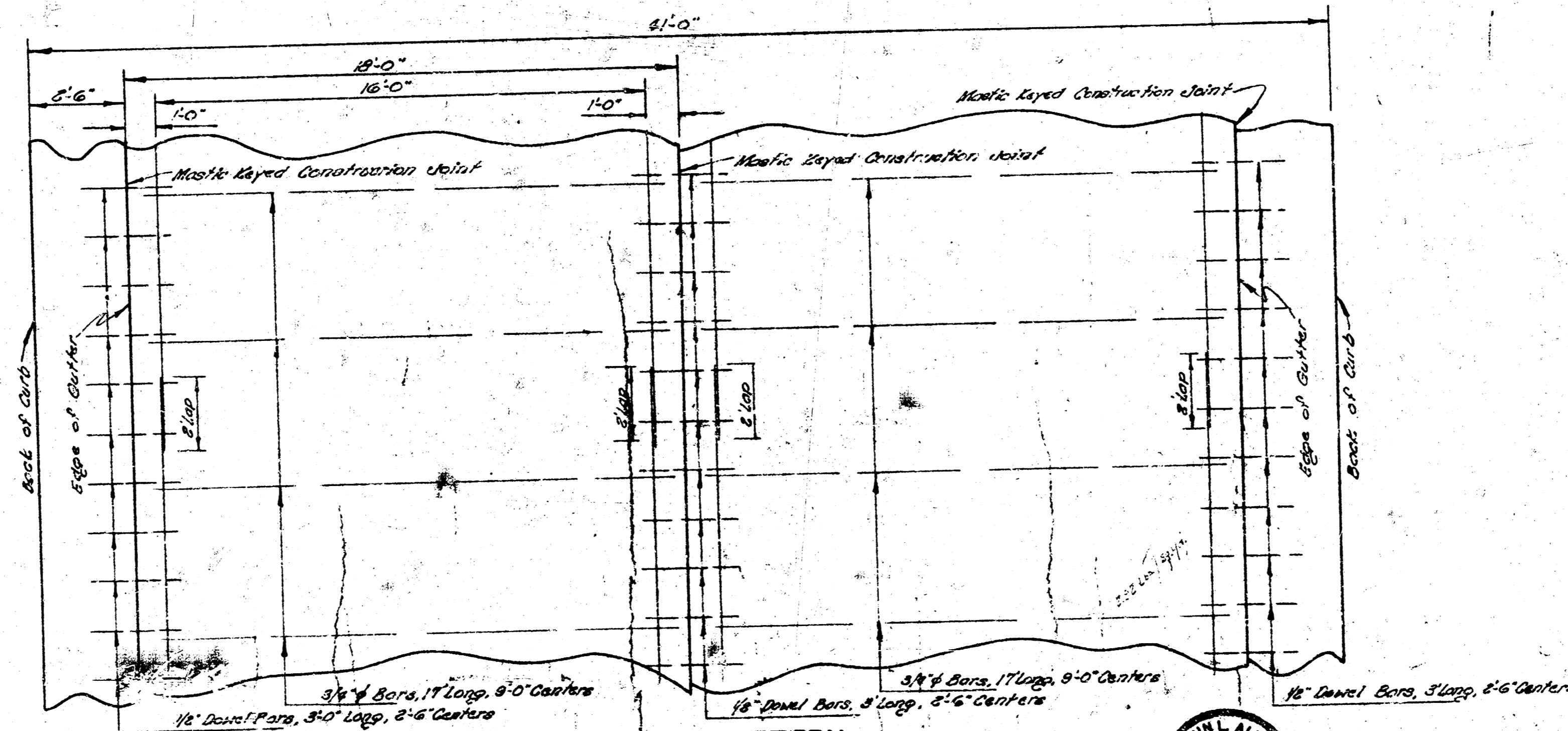

STEEL PATTERN  
 1/65 3/4" Ø BARS EXCEPT WHERE NOTED  
 NOT TO SCALE

1/5  
 1/6  
 1/7  
 1/8  
 1/9  
 1/10  
 1/11  
 1/12  
 1/13  
 1/14  
 1/15  
 1/16  
 1/17  
 1/18  
 1/19  
 1/20  
 1/21  
 1/22  
 1/23  
 1/24  
 1/25  
 1/26  
 1/27  
 1/28  
 1/29  
 1/30  
 1/31  
 1/32  
 1/33  
 1/34  
 1/35  
 1/36  
 1/37  
 1/38  
 1/39  
 1/40  
 1/41  
 1/42  
 1/43  
 1/44  
 1/45  
 1/46  
 1/47  
 1/48  
 1/49  
 1/50  
 1/51  
 1/52  
 1/53  
 1/54  
 1/55  
 1/56  
 1/57  
 1/58  
 1/59  
 1/60  
 1/61  
 1/62  
 1/63  
 1/64  
 1/65  
 1/66  
 1/67  
 1/68  
 1/69  
 1/70  
 1/71  
 1/72  
 1/73  
 1/74  
 1/75  
 1/76  
 1/77  
 1/78  
 1/79  
 1/80  
 1/81  
 1/82  
 1/83  
 1/84  
 1/85  
 1/86  
 1/87  
 1/88  
 1/89  
 1/90  
 1/91  
 1/92  
 1/93  
 1/94  
 1/95  
 1/96  
 1/97  
 1/98  
 1/99  
 1/100

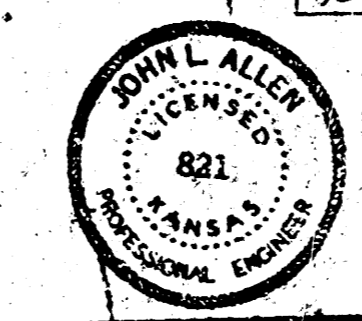
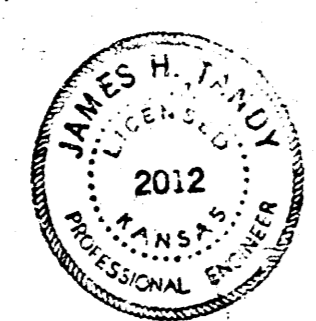
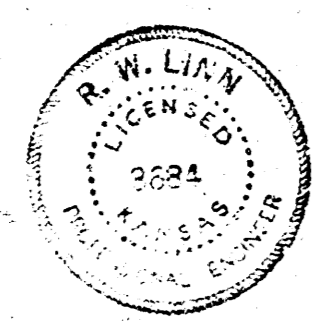

B.M. 162.56 Extrema S.E. cor. of loading dock  
"Metal Edge" @ S.E. cor. large conc. blk building  
on N.W. corner Osie of Longfellow.

Scale: 1" = 20'

Survey JFG  
Plan JLA  
Exam JLA  
Checked

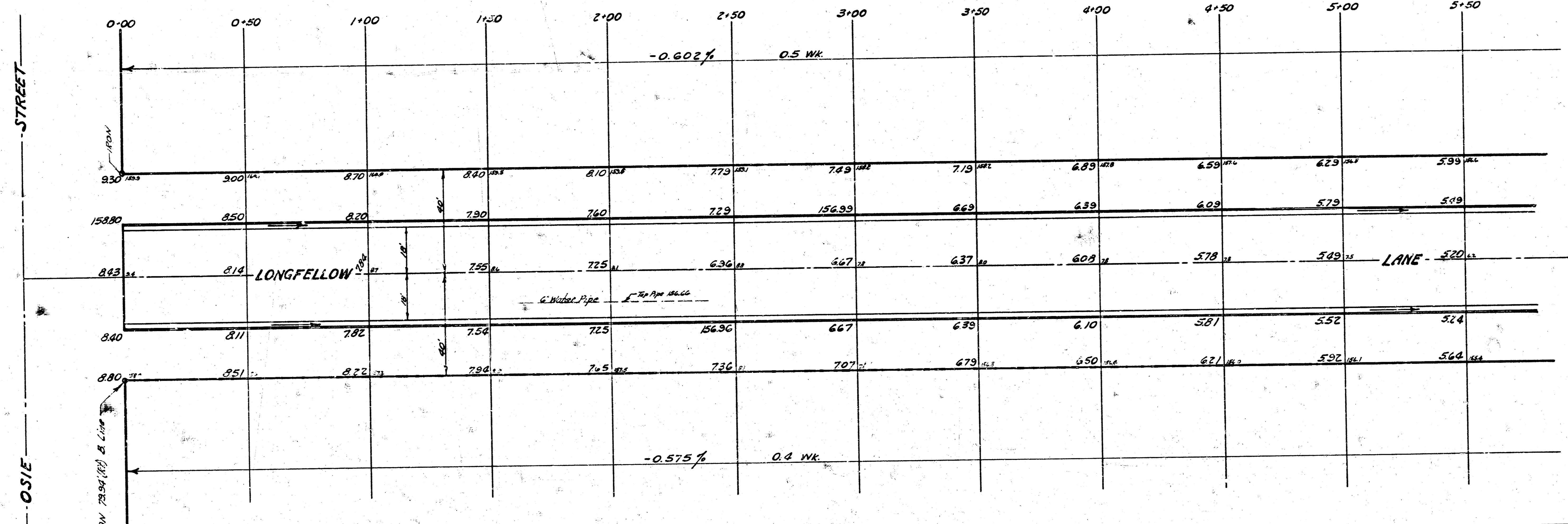

PROPERTY	CITY
EXCAVATION	EXC. COMP. FILL
3241	21 Cu Yds. 27 Cu Yds.
110	2
Totals 3355 Cu Yds.	23 Cu Yds. 30 Cu Yds.

NOTE: Paving Contractor is to remove existing 6" pipe where it conflicts with pavement sub-grade. No pay item, incidental to excavation.

**LONGFELLOW LANE**  
From N.L. OSIE STREET  
to S.L. HARRY STREET  
36'-2'-40" Asph. Conc.  
B.E. SMITH CITY ENGINEER  
CITY OF WICHITA KANSAS  
Date: OCT. 1965  
Proj. No. C 16-55

2/5

B.M. 156.11 R.P. spike S. side power pole on N. side Harry at 30' E. of W.L. Longfellow S.  
 B.M. 145.33 "X" top W. end of N. Handrail on R.C.C. on Harry, 23' E. of Rock Road.

