

BASELINE is CTR. LOOMAN AVE.

BM 176.09 N.W. COR. 25<sup>TH</sup> ST. & OLIVER.  
 B.M. 183.79 @ ON TOP CURB W/S OLIVER, 1/2<sup>ND</sup> CR. JOINT N. OF ST. ARLENE EXT.  
 B.M. 186.39 S.W. COR. CONC. PORCH, No. #4914 E. 24<sup>TH</sup> ST. No.

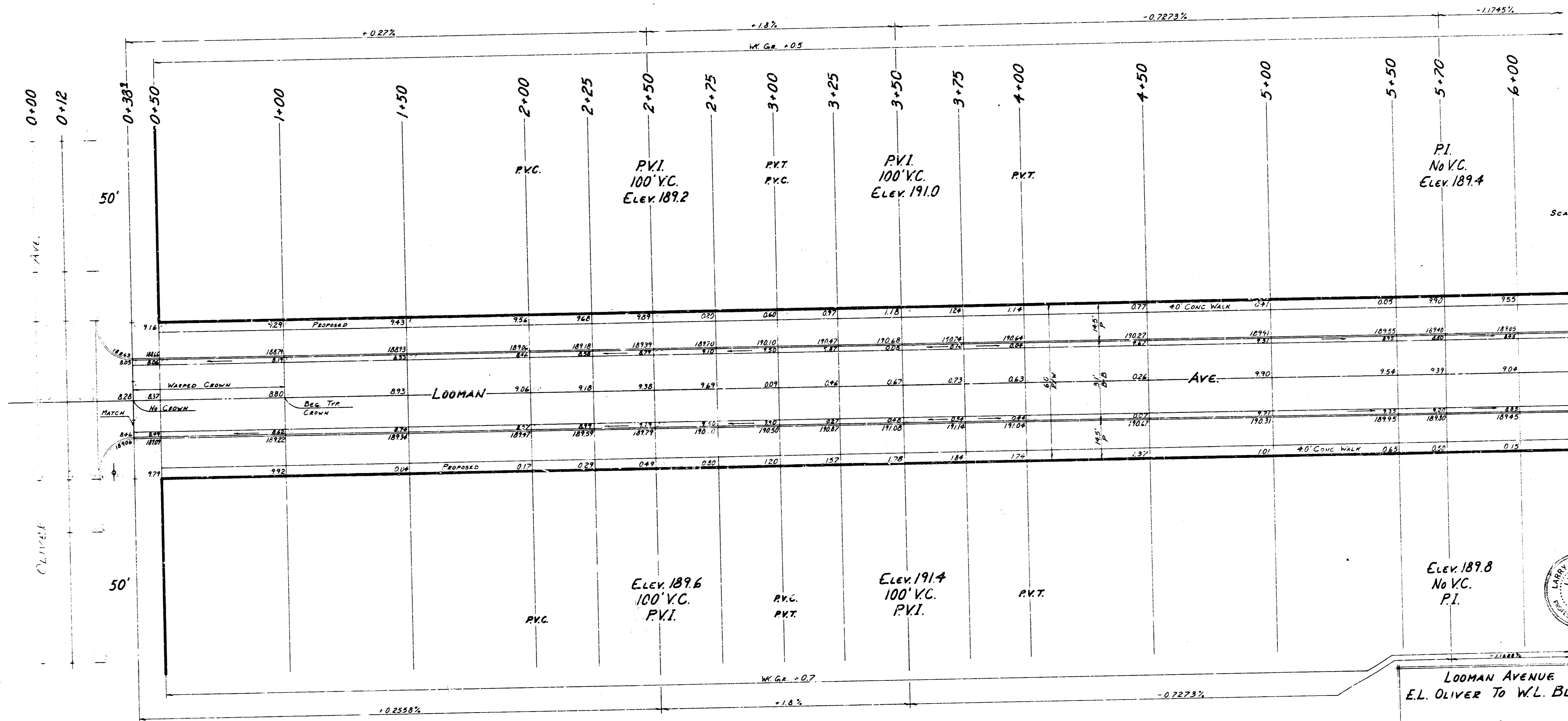

SURVEY DONE BY D.D. DAVIS  
 P.L.C. APPROVED  
 CHECKED

NOTE: CONTRACTOR TO CLEAR RIGHT-OF-WAY, GRADE PARKING AND CONSTRUCT COMPACTED FILL WHERE NECESSARY FOR PROPOSED SIDEWALK. SIDEWALK TO BE CONSTRUCTED BY OTHERS. FIELD ENGINEER IS TO DETERMINE THE TYPE OF SUBGRADE TREATMENT WHICH IS TO BE USED. SUBGRADE TREATMENT MAY CONSIST OF LIME TREATED SUBGRADE, CEMENT TREATED SUBGRADE, RE-COMPACTION OF EXISTING SUBGRADE MATERIAL AS SPECIFIED IN STANDARD SPECIFICATIONS, OR ANY COMBINATION OF THESE.

**EARTHWORK CITY**  
 EXCAVATION 113 Cu. Yds.  
 +10% 11.1 Cu. Yds.  
 TOTAL 124 Cu. Yds.

**EARTHWORK PROPERTY**  
 EXCAVATION 1867.8 Cu. Yds.  
 +10% 186.8 Cu. Yds.  
 COMPACTED FILL 212 Cu. Yds.  
 +10% 21.1 Cu. Yds.  
 TOTAL 1834.6 Cu. Yds.

LOOMAN AVENUE  
 E.L. OLIVER TO W.L. BLECKLEY  
 ASPHALTIC CONCRETE PAYMT  
 3" B-B WITH COMB. CB & GTR.  
 CITY OF WICHITA, KANSAS  
 R.W. LINN CITY ENGINEER  
 PROJECT No. DAKS 569028  
 DATE: \_\_\_\_\_



SUPERVISOR DR. BOGGS  
CITY ENGINEER  
CITY OF WICHITA, KANSAS

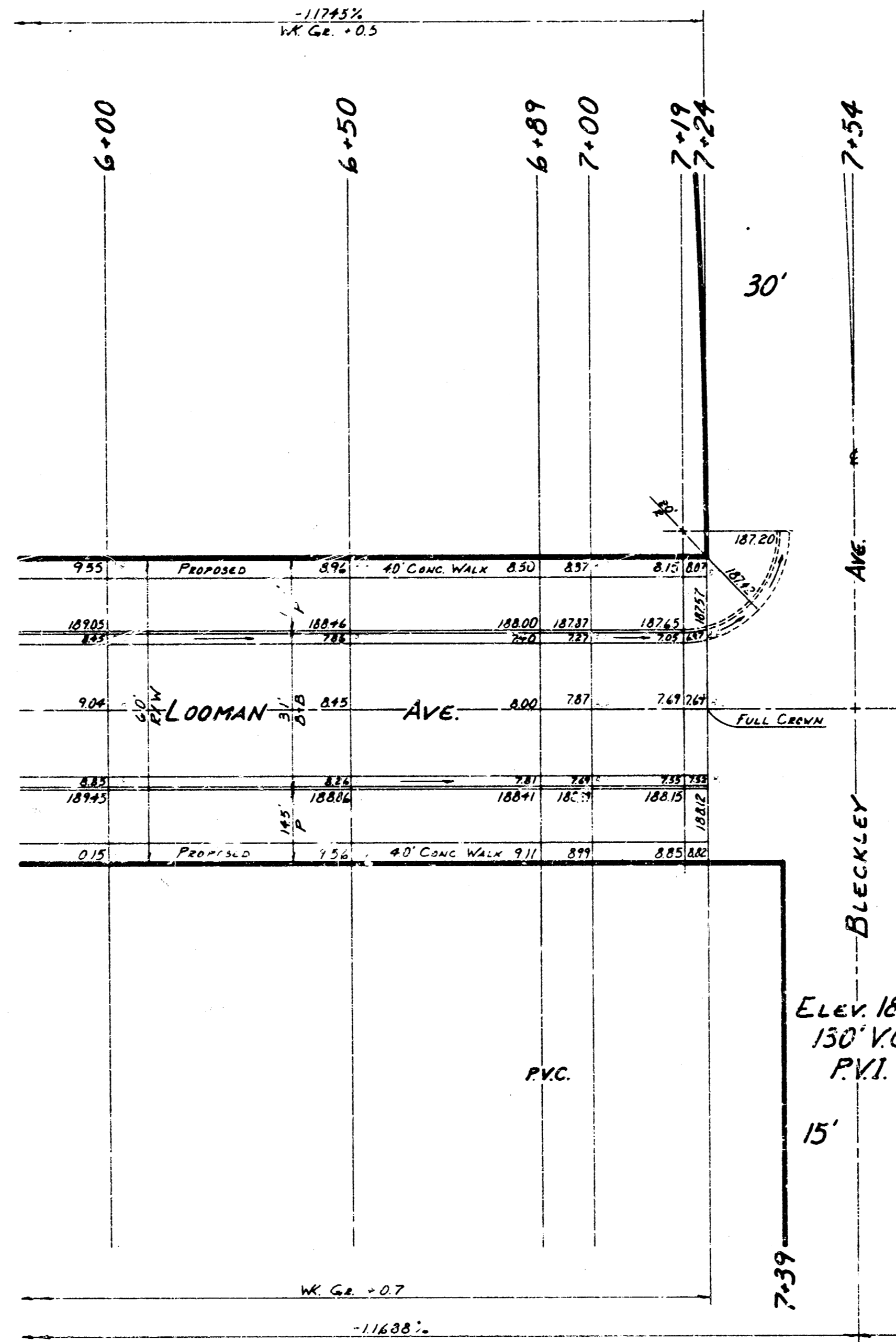

NOTE: BLECKLEY AVE. SHALL BE GRADED TO THE NORTH SO THAT THE DRAINAGE WATER FROM LOOMAN AVE. WILL DRAIN TO THE NORTH. THE FIELD ENGINEER SHALL TAKE ORIGINAL AND FINAL CROSS-SECTIONS TO DETERMINE THE FINAL PAY QUANTITY OF CU. YDS. OF EXCAVATION. (GRADE APPROX. 225' NORTH)

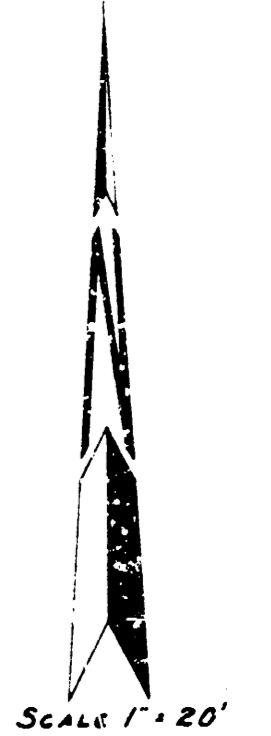

LOOMAN AVENUE  
E.L. OLIVER TO W.L. BLECKLEY  
ASPHALTIC CONCRETE PAYMT  
3' B-B WITH COMB. C.B. & GTR.  
CITY OF WICHITA, KANSAS  
R.W. LINN CITY ENGINEER  
PROJECT No. DAKS 569028  
DATE: 28