

Scale 1/4" = 100'

ON 17685 "T" TOP CO. E. and Radius S.E. of Douglas
Base Line - West + South Property Lines.

AVENUE

DOUGLAS

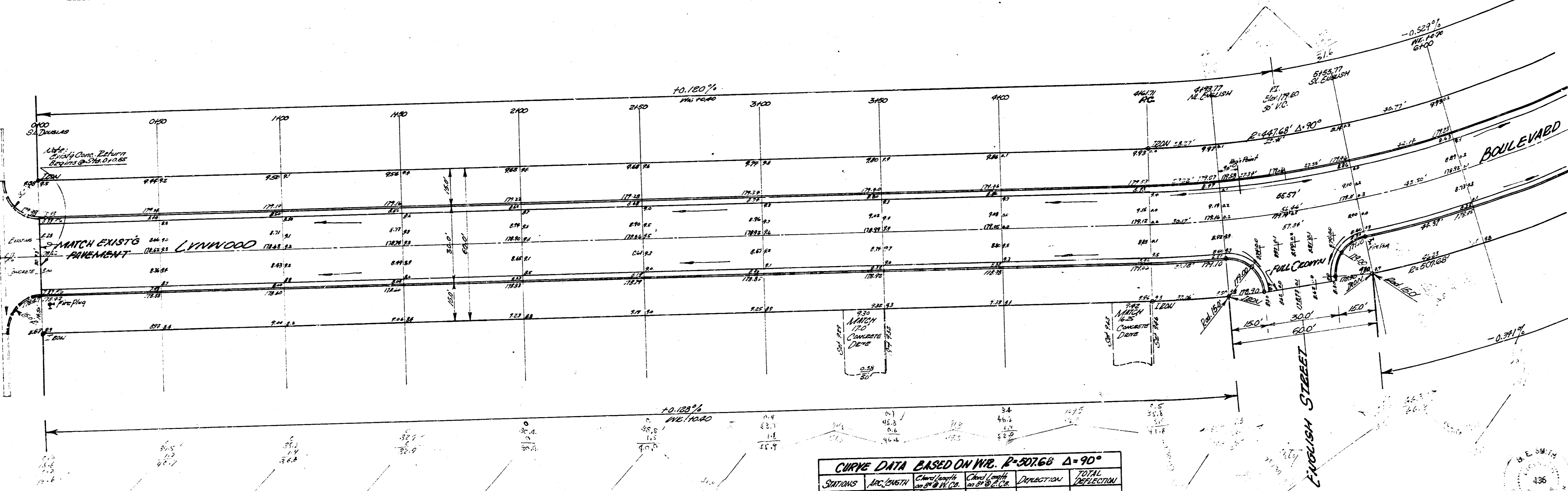

CURVE DATA BASED ON H.W. P-507.68 Δ=90°

STATIONS	ARC LENGTH	Chord Length on 1" = 100'	Chord Length on 1" = 50'	DEFLECTION	TOTAL DEFLECTION
6+46.77	32.00'	31.60	22.71	1° 08' 33"	1° 08' 33"
6+78.77	32.00'	31.60	22.71	3° 28' 09"	5° 11' 48"
7+10.77	32.00'	31.60	22.71	5° 47' 31"	7° 08' 13"
7+42.77	32.00'	31.60	22.71	8° 06' 17"	10° 37' 30"
7+74.77	32.00'	31.60	22.71	10° 24' 47"	13° 06' 47"
8+06.77	32.00'	31.60	22.71	12° 43' 17"	15° 35' 21"
8+38.77	32.00'	31.60	22.71	15° 01' 47"	18° 03' 51"
8+70.77	32.00'	31.60	22.71	17° 20' 17"	20° 32' 21"
9+02.77	32.00'	31.60	22.71	19° 38' 47"	23° 00' 51"

EXCAVATION TOTALS

PROPERTY	CITY	W&E
151.1	117.9	167
1668.3 CF	117.9 CF	

LYNNWOOD BOULEVARD
S.E. DOUGLAS - N.W. RIDGECREST
26-2-30 A.C.

CITY OF WICHITA, KANSAS
B.E. SMITH CITY ENGINEER
DATE: SEPT. 1958, PROJ. NO. C-14-33



Sheet 1/2

