

B.M. 120.935 'X' TOP OF CURB AT S END OF S.E. RADIUS, 17TH & WOODROW COURT.
 B.M. 124.34 Z.R. SPIKE S.S. H.L.P. S.E. COR. 18TH & WOODROW COURT.
 BASE LINE AND STATIONING ON SOUTH AND WEST PROPERTY LINE.

~ PROPERTY EXCAVATION TOTALS ~

435.3 Cu. Yds. Property Cut
 44.7 Cu. Yds.
 480.0 Cu. Yds. Property Cut

NOTE: THIS PROJECT STATIONED S.E. to N.W.

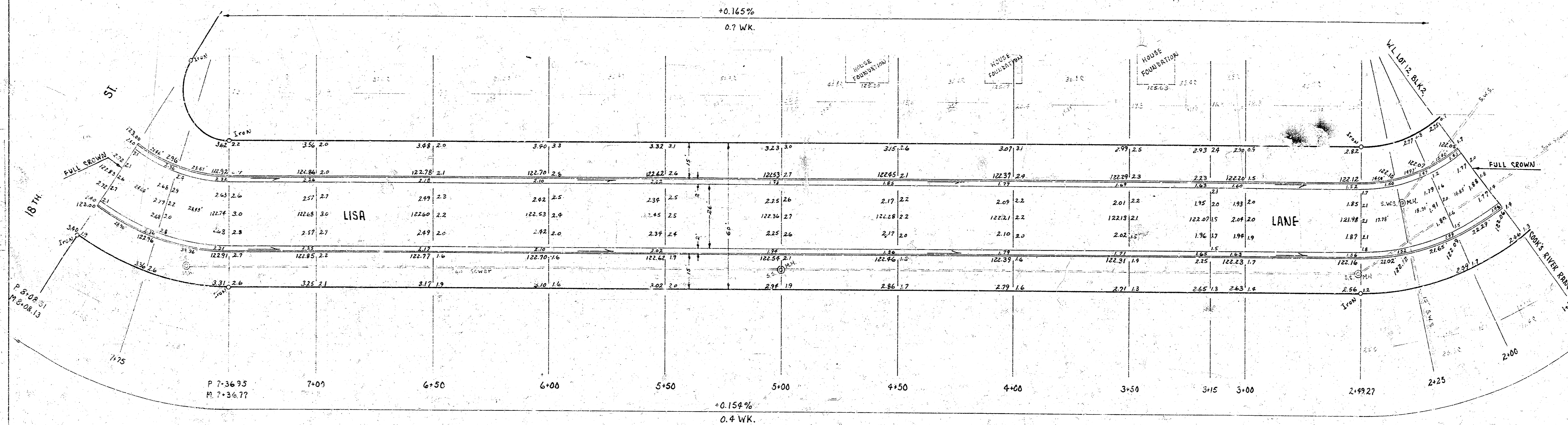

CURVE DATA STA. 7+36.77 to STA. 8+08.13
 BASED ON WEST PROPERTY LINE

$\Delta = 34^{\circ} 45' 00''$
 $\frac{1}{2}\Delta = 17^{\circ} 22' 30''$
 $R = 112.16'$
 $ARC = 71.36'$
 $MIN. DEFL./FT. = 1/16.602781$

STATION	DEFL. \angle	TOTAL DEFL. \angle	CHORD 8' OFF S.W. CB.	CHORD 8' OFF N.E. CB.	ARC ON WEST P.L.
P.C. 7+36.77					
7+75	$9^{\circ} 18' 30''$	$9^{\circ} 18' 30''$	35.80	20.92	38.23
P.T. 8+08.13	$8^{\circ} 03' 57''$	$17^{\circ} 22' 27''$	51.06	18.15	58.18

CURVE DATA STA. 1+41.12 to STA. 2+99.27
 BASED ON SOUTH & WEST PROP. LINE

$\Delta = 55^{\circ} 15' 00''$
 $\frac{1}{2}\Delta = 27^{\circ} 37' 30''$
 $R = 112.16'$
 $ARC = 108.15'$
 $MIN. DEFL./FT. = 1/12.325153$

STATION	DEFL. \angle	TOTAL DEFL. \angle	CHORD 8' OFF S.W. CB.	CHORD 8' OFF N.E. CB.	ARC ON S.W. P.L.
P.C. 1+41.12					
1+74.27	$8^{\circ} 28' 02''$	$8^{\circ} 28' 02''$	30.97	17.42	33.15
END PROJ. NO. C19-4, BEGIN PROJ. NO. C19-5					
1+74.27	$8^{\circ} 28' 02''$	$8^{\circ} 28' 02''$	30.97	17.42	33.15
2+00	$6^{\circ} 34' 18''$	$15^{\circ} 02' 20''$	24.07	13.54	25.73
2+25	$6^{\circ} 23' 08''$	$21^{\circ} 25' 28''$	23.39	13.16	25.00
P.T. 2+99.27	$6^{\circ} 11' 57''$	$27^{\circ} 37' 26''$	22.71	12.78	24.27

LISA LANE
 W.L. LOT 12, BLK. 2, COOKS RIVER
 RANSH ADDN. to S.L. 18 TH.
 26-2-30 A.C.
CITY OF WICHITA, KANSAS
 B. E. SMITH CITY ENGINEER
 DATE: APRIL 1959, PROJ. NO. C19-5