

B.M. 178.08 S.W. cor. 1st Conc. St. & Ave. House # 3100 E. 24th.

Shelving on N.P.

0+00 N.W. 1/4 Sec. 22, T. 22 N., R. 15 W.

25.78' City Water 10' dia.

25.00' 25.00' 10' dia. City Water 10' dia. 25.00' 25.00' 10' dia. City Water 10' dia.

ST. JAVIER MATLOCK ADDITION

ST.

1:10 CROWN

23RD

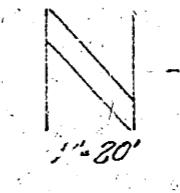
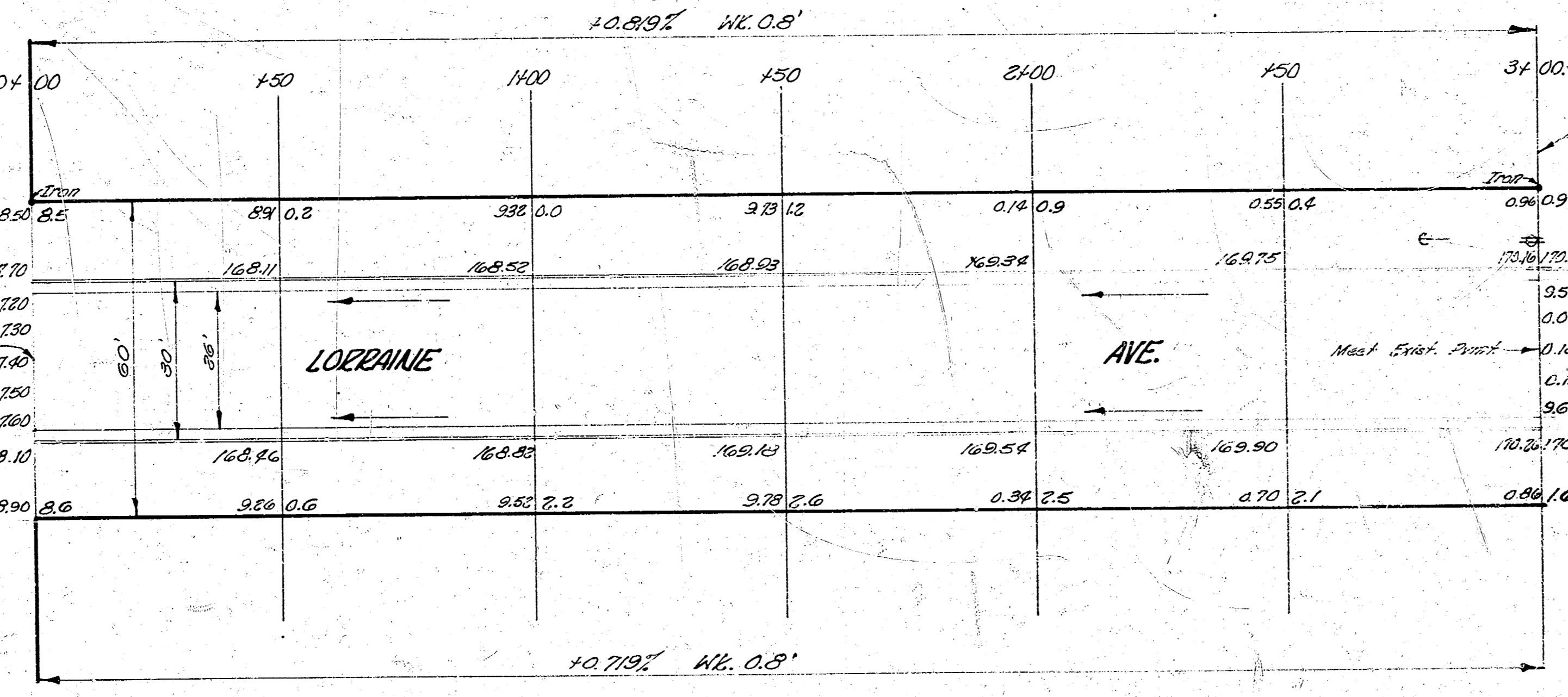

LORRRAINE AVE.
 N.W. 23RD ST. TO ST. JAVIER MATLOCK ADDITION
 26'-0" TO 30'-0" A.C.

CITY OF WICHITA, KANSAS.

B.E. SMITH
 AUG. 1953

CITY ENGINEER
 PROJ. NO. C13-77



1/2