

1941  
 LULU AVE - N.L. LINCOLN TO S.L. MORRIS  
 30' CONC. WITH INTEGRAL CURB  
 20 Dimes

Note: Rebuild con and lower catch basin

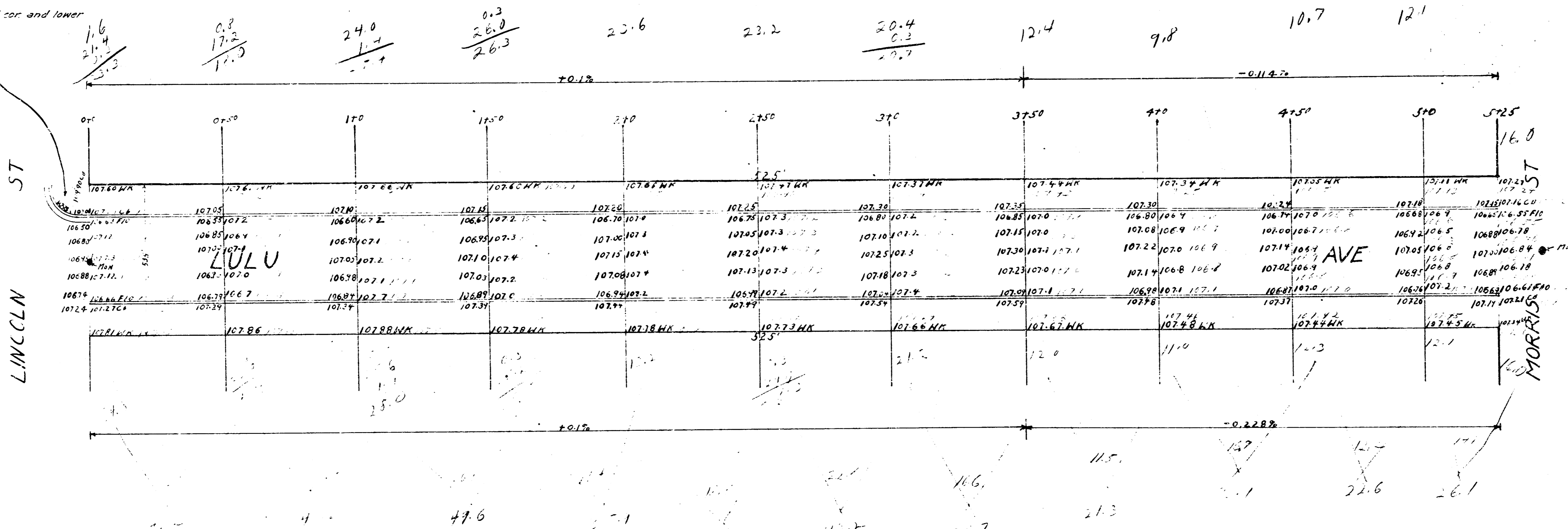

BM 10728 IRON IN THE G. LULU S.S. LINCOLN  
 BM 10713 " " " " " " N.S. "

12.2  
 4.2  
 4.2  
 1  
 24.8  
 42.2  
 2.7  
 21.3  
 30.4  
 2.6  
 1.1  
 1.5