

STATE OF KANSAS
CITY OF WICHITA

Federal Aid Project

KANSAS DEPARTMENT OF TRANSPORTATION PROJECT NUMBER 87 N-0359-01
HILLSIDE BRIDGE AT RANGE ROAD

2000 TRAFFIC CENSUS 7,999 VEHICLES PER DAY
DESIGN SPEED 35 mph

State	PROJECT No.	Year	Sheet No.	Total Sheets
Kansas	87 N-0359-01	2006	1	61
BRM-NO35(901)				

INDEX OF SHEETS

1	TITLE SHEET
2	TYPICAL SECTIONS
3-4	PLAN & PROFILE SHEETS
5-13	PAVEMENT DETAILS
13.001	SCHEDULE OF INLETS
13.002-13.003	CURB INLET DETAILS
14	SUMMARY OF BRIDGE QUANTITIES
15	CONTOUR MAP
16	CONSTRUCTION LAYOUT
17-28	BRIDGE DETAILS
29	SHEET PILING & CAP DETAILS
30	STANDARD PILE DETAILS
31	BRIDGE EXCAVATION
32	SUPPORTS & SPACERS FOR REINFORCING STEEL
33	CHAIN LINK FENCE DETAILS
34	SUMMARY OF QUANTITIES
35-41	WATER POLLUTION CONTROL
42	SEEDING DETAILS
43	PROJECT SURFACING
44-45	PAVEMENT MARKING DETAILS
46-50	TRAFFIC CONTROL PLAN
51	GENERAL NOTES WATER DISTRIBUTION PROJECT
52-53	WATERLINE PLAN & PROFILE
54-57	WATERLINE DETAILS
58-61	CROSS SECTIONS

BRIDGE
BRIDGE APPROACH PAVEMENT
ARTICULATING CONCRETE BLOCK
SLOPE PROTECTION
SEEDING
STORM SEWER
12" WATER LINE (Non-participating)

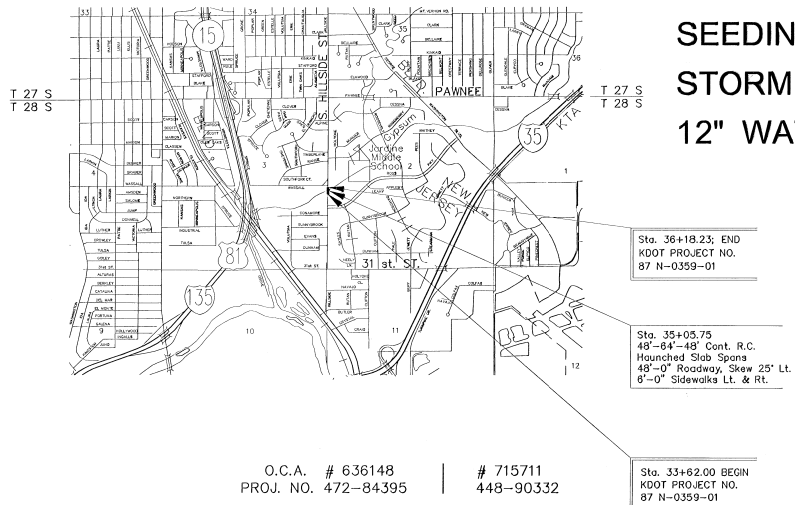

O.C.A. # 636148 | # 715711
PROJ. NO. 472-84395 | 448-90332

CONVENTIONAL SIGNS

COUNTY LINE	-----	CENTER LINE OF PROJECT	----- 50
CITY LIMITS	-----	TERRACE	-----
STATE OR NATIONAL LINE	-----	CULVERTS	-----
TOWNSHIP SECTION or GRANT LINE	-----	DROP INLET & STORM SEWER	-----
PROPERTY LINE	-----	ACCESS CONTROL	-----
HIGHWAY FENCE	-----	POWER POLE	-----
EXISTING FENCE	-----	TELEPHONE POLE	-----
GUARD FENCE	-----	MARSH	-----
CONSTRUCTION LIMITS	-----	HEDGE	-----
RIGHT OF WAY LINE	-----	TREES	-----
TRAVELED WAY	-----	PROFILE ELEVATION	-----
RAILROADS	-----	STREAM or CREEK	-----

GROSS LENGTH OF PROJECT	256.23	FT.
EXCEPTIONS		FT.
NET LENGTH OF PROJECT	256.23	FT. = 0.049 MI.
NET LENGTH OF BRIDGES	162.76	FT. = 0.031 MI.
NET LENGTH OF ROAD	93.47	FT. = 0.018 MI.

NOTE: ROAD SHALL BE CLOSED TO THRU TRAFFIC DURING CONSTRUCTION.



APPROVED:
Jim Armour
P.E. ENGINEER: JIM ARMOUR, P.E.
DATE: SEPT 21 2007