

DATE	BY	INITIALS
REFERENCE NOTED	REFERENCE CHECKED	

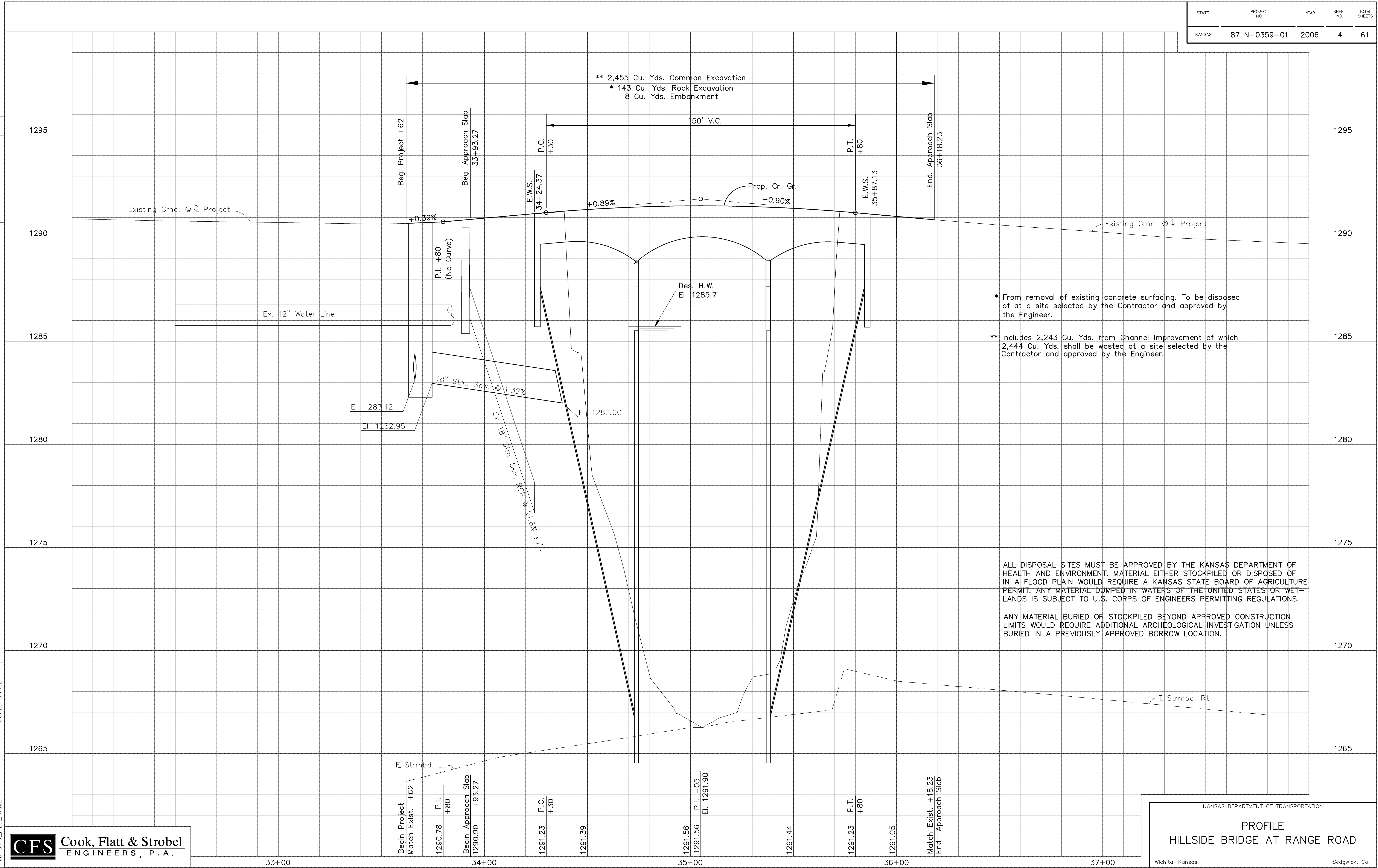

\* From removal of existing concrete surfacing. To be disposed of at a site selected by the Contractor and approved by the Engineer.

\*\* Includes 2,243 Cu. Yds. from Channel Improvement of which 2,444 Cu. Yds. shall be wasted at a site selected by the Contractor and approved by the Engineer.

ALL DISPOSAL SITES MUST BE APPROVED BY THE KANSAS DEPARTMENT OF HEALTH AND ENVIRONMENT. MATERIAL EITHER STOCKPILED OR DISPOSED OF IN A FLOOD PLAIN WOULD REQUIRE A KANSAS STATE BOARD OF AGRICULTURE PERMIT. ANY MATERIAL DUMPED IN WATERS OF THE UNITED STATES OR WETLANDS IS SUBJECT TO U.S. CORPS OF ENGINEERS PERMITTING REGULATIONS.

ANY MATERIAL BURIED OR STOCKPILED BEYOND APPROVED CONSTRUCTION LIMITS WOULD REQUIRE ADDITIONAL ARCHEOLOGICAL INVESTIGATION UNLESS BURIED IN A PREVIOUSLY APPROVED BORROW LOCATION.

Drawn by: [Name] Plotted: [Name]  
 File: DWG\_FILE\_NAME SCALE SCALE



KANSAS DEPARTMENT OF TRANSPORTATION

### PROFILE

## HILLSIDE BRIDGE AT RANGE ROAD

Wichita, Kansas Sedgwick, Co.

33+00 34+00 35+00 36+00 37+00