

STATE	PROJECT NO.	YEAR	SHEET NO.	TOTAL SHEETS
KANSAS	87 N-0359-01	2006	17	61

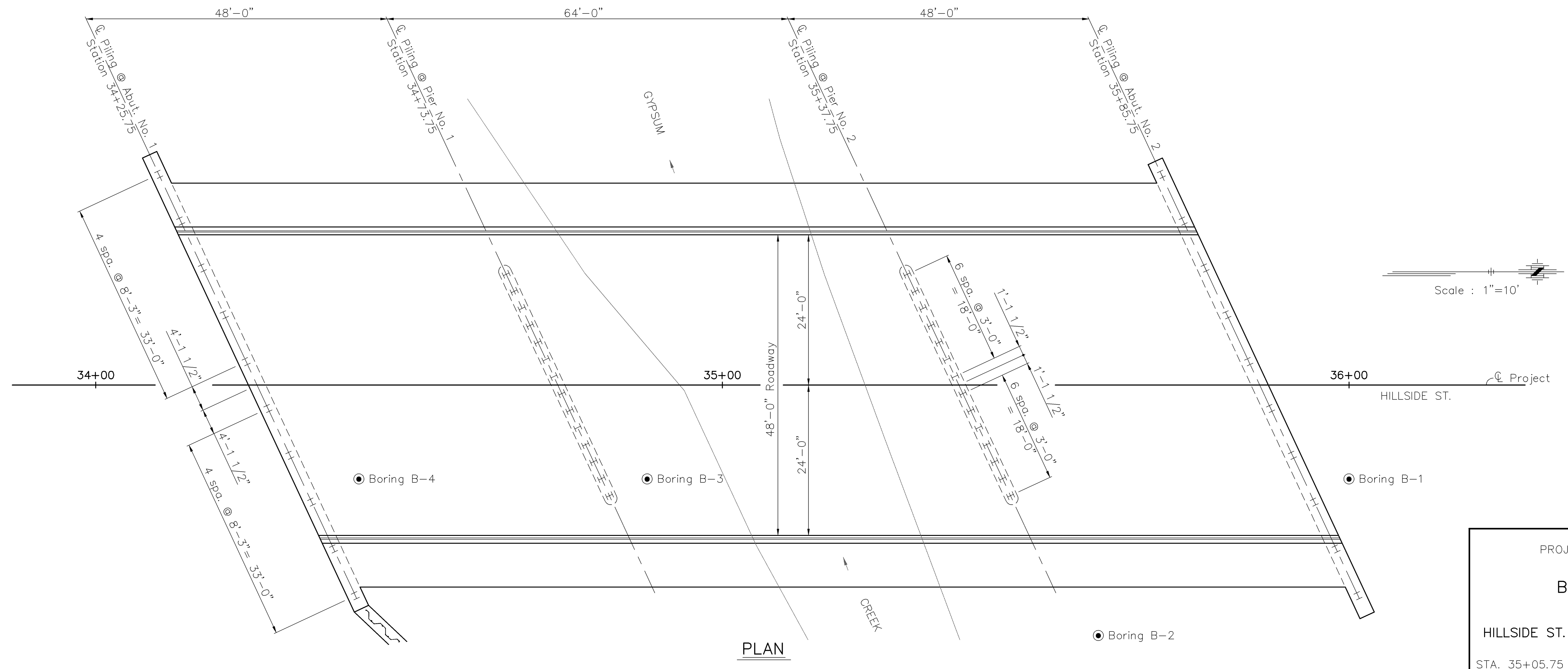
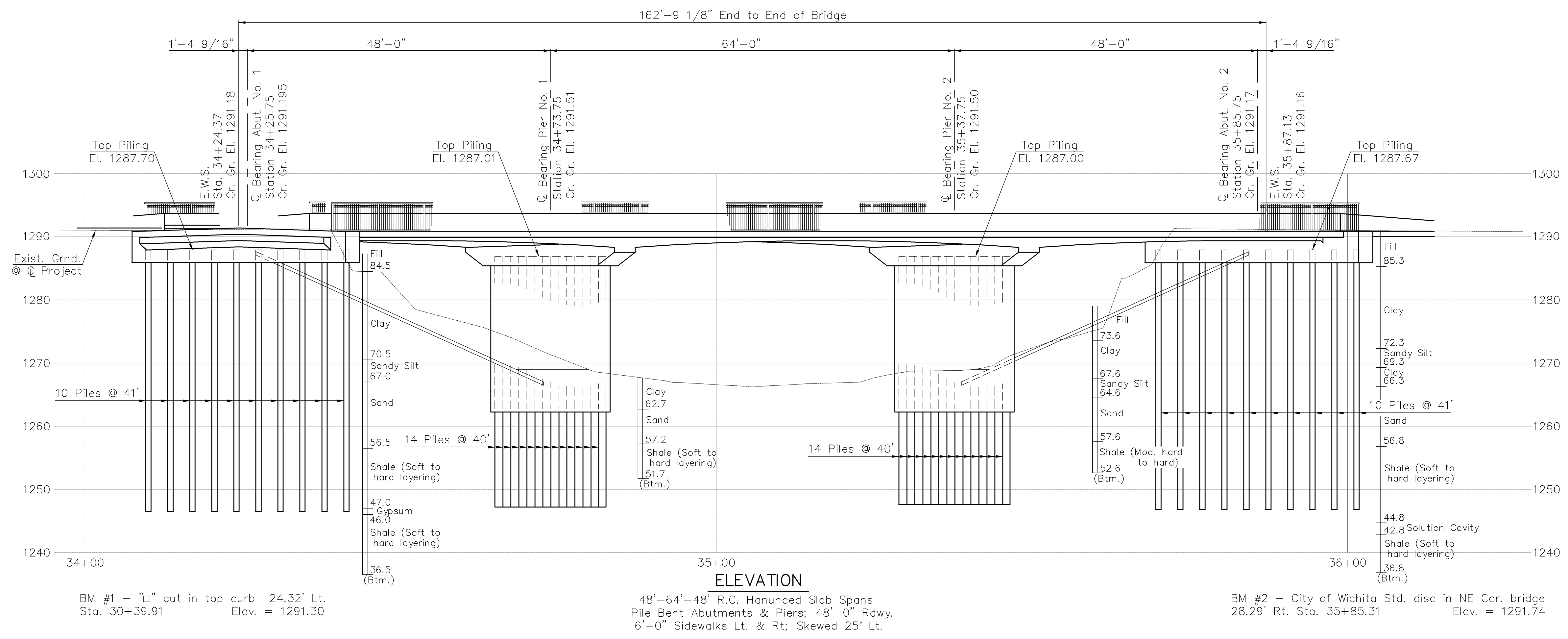

J:\2004PROJ\04559\DWGS\CL 1"=10'

PROJECT NO. 87 N-0359-01		CFS Cook, Flatt & Strobel ENGINEERS, P.A.
BRIDGE GEOLOGY		
HILLSIDE ST. BRIDGE OVER GYPSUM CREEK		DESIGNED RSC SCALE
STA. 35+05.75 CITY OF WICHITA		DETAILED DEG DATE
		QUANTITIES SHEET OF