

CURB & GUTTER REPAIR MAIN STREET

HARRY-BAYLEY WEST SIDE
BAYLEY-KELLOGG BOTH SIDES

LULU STREET KELLOGG-DOUGLAS

CITY OF WICHITA, KANSAS
R.W. LINN - CITY ENGINEER
PROJ. NO. WMKB536430

INDEX

1	Title Sheet
2-3	Typicals
4-13	Main St. Plans
14-18	Lulu St. Plans

GENERAL NOTES

1. COMBINED CURB AND GUTTER AND SEPARATE CURB & GUTTER REMOVED ON THIS PROJECT SHALL BE BID AS COMBINED CURB & GUTTER REMOVED.
2. THE ASPHALT WEARING SURFACE REMOVED SHALL BE BID AS SQUARE YARDS OF ASPHALT MAT REMOVED.
3. EXISTING CURB ALIGNMENT TO BE MAINTAINED.
4. FIELD ENGINEER SHALL DETERMINE ALL REMOVAL LIMITS. REMOVAL IS TO BE TO THE NEAREST JOINT WHERE POSSIBLE.
5. FIELD ENGINEER TO DETERMINE TYPE OF SUB-GRADE TREATMENT.
6. ALL DRAIN TILES IN USE SHALL BE REPLACED. THE REMOVAL OF DRAIN PIPES SHALL BE CONSIDERED A PART OF COMBINED CURB & GUTTER REMOVAL BID.
7. ALL DRIVE APPROACHES THAT HAVE A WIDTH LESS THAN (10') AT THE PROPERTY LINE SHALL BE CONSTRUCTED TO MEET MINIMUM CITY SPECIFICATION WIDTH. IN NO CASE SHALL A DRIVE APPROACH EXCEED THE MAXIMUM WIDTH OF (30'). CLOSE ALL DRIVES NOT IN USE.
8. REMOVE ONLY THAT PORTION OF EXISTING APPROACH WALK BETWEEN BACK OF CURB AND FACE OF WALK NECESSARY TO INSTALL NEW COMBINED CURB & GUTTER. NEW CONSTRUCTION OF APPROACH WALKS TO BE SAME WIDTH AS REMOVED AT FACE OF WALK. AT NO LOCATION SHALL APPROACH WALK BE BELOW NEW CURB AND GUTTER CONSTRUCTION.
9. CONTRACTOR SHALL BE RESPONSIBLE IN CONTACTING ALL UTILITY COMPANIES FOR RELOCATION OF EXISTING SERVICES.
10. REMOVAL LIMITS OF EXISTING DRIVES AND APPROACH WALKS BETWEEN FACE OF WALK AND BACK OF CURB TO BE DETERMINED IN THE FIELD.

11. PRICE OF MANIPULATION TO INCLUDE ANY COST OF HAULING.
12. ALL USABLE EXCAVATED MATERIAL TO REMAIN ON PROJECT.
13. DO NOT REPLACE ANY APPROACH WALK THAT IS NOT SERVING THE ORIGINAL PURPOSE.

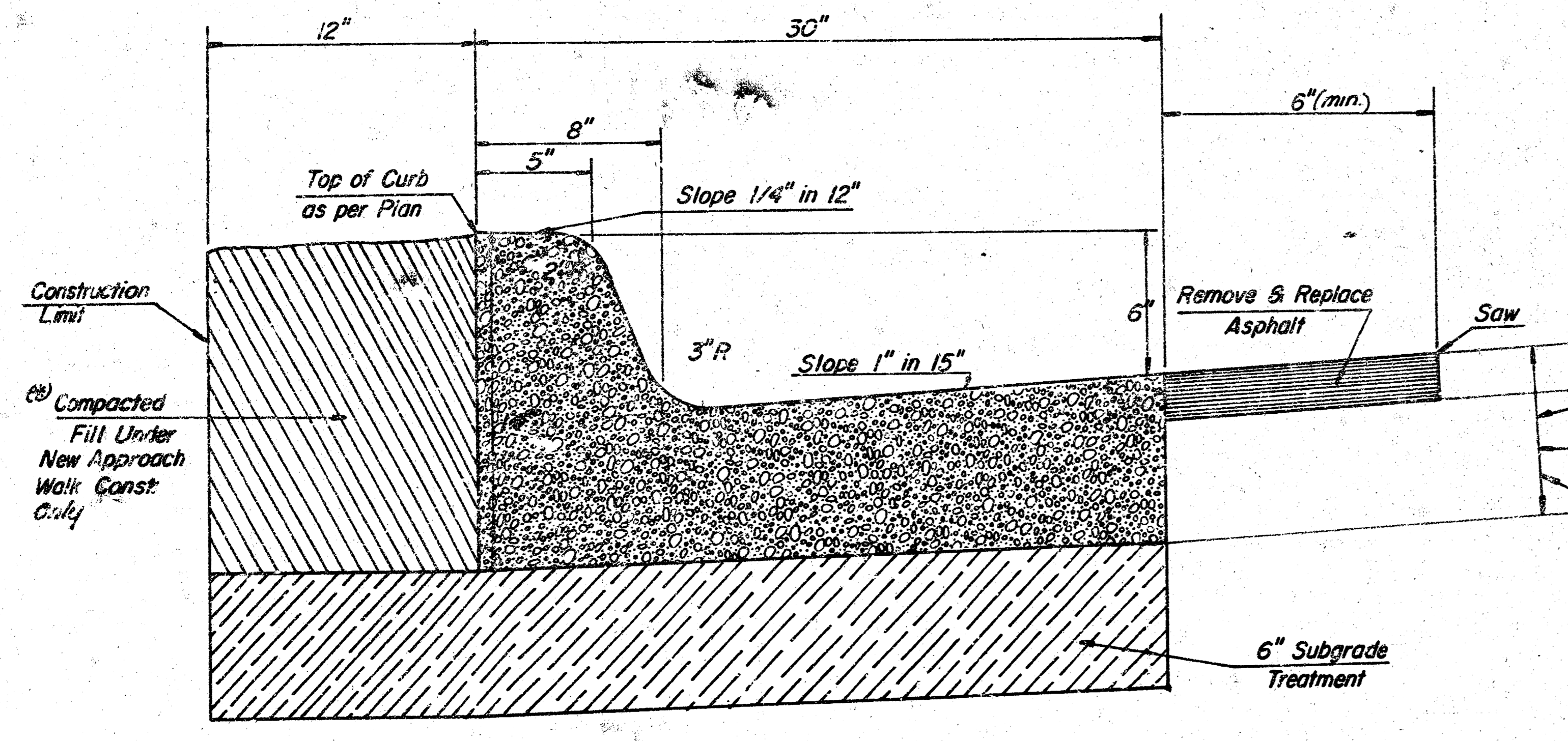

TYPICAL SECTION
EXISTING 30" CURB & GUTTER

EXISTING PAVEMENT
MAIN
Harry-Bayley
2" Asphalt Surf.
5" Conc. Base

Bayley-Kellogg
3" Asphalt Surf.
6" Conc. Base
LULU
Kellogg-Douglas
2" Asphalt Surf.
5" Conc. Base

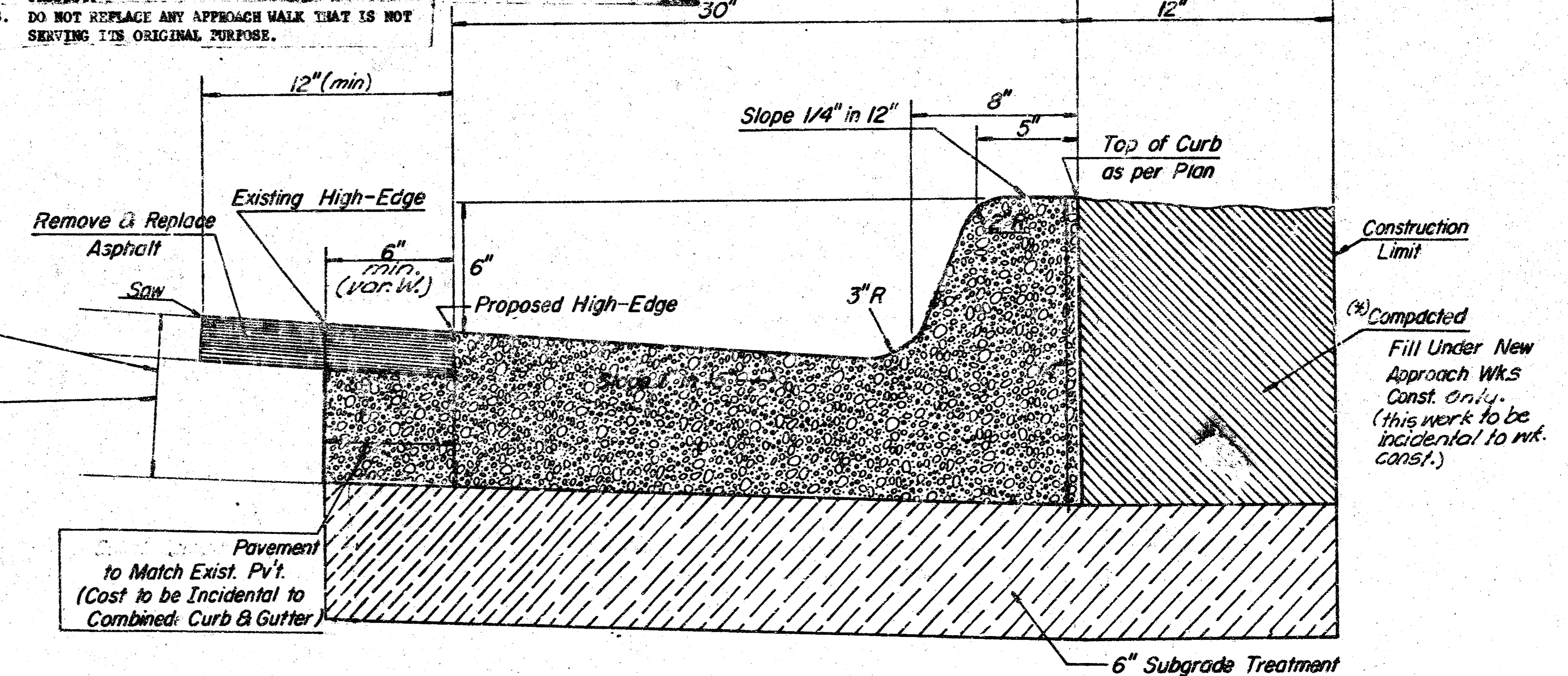

TYPICAL SECTION
EXISTING 36" CURB & GUTTER



B.M. 109.19 Top S.E. Corner Brick Planter at S.E. Corner of House at 102 W. Zimmerly
 B.M. 106.39 "L" Cut in N.E. Corner of 2nd Conc. Step from the Bottom at 1301 S. Main.

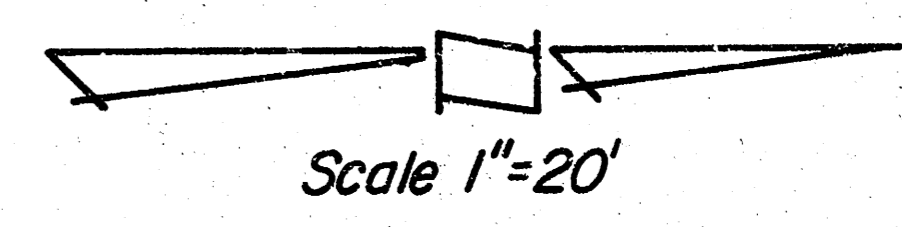

Scale 1"=20'

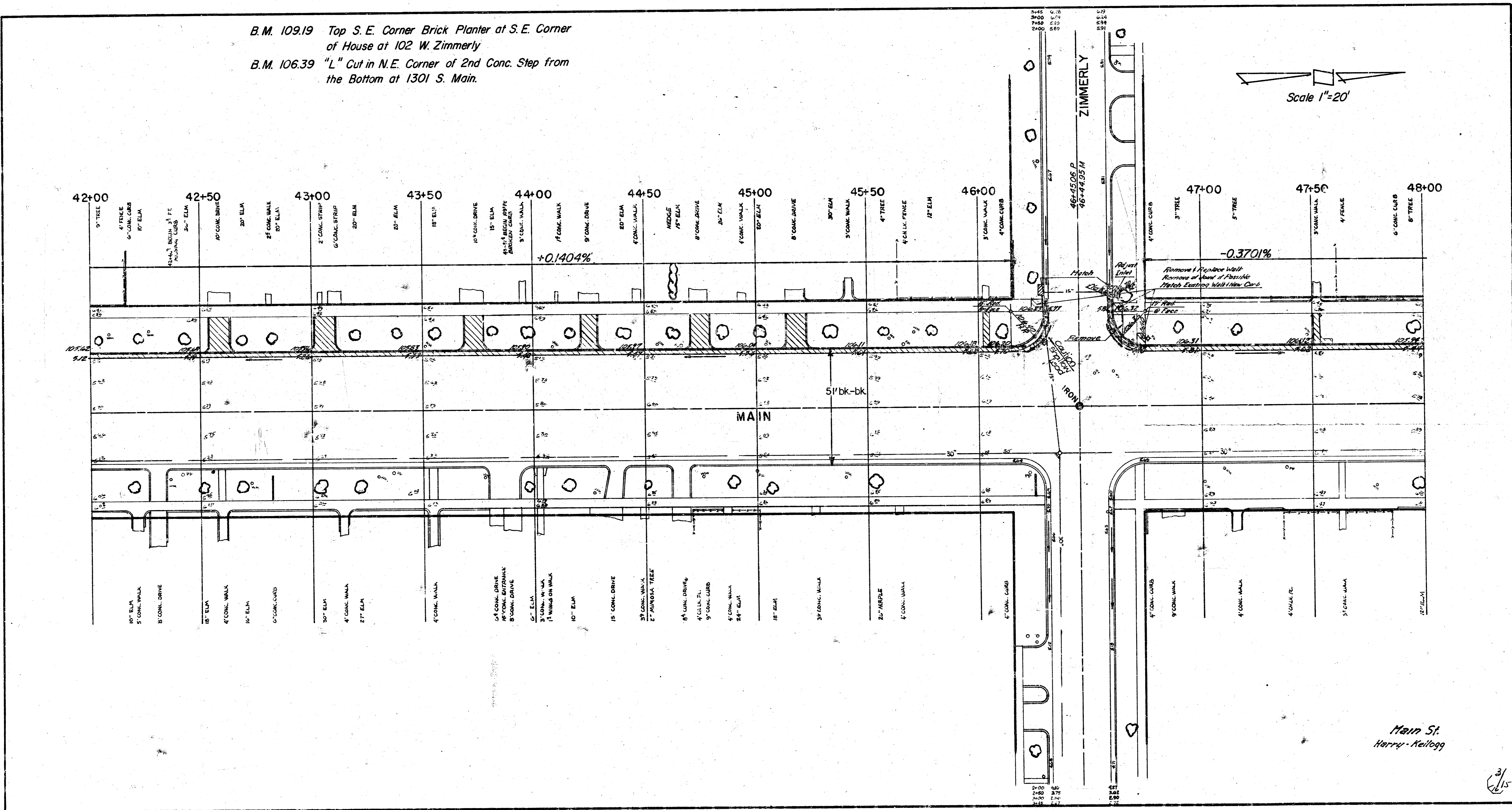

Main St.
 Harry Kellogg

3/15

B.M. 106.39 "L" Cut in N.E. Corner of 2nd Conc. Step from Bottom at 1301 S. Main

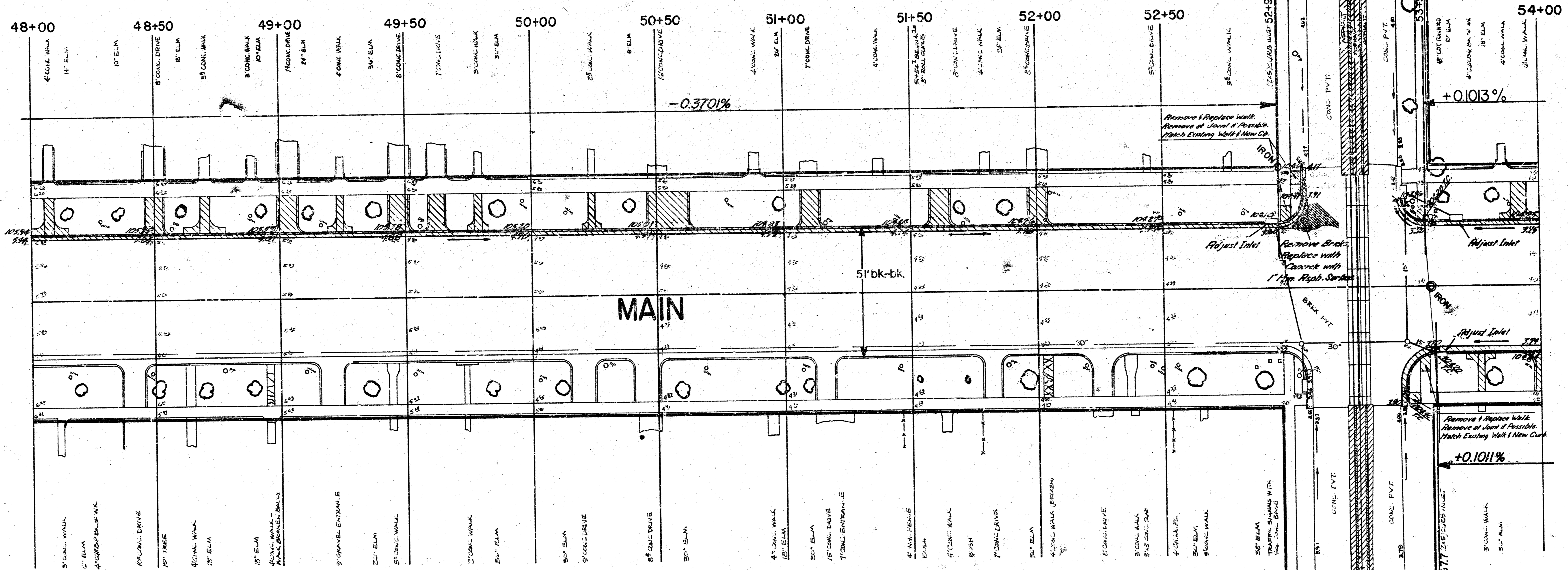
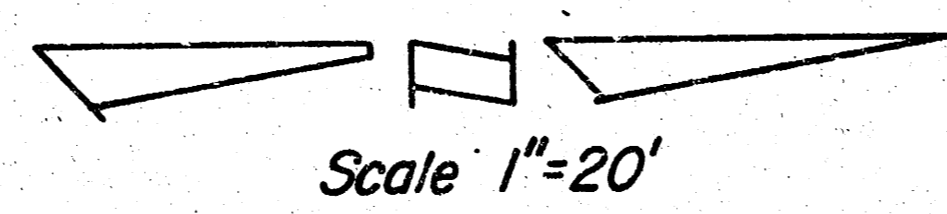

Main St.
Harry Kellogg

4/12

3+46	6.34
3+40	8.19
2+80	15
2+20	6.84
1+60	8.16

B.M. 106.57 "F" N.E. Corner Lower Step of Entrance Walk
to House at 1045 S. Main
B.M. 104.49 "4" Near S.E. Cor. of Conc. Base for Metal Pole at S.W.
Cor. Lincoln & Main

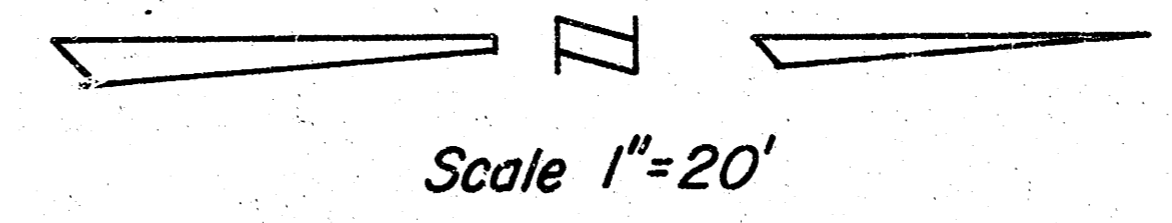

ALL BENCH MARK ELEVATIONS ON THIS AND FOLLOWING SHEETS
ARE TO BE USED NORTH OF LINCOLN ONLY AND ON THIS PROJECT ONLY.

LINCOLN

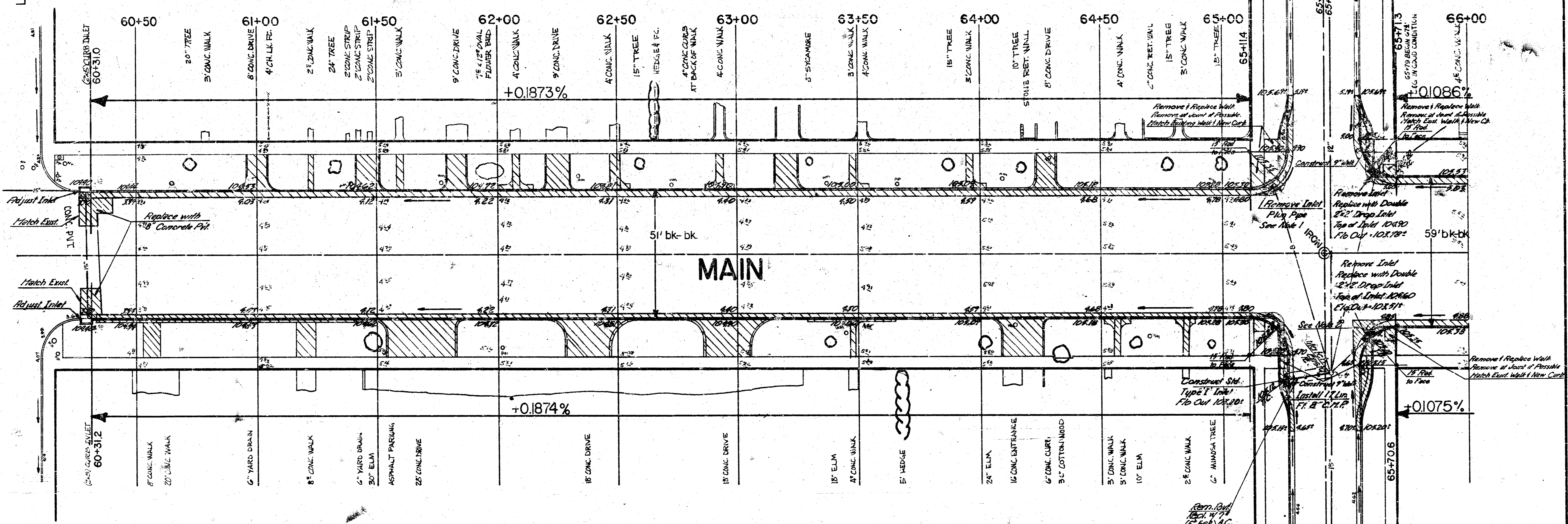

1+00	7.80
0+90	2.85
2+80	4.15
3+30	4.12
3+42	4.81

2+40	5.55
3+00	7.18
2+90	2.78
2+80	6.18

MORRIS

General Notes
1. Cost of Plugging Pipe at S.W. Corner of Morris
is to be included in Cost of Replacing Inlet.
2. Personnel Removal is to be Replaced with P.V.
Noting Existing Type, Cost to be Determined, to
Comply with Code & Ordinances.

Main
Harry Kellogg

6/15

B.M. 106.57 "Γ" N.E. Corner Lower Step of Entrance
Walk to House at 1045 S. Main
B.M. 107.83 S.E. Cor. Conc. Slab in Front of Steps to Porch
at 945 S. Main.

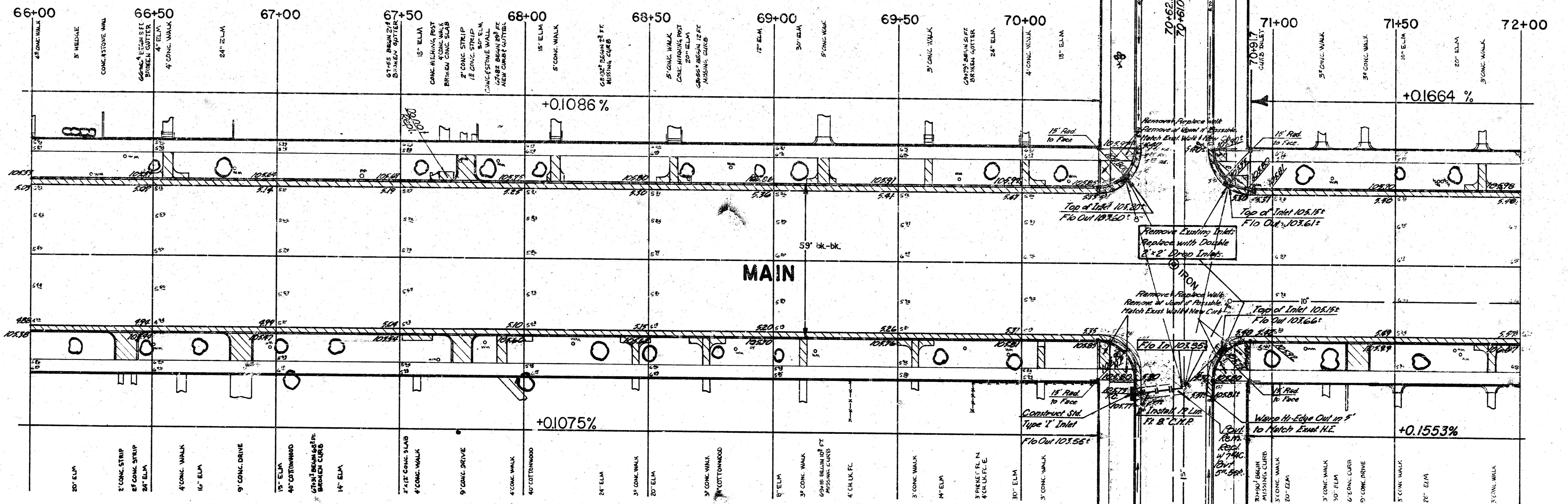
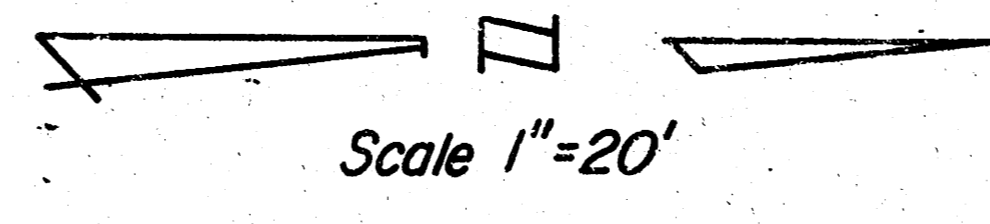

MAIN

70+62.77 P
70+61.04 M GILBERT

General Sheet Notes
1. Pavement to be Replaced to Match Existing Type
2. P.V. Cast to be Incidental to Compacted Sand
3. Gutters

17117
Harry Kellogg

7/15
(e)

B.M. 107.83 S.E. Cor. Conc. Slab in Front of Steps to Porch
 at 945 S. Main
 B.M. 107.87 N.W. Cor. Lower Step to Porch at Apartment
 House, N.E. Cor. Main & Indianapolis

3+50	0.05	9.10
3+00	1.99	8.05
2+50	1.83	7.87
2+00	1.85	7.69

SCALE 1"=20'

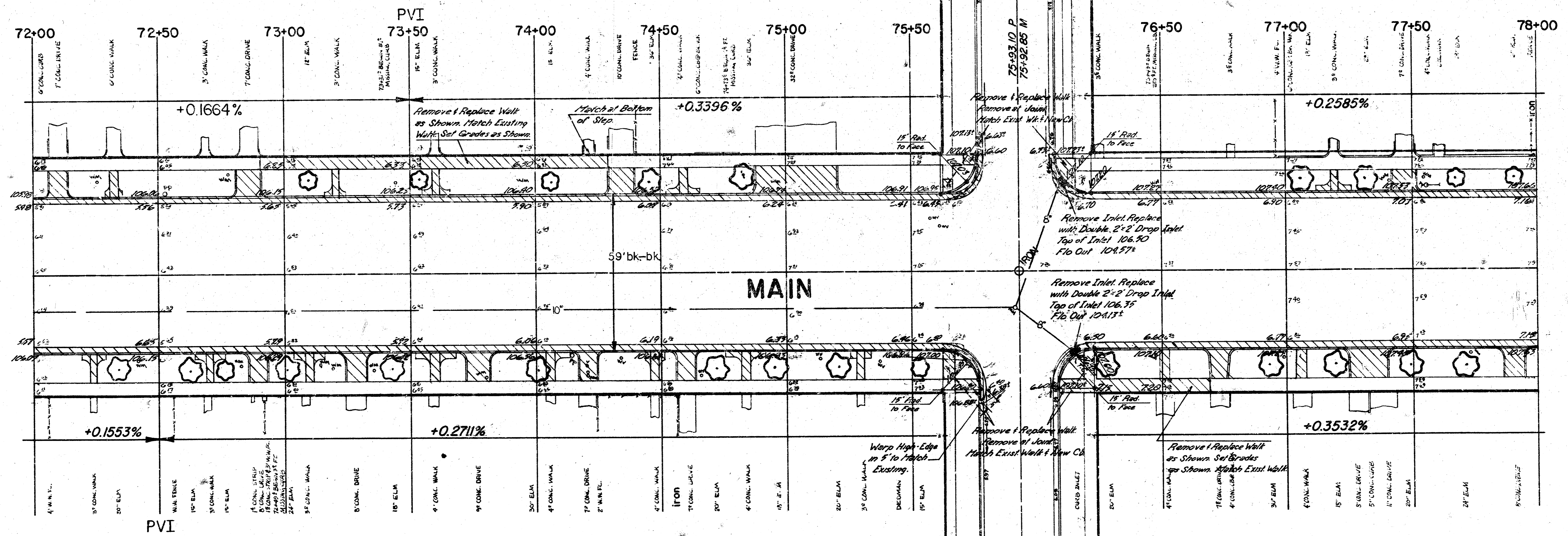

2+00	6.16	3.10
2+50	6.11	6.00
3+00	6.20	8.00
3+50	5.99	6.00

Main
 Harry Kellogg

B.M. 110.00 N.E. Cor. 2nd Step from Bottom to House at 815 S. Main

345	929
340	894
250	817
500	87

SCALE 1"=20'

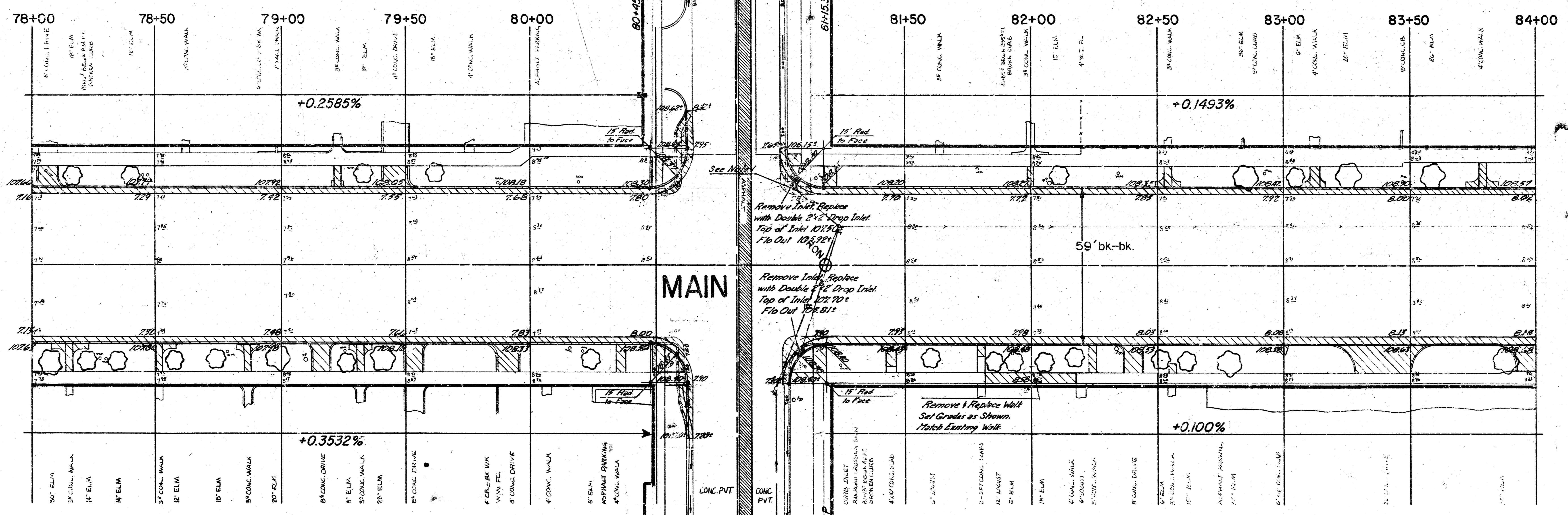

MAIN

ORME

200	725
150	639
700	645
345	635

General Sheet Notes
 1. Install 4 Lin. Ft. 8" C.H.P. Construct 4" Reinf. Concrete Collar Collar to Extend 2' Either side of Joint. Cos. of Collar to be Incidental to Project.

Harry
 Harry-Kellogg

SCALE 1"=20'

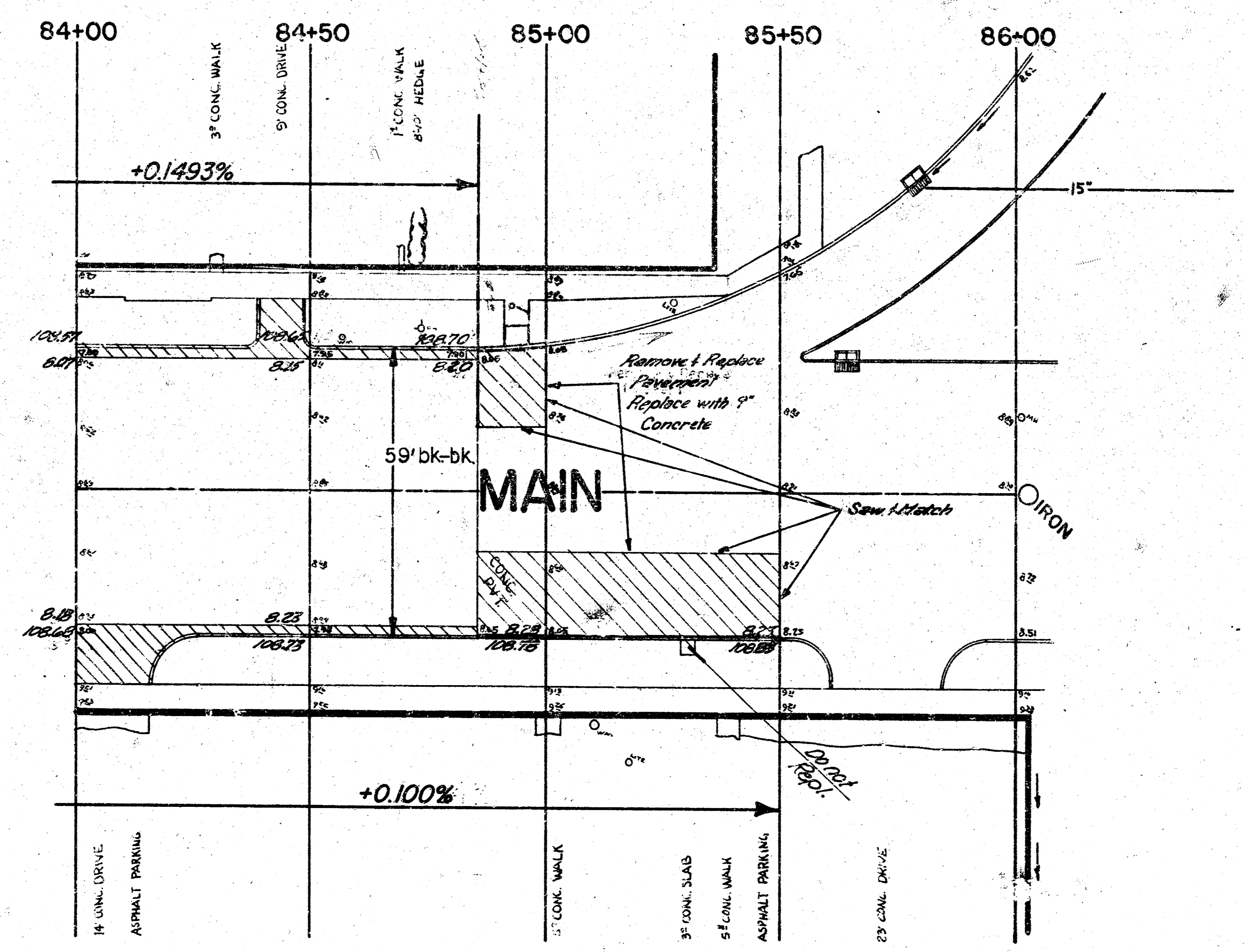

MAIN
Harry-Hellogg

10/15



B.M. 106.70 N.W. Corner Lower Step to House at 400 S. Lulu

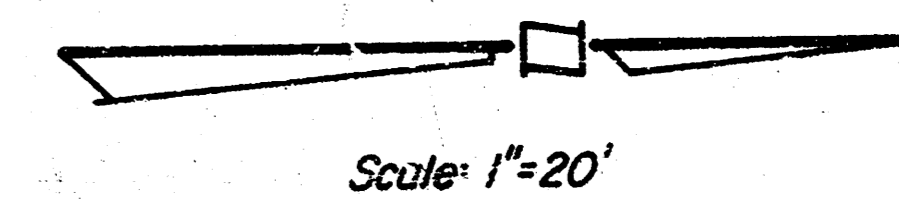

P.I.
Elev. 105.80
No V.C.

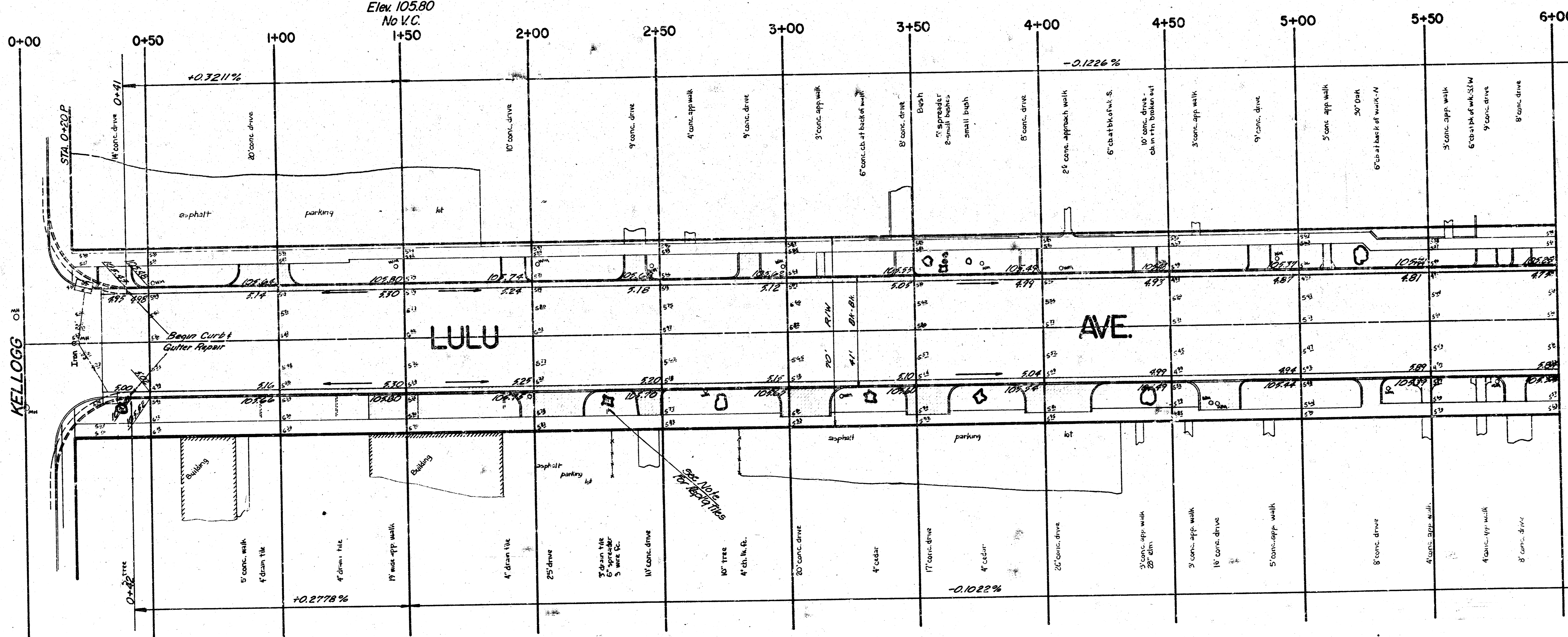

P.I.
Elev. 105.80
No V.C.

Lulu Street
Kellogg-Douglas

Survey
PLAN
S.K.
DATE

B.M. 106.70 N.W. Corner Lower Conc. Step to House at 400 S. Lulu
 B.M. 105.80 N.E. Corner Lower Conc. Step to House at 303 S. Lulu

SCALE 1"=20'

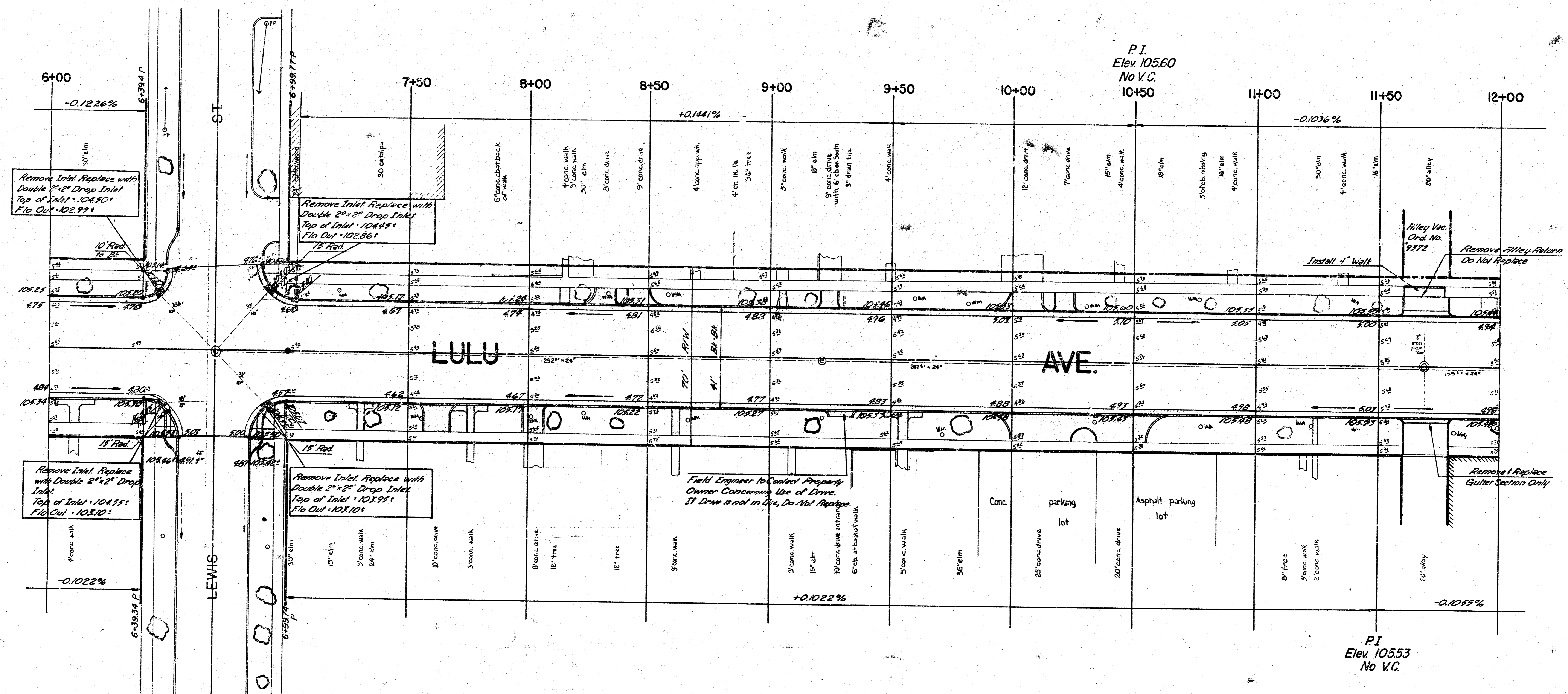

P.I.
 Elev. 105.60
 No V.C.

Lulu
 Kellogg - Douglas

B.M. 105.80 N.E. Corner Lower Conc. Step to House at 303 S. Lulu
 B.M. 107.55 N.E. Corner Conc. Step (1st Step) to Stairs at Calvary
 Methodist Church at 201 S. Lulu

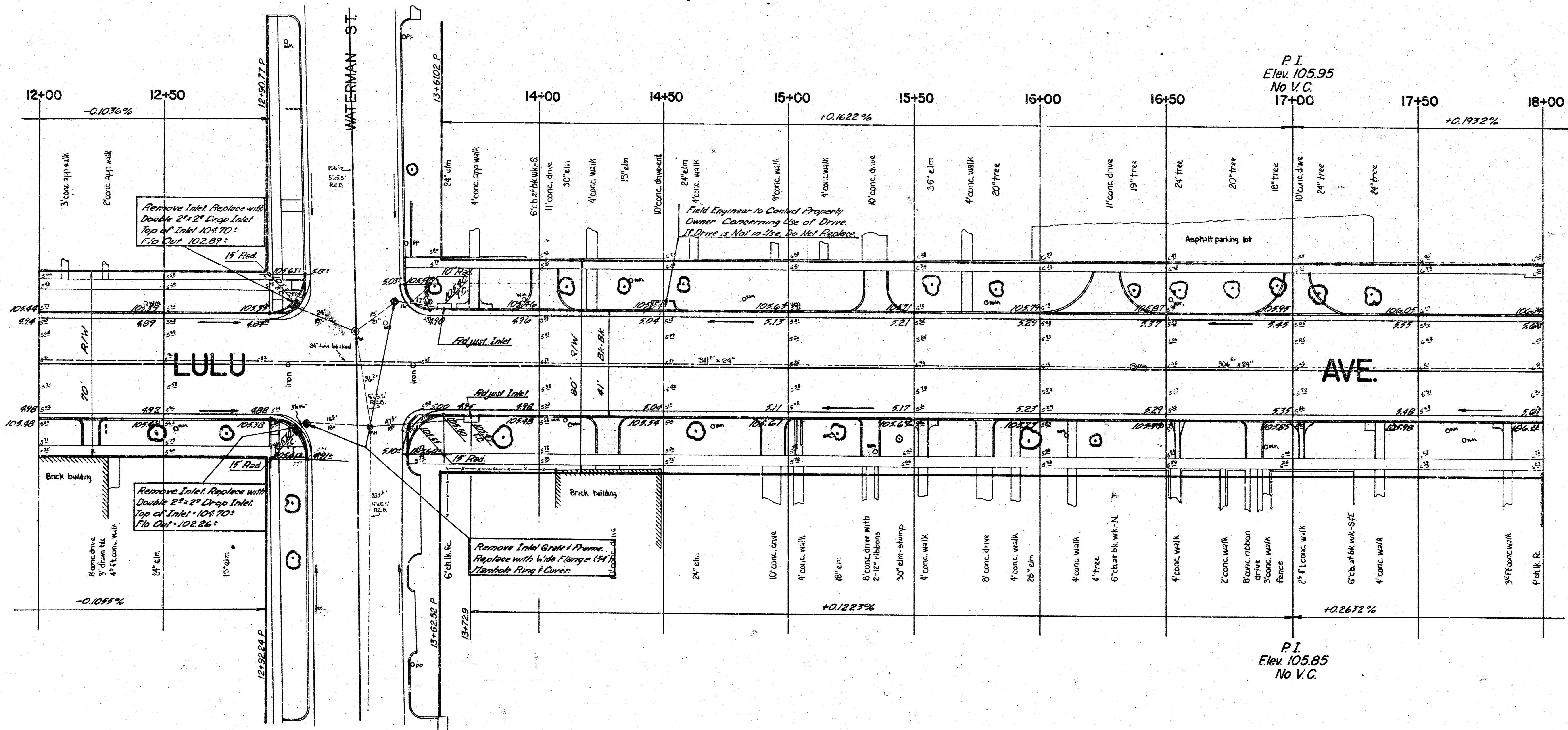
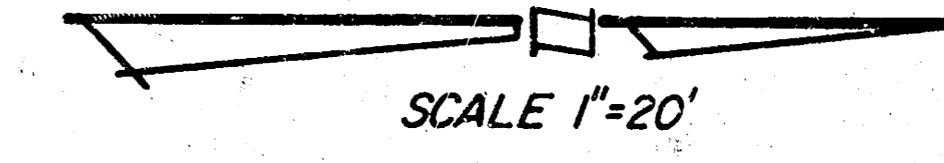

Lulu
 Kellogg-Douglas

B.M. 111.44 'M' in Mueller, Fire Hydrant at N.W. Cor. Douglas & Hydraulic

SCALE 1"=20'

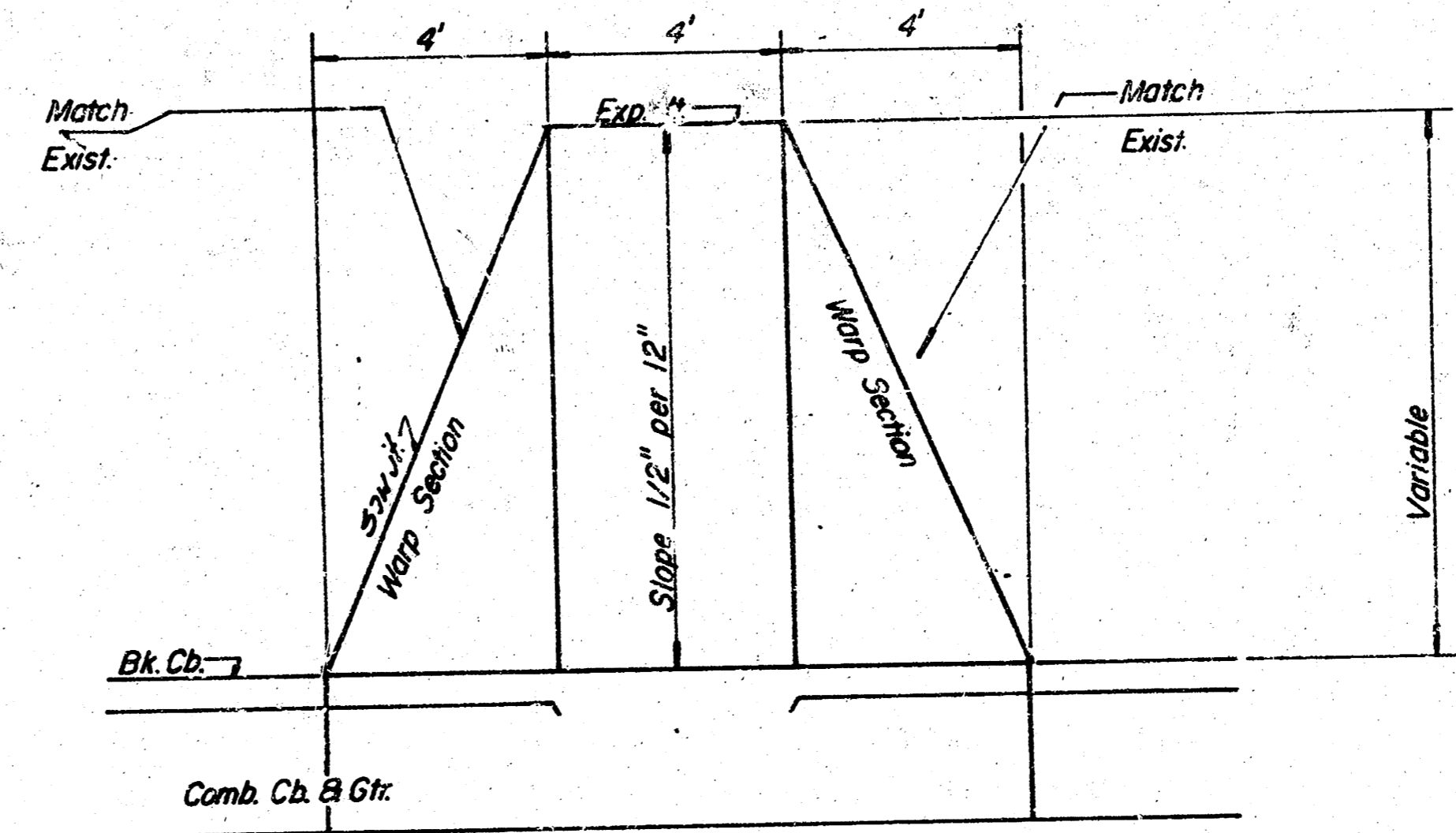
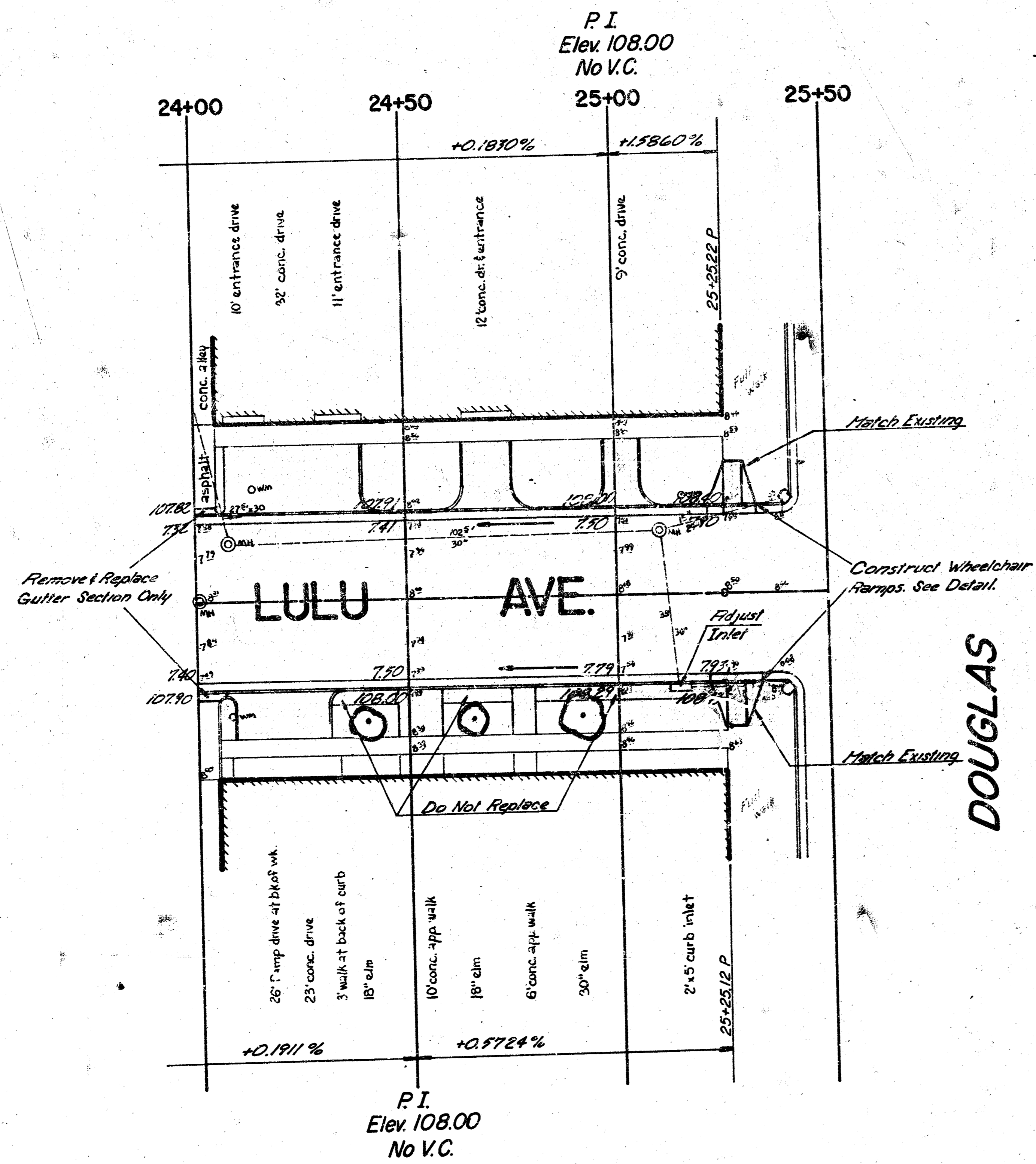

WHEELCHAIR RAMP DETAIL
(Ramps Shall be considered a part of Sidewalk Construction)

Lulu Kellogg-Douglas