

# MAPLE STREET

FROM W.L. TRACY STREET TO W.L. WEST STREET

B.E. SMITH CITY ENGINEER

CITY OF WICHITA, KANSAS

PROJECT NO. C17-5

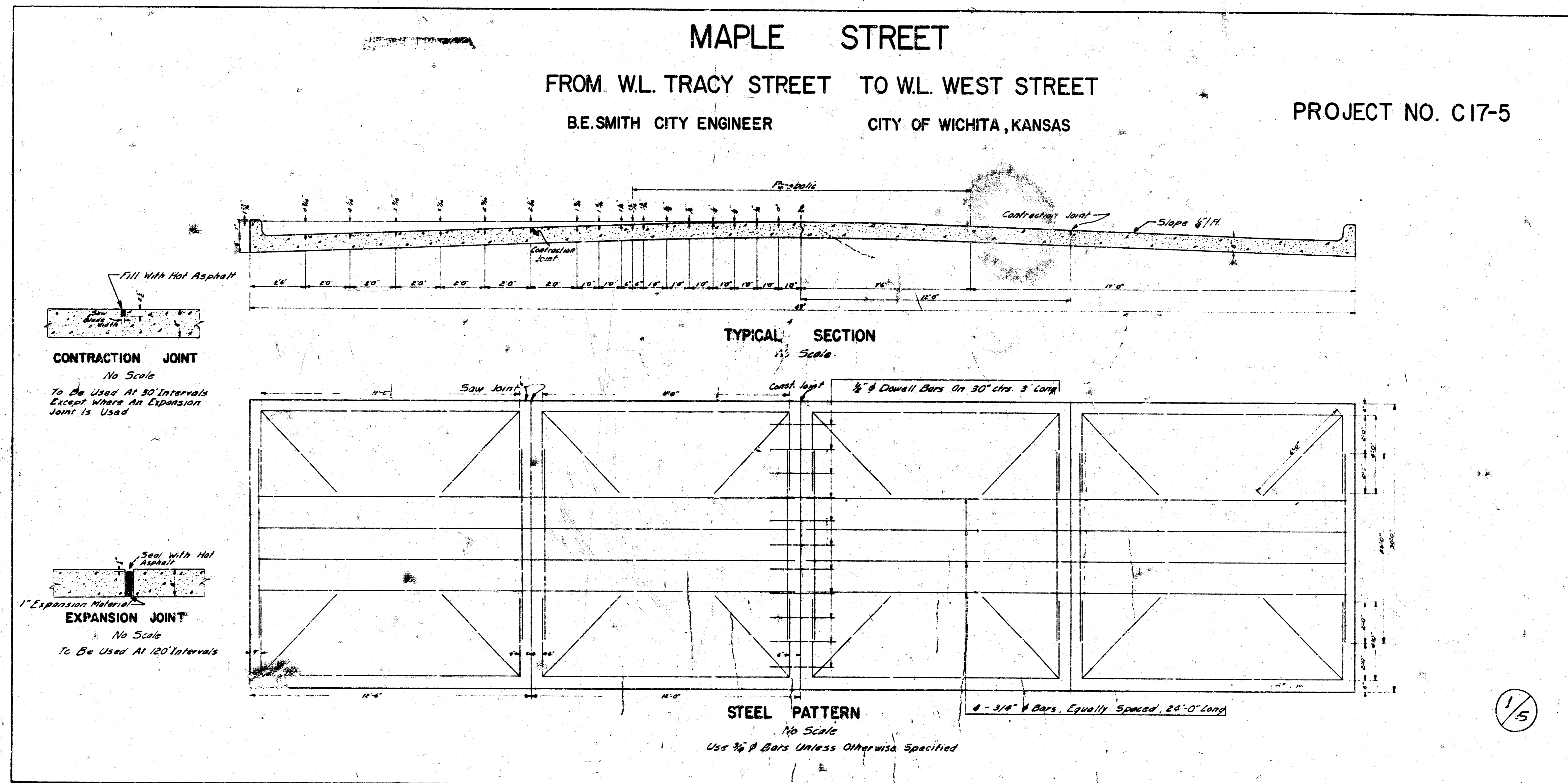

B.M. 11330 R.R. Spike in East Face  
Power Pole N.W. Maple & Tracy

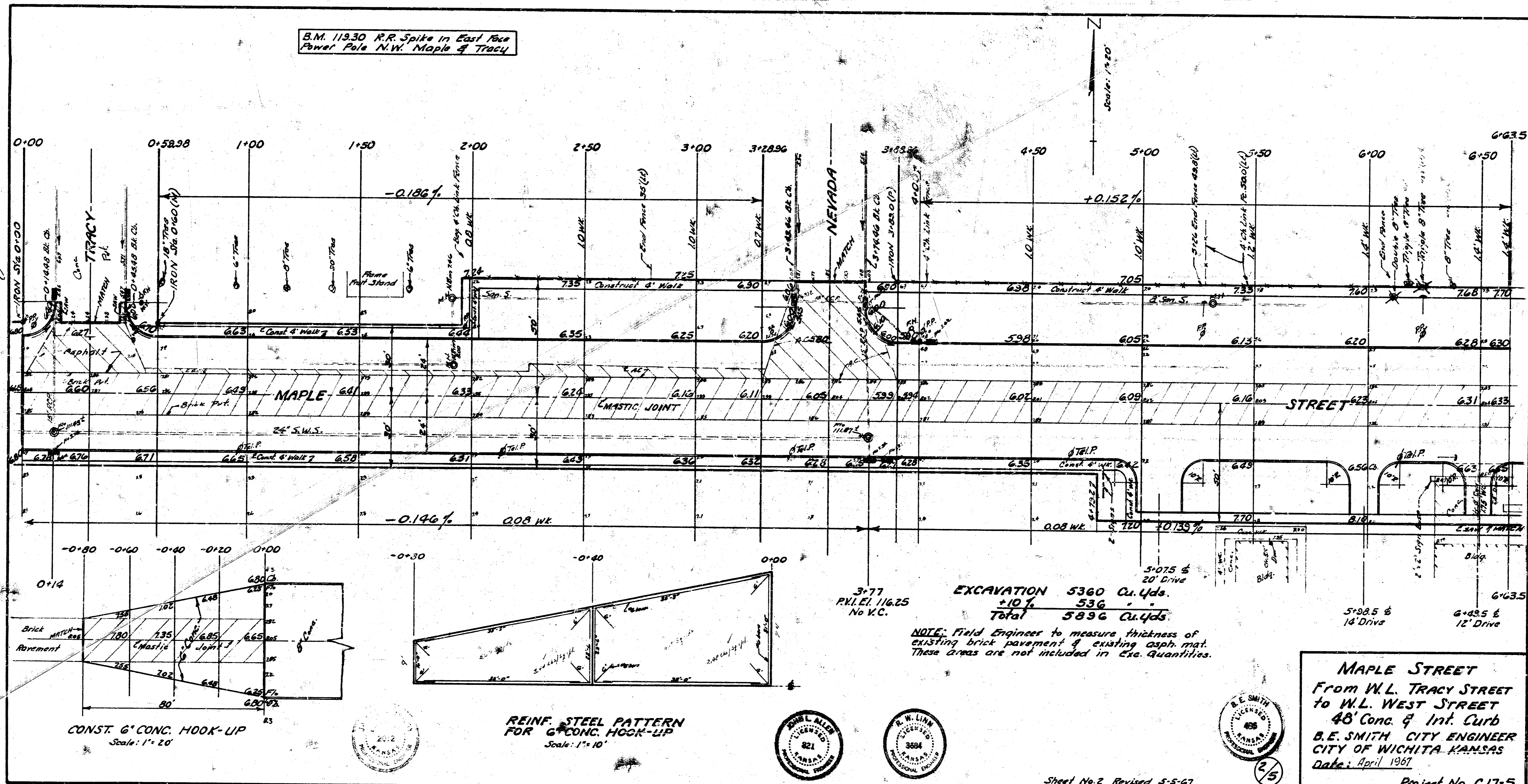

BUILDING LINES  
FROM 1/2" 0100  
FROM 1/2" 0100  
FROM 1/2" 0100

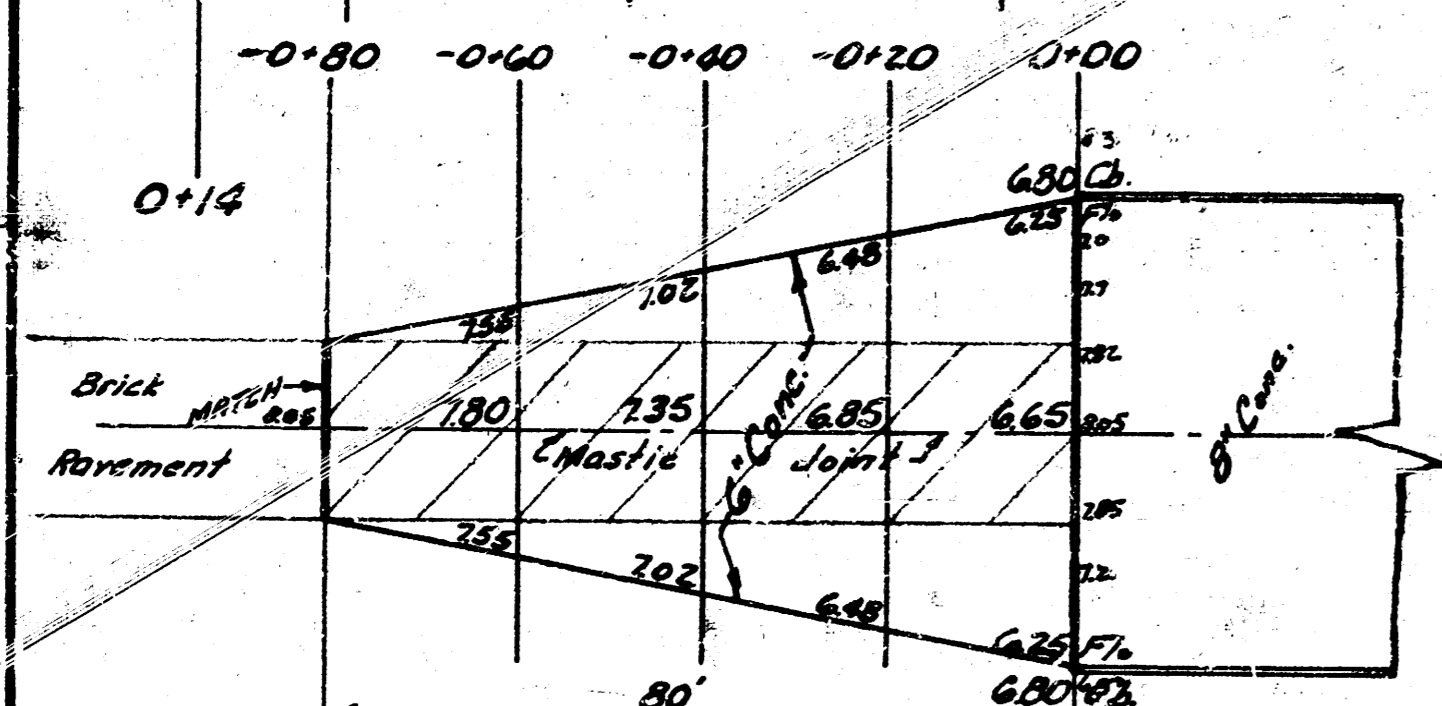

CONST. 6" CONC. HOOK-UP  
Scale: 1" = 2'

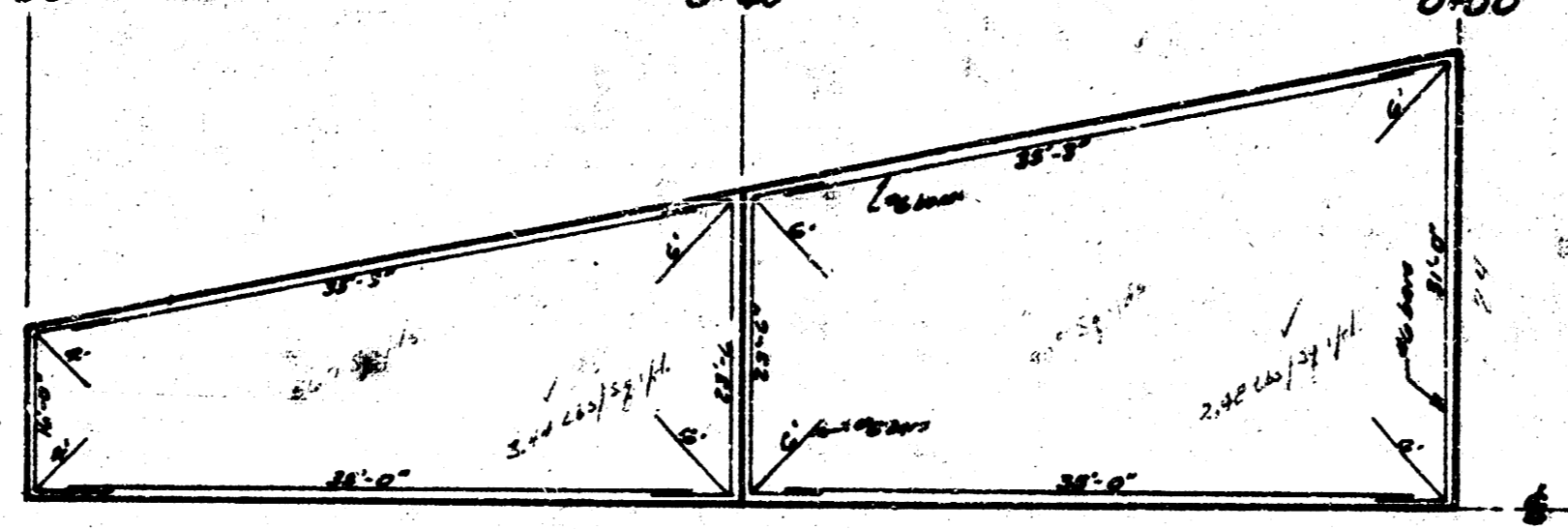

REINF. STEEL PATTERN  
FOR 6" CONC. HOOK-UP  
Scale: 1" = 10'

3+77  
R.H.E. 11625  
No V.C.

EXCAVATION 5360 Cu.Yds.  
+10' 536  
Total 5896 Cu.Yds.

NOTE: Field Engineer to measure thickness of  
EXISTING brick pavement & existing asph. mat.  
These areas are not included in Exc. Quantities.

**MAPLE STREET**  
From W.L. TRACY STREET  
to W.L. WEST STREET  
48" Conc. & Int. Curb  
B.E. SMITH CITY ENGINEER  
CITY OF WICHITA, KANSAS  
Date: April 1967  
Project No. C17-5



Sheet No. 2 Revised 5-5-67

10 IN. ENG  
-m-10

