

MAPLE
E.L. I-235-E.L. McCOMAS
472-76-245-80643-000-000-001

GENERAL NOTES

1. PAVING CONTRACTOR TO COORDINATE CONSTRUCTION WITH DRAINAGE CONTRACTOR.
2. CONTRACTOR TO CONTACT PROPERTY OWNERS FOR DRIVE LOCATIONS. ANY DRIVES NOT IN USE ARE NOT TO BE REPLACED. NO DRIVE APPROACHES TO BE CONSTRUCTED AT STAR LAMBER COMPANY WITHOUT PUBLIC WORKS ENGINEERING OFFICE APPROVAL. *All Commercial & Parking Lot Driveways to have 8' min. width.*
3. THE PROJECT BASE LINE STATIONING IS = TO SECTION LINE - STATION 0 + 00 = EAST END OF BRIDGE ACROSS FLOOD CONTROL DITCH.
4. ALL DRAINAGE SHOWN ON DETAILED CONSTRUCTION SHEETS IS S.I.C. PAVEMENT CONTRACTOR TO CONSTRUCT INLET HOOD-UPS.
5. WHEELCHAIR RAMP LOCATIONS AS SHOWN ARE PREFERENCE ONLY. LOCATION MAY BE CHANGED BY FIELD ENGINEER.
6. TIES ARE TO BE TAKEN TO ALL "IRONS" ON PROJECT AND SHALL BE REPLACED DURING CONSTRUCTION IF DISTURBED. BOTH FIELD ENGINEER AND PAVING CONTRACTOR TO BE RESPONSIBLE FOR THIS WORK BEFORE FINAL PAYMENT.
7. LIMITS OF REMOVAL AT LONG JOHN SILVERS PARKING LOT SHALL BE DETERMINED IN FIELD. FIELD ENGINEER TO CONTACT PROPERTY OWNER BEFORE DOING ANY WORK BEHIND PROPERTY LINE.
8. BETWEEN STATION 47 + 78.6 AND END OF PROJECT, ASPHALT IS TO BE STRIPPED FROM EXISTING CONCRETE BASE. THE CONCRETE BASE IS TO BE REMOVED AS SHOWN ON PLANS, THE JOINTS IN THE NEW ASPHALT SURFACE TO BE OFFSET FROM JOINTS IN THE EXISTING CONCRETE BASE.
9. SUB-GRADE MANIPULATION SHALL BE PLACED UNDER NEW PAVEMENT AND ALSO WHERE EXISTING PAVEMENT HAS BEEN REMOVED.
10. CONTRACTOR TO CONTACT UTILITY COMPANIES FOR EXACT LOCATION OF UNDERGROUND UTILITIES. LOCATIONS SHOWN ARE APPROXIMATE ONLY.
11. COST OF REMOVING TEMPORARY 3" ASPHALT SURFACE PLACED BY DRAINAGE ENGINEER SHALL BE CONSIDERED AS PAVEMENT REMOVAL.

CITY OF WICHITA, KANSAS
R.W. LINN - CITY ENGINEER
DATE _____

INDEX

- 1 TITLE SHEET
- 2-4 TYPICALS
- 5-14 PLAN SHEETS
- 14-22 CROSS-SECTIONS

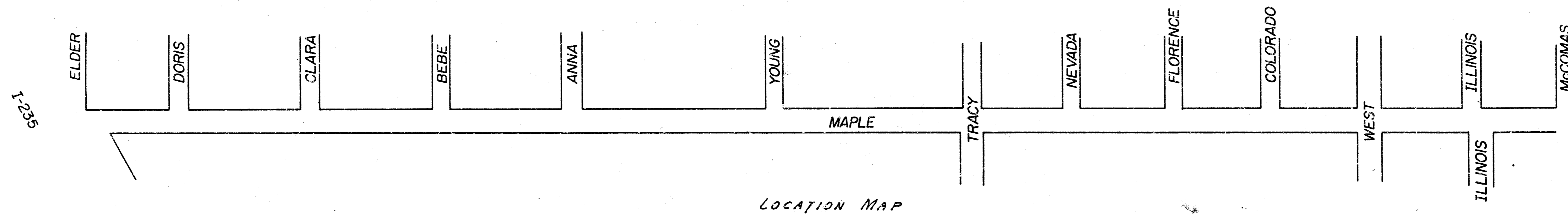

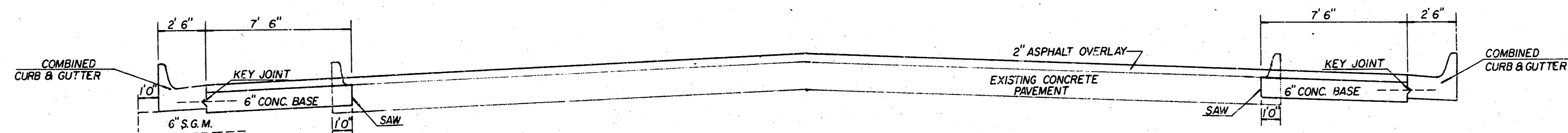

TYPICAL SECTION
STA. 22+25-44+27.3

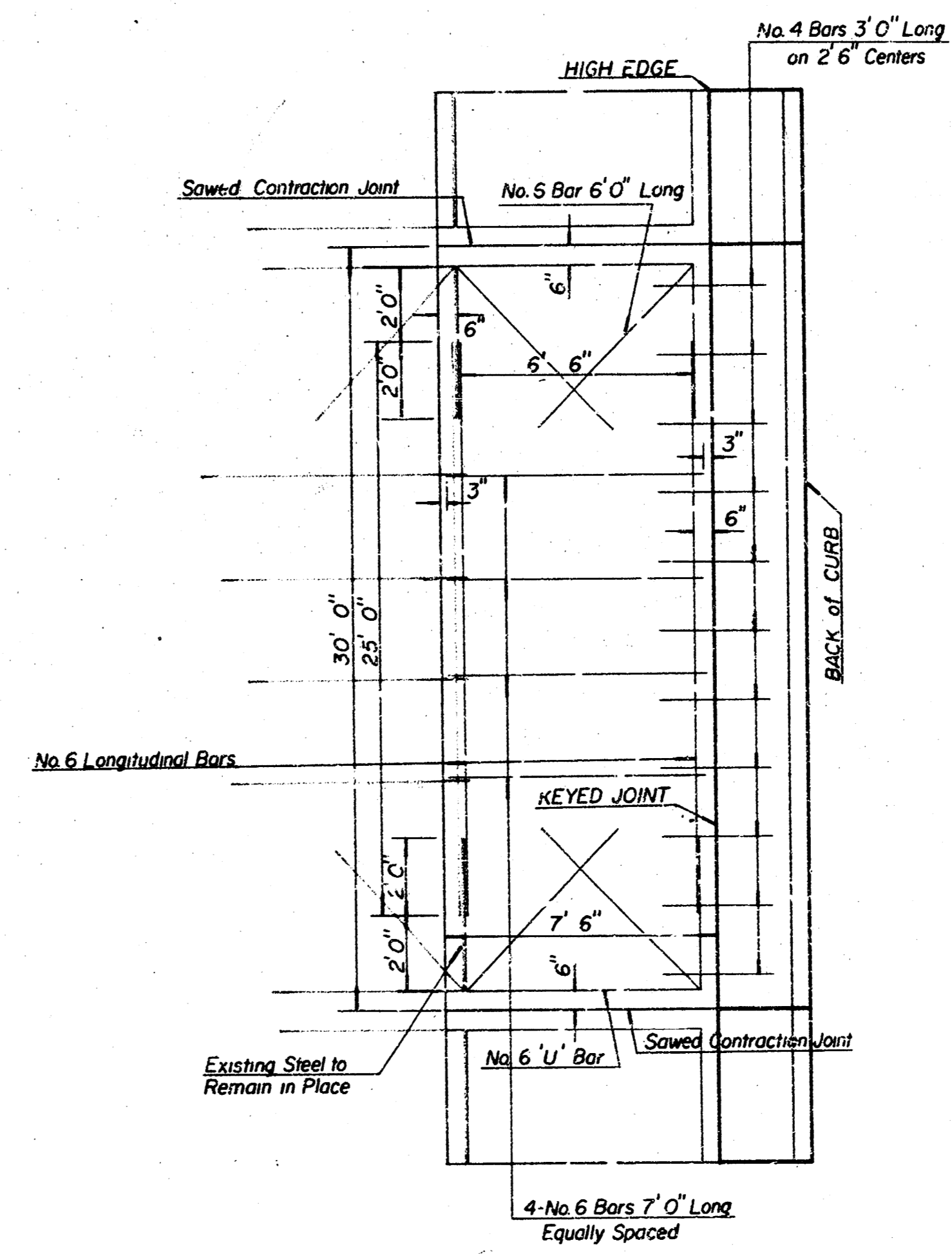
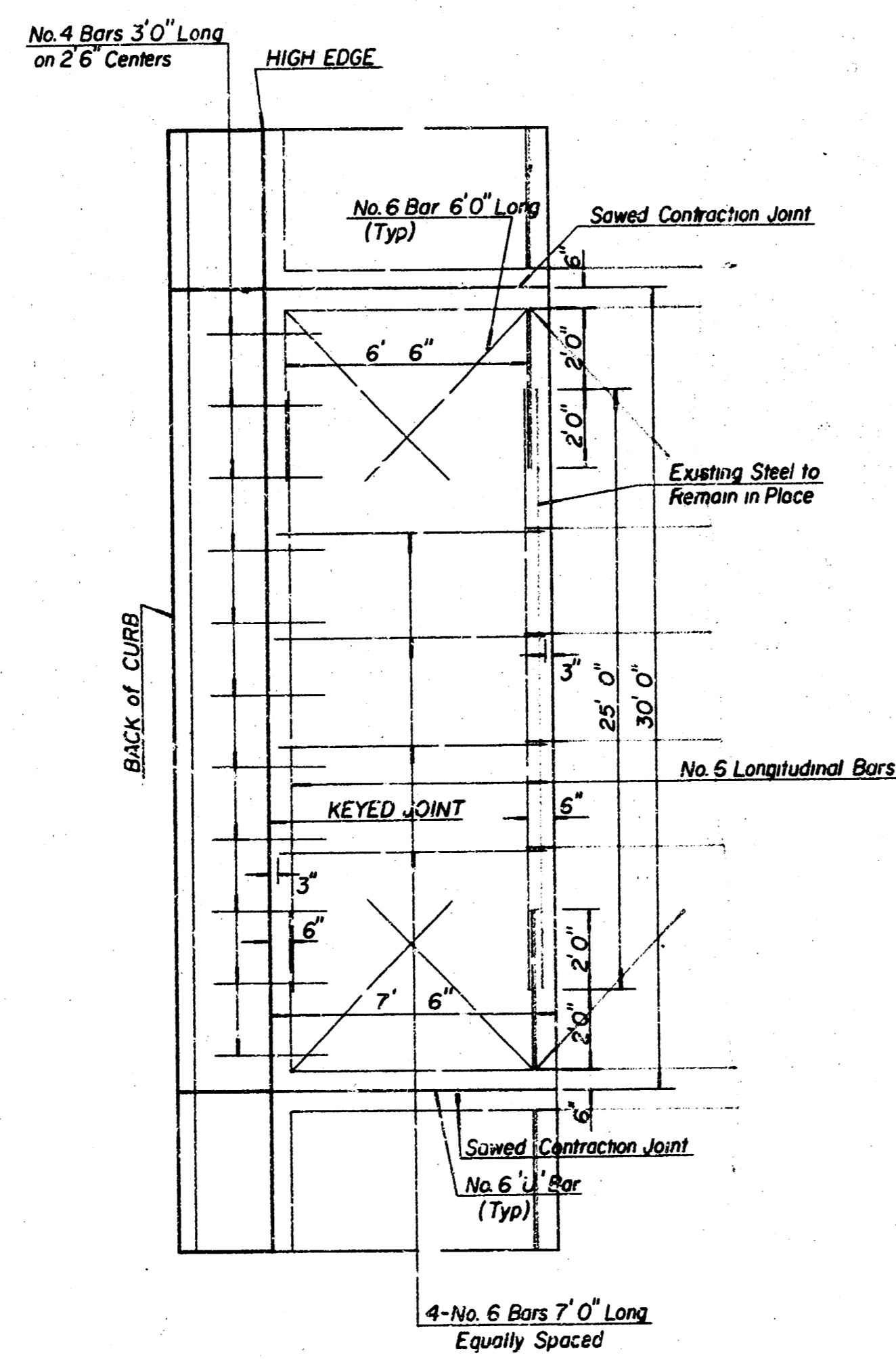

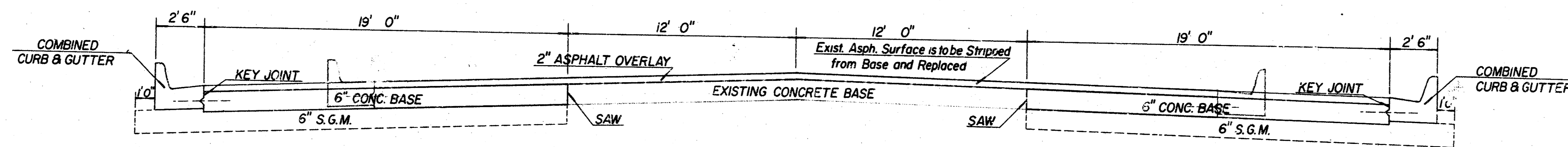

**TYPICAL SECTION
STA. 47+78.6-53+36**

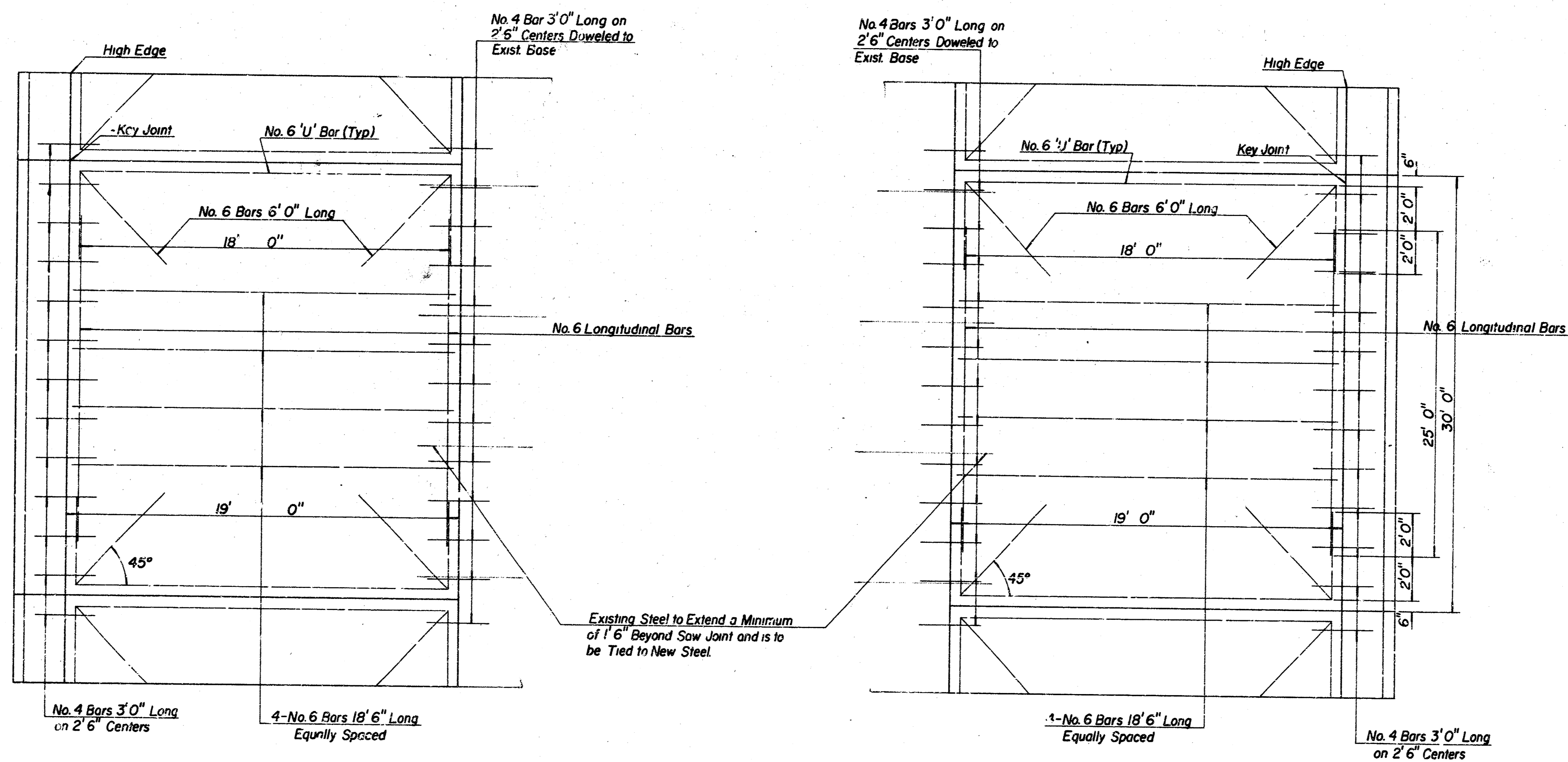

Survey Data
Plan
Checked

B.M. 13016 City Std. North Hubguard on Bridge over Big Ditch at East End.
B.M. 12115 '□' on Conc. Base of Lite Pole, N.S. Maple 100' West of W.L.
West St. in Long John Silver's Parking Lot

N
Scale:
1" = 20'

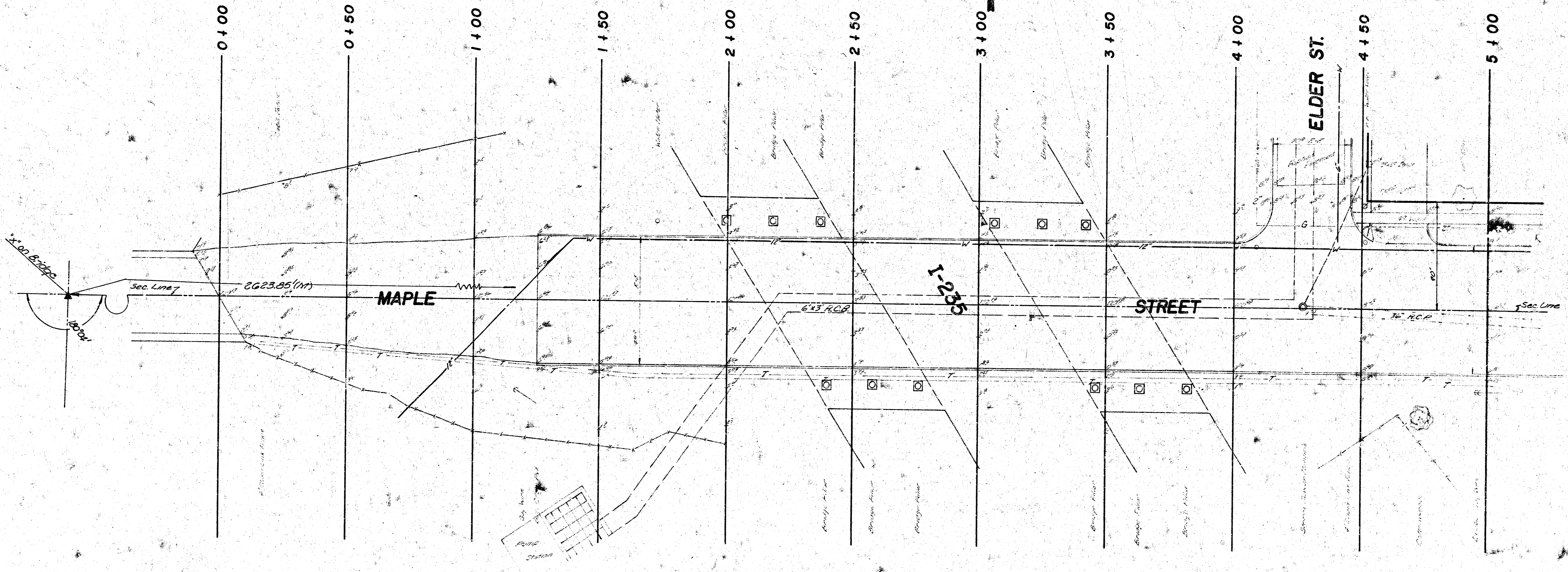

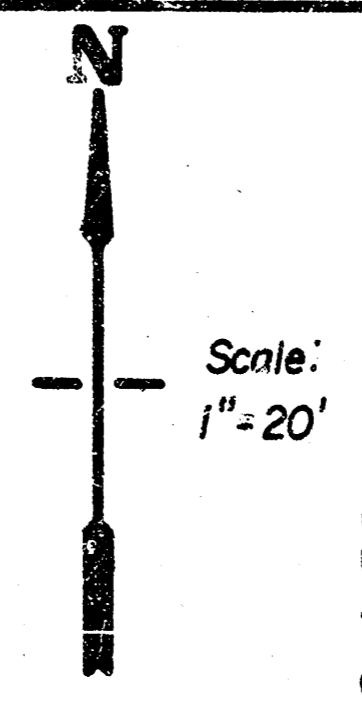
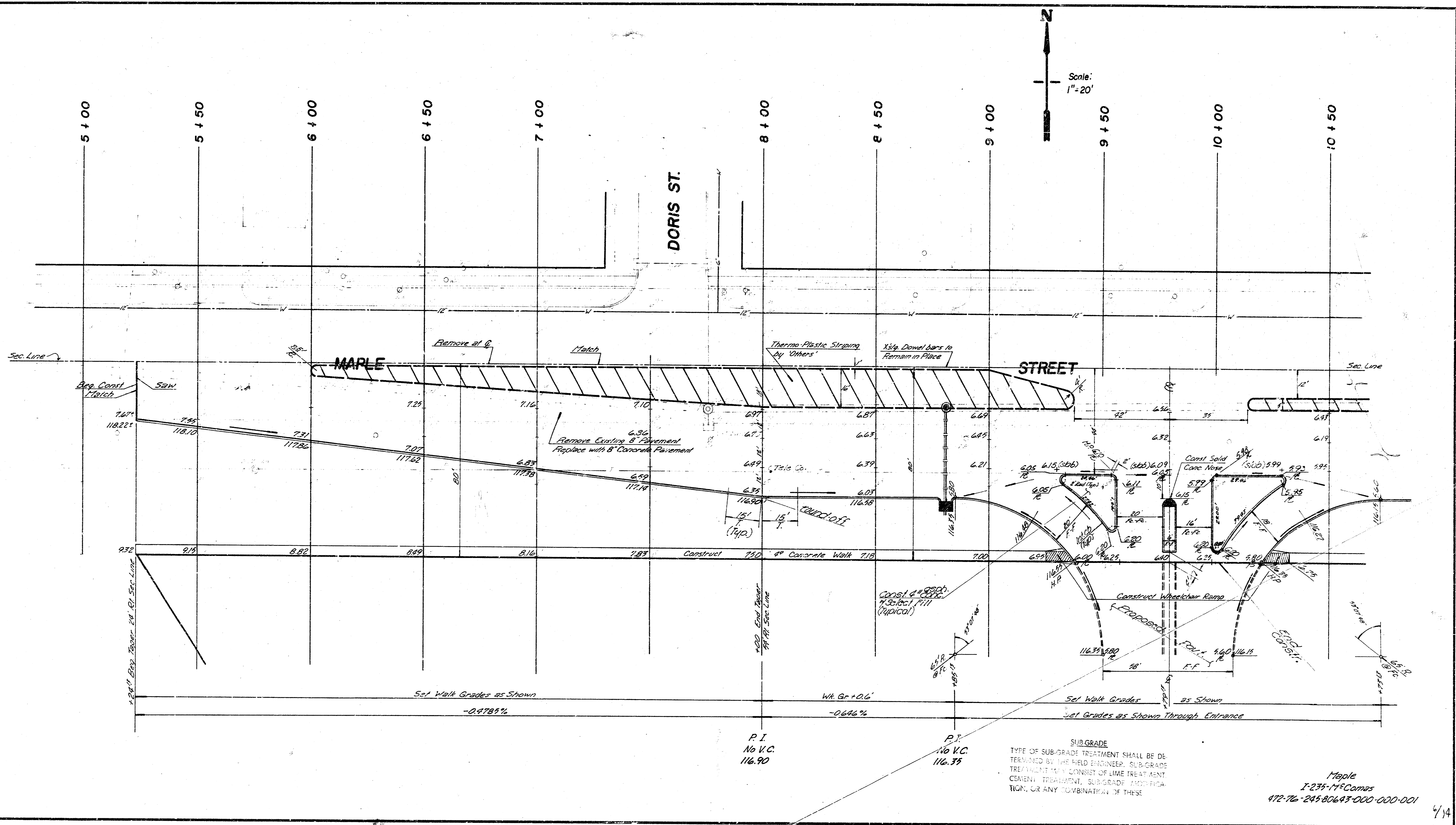

SUBGRADE
 TYPE OF SUBGRADE TREATMENT SHALL BE DETERMINED BY THE FIELD ENGINEER. SUBGRADE TREATMENT MAY CONSIST OF LIME TREATMENT, CEMENT TREATMENT, SUBGRADE MODIFICATION, OR ANY COMBINATION OF THESE.

Maple
 I-235-114-Corpus
 472-76-245-80693-000-000-001
 4/14

B.M. 130.16 City Std. North Hubguard of Bridge over Big Ditch at East End.
 B.M. 121.15 '□' on Conc. Base of Lite Pole, N.S. Maple 100' West of W.L.
 West St. in Long John Silver's Parking Lot.

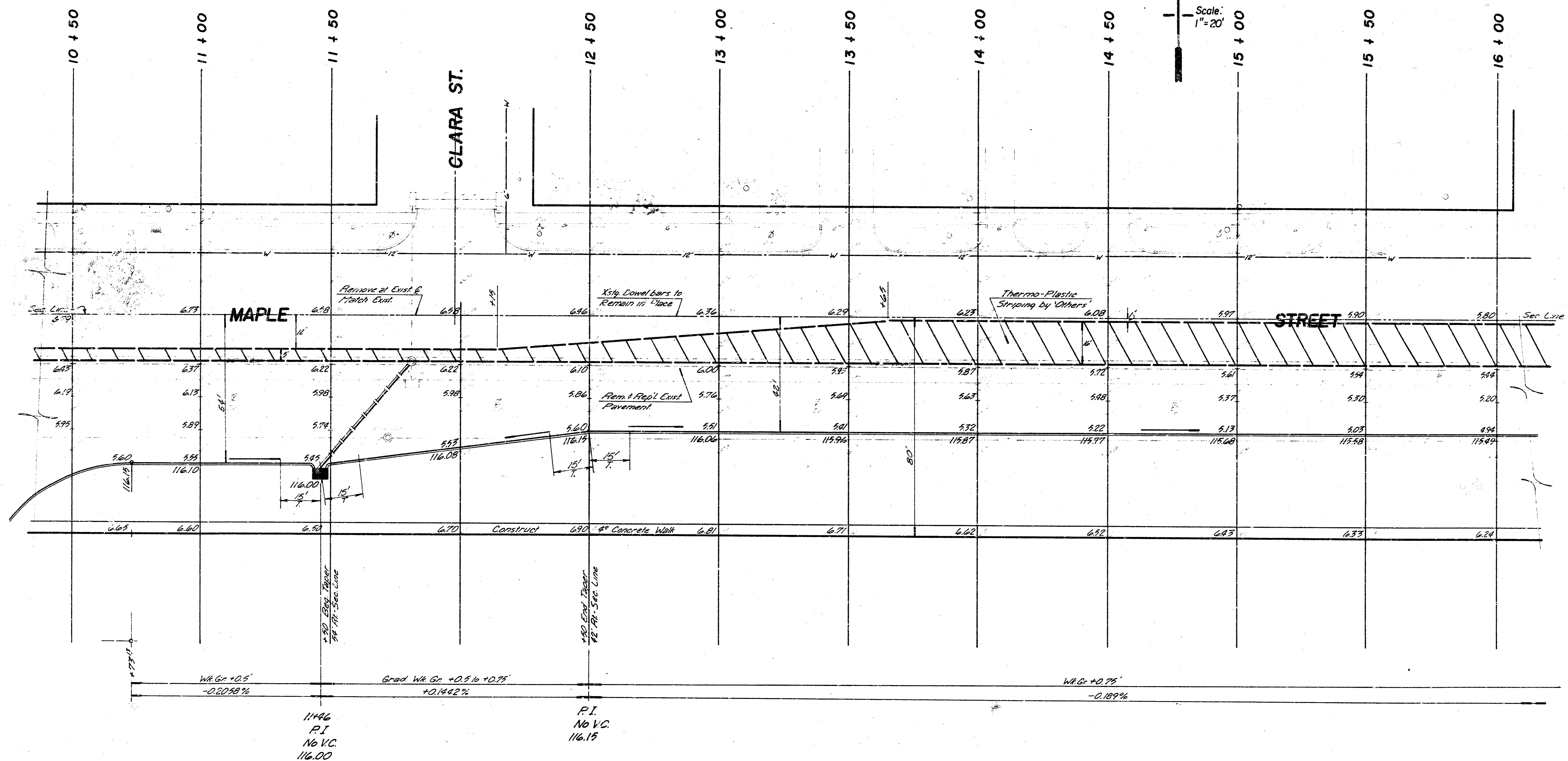
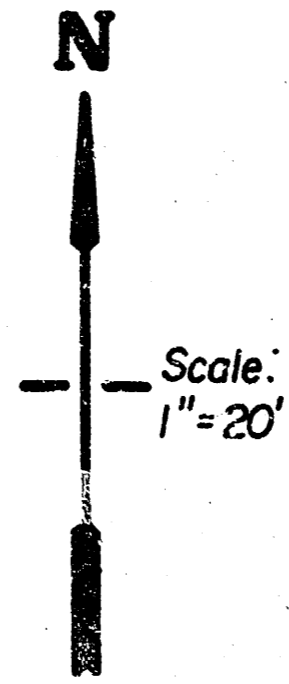

W.G. ±0.5' -0.0208%
 Grad W.G. ±0.5 to ±0.75' +0.1442%
 W.G. ±0.75' -0.189%
 P.I. No V.C. 116.00
 P.I. No V.C. 116.15

Maple
 I-235-17th Conns
 972-76-245-80643-000-000-001

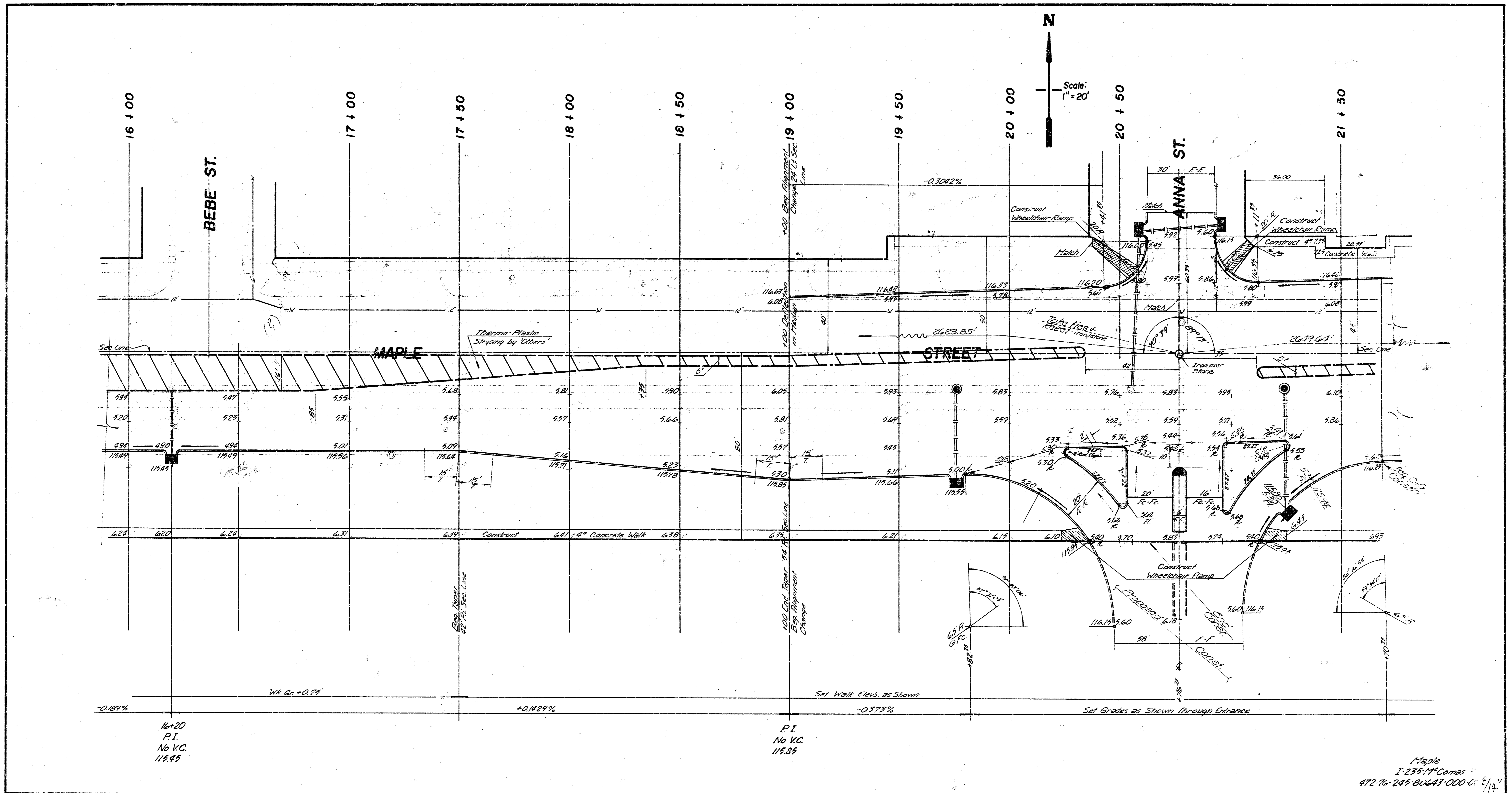

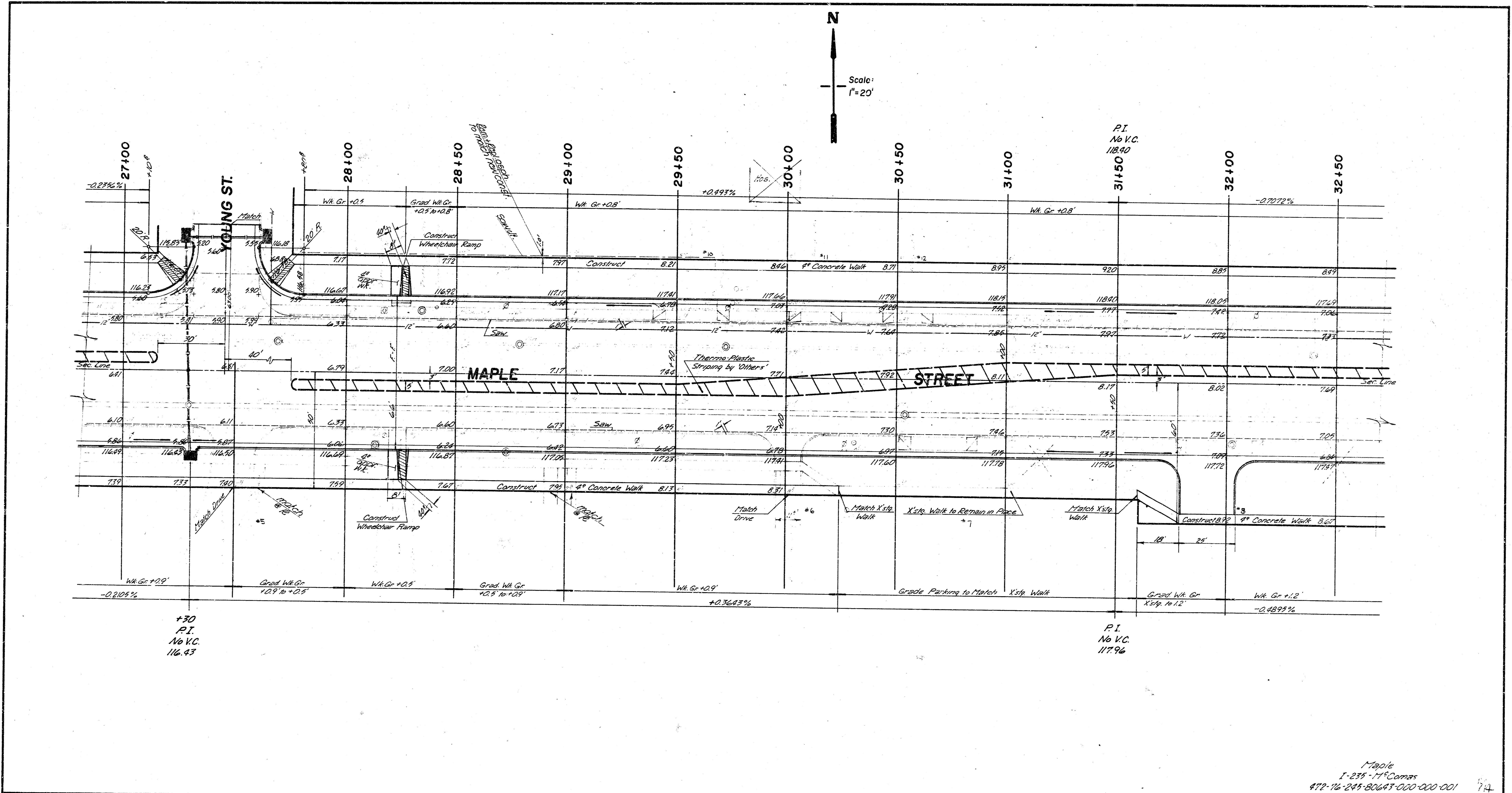

N
Scale:
1" = 20'

+30
P.I.
No V.C.
116.43

P.I.
No V.C.
117.96

B.M. 130.16 City Std. East End of North Hubguard to Bridge over Long Litch.
 B.M. 121.15 '□' on Conc. Base of Life Pole, N.S. Maple 100' west of W.L. West St. in Long John Silver's Parking Lot.

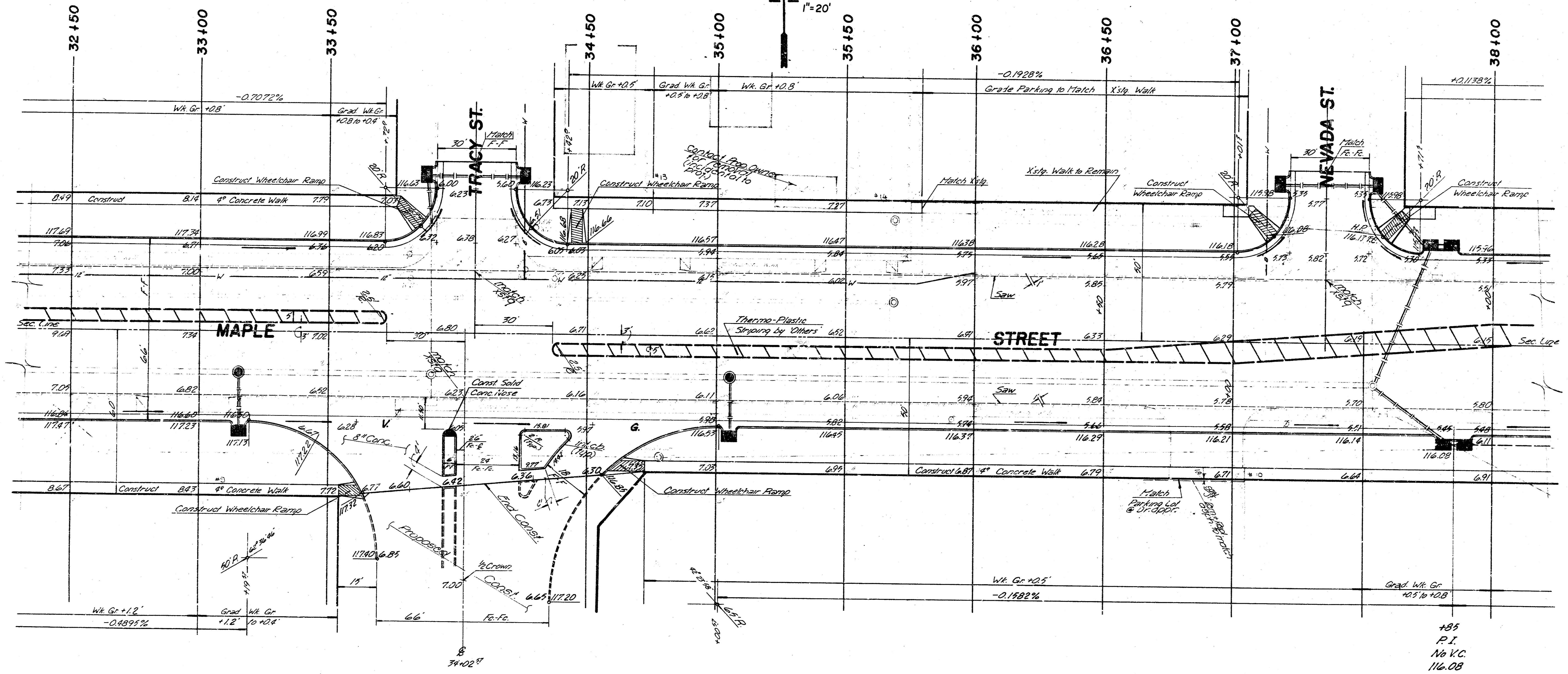
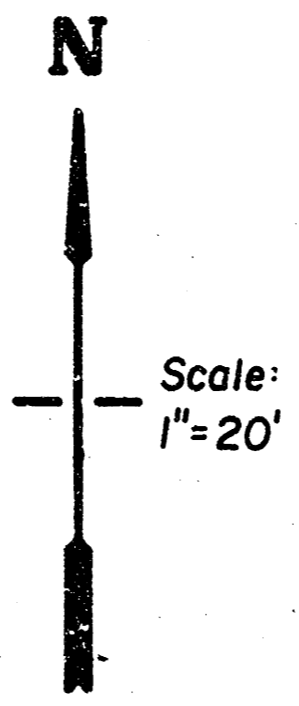

Maple
 I-235-175 Compas
 472-76-80647-000-000-001

12

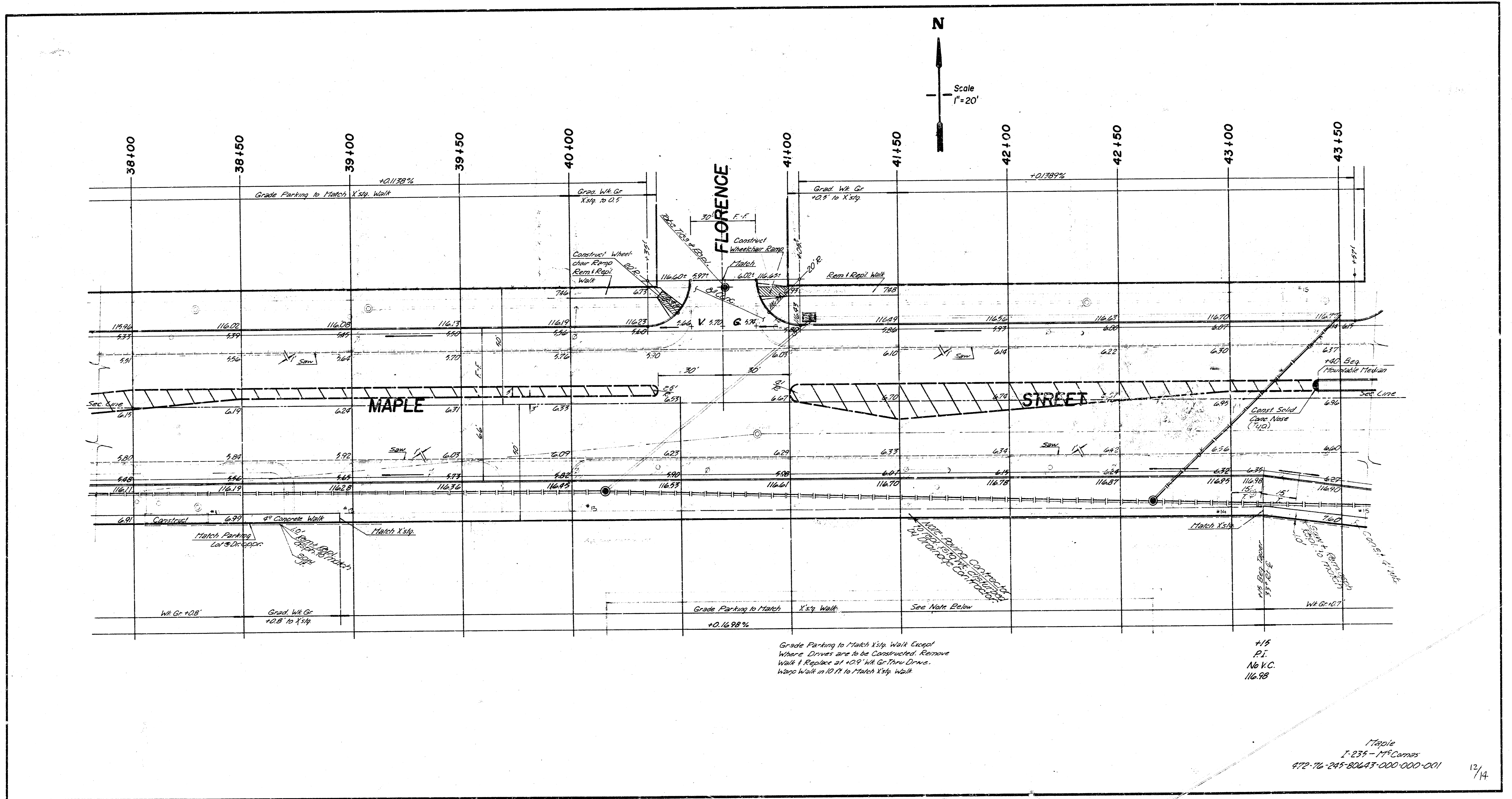

+1.5
P.I.
No V.C.
116.98

Maple
J-235 - 11th Corners
972-76-245-50643-000 000-001

B.M. 130.16 City Std. East End of North Hubguard to Bridge over Dig Ditch
 B.M. 121.15 [] Conc. Base of Lite Pole, N.S. Maple 100' West of W.L.
 West St in Long John Silver's Parking Lot.

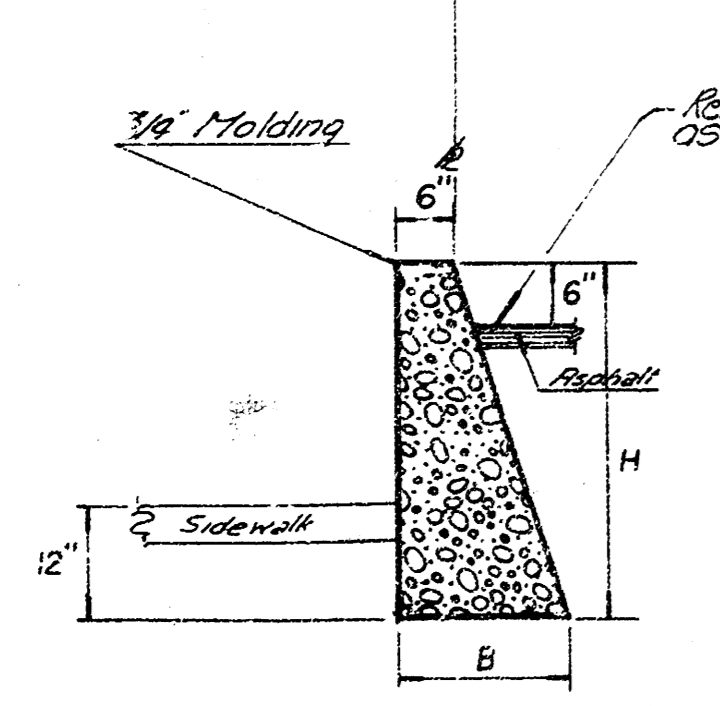
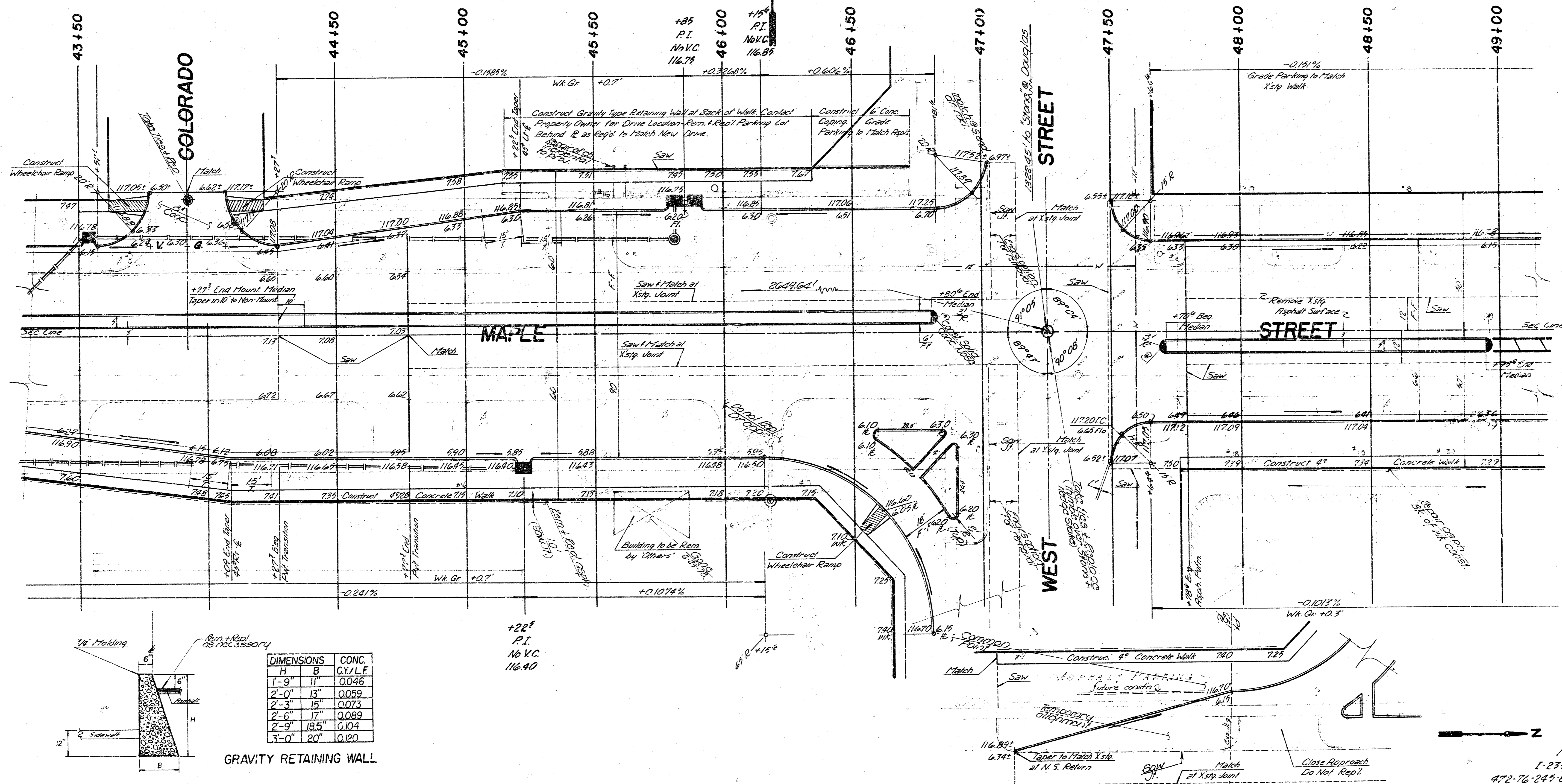
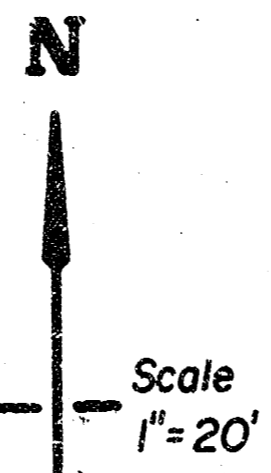

GRAVITY RETAINING WALL

DIMENSIONS		CONC.
H	B	CY./L.F.
1'-9"	11"	0.046
2'-0"	13"	0.059
2'-3"	15"	0.073
2'-6"	17"	0.089
2'-9"	18.5"	0.104
3'-0"	20"	0.120

+22°
 P.I.
 No V.C.
 116.40

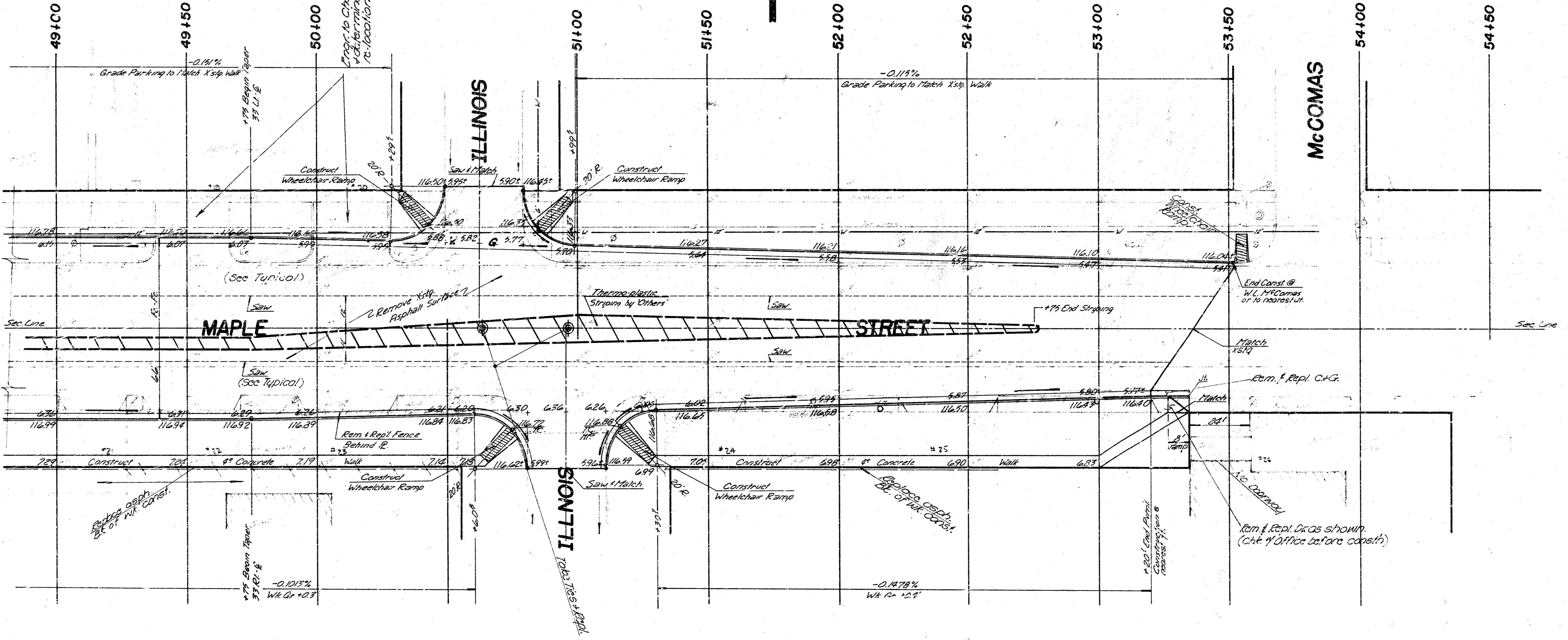
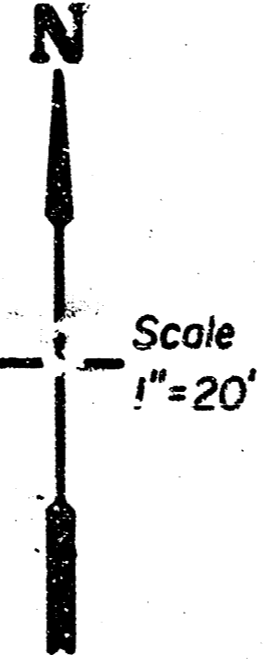

Maple
I-236 - M.C. Comas
472-76-245-80683-000-000-001 14/14