

BM = 97.92 "8" in 1948 W. curb Market @ S.L. Blake  
 B.M. = 101.72 S.W. Cor. conc. porch flgs. on N.E. Cor Market + Kinkaid.

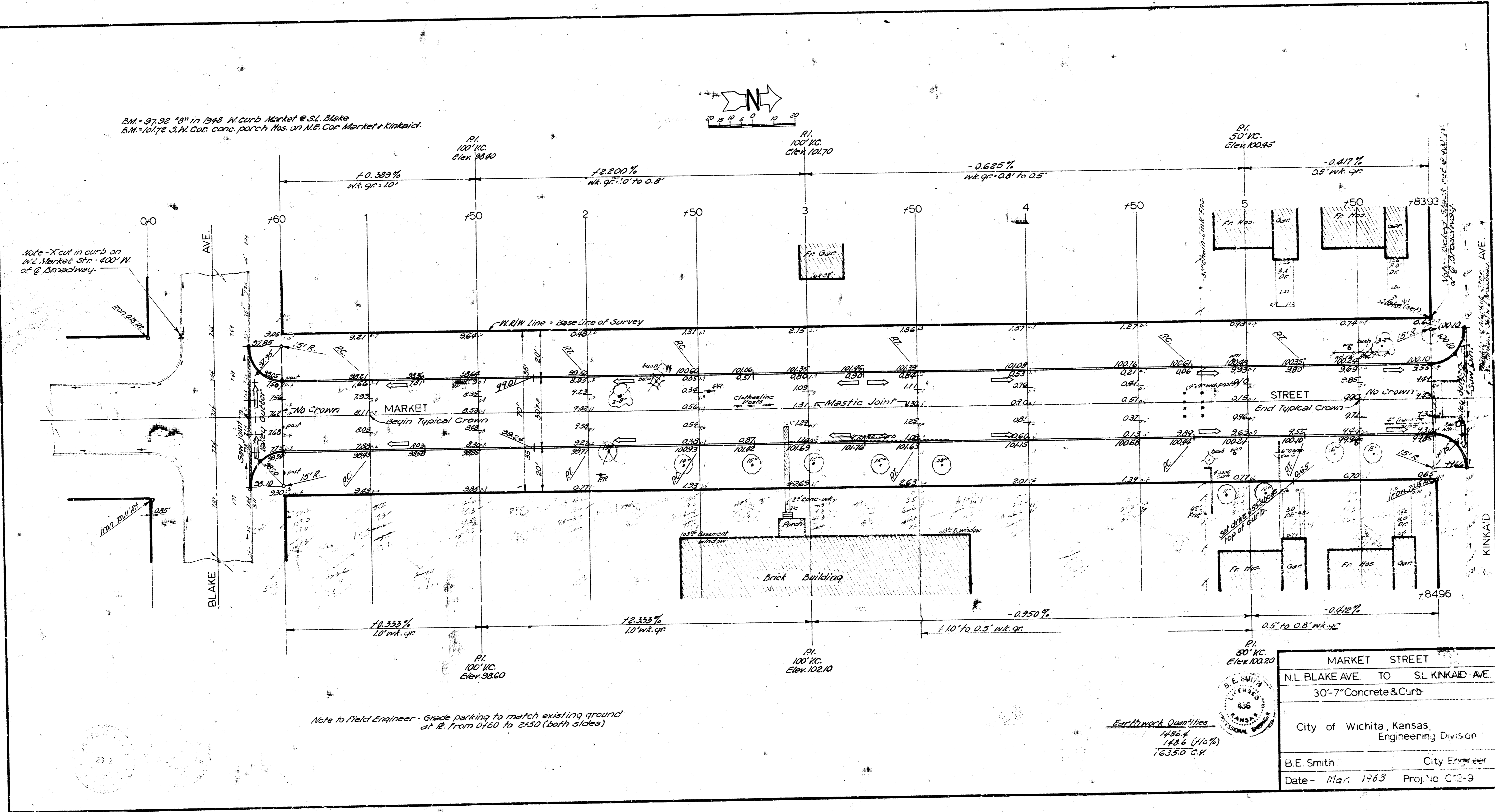
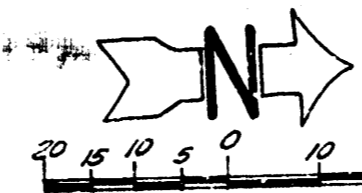

Note - X cut in curb on N.L. Market Str. 400' W. of E. Broadway.

Gantz Seal

Note to Field Engineer - Grade parking to match existing ground at R. from 2160 to 2150 (both sides)

Earthwork Quantities  
 1486 cu yd  
 1436 (10%)  
 16350 cu yd

P.I. 50' K.C. Elev. 100.20

MARKET STREET	
N.L. BLAKE AVE. TO S.L. KINKAID AVE.	
30"-7" Concrete & Curb	
City of Wichita, Kansas Engineering Division	
B.E. Smith	City Engineer
Date - Mar. 1963	Proj No C12-9