

N ½ MAY AVE.

2
2

PROJ. No. C-12-6

B.M. 106.24 311' cor. conc. parch. H.A. #1358 S. Martinson
Stationing on E.

Excavation
2.74
0
Prop.
496.9
+10% 49.7
Total 546.6 Cu. yds.

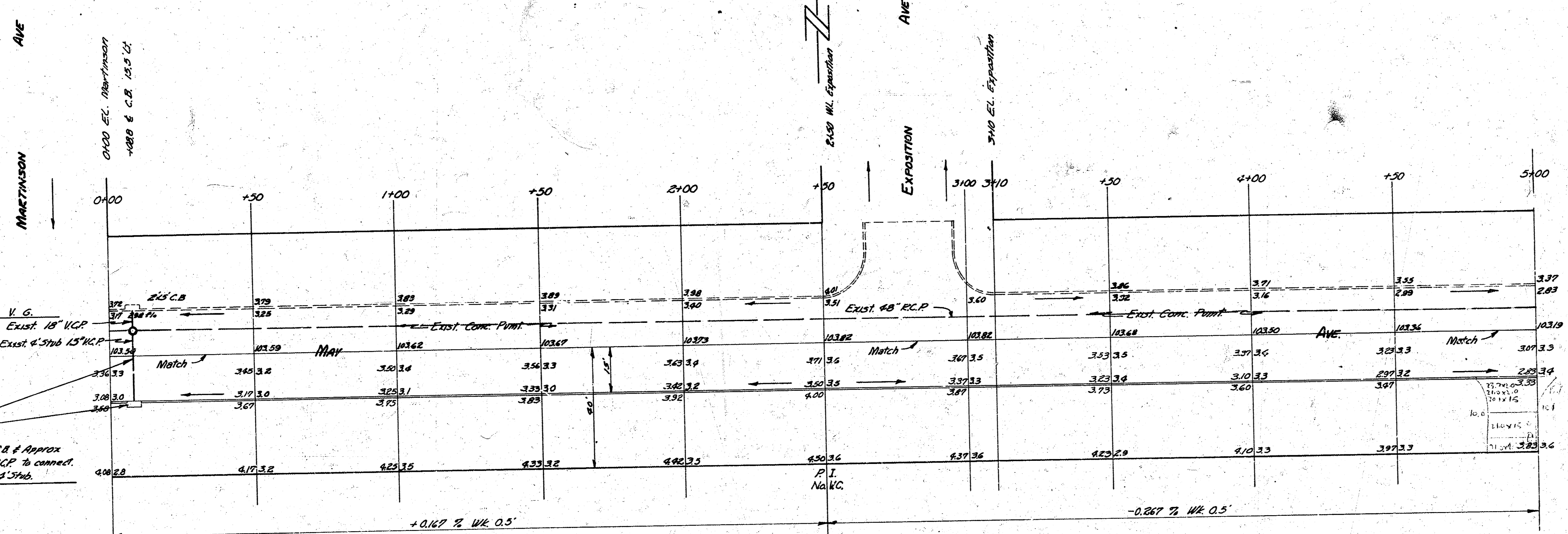

NOTE
Install 24" C.B. at approx
11.5' of 15" R.C.P. to connect
with exist. 48" R.C.P.

Sheet 24
Part 2
of 2
Drawn
J.E.

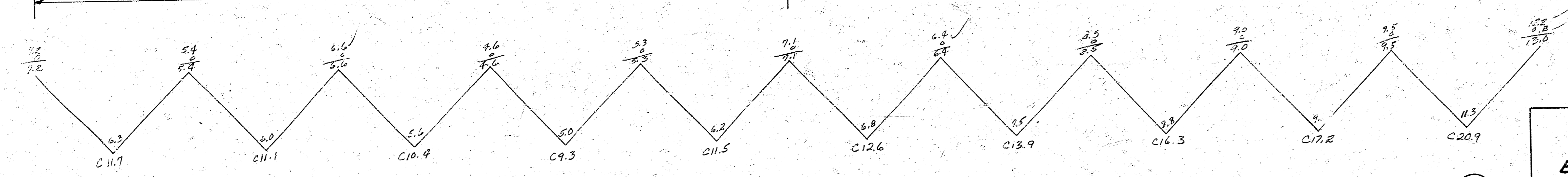

1/2

MAY AVE 5 1/2
E.L. MARTINSON TO W.L. SENECA
15' CONC. & C.B.
CITY OF WICHITA KANSAS
B.E. SMITH CITY ENGINEER
APRIL 1934 Proj. No. 14-49

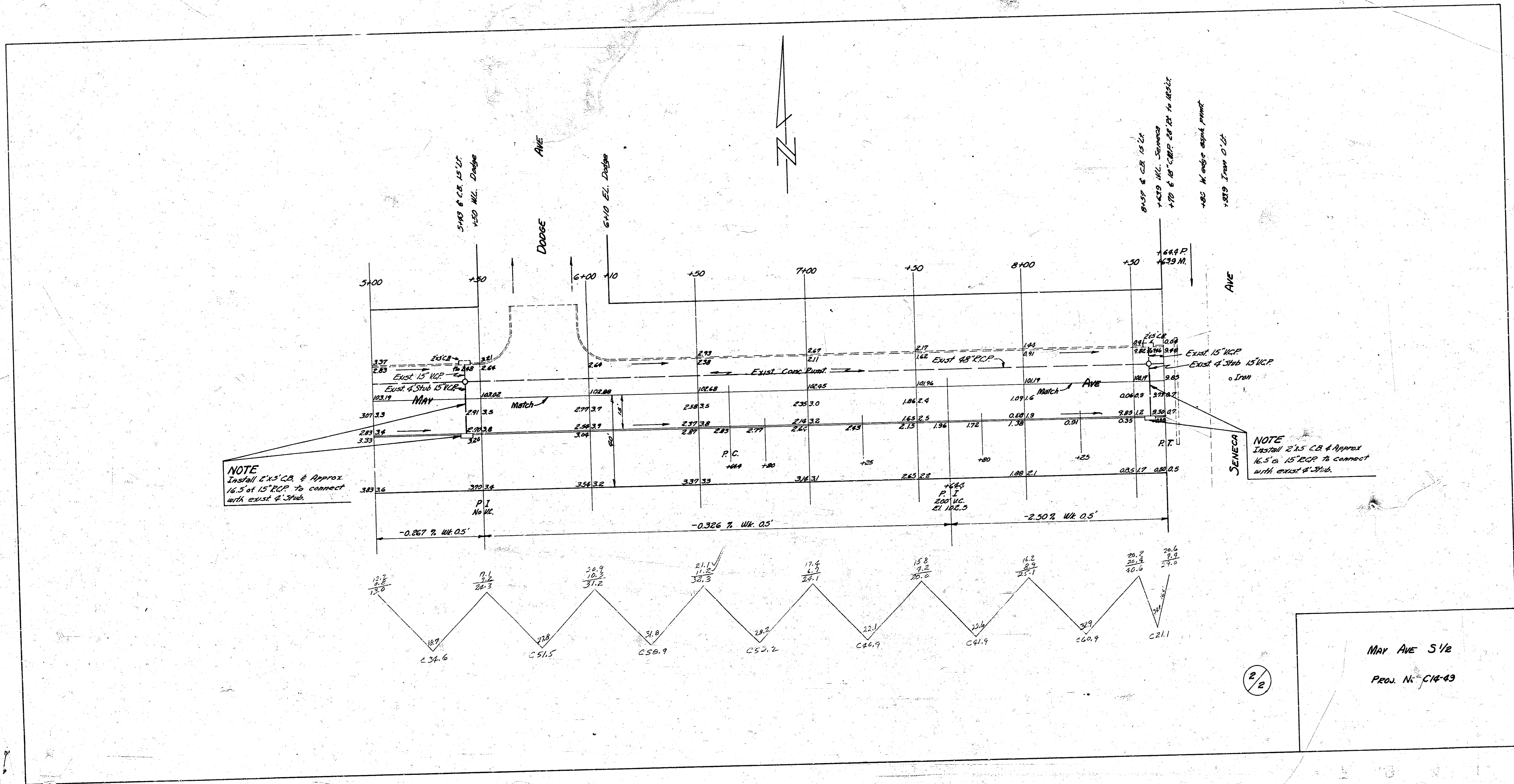

May Ave S 1/2
 Proj. No. C14-43
 2/2