

1942

MATHEWSON COURT - N.L. THIRD TO S.L. MATHEWSON LANE

28-C.1
27' Curb to Curb

NOTE: STATIONS ARE ON E OF PROPOSED PAVT.

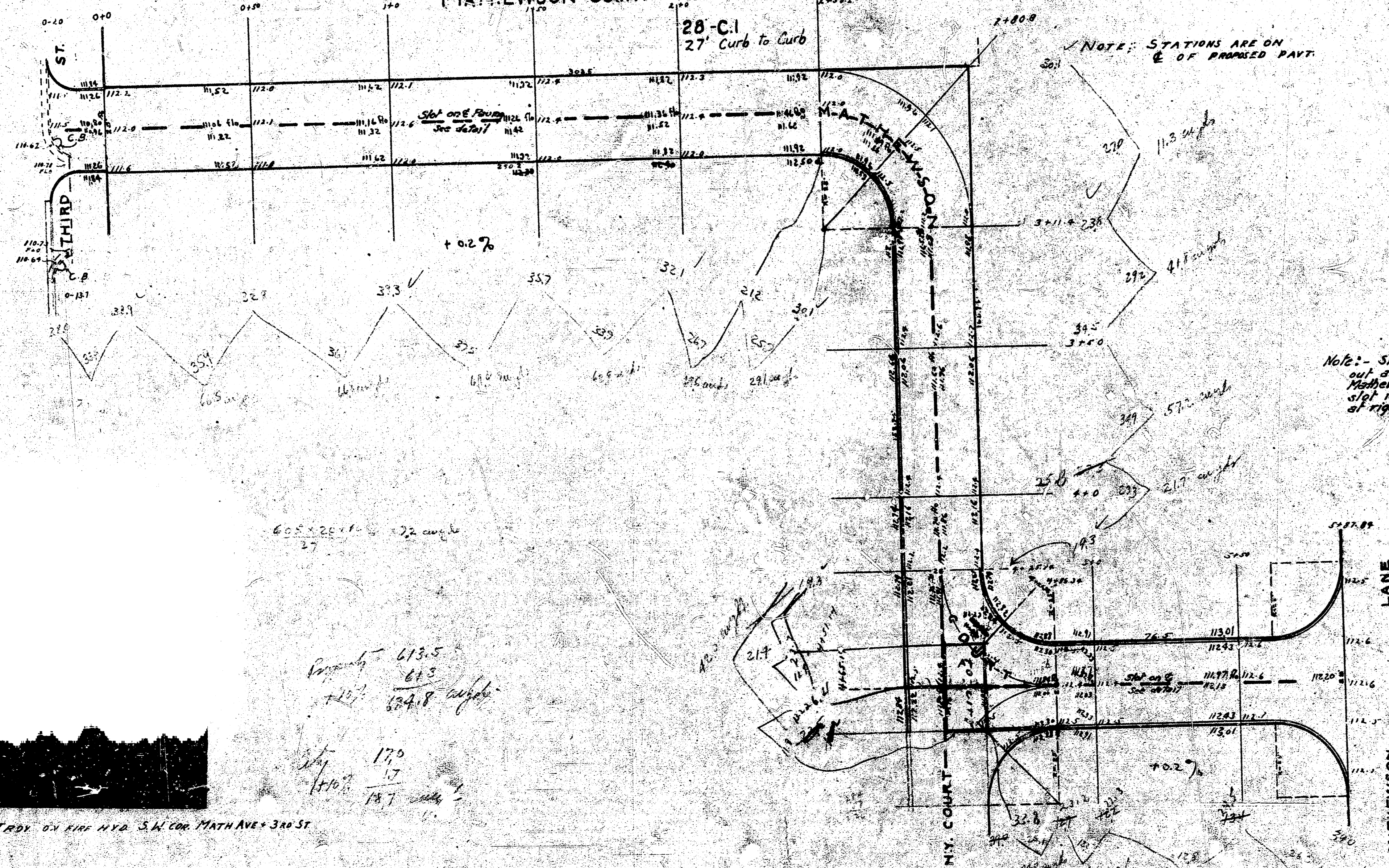

NOTE: Slot on E of paving is to be scattered out at 5'-12" at the intersection of Mathewson Court and New York Court the slot is continuous east + west with a branch at right angles to the north to Mathewson Court.

605 x 22 x 10 = 22 cu yds

Property 613.5
 + 12.7 = 626.2
 626.2 x 17.0 = 10645.4
 10645.4 x 1.7 = 18107.2
 18107.2 x 18.7 = 338604.54



B.M. 11429 T IN TROP. ON CURB N.Y.C. S.W. COR. MATH AVE + 3rd ST