

MAXWELL AVE

E.L. CUSTER TO W.L. MERIDIAN

WORK ON THIS PROJECT SHALL BE COORDINATED WITH THE WORK ON THE OTHER SIX (6) PROJECTS THAT ARE A PART OF THIS CONTRACT. CONSTRUCTION SEQUENCING IS SUBJECT TO THE APPROVAL OF THE ENGINEER.

- GENERAL NOTES
143. CONTRACTOR SHALL FURNISH CURBS ON THIS PROJECT. CURBS SHALL BE DEEPENED THROUGH DRIVES WHEN DRIVES ARE CONSTRUCTED AS A PART OF THIS CONTRACT. NO MORE THAN SIXTY (60) DRIVES ARE TO BE CONSTRUCTED WITHIN THIS PROJECT.
 142. PAVEMENT SHALL BE 7" ASPHALTIC CONCRETE (2" BITUMINOUS BASE AND 2" WEARING SURFACE).
 143. TREES TO BE REMOVED ARE INDICATED ON THE PLANS; HOWEVER, ANY TREE WHICH CAN BE SAVED, AS DETERMINED BY THE FIELD ENGINEER, SHALL NOT BE REMOVED.
 144. EARTHWORK TO MEET EXISTING FINISH ELEVATION AT RIGHT OF WAY LINE, UNLESS OTHERWISE NOTED ON THE PLAN WITH A NEW ELEVATION. IF A NEW ELEVATION IS FURNISHED, ALL EXISTING SHALL EXCEPT ONE FOOT BEYOND RIGHT OF WAY LINE, THREE UP OR DOWN ON A 1% SLOPE TO THE EXISTING FINISH ELEVATION.
 145. WIDENED WATER SECTIONS OF CONCRETE CURBS AND UTILITY INTERSECTIONS WILL NOT BE PAID FOR DIRECTLY, AND THIS COST SHALL BE CONSIDERED AS SUBORDINATE TO THE OTHER PAY ITEMS OF WORK.
 146. MAILBOXES WITHIN THE PROJECT LIMITS SHALL BE REMOVED AND REPLACED BY THE CONTRACTOR AS APPROVED BY THE ENGINEER. CONTRACTOR WILL BE REQUIRED TO MAKE SATISFACTORY PROVISIONS FOR MAIL DELIVERY TO PROPERTIES AFFECTED BY THIS PROJECT DURING CONSTRUCTION.
 147. ALL ENTRANCE AND CROSS ROAD DRAINAGE PIPES WITHIN THE PROJECT LIMITS SHALL BE REMOVED BY THE CONTRACTOR, UNLESS OTHERWISE NOTED ON THE PLAN. REMOVAL OF SUCH PIPES SHALL CONFORM TO THE APPLICABLE SECTIONS OF THE STANDARD SPECIFICATIONS.
 148. CONTRACTOR TO BID ONE (1) END-GRASS TREATMENT ALTERNATE. ALTERNATE CHOSEN BY THE SUCCESSFUL BIDDER SHALL BE CONSIDERED UNDESIRABLE TO EXHIBITION.
 149. REMOVAL OF EXCESS PAVEMENT PLACED IN THE CONSTRUCTION OF THE ST. PAUL AND THE RICHMOND PARKING PROJECTS SHALL BE CONSIDERED UNDESIRABLE TO EXHIBITION.
 150. THE "BORROW" SHOWN ON THIS PLAN IS FOR INFORMATIONAL PURPOSES ONLY. "BORROW" WILL NOT BE PAID IN CONNECTION WITH THIS PROJECT. THE CONTRACTOR SHALL SECURE HIS OWN "BANK" EXCEPT FROM OTHER PROJECTS IN THIS AREA CAN BE USED AT HIS COST TO THIS PROJECT.

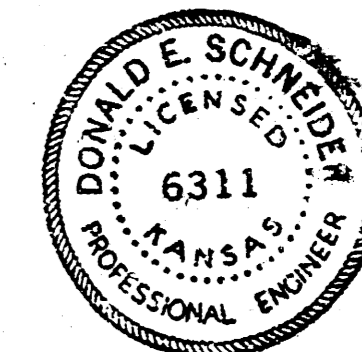
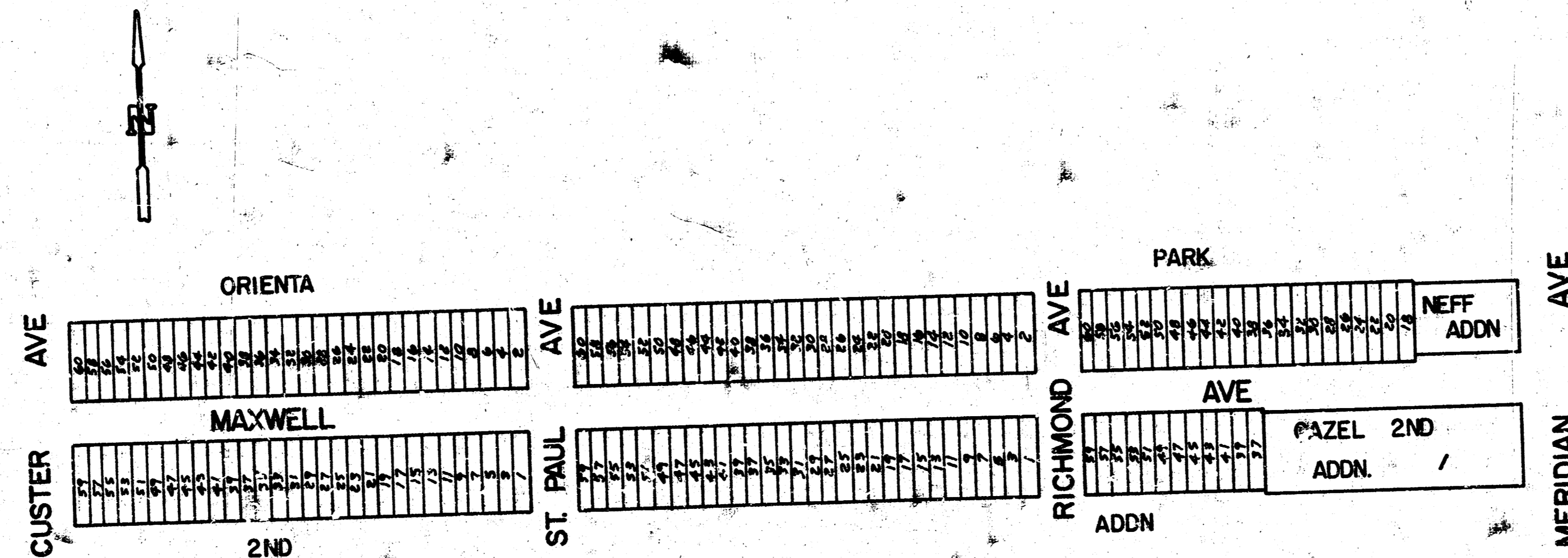

PROJECT DESCRIPTION		
MAXWELL AVE		
PROJECT NUMBER		
472 76 245 81172 000 000 001		
BOOK NO. <i>DED III</i>	APPROVED BY	DATE
DRAWN BY <i>Klug</i>	REVIS	REVIS
CITY OF WICHITA		
DEPARTMENT OF ENGINEERING		
DIRECTOR OF ENG. CITY ENGINEER		SCALE
R. W. BRUGGEMAN		1/9

MAXWELL AVE

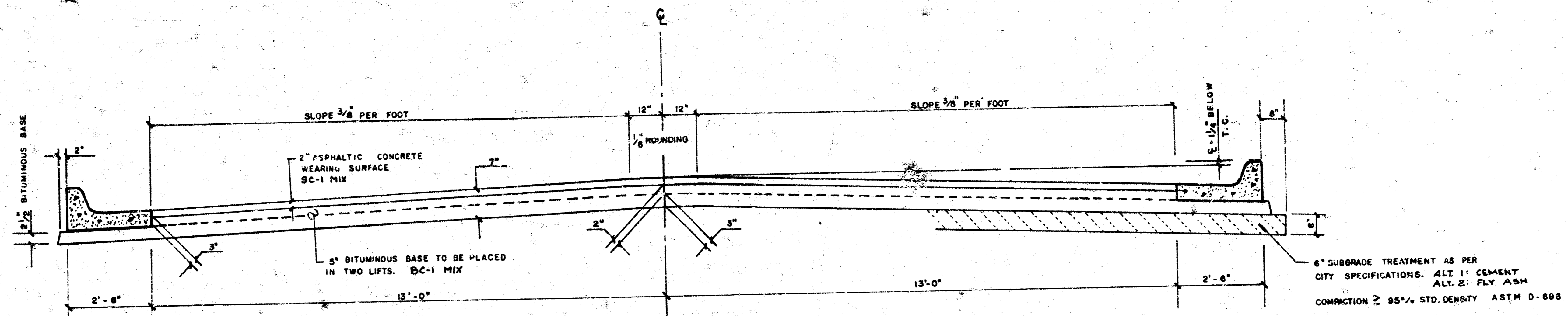

TYPICAL SECTION

3' ASPHALTIC CONCRETE PAVEMENT WITH BITUMINOUS BASE

A TACK COAT OF EMULSIFIED ASPH(SS-1H or CSS-1H) SHALL BE APPLIED AT AN APPROXIMATE RATE 0.05 GALLONS PER SQ YD BETWEEN LIFTS OF ASPHALTIC MATERIALS WHEN ORDERED BY THE ENGINEER. TACK COAT WILL NOT BE PAID DIRECTLY AND SHALL BE CONSIDERED AS SUBSIDIARY TO PRICE BID FOR ASPHALTIC PAVEMENT.

BITUMINOUS WEARING SURFACE SHALL BE PLACED WITH A LAYDOWN MACHINE HAVING AUTOMATIC CONTROLS FOR CONSTRUCTION JOINTS IN EACH LIFT SHALL BE STAGGERED A MINIMUM DISTANCE OF 1' WITH JOINTS IN THE LIFTS PLACED SUCH THAT A JOINT WILL BE CONSTRUCTED ON THE CENTERLINE IN THE TOP LIFT.

THE A.C. PAVEMENT BETWEEN THE COMBINED CURB AND GUTTER SHALL BE PAID AS SQ YDS 7" A.C. PAVEMENT (5" BITUMINOUS BASE). THE BITUMINOUS BASE UNDER THE COMBINED CURB AND GUTTER SHALL BE PAID AS SQ YDS 2 1/2" BITUMINOUS BASE.

COMBINED CURB & GUTTER

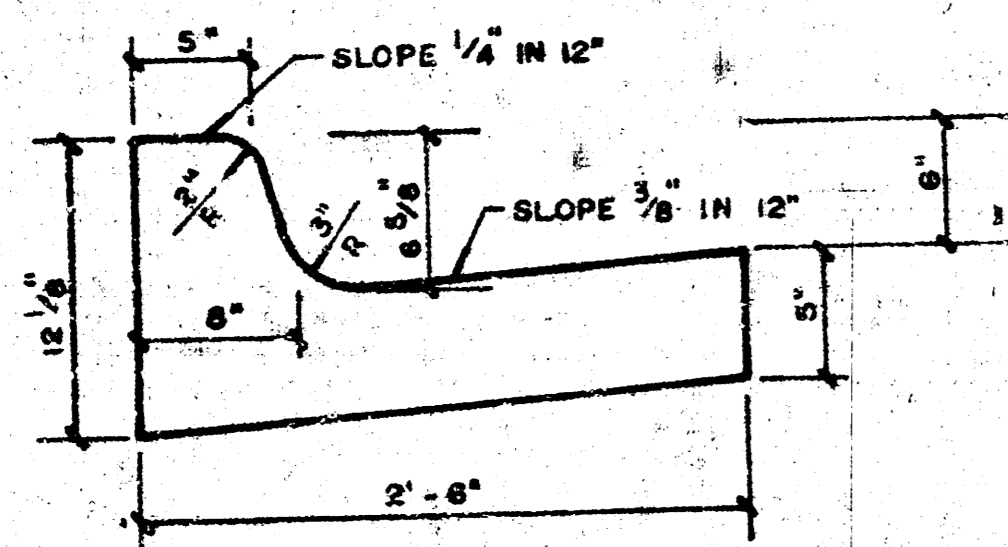

ROLL TYPE CURB & GUTTER

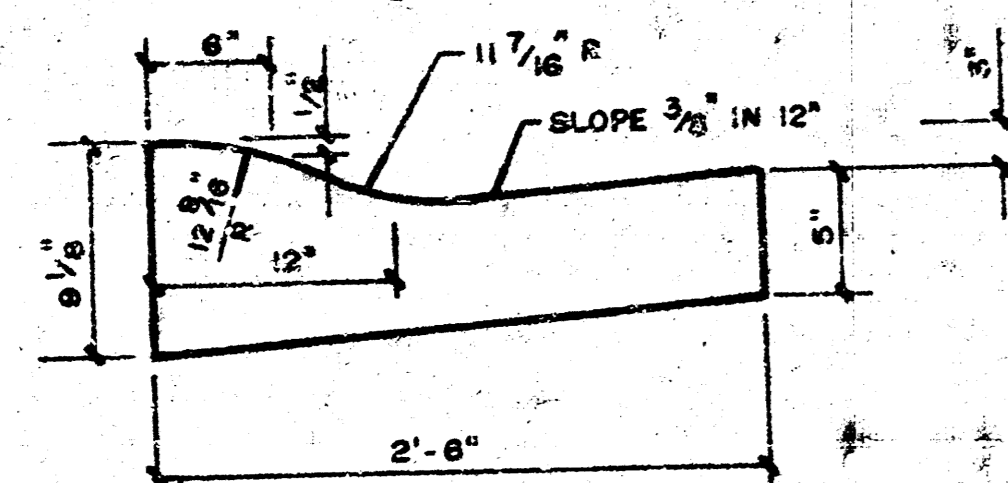

DETAIL OF TRANSVERSE CONSTRUCTION JOINTS

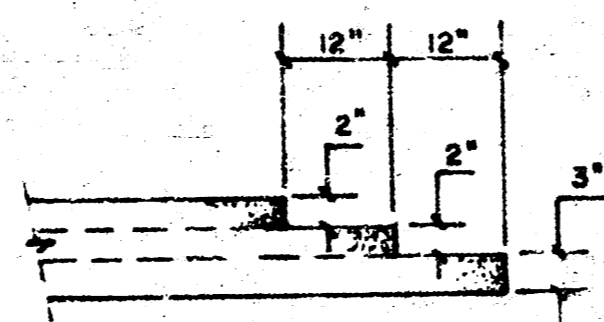

TRANSVERSE CONSTRUCTION JOINTS SHALL BE CONSTRUCTED IN FLEXIBLE BASE PAVEMENTS AT LOCATIONS WHERE PAVEMENT TEMPORARILY ENDS TO FACILITATE FUTURE PAVEMENT CONSTRUCTION AS SHOWN BY DETAIL. THE COST OF CONSTRUCTING THE TRANSVERSE CONSTRUCTION JOINTS SHALL NOT BE MEASURED OR PAID FOR DIRECTLY BUT SHALL BE INCLUDED IN THE BID PRICE FOR SQUARE YARDS OF A.C. PAVEMENT.



B.M. = 59.62 - City Stk. Disc. Meridian + 277th St. So. 44' E. + 42.5' N. of E. Bath
 B.M. = 101.70 - R.R. Spike ... For Street Light Pole SE Cor. Casado + St. Paul.

E 15 E Maxwell

CAUTION
UNDERGROUND
UTILITIES
 Please check with K O & E or
 Southwestern Bell
 Telephone Co. for Location

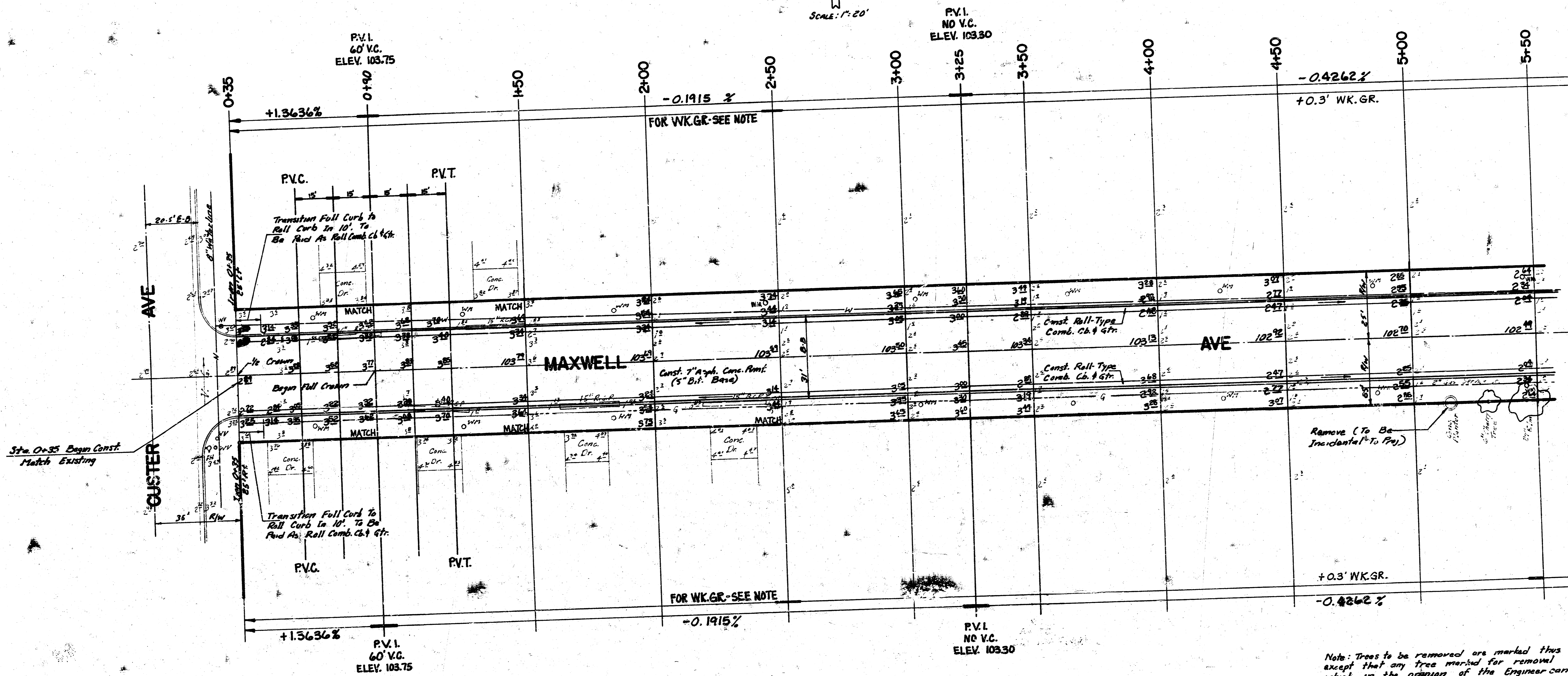
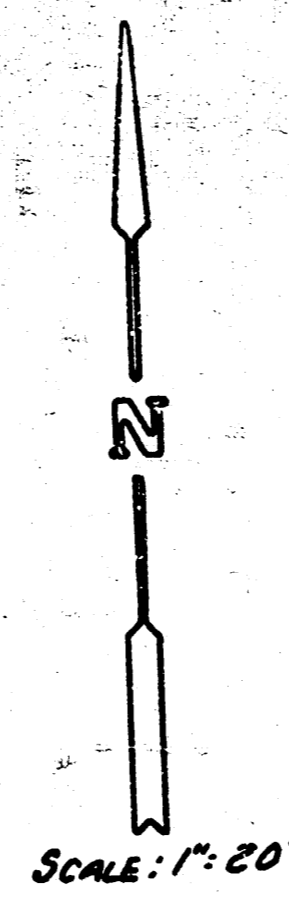

Sta. Or. 35 Begin Const. Match Existing

Note: Roll-Type Comb. Curb & Gutter To Be Constructed On This Project. Top Of Curb Elevations Given Are Actual For Both Full Height And Roll Height.

Note: Trees to be removed are marked thus except that any tree marked for removal which in the opinion of the Engineer can be saved, shall be spared.

EARTHWORK		
	Excavation	Comp. Fill
X-Section	857.4 C.Y.	40.0 C.Y.
10%	85.7 C.Y.	4.0 C.Y.
Total	943.1 C.Y.	44.0 C.Y.

Manipulation = 6,395.6 S.Y.
 Burrow = 300 C.Y.

Note: Work on this project shall be coordinated with paving work on Meridian Ave.

Note: Roll-Type Comb. Curb & Gutter To Be Constructed On This Project.

THE CONTRACTOR SHALL BE RESPONSIBLE FOR PRESERVING PROPERTY IRONS. THE CONTRACTOR SHALL BE REQUIRED TO RE-ESTABLISH ANY PROPERTY IRONS WHICH ARE DAMAGED OR DESTROYED BY HIS CONSTRUCTION OPERATIONS. SUCH IRONS SHALL BE RE-ESTABLISHED BY A LICENSED LAND SURVEYOR OR A LICENSED PROFESSIONAL ENGINEER IN ACCORDANCE WITH STATE LAWS.

PROJECT DESCRIPTION
MAXWELL AVE 3/4
 PROJECT NUMBER
 472 76 245 81172 000 000001

BM = 101.62 - R.R. Spike E. Face PP SW Cor. Crawford & Richmond.
BM = 102.38 - R.R. Spike W. Face PP SE Cor. St. Paul & Crawford.

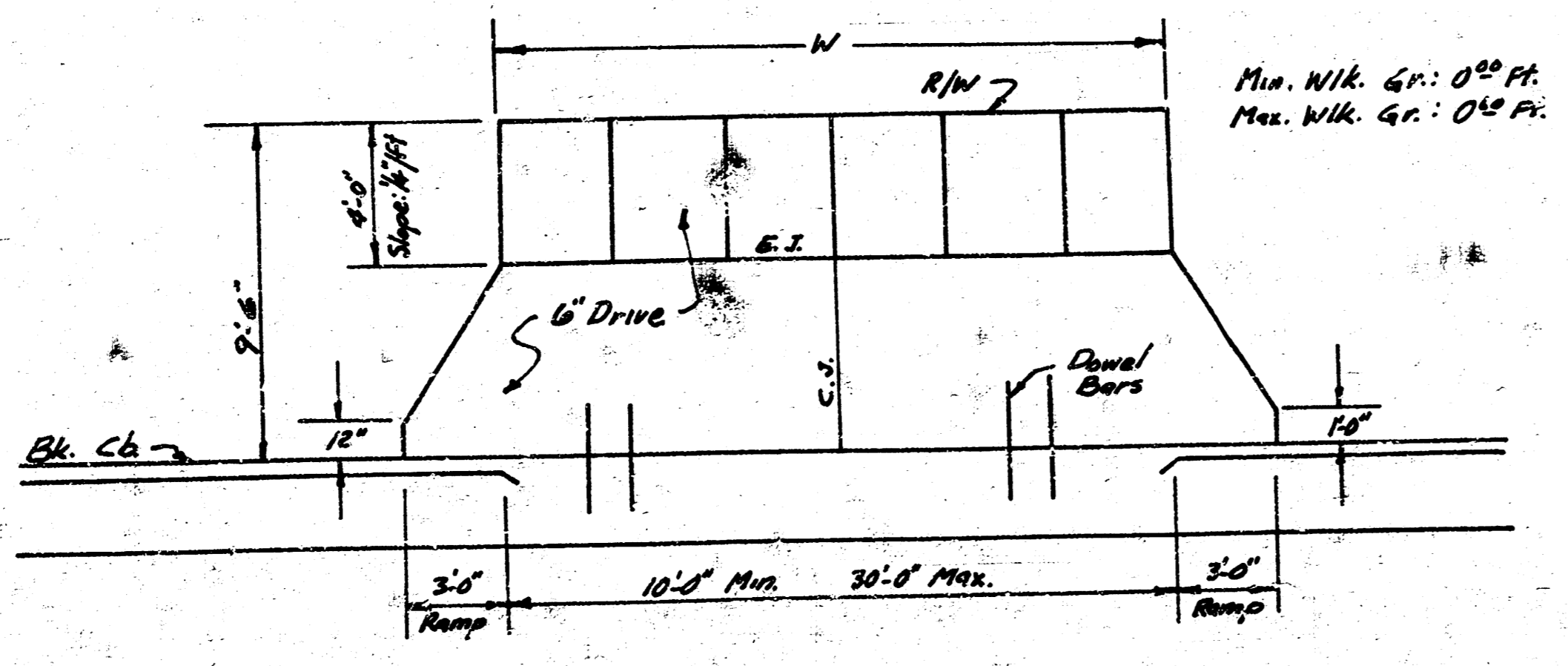
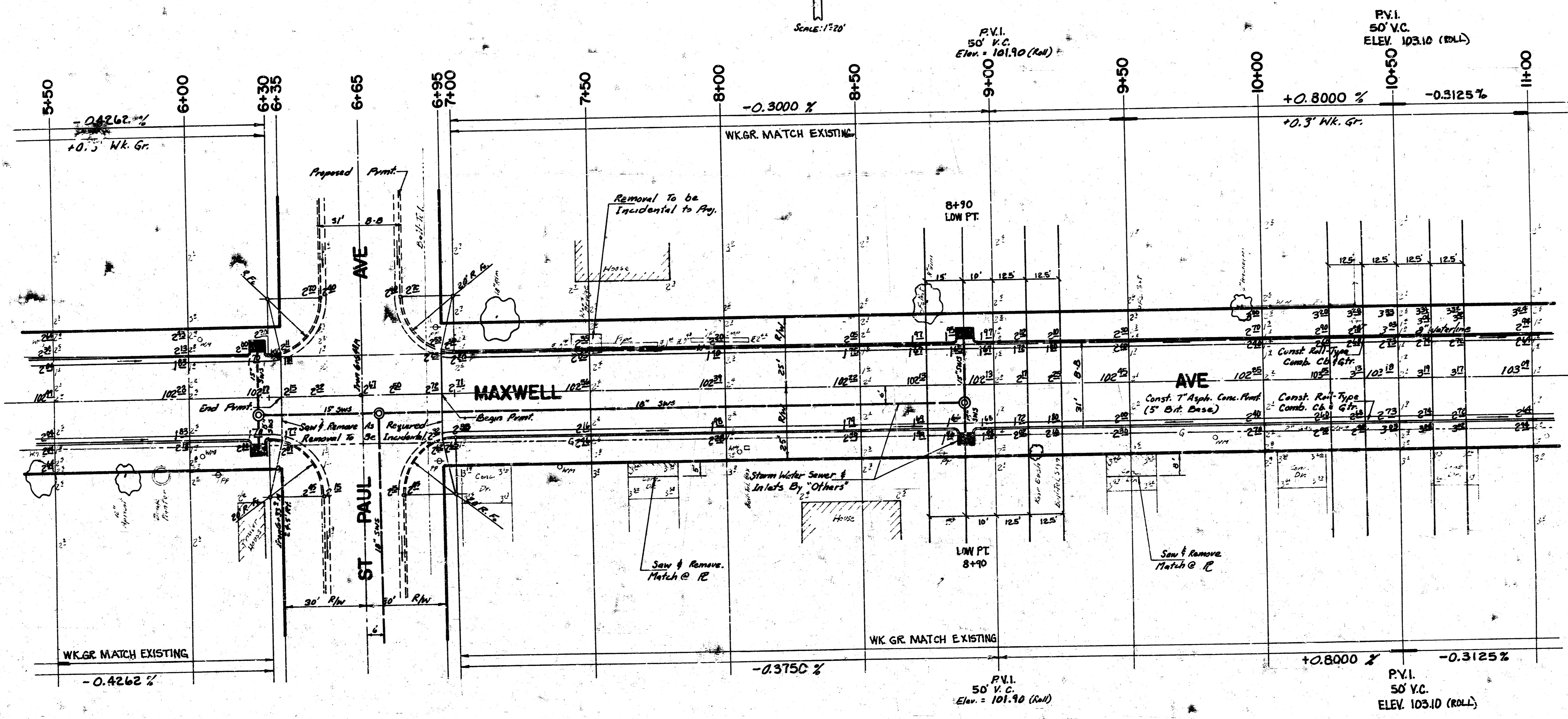
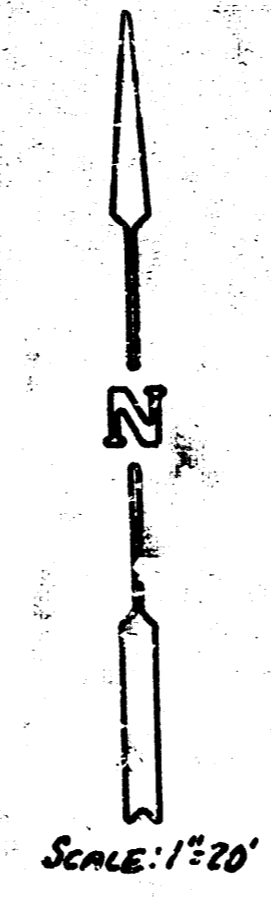

PROJECT DESCRIPTION
MAXWELL AVE 4/9
 PROJECT NUMBER
 472 76 245 81172 000 000 001

FOR INFO FROM THE DIST

B 17 = 103.25 - SE Cor. Bottom Step Mernagite Church NE. Cor. Crawford & Meridian.

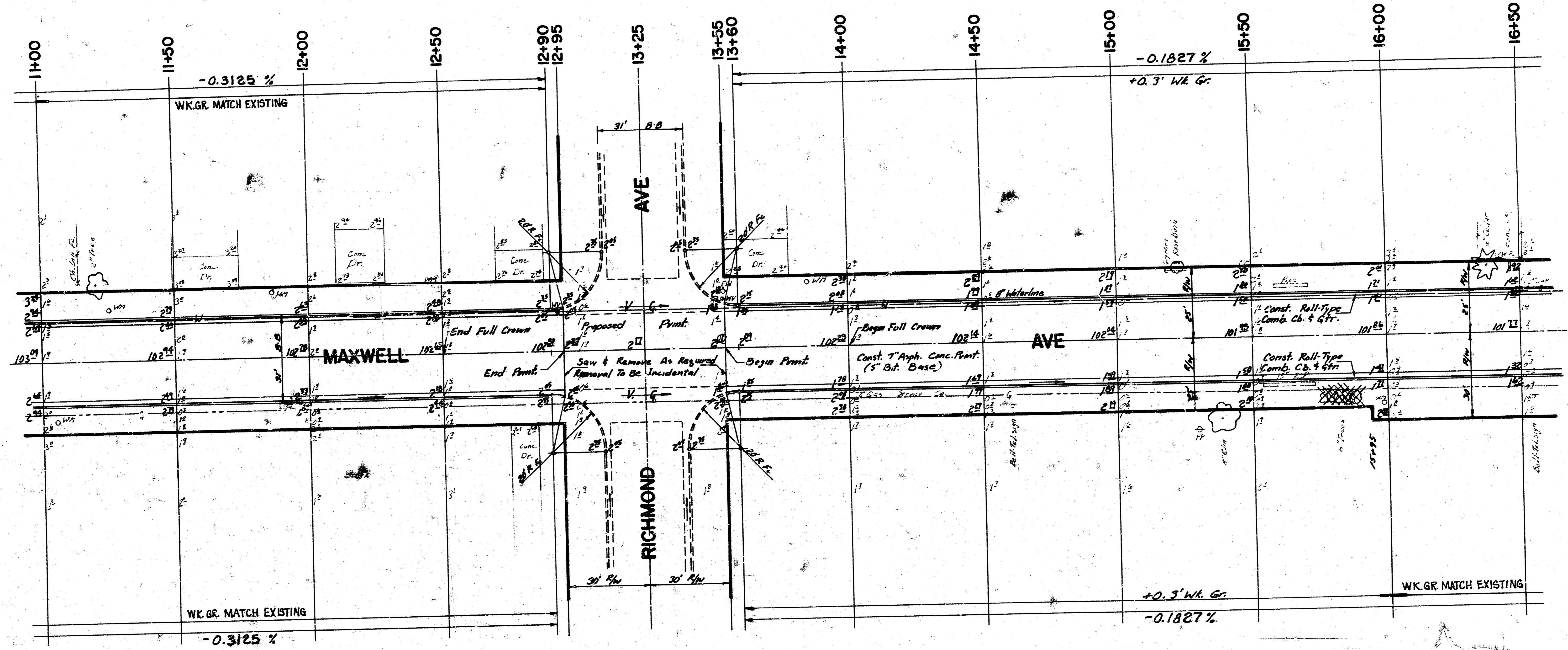
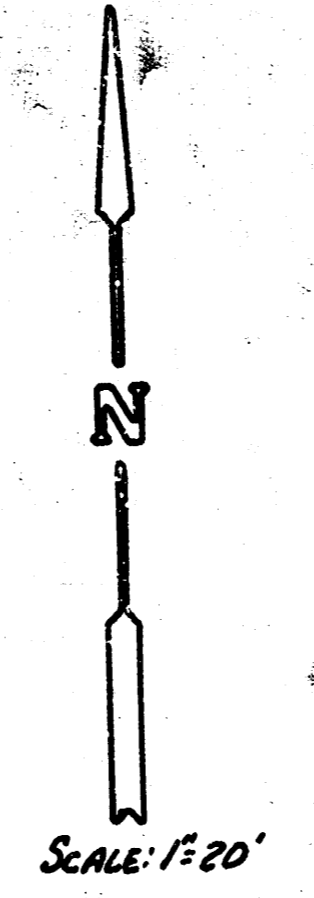

PROJECT DESCRIPTION
MAXWELL AVE 5/9
 PROJECT NUMBER
 472 76 245 81172 000 000001

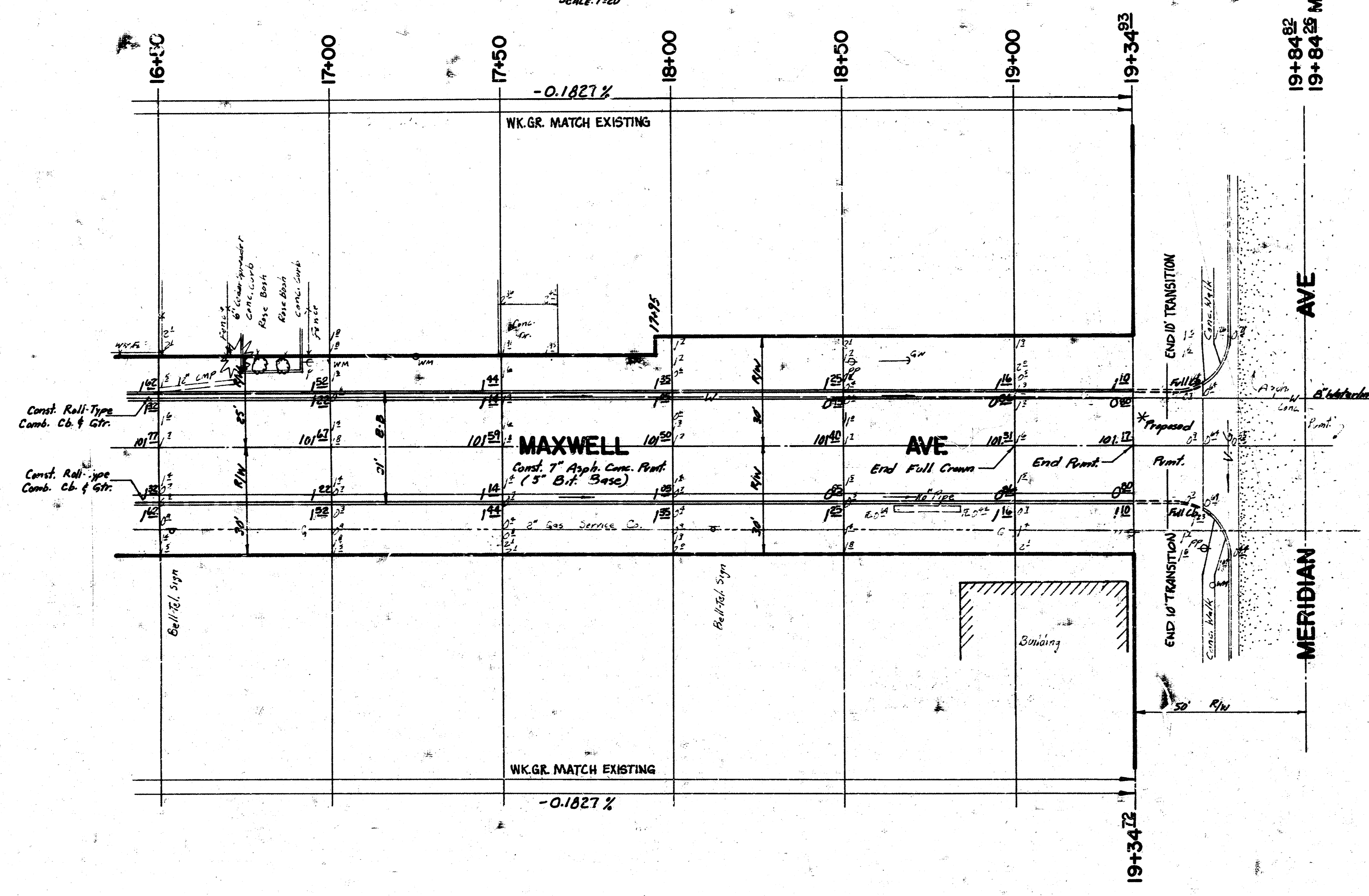
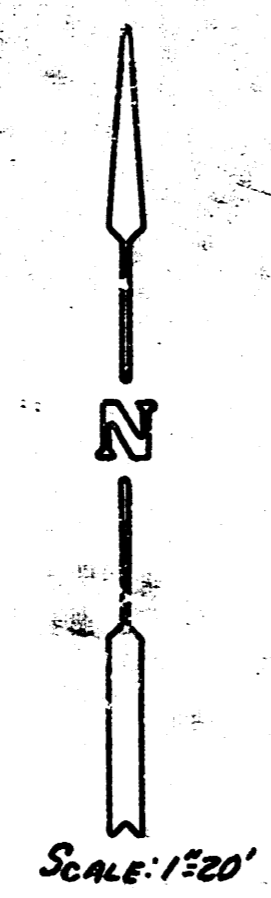

* Note: Proposed Pmt. Between End of New Pmt. & Exst. Pmt. on W.S. Meridian To Be Constructed on Meridian Paving Project.
 TRANSITION ROLL CURBS TO FULL CURBS IN 10' (AS INDICATED) TO BE CONSTRUCTED ON MERIDIAN PAVING PROJECT.

PROJECT DESCRIPTION	
MAXWELL AVE	6/9
PROJECT NUMBER	
4 76 245 81172 000 000 001	

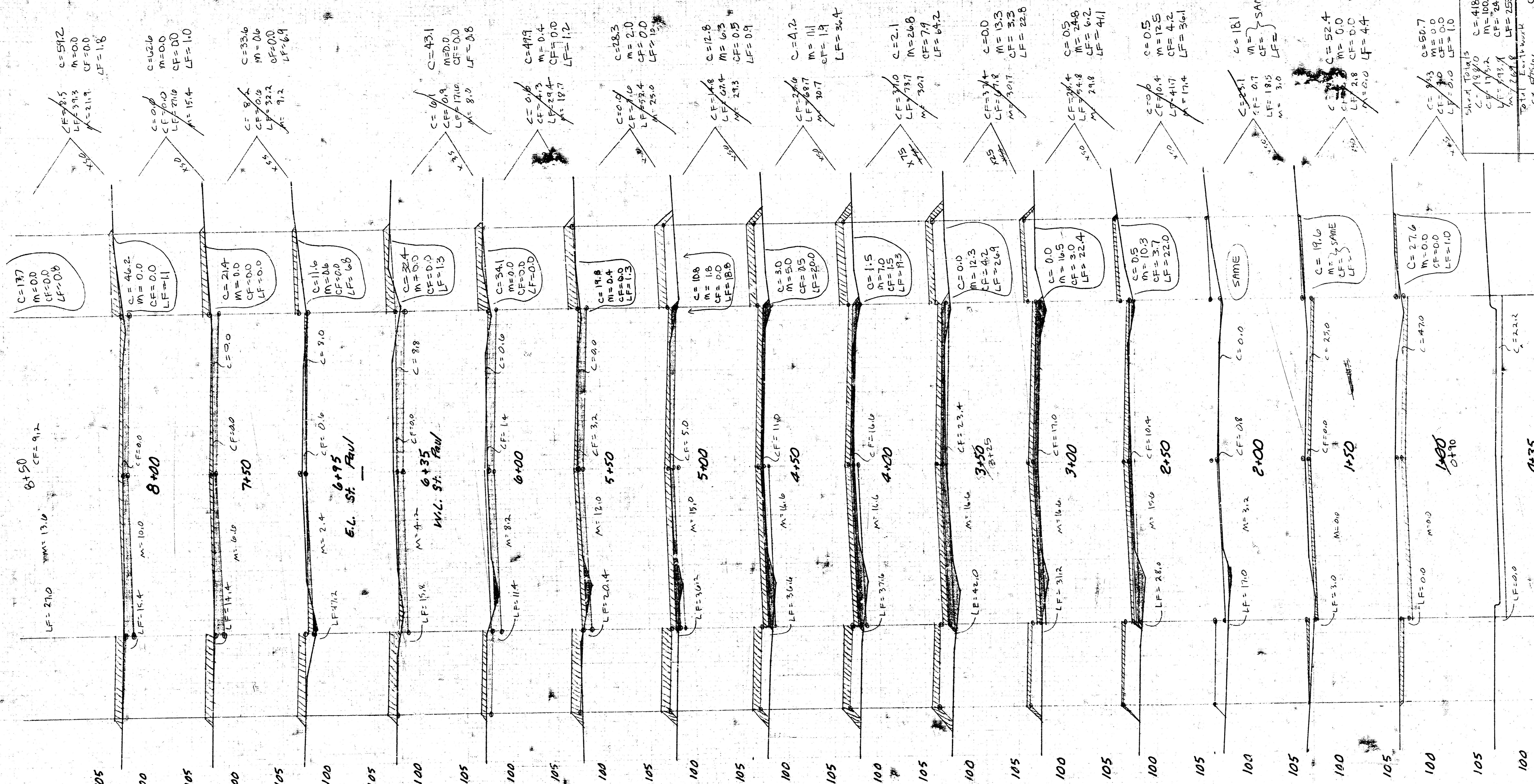

SECTION REVISIONS:
 DELETED EXC.
 DELETED FILL
 ADDITIONAL EXC.
 ADDITIONAL FILL

MAXWELL
 472 76 245 8172 000 000 001

Sheet Title
 C = 418.0
 M = 100.0
 CF = 24.7
 LF = 253.7
 BORROW = 11(12(400+210.4)+574.2) - 18x857.4 = 2189

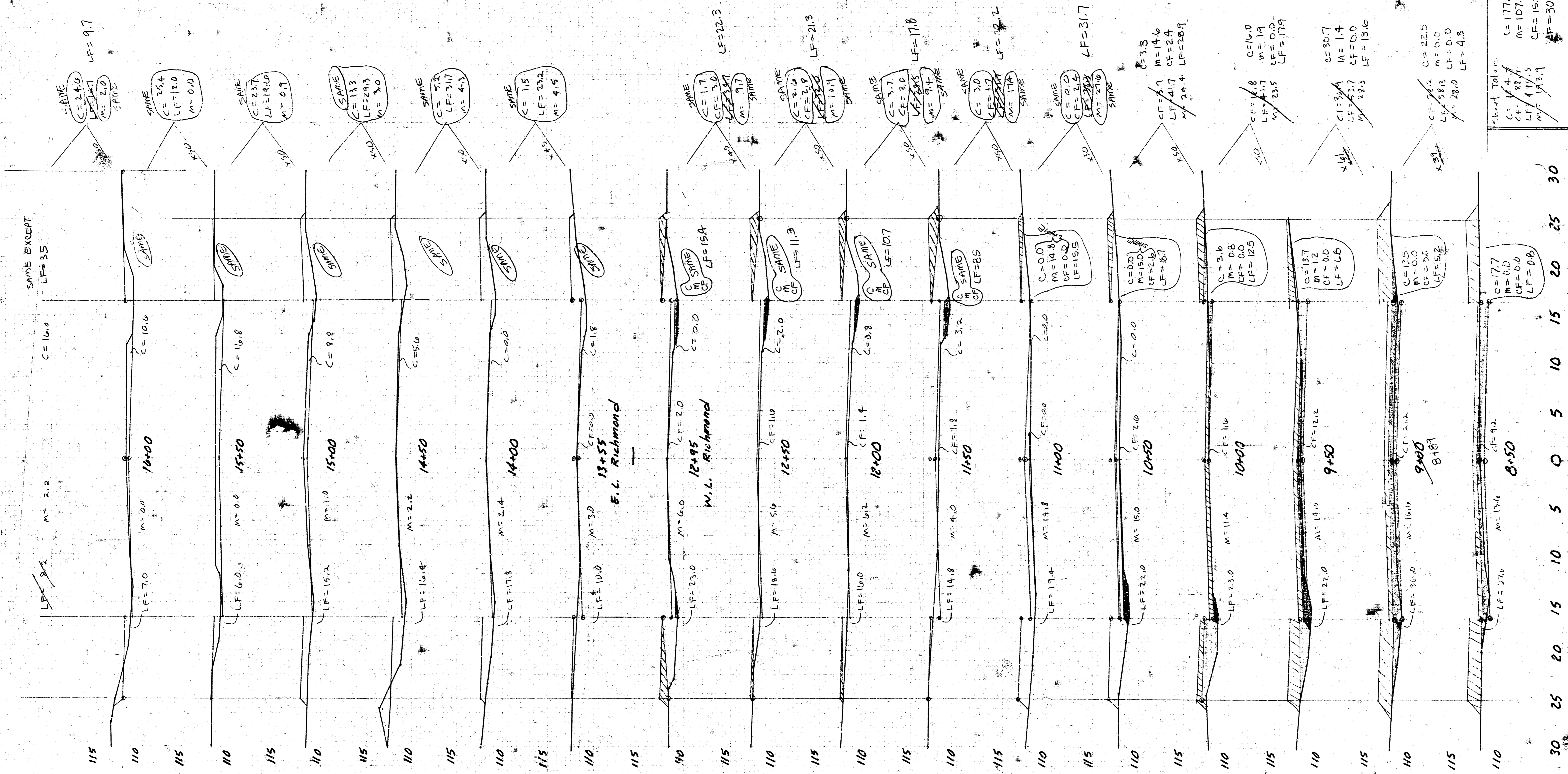

C=177.2
 M=107.6
 LF=15.3
 CF=30.55

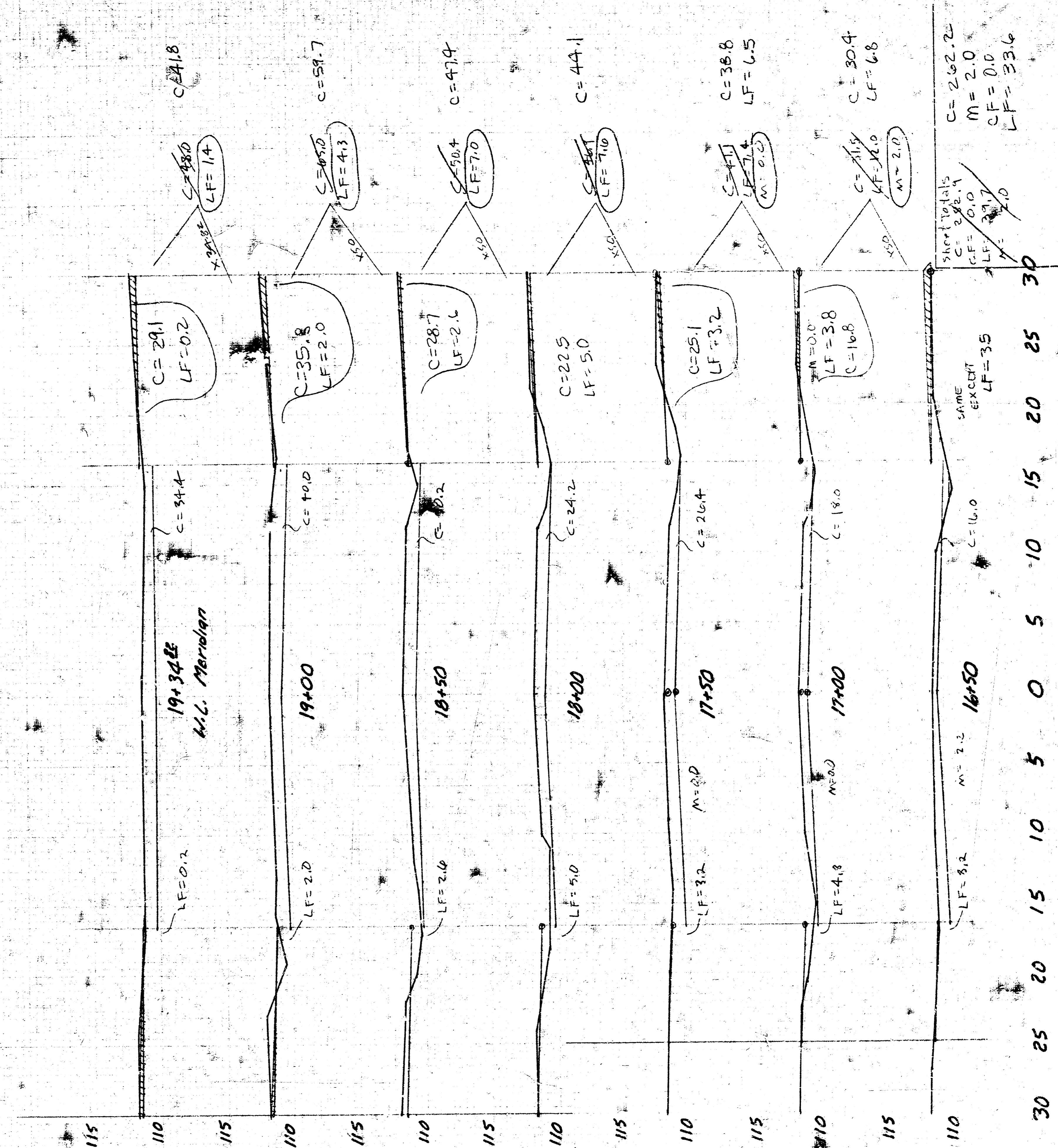

MAXWELL
 472 76 245 81172 000 000 001