

B.M. = 121.082 SE cor. 1st conc. step No. NW cor. 15th & Meridian
 B.M. = 123.54 Standard SW cor. 17th & Meridian.

NOTICE TO CONTRACTOR:-
 All entrance pipes are to be disposed of in accordance
 with instructions of City Drift Checker.

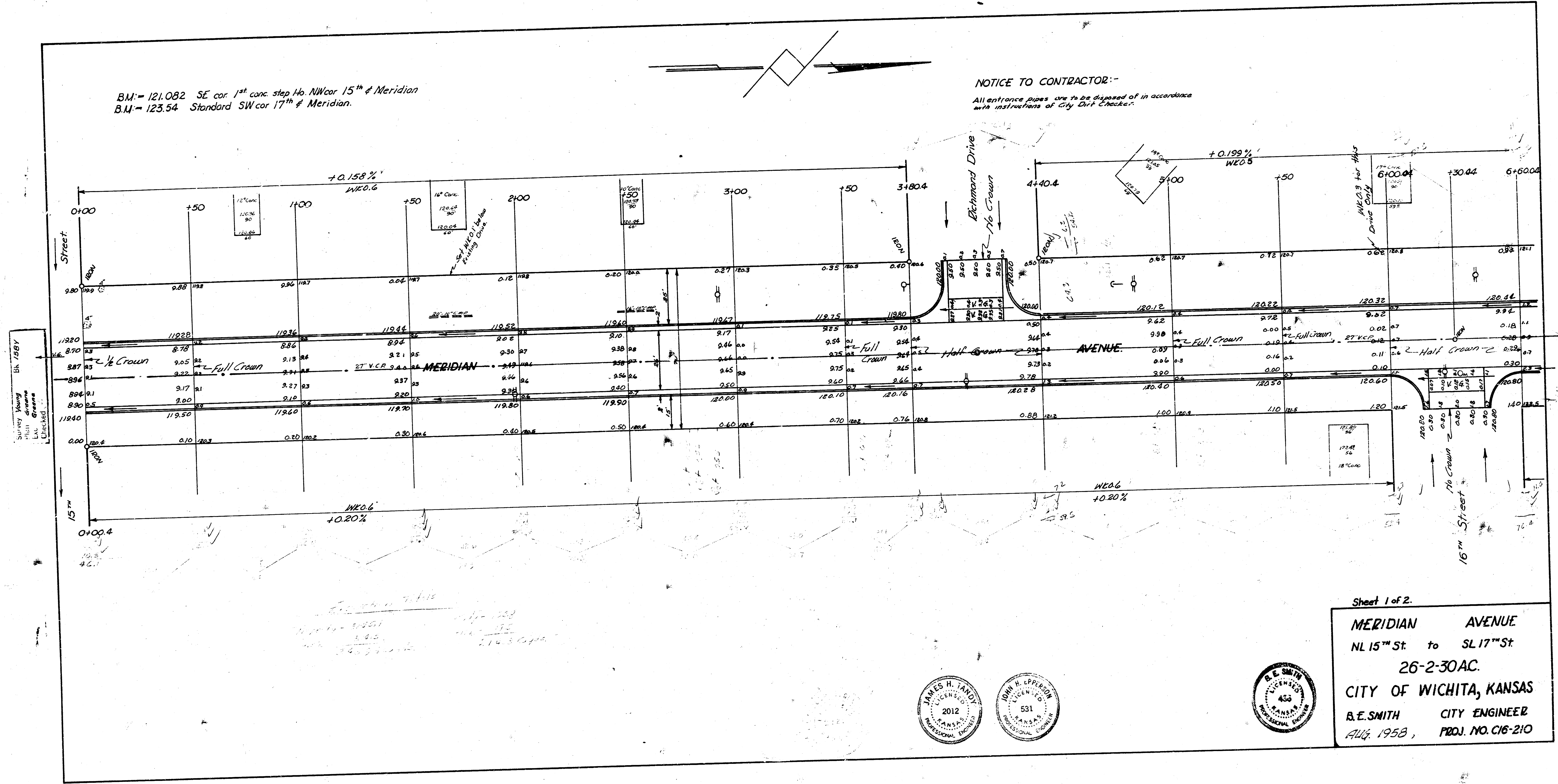

Sheet 1 of 2.
MERIDIAN AVENUE
 NL 15th St. to SL 17th St.
 26-2-30AC.
 CITY OF WICHITA, KANSAS
 B.E. SMITH CITY ENGINEER
 AUG. 1958, PROJ. NO. C16-210

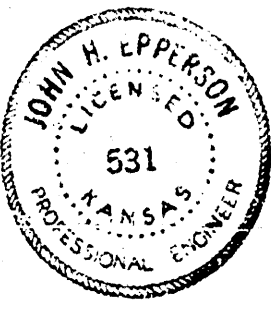

Survey Young
 Plan
 Checked

